

ENGLISH
ESPAÑOL

TRUPER[®] max

Manual

Cordless hammer drill / drill / screwdriver

20 V_≡ **1/2"**
Chuck

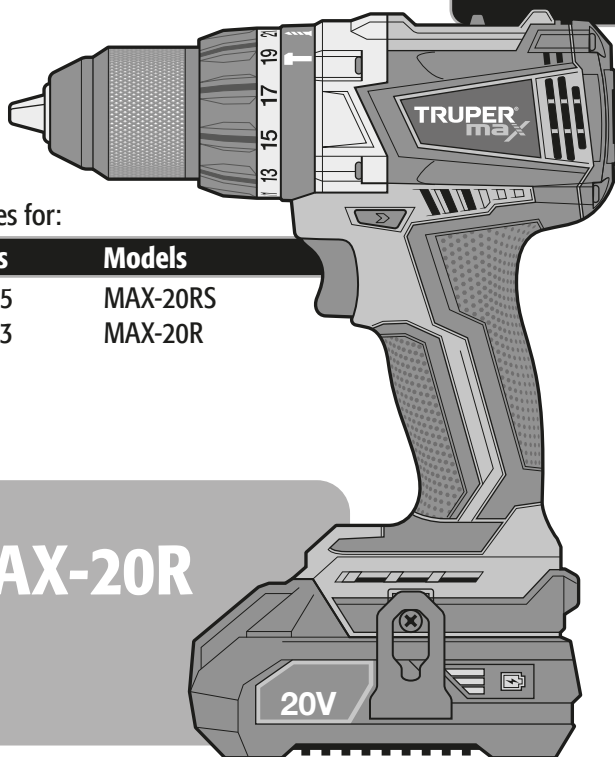

Applies for:

| Codes | Models |
|--------|----------|
| 101405 | MAX-20RS |
| 101453 | MAX-20R |

MAX-20R

CAUTION



Read this manual thoroughly
before using the tool.



| | |
|--|-----------|
| Technical data | 3 |
| Power requirements | 3 |
|  Safety warnings for power tools | 4 |
|  Safety warnings for hammer drills / drills / drivers | 5 |
| Parts | 6 |
| Preparation | 6 |
| Start up | 9 |
| Troubleshooting | 10 |
| Maintenance | 10 |
| Environmental protection | 10 |
| Authorized service centers | 11 |
| Warranty policy | 12 |

CAUTION

To gain the best performance of the tool, prolong the duty life, make the Warranty valid if necessary, and to avoid hazards of fatal injuries please read and understand this manual before using the tool.

Keep this manual for future references.

The illustrations in this manual are for reference only. They might be different from the real tool.

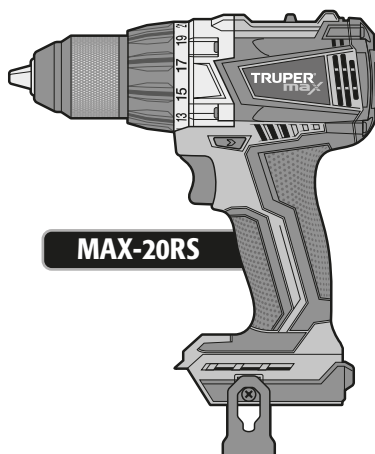

Technical data

TRUPER
max

| | MAX-20R | MAX-20RS |
|--------------------|--|---|
| Code | 101453 | 101405 |
| Description | Cordless hammer drill / drill / screwdriver | |
| Chuck | 1/2" keyless | |
| Voltage | 20 V \equiv | |
| Functions | Hammer drill / drill / driver with 21 torque functions | |
| Speed | Drill: 0 - 500 RPM and 0 - 1 800 RPM | |
| Strokes per minute | Hammer Drill: 0 - 7 500 BPM and 0 - 27 000 BPM | |
| Rotation | Forward - Reverse | |
| Torque | Strong: 39 Nm / Soft: 8 Nm | |
| Boring capacity | Concrete: 1/2" Wood: 1 1/4" Metal: 1/2" | |
| IP Grade | IP20 | |
| MAX-20R | Battery | Ion-Lithium 20 V \equiv 2 Ah Charging time: 60 min approximately. |
| | Charger | Input: Voltage: 127 V \sim Frequency: 60 Hz Current: 1.1 A Output: 21.5 V \equiv 3.5 A |

Charger power cord grips used in this product: Type "Y".
Tool build quality: Class III
Charger tool build quality: Reinforced insulation.

⚠ WARNING Avoid the risk of electric shock or severe injury. When the power cable gets damaged it should only be replaced by the manufacturer or at a **TRUPER** Authorized Service Center. The build quality of the electric insulation is altered if spills or liquid gets into the tool while in use. Do not expose to rain, liquids and/or dampness.

⚠ WARNING Before gaining access to the terminals all power sources should be disconnected.



Power requirements

⚠ WARNING Tools with double insulation and reinforced insulation are equipped with a polarized plug (one prong is wider than the other). This plug will only fit in the right way into a polarized outlet. If the plug cannot be introduced into the outlet, reverse the plug. If it still doesn't fit, call a qualified electrician to install for you a polarized outlet. Do not alter the plug in any way. Both types of insulation eliminates the need of both a grounded third power cord with three prongs or a grounded power connection.

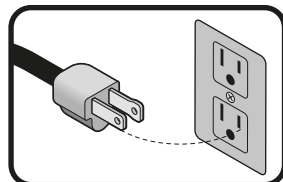

⚠ WARNING When using an extension cable, verify the gauge is enough for the power that your product needs. A lower gauge cable will cause voltage drop in the line, resulting in power loss and overheating. The following table shows the right size to use depending on cable's length and the ampere capability shown in the tool's nameplate. When in doubt use the next higher gauge.

| Ampere Capacity | Number of Conductors | Extension gauge | |
|--------------------------|----------------------|--------------------|-------------------|
| | | from 6 ft to 49 ft | higher than 49 ft |
| from 0 A and up to 10 A | 3 (one grounded) | 18 AWG(*) | 16 AWG |
| from 10 A and up to 13 A | | 16 AWG | 14 AWG |
| from 13 A and up to 15 A | | 14 AWG | 12 AWG |
| from 15 A and up to 20 A | | 8 AWG | 6 AWG |

* It is safe to use only if the extensions have a built-in artifact for over current protection.

AWG = American Wire Gauge. Reference: NMX-I-195-ANCE

⚠ WARNING When operating power tools outdoors, use a **volteck** grounded extension cable labeled "For Outdoors Use". These extensions are especially designed for operating outdoors and reduce the risk of electric shock.





Safety warnings for power tools



⚠ WARNING! Read carefully all safety warnings and instruction listed below. Failure to comply with any of these warnings may result in electric shock, fire and / or severe damage. **Save all warnings and instructions for future references.**

Work area

Keep your work area clean, and well lit.

Cluttered and dark areas may cause accidents.



Never use the tool in explosive atmospheres, such as in the presence of flammable liquids, gases or dust.

Sparks generated by power tools may ignite the flammable material.



Keep children and bystanders at a safe distance while operating the tool.

Distractions may cause losing control.



Electrical safety

The tool plug must match the power outlet. Never modify the plug in any way. Do not use any adapter plugs with grounded power tools.

Modified plugs and different power outlets increase the risk of electric shock.



Avoid body contact with grounded surfaces, such as pipes, radiators, electric ranges and refrigerators.

The risk of electric shock increases if your body is grounded.

Do not expose the tool to rain or wet conditions.

Water entering into the tool increases the risk of electric shock.

Do not force the cord. Never use the cord to carry, lift or unplug the tool. Keep the cord away from heat, oil, sharp edges or moving parts.

Damaged or entangled cords increase the risk of electric shock.

When operating a tool outdoors, use an extension cord suitable for outdoor use.

Using an adequate outdoor extension cord reduces the risk of electric shock.

If operating the tool in a damp location cannot be avoided, use a ground fault circuit interrupter (GFCI) protected supply.

Using a GFCI reduces the risk of electric shock.

Personal safety

Stay alert, watch what you are doing and use common sense when operating a tool. Do not use a power tool while you are tired or under the influence of drugs, alcohol or medication.

A moment of distraction while operating the tool may result in personal injury.

Use personal protective equipment. Always wear eye protection.

Protective equipment such as safety glasses, anti-dust mask, non-skid shoes, hard hats and hearing protection used in the right conditions significantly reduce personal injury.



Prevent unintentional starting up. Ensure the switch is in the "OFF" position before connecting into the power source and / or battery as well as when carrying the tool.

Transporting power tools with the finger on the switch or connecting power tools with the switch in the "ON" position may cause accidents.

Remove any wrench or vice before turning the power tool on.

Wrenches or vices left attached to rotating parts of the tool may result in personal injury.

Do not overreach. Keep proper footing and balance at all times.

This enables a better control on the tool during unexpected situations.

Dress properly. Do not wear loose clothing or jewelry. Keep hair, clothes and gloves away from the moving parts.

Loose clothes, jewelry or long hair may get caught in moving parts.



If you have dust extraction and recollection devices connected onto the tool, inspect their connections and use them correctly.

Using these devices reduce dust-related risks.

Power tools use and care

Do not force the tool. Use the adequate tool for your application.

The correct tool delivers a better and safer job at the rate for which it was designed.



Do not use the tool if the switch is not working properly.

Any power tool that cannot be turned ON or OFF is dangerous and should be repaired before operating.

Disconnect the tool from the power source and / or battery before making any adjustments, changing accessories or storing.

These measures reduce the risk of accidentally starting the tool.

Store tools out of the reach of children. Do not allow persons that are not familiar with the tool or its instructions to operate the tool.

Power tools are dangerous in the hands of untrained users.



Service the tool. Check the mobile parts are not misaligned or stuck. There should not be broken parts or other conditions that may affect its operation. Repair any damage before using the tool.

Most accidents are caused due to poor maintenance to the tools.



Keep the cutting accessories sharp and clean.

Cutting accessories in good working conditions are less likely to bind and are easier to control.

Use the tool, components and accessories in accordance with these instructions and the projected way to use it for the type of tool when in adequate working conditions.

Using the tool for applications different from those it was designed for, could result in a hazardous situation.

Battery tool use and care

Recharge only with the charger specified by  TRUPER.

A charger that is suitable for one type of battery pack may create a risk of fire when used with another battery pack.

Use power tools only with specifically designated battery packs.

Use of any other battery packs may create a risk of injury and fire.

When battery pack is not in use, keep it away from other metal objects, like paper clips, coins, keys, nails, screws, or other small metal objects, that can make a connection from one terminal to another.

Shorting the battery terminals together may cause burns or a fire.

Under abusive conditions, liquid may be ejected from the battery; avoid contact. If contact accidentally occurs, flush with water. If liquid contacts eyes, additionally seek medical help.

Liquid ejected from the battery may cause irritation or burns.

Service

Repair the tool in a  TRUPER Authorized Service Center using only identical spare parts.

This will ensure that the safety of the power tool is maintained.

Safety warnings for Hammer drills / Drills / Drivers

TRUPER
max

Battery and charger

⚠ DANGER • Use only Truper Max chargers to charge the battery. Using a different charger may cause fire or injury hazard.

⚠ DANGER • Use only batteries specifically designed for the tool. Different batteries could generate risk of injury or fire.

⚠ DANGER • Do not use the charger outdoors.

- When charging, obey the “+/-” polarity.
- Never recharge a leaking battery or that is visibly damaged.
- Do not use batteries or a charger for purposes different that it was designed for.
- Do not modify the battery contacts or the chargers.
- Do not expose the battery pack or the tool to fire or extreme temperatures. Exposure to fire or temperatures above 130 °C can cause an explosion.

⚠ DANGER • Never expose the batteries to fire or impact. They could explode.

⚠ CAUTION • Batteries shall be kept away from metallic objects like clips, coins, keys, nails, screws or other type of object making contact with the terminals. It would cause a short circuit and burns or fire. They should be kept clean, dry and in good repair.

⚠ CAUTION • Under extreme conditions the battery liquid could spill out. Avoid any contact. If an accidental contact happens clean with enough water. If the battery liquid comes into contact with your eyes, clean with enough water and immediately go see the doctor. Liquid expelled from the batteries could cause irritation or burns.

- Remove battery when not in use.

⚠ CAUTION • If the battery will be stored for long periods of time, keep an intermediate charge (40%) to maximize its useful life. Do not leave it completely charged for long periods of time, or leave it charging when not in use.

- Keep batteries away from children reach.
- Do not discard batteries together with household trash. Go to a specialized center for it's recycling.

Choose the right bit

⚠ CAUTION • Choose the right bit for the work piece. It reduces the risk of severe injury and makes the job easier.

- To work on metal or plastic, use bits suitable for metal. Sizes encompass a minimum of 0.05” and up to the chuck maximum capacity.
- On wood, use regular bits suitable for wood. In any case, to drill 0.25” or smaller orifices, use bits designed to drill on metal.
- Do not try using bits exceeding the chuck capacity.

Before operating the tool

- Take your time to assess the job to be done and double check you are paying attention to the necessary caution advices before starting to drill.
- Adjust correctly the bit into the chuck.

⚠ DANGER • Before boring a wall, floor or ceiling, double check there are no hidden objects, like cables, power conductors or pipes.

⚠ DANGER • Verify the switch is in the OFF position before inserting the battery. Otherwise it will start working unexpectedly, causing severe injuries.

⚠ CAUTION • Turn off and disconnect the tool before reversing the chuck rotation direction, as well as setting up or replacing a bit.

Use auxiliary handles, if supplied with the tool. Loss of control can cause personal injury.

While operating the tool

- Hold the tool by it's isolated surfaces designed for that purpose, especially when making jobs where the bit might contact hidden wiring. Contact with a power cable makes the metallic parts of the tool will be energized as well and produce a short circuit to the operator.

- Do not submit the tool to excessive loads.

⚠ CAUTION • If the bit gets stuck in the work piece, turn off the tool immediately. Then, remove the bit from the work piece. Do not try to remove stuck bits turning on and off the tool.

- Do not put excessive pressure on the tool to accelerate boring. Otherwise the bit will get damaged and the tool efficiency will diminish as well as it working life.

⚠ WARNING • The largest the bit diameter, the reactive force is higher. The reactive force is higher causing loss of control over the tool. To prevent this possibility hold firmly the tool with both hands, and keep good footing while boring at 90°.

- Stay alert and ready to relax the force when the bit goes through the material. Sudden movements can break the bit or damage the tool.

⚠ CAUTION • Do not touch the bit or the orifices immediately after drilling. Wait for them to cool off to manipulate. Do not try to cool them with water or oil.

- Before leaving the tool aside make sure all the moving parts have come to a complete stop.

• Avoid setting the tool where there are particles and / or dust immediately after use. These can get absorbed inside the tool mechanism and damage the machine.

- Wear hearing protectors when making jobs with a noise level higher than 85 dB.

• Wear anti-dust mask and dust extraction equipment if necessary. Remember that working with materials like asbestos, leaded paint, additives, some types of wood, metals or minerals are highly toxic.

- Wear safety eyeglasses.



The cordless hammer drill is useful both for drilling holes with impact mode, as well as for screwing and unscrewing

NOTE In model MAX-20RS, battery and charger are sold separately.

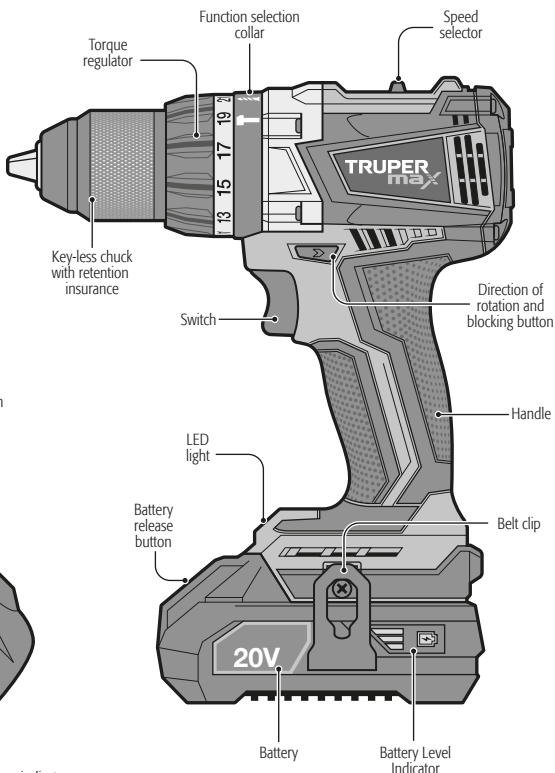
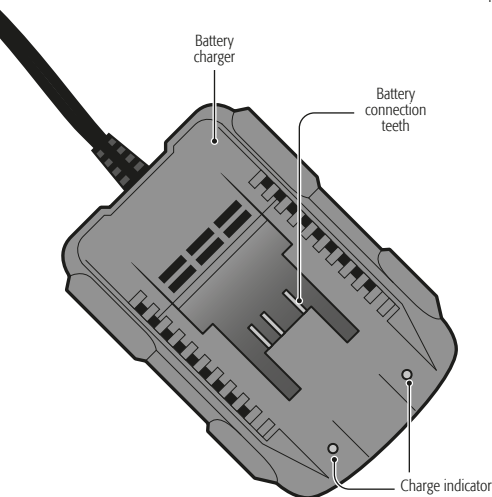

Preparation

Loading the battery

1. Plug in the charger in a 127 V~ (The green light of the charging indicator turns on) power outlet.
 2. Insert the battery into the charger sliding it as shown in the figure. The green light will turn off and the red light should come on.
- When the battery is completely charged, the green light will be on and the red light will be off.
 - Disconnect the charger from the power once the charge is completed.

Battery failures

- If the red light flashes, it is a sign that the battery has a delay caused by the heat; wait until the battery temperature is in the proper range to be able to charge.
- The red light remains on exceeding the recommended charging time or if the red and green light flash alternately it is a sign that the battery is defective; you must replace it or use a **TRUPER** Authorized Service Center.

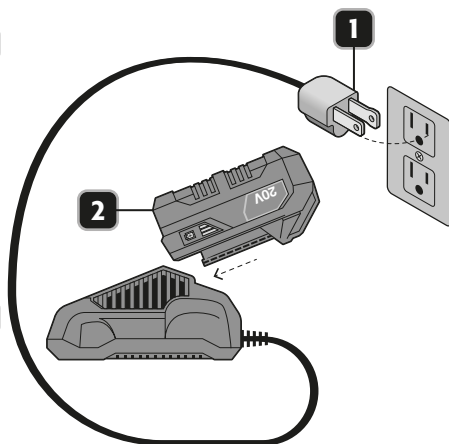

Important load considerations

- Longer life and better performance can be obtained if the battery unit is charged in room temperature between 5°C and 45°C. Allow a hot battery pack to cool before charging.
- The charger and battery unit may heat up slightly during the charging process. This is normal and does not represent any problem. To make it easier to cool the battery unit after use, avoid placing the charger or battery unit in a warm place, such as a metal shed or trailer without thermal insulation.
- The battery unit should be recharged when it is not able to produce enough power for jobs that were easily performed before. **DO NOT CONTINUE** to use it under these circumstances. Follow the charging procedure.
- The best storage place is one that is cool and dry, away from direct sunlight and excess heat or cold.
- For optimal results during extended storage times, it is recommended to store the fully charged battery unit in a cool, dry place outside the charger.

Belt Clip Assembly

- Attach the clip on the tool's accessory-designated side.
- Use the included screw (A) to adjust the clip.
- **NOTE:** If the tool already has the screw in position, just take it out before securing the clip.
- If you choose not to use the belt clip, you can detach it from the tool by loosening the screw that keeps it in position.

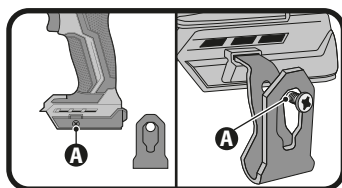

Tool/battery protection system

CAUTION • The tool is equipped with a system that automatically stops the tool to prolong both its useful life and that of the batteries, this happens in the following cases:

Overload. When the tool is forced, the battery consumes abnormally high current levels. Suspend overexertion work and turn the tool back on.

Overheating. Let the tool and battery cool before turning it back on.

Over-discharge. The battery level is low. In this case, remove the battery from the tool and charge it.

Batteries

- To install the battery in the tool handle, align the battery unit with the rails on the inside of the tool handle and slide it into the handle until the battery unit is firmly inserted into the tool; check that it does not come off by itself.
- To remove the battery from the tool, press the release button (A) and firmly pull the battery out of the tool handle.
- To make sure the battery is charged, press the indicator button (B). The color of the light indicates the charge level.

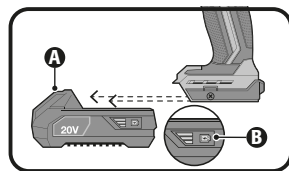

Remaining battery capacity

| | | | |
|----------------|--|--------|-------------|
| Indicator lamp | | Green | 51% to 100% |
| | | Orange | |
| | | Red | |
| Illuminated | | Orange | 26% to 50% |
| | | Red | |
| OFF | | | 10% to 25% |
| | | Red | |

NOTE: Depending on the conditions of use and ambient temperature, the indication may differ slightly from the actual capacity.

Bits or adaptors assembly

- Place the direction button in the locked position (center).
- Hold the handle firmly with one hand, and with the other hand turn the chuck counterclockwise for the jaws to loosen.
- Insert the bit until it stops or remove it whichever the situation.
- Turn the chuck tip clockwise to fasten the bit.
- The chuck has a lock that activates when turning the chuck. You will listen a click when the bit is set.

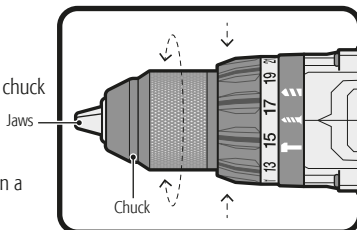

Direction of rotation

- To bore and screw release the switch and press the direction button on the side where arrows point towards the chuck.
- To reverse the turn, and unscrew press it on the other side.
- The drill switch will get blocked if the button sits in the middle.

CAUTION • The first time you turn on the drill and after reversing rotation you might hear a click. This is normal and does not represent a problem.

CAUTION • To prevent damaging the tool, never reverse the rotation direction while the drill is running.

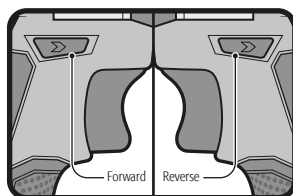

Speed selection

- The two speeds in the drill work in a similar manner to those used in cars.
- Low speed (1) will give a lot of torque (torsion power). Use this speed when starting to drill large orifices, be it wood or metal. This will prevent the bit to get stuck.
- High speed (2) has a reduced torque but lets the drill operate with higher revolutions per minute, that make the tool when in the drill function to bore faster lean metal or wood.

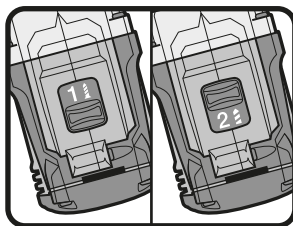

Change from hammer drill / drill / drivers

- To bore concrete, tiled floor or materials similarly hard, turn the function selection collar into the IMPACT (🔨) position. The bit will strike and rotate at the same time onto the material.
- To bore metal or plastic turn the function selection collar into the DRILL (🌀) position to make the bit rotate against the material.
- For screw / unscrew turn the function selection collar to this position (🔩) so the bit turns over the screw for better control.

WARNING Do not try to drill metal, wood or plastic with the hammer drill in the IMPACT mode. Otherwise the tool efficiency would diminish and the bit tip will get damaged.

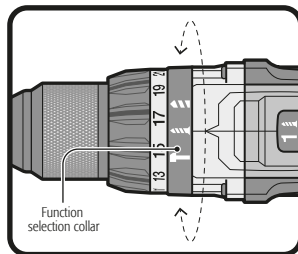

Torque adjust

- To select the desired torque level to screw drive, turn the torque regulator until it matches the corresponding number with the upper mark:
- From 1 to 4 for small screws,
- From 5 to 9 for screws on soft materials,
- From 10 to 15 for screws on soft and hard material.
- On 16 to 21, for larger screws.

CAUTION • The torque level necessary depends on the type of screw to be used and the material onto which you are working. In if doubt use a lower torque and increase gradually until reaching the right one. An adequate torque prevents damaging the tool.

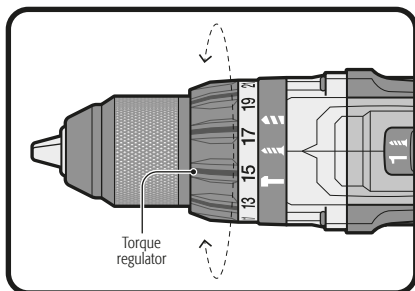

Turn On and operation control

- The switch allows selecting the adequate speed for each job. The more you push the switch the fastest the drill will run.
- The switch is also built with a braking function. When releasing the trigger, the drill will immediately stop and you will be able to use it as a manual screwdriver to give a screw an extra turn.

Screwing - Unscrewing

- It is recommended to first bore a "pilot orifice"; slightly longer and barely narrower than the measurements of the screw. This orifice will be the entry guide for the screw and will make it easier to tighten. When screwing near the edge of a work piece, a pilot orifice prevents the wood from cracking.
- Use the adequate type of tip for each screw head to prevent the screw from sticking over from the surface.
- If inserting the screw gets difficult, remove and try to bore a slightly longer or wider orifice. However keep in mind there should be enough material to fasten the screw. If you reinitiate the screwing operation in an already-made orifice, start threading it by hand. If still difficult to thread the screw (as with noble woods), try using lubricants like soap. Liquid soap is more useful.
- Always apply enough pressure on the drill to prevent the screw head to slide. It is easy that the screw head gets damaged, making it difficult to completely get inserted or even to remove it.

Additional recommendations

- Use the adequate speed for each job: do not try to bore at low speeds or to screw at high speeds.
- If the operation overloads the drill, take it out and repeat the operation applying less strength.
- Use low speeds to start bores where there is no support point; on plastic or metal; when screwing, boring ceramic or any other application that requires a high torque. Use high speeds to drill woods and using polishing devices.
- To get a longer drill duty life, use the variable speed control.

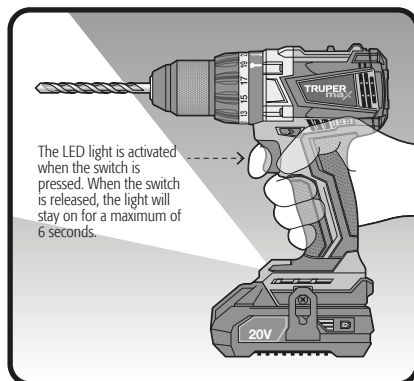

Drilling

- When trying to bore large diameter orifices it is better to start with a narrow bit and then replace it with the required size. This prevents overloading the drill.
- When drilling deep orifices remove the bit a little and regularly while boring to allow the shavings to be correctly expelled from the orifice.

⚠ CAUTION • If the bit gets stuck, immediately release the switch to prevent damaging the tool. Try to release the bit reversing the operation direction.

- Keep the drill aligned regarding the orifice. Ideally the bit shall enter the work piece perpendicularly. If the angle is changed while drilling, it could make the bit to break and block the orifice or causing personal injury.

Problem

Cause

Solution

The hammer drill loses efficiency.

- Low battery.

- Charge the battery.

The trigger cannot be pushed.

- The direction rotation button is in the blocking position.

- Move the direction button into the rotate or reverse position.

The trigger can be pushed but the hammer drill stops operations.

- Uncharged battery.

- Charge battery.

- Regulator is adjusted into a inadequate torque.

- Adjust the regulator into a torque that allows the job. Try with the next torque level.

The torque regulator stops operation.

- Small leaking can be present in extreme temperatures or after heavy use. This is normal.
- Intense leaking or very evident shows a damaged battery.

- Immediately clean the liquid from skin or clothing using water and soap.
- Replace the battery immediately.

The battery leaks.

The battery is not charging and the charger light is not on.

- The battery is wrongly fit into the charger.
- The charger is not correctly plugged into the power outlet.

- Insert correctly the battery to the charger.
- Double-check the battery is correctly connected into the power outlet.

The hammer drill gets hot after long periods or work.

- This heating is normal. It absorbs the energy from the motor cogs and the electricity generated during the job.

- Allow the hammer drill to cool off for 5 minutes.

The battery gets hot while operating.

- This heating is normal. The energy absorbed from the battery makes this warning.

- Stop the drill around 5 minutes to allow the battery to cool off.

The battery gets hot while charging.

- This type of warming is normal. Results from the chemical reactions happening.

The charger gets hot while charging.

- This type of warming is normal resulting from tension regulation.

Maintenance

Cleaning and care

- Keep the air vents clean and free of obstructing debris to guarantee an adequate motor cooling.
- Regularly inspect all the assembly screws. Double check they are correctly tightened. In the event one screw is loose, tighten immediately.
- Use a clean and soft cloth to clean the tool. Never use alcohol or detergent. Disconnect the tool and remove the battery before cleaning.

Service

- Servicing the tool shall be carried out only in a  **TRUPER** Authorized Service Center.
- Service and maintenance carried out by non - qualified people may result dangerous and could cause personal damage. It also makes the Warranty void.

Environmental protection

Power tools and batteries should not be disposed off together with household trash. Please deliver this tool and the batteries to its adequate recycling in the authorized disposal sites. Verify the nearest recycling center in your community.

In the event of any problem contacting a Truper Authorized Service Center, please see our webpage www.truper.com to get an updated list, or call our toll-free numbers **800 690-6990** or **800 018-7873** to get information about the nearest Service Center.

AGUASCALIENTES **DE TODO PARA LA CONSTRUCCIÓN**
GRAL. BARRAGÁN #1201, COL. GREMIAL, C.P. 20030,
AGUASCALIENTES, AGS. TEL.: 449 994 0537

BAJA CALIFORNIA **SUCURSAL TIJUANA**
AV. LA ENCANTADA, LOTE #5, PARQUE INDUSTRIAL EL
FLORIDO II, C.P. 22244, TIJUANA, B.C.
TEL.: 664 969 5100

BAJA CALIFORNIA SUR **FIX FERRETERÍAS**
FELIPE ÁNGELES ESQ. RUIZ CORTÍNEZ S/N, COL. PUEBLO
NUEVO, C.P. 23670, CD. CONSTITUCIÓN, B.C.S.
TEL.: 613 132 1115

CAMPECHE **TORNILLERÍA Y FERRETERÍA AAA**
AV. ALVARO OBREGÓN #324, COL. ESPERANZA
C.P. 24080 CAMPECHE, CAMP. TEL.: 981 815 2808

CHIAPAS **FIX FERRETERÍAS**
AV. CENTRAL SUR #27, COL. CENTRO, C.P. 30700,
TAPACHULA, CHIS. TEL.: 962 118 4083

CHIHUAHUA **SUCURSAL CHIHUAHUA**
AV. SILVESTRE TERRAZAS #128-11, PARQUE INDUSTRIAL
BAFAR, CARRETERA MÉXICO CUAUHTÉMOC, C.P. 31415,
CHIHUAHUA, CHIH. TEL.: 614 434 0052

CIUDAD DE MÉXICO **FIX FERRETERÍAS**
EL MONSTRUO DE CORREGIDORA, CORREGIDORA # 35,
COL. CENTRO, C.P. 06060, CUAUHTÉMOC, CDMX.
TEL.: 55 5522 5051 / 5522 4861

COAHUILA **SUCURSAL TORREÓN**
CALLE METAL MECÁNICA #280, PARQUE INDUSTRIAL
ORIENTE, C.P. 27278, TORREÓN, COAH.
TEL.: 871 209 6823

COLIMA **BOMBAS Y MOTORES BYMTESA DE MANZANILLO**
BLVD. MIGUEL DE LA MADRID #190, COL. 16 DE
SEPTIEMBRE, C.P. 28239, MANZANILLO, COL.
TEL.: 314 332 1986 / 332 8013

DURANGO **TORNILLOS ÁGUILA, S.A. DE C.V.**
MAZURIO #200, COL. LUIS ECHEVERRÍA, DURANGO,
DGO. TEL.: 618 817 1946 / 618 818 2844

ESTADO DE MÉXICO **SUCURSAL CENTRO JILOTEPEC**
PARQUE INDUSTRIAL # 1, COL. PARQUE INDUSTRIAL
JILOTEPEC, JILOTEPEC, EDO. DE MÉX. C.P. 54257
TEL.: 761 782 9101 EXT. 5728 Y 5102

GUANAJUATO **CÍA. FERRETERA NUEVO MUNDO S.A. DE C.V.**
AV. MÉXICO - JAPÓN #225, CD. INDUSTRIAL, C.P. 38010,
CELAYA, GTO. TEL.: 461 617 7578 / 79 / 80 / 88

GUERRERO **CENTRO DE SERVICIO ECLIPSE**
CALLE PRINCIPAL MZ1 LT. 1, COL. SANTA FE, C.P. 39010,
CHILPANCINGO, GRO. TEL.: 747 478 5793

HIDALGO **FERREPRECIOS S.A. DE C.V.**
LIBERTAD ORIENTE #304 LOCAL 30, INTERIOR DE PASAJE
ROBLEDO, COL. CENTRO, C.P. 43600, TULANCINGO,
HGO. TEL.: 775 753 6615 / 775 753 6616

JALISCO **SUCURSAL GUADALAJARA**
AV. ADOLFO B. HORN # 6800, COL. SANTA CRUZ DEL
VALLE, C.P.: 45655, TLAJOMULCO DE ZUÑIGA, JAL.
TEL.: 33 3606 5285 AL 90

MICHOACÁN **FIX FERRETERÍAS**
AV. PASEO DE LA REPÚBLICA #3140-A, COL.
EX-HACIENDA DE LA HUERTA, C.P. 58050, MORELIA,
MICH. TEL.: 443 334 6858

MORELOS **FIX FERRETERÍAS**
CAPITÁN ANZURES #95, ESQ. JOSÉ PERDIZ, COL.
CENTRO, C.P. 62740, CUAUTLA, MOR.
TEL.: 735 352 8951

NAYARIT **HERRAMIENTAS DE TEPEC**
MAZATLAN #117, COL. CENTRO, C.P. 63000, TEPEC, NAY.
TEL.: 311 258 0540

NUOVO LEÓN **SUCURSAL MONTERREY**
CARRETERA LAREDO #300, 1B MONTERREY PARKS,
COLONIA PUERTA DE ANÁHUAC, C.P. 66052, ESCOBEDO,
NUEVO LEÓN, TEL.: 81 8352 8791 / 81 8352 8790

OAXACA **FIX FERRETERÍAS**
AV. 20 DE NOVIEMBRE #910, COL. CENTRO, C.P. 68300,
TUXTEPEC, OAX. TEL.: 287 106 3092

PUEBLA **SUCURSAL PUEBLA**
AV. PERIFÉRICO #2-A, SAN LORENZO ALMECATLA,
C.P. 72710, CUAUHTLACINGO, PUE.
TEL.: 222 282 8282 / 84 / 85 / 86

QUERÉTARO **ARU HERRAMIENTAS S.A. DE C.V.**
AV. PUERTO DE VERACRUZ #110, COL. RANCHO DE
ENMEDIO, C.P. 76842, SAN JUAN DEL RÍO, QRO.
TEL.: 427 268 4544

QUINTANA ROO **FIX FERRETERÍAS**
CARRETERA FEDERAL MZ. 46 LT. 3 LOCAL 2, COL. EJIDAL,
C.P. 77710 PLAYA DEL CARMEN, Q.R.
TEL.: 984 267 3140

SAN LUIS POTOSÍ **FIX FERRETERÍAS**
AV. UNIVERSIDAD #1850, COL. EL PASEO, C.P. 78320,
SAN LUIS POTOSÍ, S.L.P. TEL.: 444 822 4341

SINALOA **SUCURSAL CULIACÁN**
AV. JESÚS KUMATE SUR #4301, COL. HACIENDA DE LA
MORA, C.P. 80143, CULIACÁN, SIN.
TEL.: 667 173 9139 / 173 8400

SONORA **FIX FERRETERÍAS**
CALLE 5 DE FEBRERO #517, SUR LT. 25 MZ. 10, COL.
CENTRO, C.P. 85000, CD. OBREGÓN, SON.
TEL.: 644 413 2392

TABASCO **SUCURSAL VILLAHERMOSA**
CALLE HELIO LOTES 1, 2 Y 3 MZ. #1, COL. INDUSTRIAL,
2A ETAPA, C.P. 86010, VILLAHERMOSA, TAB.
TEL.: 993 353 7244

TAMAULIPAS **VM ORINGS Y REFACCIONES**
CALLE ROSITA #527 ENTRE 20 DE NOVIEMBRE Y GRAL.
RODRÍGUEZ, FRACC. REYNOSA, C.P. 88780, REYNOSA,
TAMS. TEL.: 899 926 7552

TLAXCALA **SERVICIOS Y HERRAMIENTAS INDUSTRIALES**
PABLO SIDAR #132, COL. BARRIO DE SAN BARTOLOMÉ,
C.P. 90970, SAN PABLO DEL MONTE, TLAX.
TEL.: 222 271 7502

VERACRUZ **LA CASA DISTRIBUIDORA TRUPER**
BLVD. PRIMAVERA ESQ. HORTENSIA S/N, COL.
PRIMAVERA C.P. 93308, POZA RICA, VER.
TEL.: 782 823 8100 / 826 8484

YUCATÁN **SUCURSAL MÉRIDA**
CALLE 33 #600 Y 602, LOCALIDAD ITZINCAB Y MULSAI,
MPIO. UMAN, C.P. 97390, MÉRIDA, YUC.
TEL.: 999 912 2451

| Code | Model | Brand |
|--------|----------|---------------|
| 101405 | MAX-20RS | TRUPER max |
| 101453 | MAX-20R | |

Warranty. Duration: 5 year. Coverage: parts, components and workmanship against manufacturing or operating defects, except if used under conditions other than normal; when it was not operated in accordance with the instructive; was altered or repaired by personnel not authorized by TRUPER®. To make the warranty valid, only present the product in the establishment where you bought it or in Corregidora 35, Centro, Cuauhtémoc, CDMX, 06060, where you can also purchase parts, components, consumables and accessories. The costs of transportation of the product that derive from its fulfillment of its service network are included. TRUPER will not require any proof of purchase to make the warranty effective. Phone number 800-018-7873. Made in China. Imported by TRUPER, S.A. de C.V. Parque Industrial 1, Parque Industrial Jilotepec, Jilotepec, Edo. de Méx. C.P. 54257, Phone number 761 782 9100.

Stamp of the business. Delivery date:

