

ENGLISH

ESPAÑOL

TRUPER[®]

Manual

Automatic battery charger / maintainer

CARBA-1

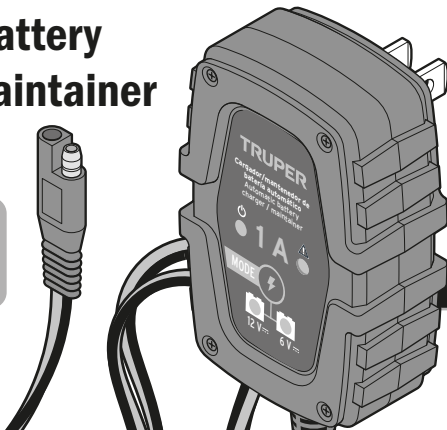

1 A
Current

Applies for

Code	Model
101610	CARBA-1

CAUTION



Read this manual thoroughly
before using the tool.





Technical data	3
Safety warnings	4
Parts	5
Start Up	6
Troubleshooting	8
Notes	9
Warranty Policy	10

Contents



CAUTION

To gain the best performance of the tool, prolong the duty life, make the Warranty valid if necessary, and to avoid hazards of fatal injuries please read and understand this manual before using the tool.

Keep this manual for future references.

The illustrations in this manual are for reference only. They might be different from the real tool.

CARBA-1

Code	•	101610
Description	•	Automatic battery charger / maintainer
Output voltage	•	6 V c.c. 12 V c.c.
Maximum input power	•	21 W (Maximum)
Rated output voltage	•	7.2 V c.c. \pm 0.2 V 14.4 V c.c. \pm 0.2 V
Rated output current	•	1 A
Frequency	•	60 Hz
Work temperature	•	32 °F - 104 °F
Storage temperature	•	32 °F - 140 °F
Size	•	2.7" x 1.35" x 4"
Weight	•	0.405 lb

Uses

This charger is designed for use with deep cycle lead-acid (standard) batteries and 6V DC / 12 V DC AGM batteries.

Charge and maintenance (up to 12 Ah)



Maintenance only (more than 60 Ah)



⚠ CAUTION • Read all instructions before using or operating the charger.

- Do not disassemble the charger without training.
- It is normal for the charger to be slightly warm when in use, this situation does not affect the life of the charger.

⚠ WARNING • Do not use the charger in rainy or humid environments.

- Do not place the charger within reach of children.

⚠ CAUTION • Check the power cord before use and confirm that it is not damaged. Do not use the charger if the cable is damaged.

- Never attempt to recharge a damaged or frozen battery.
- Never place the charger on top of the battery when it is charging.
- Keep the battery well ventilated and do not cover it.
- Disconnect the battery when it is fully charged.

Safety warnings

- Keep the charger away from heat sources when charging to prevent the heat source from damaging the charger and becoming a safety issue.
- The AC input must comply with national regulations for electrical installations.

Explosive gas hazards

⚠ DANGER • It is dangerous to work near a battery with acid as the battery acid produces explosive gas during operation. It is important to follow the instructions in the user's manual before use.

- To reduce the danger of battery explosion, follow these instructions and those published by the manufacturer of the equipment to be used near the battery.

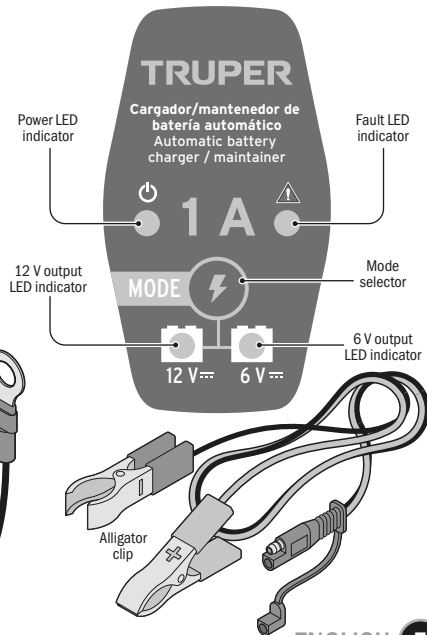
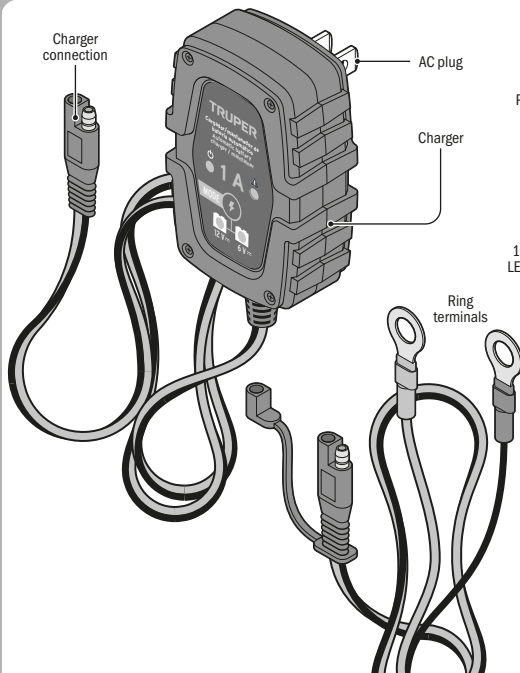

1. Connect to the AC outlet (A)

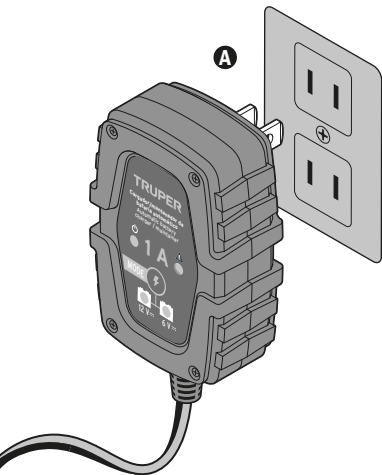

2. Select the correct charging voltage according to the nominal voltage of the battery (e.g., for a 6 V battery select the 6 V charging voltage).

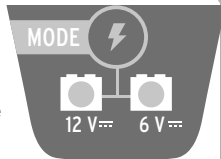

3. You have two options for fastening the battery terminals: by means of clamps (B) or washers (C), depending on the type of battery. Connect the most suitable one to the charger cable (D).

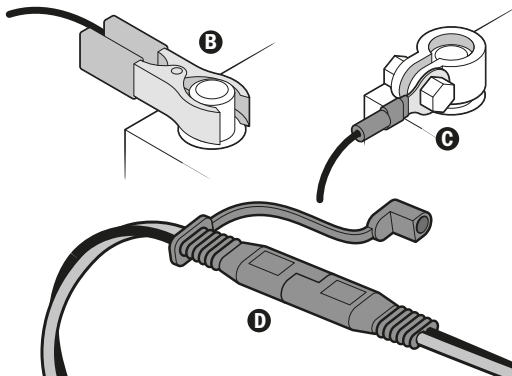

4. Connect the red clamp or washer to the positive battery "+" and the black clamp or washer to the negative of the battery "-" (E).

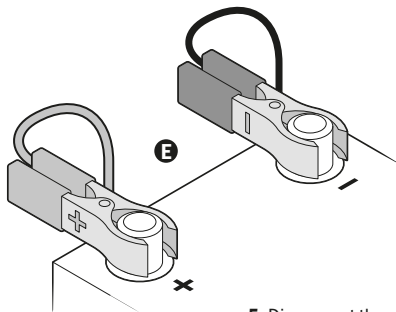

5. Disconnect the mains plug before disconnecting the battery, and then remove the battery clamps or washers.

Safety device

1. The charger will automatically go into sleep mode when charging is finished to prevent overcharging.
2. The charger is protected against short-circuit on the AC input.
3. Over-temperature protection: The charger will shut down when the charger is used for a long time at high temperature and/or when the inside temperature of the charger exceeds the preset temperature. When the temperature becomes normal, the charger will automatically return to normal charging mode.
4. The charger has over-voltage protection.
5. Fire protection.
No clamp output when disconnected with battery to avoid sparks.
6. Low voltage activation.
The charger will enter charging mode automatically when the voltage at the end of the clamp is higher than 2 V d.c., the charger will not charge if the voltage is lower than 2 V d.c.
7. **⚠ WARNING** Use the correct charging voltage according to the rated voltage of the battery, or the battery will be damaged.
8. **⚠ WARNING** Do not charge the battery when the engine is running.

Problem

Solution

Does not react when power is on.

1. Check if the battery charger is plugged into a good socket.
2. Does the plug have an AC outlet?

The indicator lights up, but there is no DC output.

1. Check that the clamp is properly connected.
2. Check if the terminal is sulfated.
3. Check if the clamp cable is broken.

The power indicator and fault indicator light up at the same time.

1. Check that the clamp is not connected backwards.
2. The charger was in overheat protection.
3. Incorrect battery voltage was selected.

Voltage indicator does not light up when the charger is running.

The 6 V or 12 V indicator does not light up when the charger is running.

6 V / 12 V do not light or are not sensitive.

1. Incorrect operation when the switch is used.
2. Switch is damaged.

Code**101610****Model****CARBA-1****Brand****TRUPER**

Warranty. Duration: 1 year. Coverage: parts, components and workmanship against manufacturing or operating defects, except if used under conditions other than normal; when it was not operated in accordance with the instructive; was altered or repaired by personnel not authorized by TRUPER®. To make the warranty valid, present the product, stamped policy or invoice or receipt or voucher, in the establishment where you bought it or in Corregidora 35, Centro, Cuauhtémoc, CDMX, 06060, where you can also purchase parts, components, consumables and accessories. It includes the costs of transportation of the product that derive from its fulfillment of its service network. . Phone number 800-018-7873. Made in China. Imported by TRUPER, S.A. de C.V. Parque Industrial 1, Parque Industrial Jilotepec, Jilotepec, Edo. de Méx. C.P. 54257, Phone number 761 782 9100.

Stamp of the business. Delivery date:



WWW.TRUPER.COM

12-2024