

ENGLISH  
ESPAÑOL

# TRUPER<sup>®</sup> max

Manual

## Cordless Angle Grinder

20 V<sup>==</sup> 115 mm  
4 1/2"  
Disc

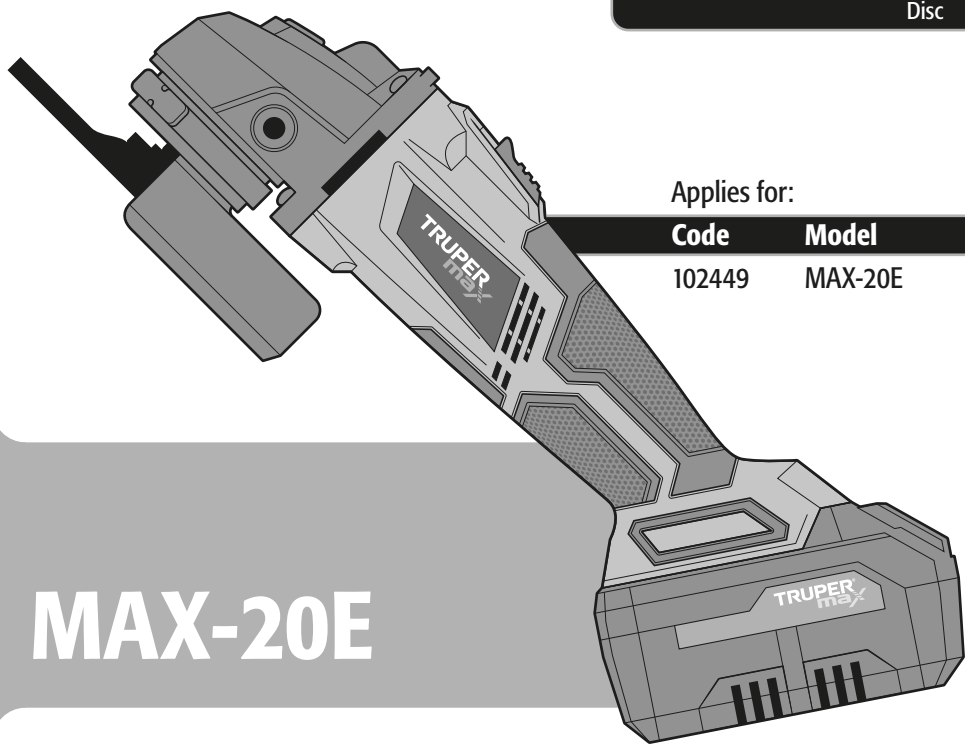

Applies for:

Code	Model
102449	MAX-20E

## MAX-20E

**CAUTION**



Read this manual thoroughly  
before using the tool.



Technical data .....	<b>3</b>
Power requirements .....	<b>3</b>
 General power tool safety warnings .....	<b>4</b>
 Safety warnings for the use of cordless grinders .....	<b>5</b>
Parts .....	<b>8</b>
Preparation .....	<b>9</b>
Mounting .....	<b>10</b>
Start up .....	<b>11</b>
Maintenance .....	<b>12</b>
Environmental protection .....	<b>12</b>
Authorized Service Centers .....	<b>13</b>
Warranty policy .....	<b>14</b>

 **CAUTION**

To gain the best performance of the tool, prolong the duty life, make the Warranty valid if necessary, and to avoid hazards of fatal injuries please read and understand this Manual before using the tool.

Keep this manual for future references.

The illustrations in this manual are for reference only. They might be different from the real tool.

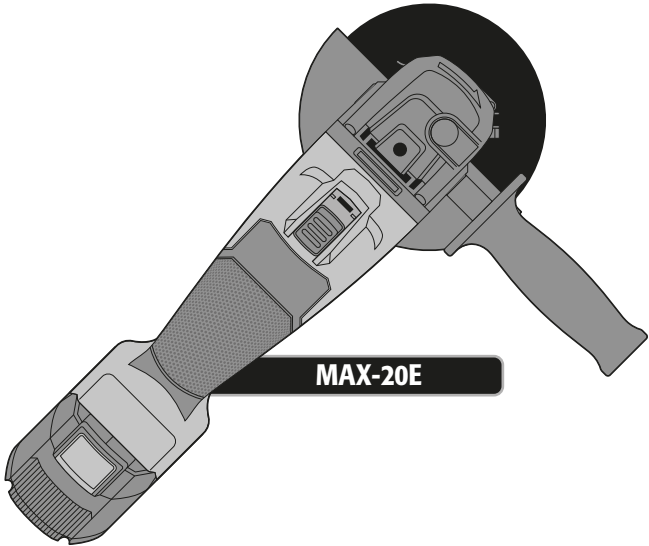

## MAX-20E

Code	102449
Description	Cordless angle grinder
Discs	4 1/2"
Voltage	20 V <sup>---</sup>
Speed	10 000 RPM
IP Grade	IP20
Thread size	5/8-11-UNC-1A
Battery	Ion-lithium 20 V <sup>---</sup> 4 Ah   Charging time: 80 min approximately
Charger	Input: Voltage: 127 V~ Frequency: 60 Hz Current: 1.1 A Output: 21.5 V <sup>---</sup> 3.5 A

The charger power cord has cord fasteners type: Y  
The construction class of the tool is: Class III  
The construction class of the charger is: Reinforced insulation

**⚠ WARNING** Avoid the risk of electric shock or severe injury. When the power cable gets damaged it should only be replaced by the manufacturer or at a **TRUPER** Authorized Service Center. The build quality of the electric insulation is altered if spills or liquid gets into the tool while in use. Do not expose to rain, liquids and/or dampness.

**⚠ WARNING** Before gaining access to the terminals all power sources should be disconnected.



## Power Requirements

**⚠ WARNING** Tools with double insulation and reinforced insulation are equipped with a polarized plug (one prong is wider than the other). This plug will only fit in the right way into a polarized outlet. If the plug cannot be introduced into the outlet, reverse the plug. If it still doesn't fit, call a qualified electrician to install for you a polarized outlet. Do not alter the plug in any way. Both insulation types eliminate the need of both a grounded third power cord with three prongs or a grounded power connection.

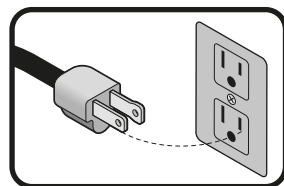

**⚠ WARNING** When using an extension cable, verify the gauge is enough for the power that your product needs. A lower gauge cable will cause voltage drop in the line, resulting in power loss and overheating. The following table shows the right size to use depending on cable's length and the ampere capability shown in the tool's nameplate. When in doubt use the next higher gauge.

Ampere Capacity	Number of Conductors	Extension gauge	
		from 6' to 49'	higher than 49'
from 0 A and up to 10 A	3 (one grounded)	18 AWG(*)	16 AWG
from 10 A and up to 13 A		16 AWG	14 AWG
from 13 A and up to 15 A		14 AWG	12 AWG
from 15 A and up to 20 A		8 AWG	6 AWG

\* It is safe to use only if the extensions have a built-in artifact for over current protection.  
AWG = American Wire Gauge. Reference: NMX-J-195-ANCE

**⚠ WARNING** When operating power tools outdoors, use a **VOLTECK** grounded extension cable labeled "For Outdoors Use". These extensions are specially designed for operating outdoors and reduce the risk of electric shock.





## General power tool safety warnings



**⚠ WARNING! Read carefully all safety warnings and instructions listed below.** Failure to comply with any of these warnings may result in electric shock, fire and / or severe damage. **Save all warnings and instructions for future references.**

### Work area

**Keep your work area clean, and well lit.**

Cluttered and dark areas may cause accidents.



**Never use the tool in explosive atmospheres, such as in the presence of flammable liquids, gases or dust.**

Sparks generated by power tools may ignite the flammable material.



**Keep children and bystanders at a safe distance while operating the tool.**

Distractions may cause losing control.



### Electrical Safety

**The tool plug must match the power outlet. Never modify the plug in any way. Do not use any adapter plugs with grounded power tools.**

Modified plugs and different power outlets increase the risk of electric shock.



**Avoid body contact with grounded surfaces, such as pipes, radiators, electric ranges and refrigerators.**

The risk of electric shock increases if your body is grounded.

**Do not expose the tool to rain or wet conditions.**

Water entering into the tool increases the risk of electric shock.

**Do not force the cord. Never use the cord to carry, lift or unplug the tool. Keep the cord away from heat, oil, sharp edges or moving parts.**

Damaged or entangled cords increase the risk of electric shock.

**When operating a tool outdoors, use an extension cord suitable for outdoor use.**

Using an adequate outdoor extension cord reduces the risk of electric shock.

**If operating the tool in a damp location cannot be avoided, use a ground fault circuit interrupter (GFCI) protected supply.**

Using a GFCI reduces the risk of electric shock.

### Personal safety

**Stay alert, watch what you are doing and use common sense when operating a tool. Do not use a power tool while you are tired or under the influence of drugs, alcohol or medication.**

A moment of distraction while operating the tool may result in personal injury.

**Use personal protective equipment. Always wear eye protection.**

Protective equipment such as safety glasses, anti-dust mask, non-skid shoes, hard hats and hearing protection used in the right conditions significantly reduce personal injury.



**Prevent unintentional starting up. Ensure the switch is in the "OFF" position before connecting into the power source and / or battery as well as when carrying the tool.**

Transporting power tools with the finger on the switch or connecting power tools with the switch in the "ON" position may cause accidents.

**Remove any wrench or vice before turning the power tool on.**

Wrenches or vices left attached to rotating parts of the tool may result in personal injury.

**Do not overreach. Keep proper footing and balance at all times.**

This enables a better control on the tool during unexpected situations.

**Dress properly. Do not wear loose clothing or jewelry. Keep hair, clothes and gloves away from the moving parts.**

Loose clothes, jewelry or long hair may get caught in moving parts.



**If you have dust extraction and recollection devices connected onto the tool, inspect their connections and use them correctly. Using these devices reduce dust-related risks.**

### Power Tools Use and Care

**Do not force the tool. Use the adequate tool for your application.**

The correct tool delivers a better and safer job at the rate for which it was designed.



**Do not use the tool if the switch is not working properly.**

Any power tool that cannot be turned ON or OFF is dangerous and should be repaired before operating.

**Disconnect the tool from the power source and / or battery before making any adjustments, changing accessories or storing.**

These measures reduce the risk of accidentally starting the tool.

**Store tools out of the reach of children. Do not allow persons that are not familiar with the tool or its instructions to operate the tool.**

Power tools are dangerous in the hands of untrained users.



**Service the tool. Check the mobile parts are not misaligned or stuck. There should not be broken parts or other conditions that may affect its operation. Repair any damage before using the tool.**

Most accidents are caused due to poor maintenance to the tools.



**Keep the cutting accessories sharp and clean.**

Cutting accessories in good working conditions are less likely to bind and are easier to control.

**Use the tool, components and accessories in accordance with these instructions and the projected way to use it for the type of tool when in adequate working conditions.**

Using the tool for applications different from those it was designed for, could result in a hazardous situation.

### Service

**Repair the tool in a TRUPER Authorized Service Center using only identical spare parts.**

This will ensure that the safety of the power tool is maintained.

# Safety warnings for the use of cordless grinders

**TRUPER**  
max

This power tool is intended to function as a cutting tool. Read all safety warnings, instructions and specifications provided. Failure to follow the instructions outlined below may result in electric shock, fire and/or serious injury.

## Choose the appropriate disc

**⚠ CAUTION** • Never use a disc that is larger in diameter than the size of the tool.

**⚠ WARNING** • Use only discs or accessories for speed of 10 000 RPM.

- The rated speed of the accessory must be at least equal to the maximum speed marked on the tool.
- Accessories running faster than their rated speed may break and come loose.

**⚠ CAUTION** • Use only discs or accessories with the bore corresponding to the tool shaft.

**⚠ CAUTION** • Use only discs or accessories specific to the material to be worked.

## Batteries and charger

**⚠ DANGER** • Use only Truper Max chargers to charge the tool battery. Using any other charger may result in fire or risk of injury.

**⚠ DANGER** • Use only batteries specifically designed for the tool. Other batteries may create a risk of injury or fire.

- Connect the charger to an alternating current (AC) supply only.

**⚠ DANGER** • Do not use the charger outdoors.

- Observe the “+/-” polarity when charging.
- Never recharge a leaking battery.
- Do not use batteries or the charger for purposes other than those for which they were designed.
- Do not modify the battery or charger contacts.
- Do not expose the battery pack or tool to fire or excessive temperatures. Exposure to fire or temperatures above 266 °F can cause an explosion.

**⚠ CAUTION** • Batteries should be kept away from any metallic object such as paper clips, coins, keys, nails, screws or any other object that could cause the terminals to make contact, and would cause a short circuit that could cause burns or fires.

**⚠ CAUTION** • Under extreme conditions, the battery liquid may leak. If so, avoid any contact. If accidental contact occurs, wash with abundant water, rinse with lemon juice and vinegar. If the liquid enters in contact with the eyes, wash with abundant water during several minutes and look for medical help immediately. The liquid expelled from the batteries could cause irradiation or burns.

**⚠ CAUTION** • To maximize battery life, fully discharge the battery at least once a month. Do not leave the battery without recharging for more than three months. Always charge the battery to its maximum capacity. Before using the machine for the first time, charge the battery to its maximum capacity.

- Avoid stopping constantly while cutting to prevent damage to the battery.

## While operating the grinder

**⚠ CAUTION** • To obtain a good result during the grinding process, the inclination between the disc and the work surface must have an angle of 15° to 30°

**⚠ DANGER** • When the disc is rotating, do not use the spindle lock to break it, as this is very dangerous and may cause injury to the user.

**⚠ CAUTION** • Do not touch the disc or workpiece immediately after grinding. Wait for them to cool before handling. Do not attempt to cool them with water or oil.

## Before operating the grinder

- Keep bystanders at a safe distance from the work area. Anyone entering the work area must wear personal protective equipment.
- Take your time to evaluate the work to be done and make sure you have observed all necessary precautions before you begin grinding.

**⚠ DANGER** • Remove any adjusting wrenches from the tool. Otherwise, they can be thrown with force causing serious injury to the operator.

**⚠ WARNING** • Check that the disc guard is in good condition and securely fastened. The tool must not be used without the guard. Fragments of workpieces or a broken accessory can break off and cause damage beyond the immediate area of operation. If you drop the power tool or an accessory, inspect for possible damage or install an accessory without damage. After inspecting and installing an accessory, standing clear and keeping bystanders away from the plane of the rotating accessory, operate the power tool at full speed without load for one minute.

**⚠ CAUTION** • Verify that the disc is not broken or cracked. Tap it lightly with a wooden hammer, the sound it makes will indicate if it is cracked.

**⚠ DANGER** • Make sure the power switch is turned off (See page 11, Power) before turning on the tool, otherwise the tool will start to operate unexpectedly, which may cause serious injury.

**⚠ CAUTION** • Turn on the tool 30 seconds before using it to detect considerable vibrations or any unusual movements. If detected, disconnect the tool and contact a **TRUPER** Authorized Service Center.

**⚠ CAUTION** • Check that the blade rotates freely.

- Do not overtighten the disc, otherwise it may break.

**⚠ WARNING** • To work on small parts, secure them with clamps or vice grips. Never use your hands for this purpose.

## While operating the grinder

- Do not use the power tool near flammable materials.

**⚠ CAUTION** • Do not turn on the tool when the disc is in contact with the workpiece.

**⚠ DANGER** • Do not use a woodworking disk saw or serrated blade. Such blades create frequent kickback and loss of control.

**⚠ WARNING** • Wear safety glasses, gloves and apron when operating the tool.

**⚠ WARNING** • Keep the cord or extension cord behind the tool to avoid accidentally damaging it with the disc. If control of the power tool is lost, the cord may be cut or entangled and the operator's arm or hand may be pulled into the rotating accessory.

**⚠ WARNING** • Never hold the tool by the power cord, hold it by the body or by the auxiliary handle.

**⚠ WARNING** • Hold the tool by the insulated gripping parts when performing operations where there is a risk that the cutting tool may contact hidden wiring. Contact with a “live” wire will cause the exposed metal parts become electrified and shock the operator.

- Never release the power tool until the accessory comes to a complete stop.
- Never strike the work surface with the disc.



### After operating the grinder

**⚠ WARNING** • Make sure the tool is switched off before checking, adjusting or changing the disc.

• Do not operate the tool while carrying it at your side.

**⚠ DANGER** • Sparks caused by grinding can be a hazard if proper measures are not taken. Ensure that they do not come into contact with skin or flammable substances.

• Gradually clean the tool vents. The motor fan directs dust into the housing and excessive accumulation of metal dust can cause an electrical hazard.

• Do not use accessories that require liquid coolants. Use of water or other liquid coolants may result in electrical shock.

### Kickback

**⚠ DANGER** Kickback (abrupt backlash) is a sudden reaction when a spinning disc, backrest, brush or any other accessory gets caught or snagged. Jamming or snagging causes rapid stalling of the rotating accessory which in turn causes the power tool to force itself in an uncontrolled manner in the opposite direction of the accessory's rotation at the point of work.

An abrasive disc jams or snags on the workpiece, of the material causing the disc to stop, creating kickback. The disc may break and fragments may jump in the direction of or away from the operator depending on the direction of disc movement at the point of binding. Kickback can occur as a result of misuse of power tools and/or improper operating procedures or unsuitable conditions and can be avoided by taking the precautions outlined below:

**a) Maintain a firm grip on the power tool, keeping your body and arm so that it can resist kickback forces. Always use the auxiliary handle; if provided, for maximum control over kickback or torque reaction of the motor during start-up.**

Torsional momentum and kickback forces can be controlled by the operator if proper precautions are taken;

**b) Never place your hand near the rotating accessory.**

The accessories can kickback on the hand;

**c) Do not place your body in the area where the power tool may move if kickback occurs.**

This propels the power tool in the opposite direction of the blade movement at the point of engagement or jamming;

**d) Take special care when working around corners, sharp edges, among others. Avoid bouncing and jamming of the accessory.**

When working around corners, sharp edges or a bounce can cause the accessory to bind and cause loss of control of the power tool or kickback of the power tool.

### Specific safety precautions for grinding operations

**a) Use only types of discs that are recommended for the power tool and the specific guard that is designed for the selected disc.**

Discs that are not designed for the power tool cannot be properly guarded and are unsafe;

**b) The grinding surface of discs with a sunken center should be installed below the plane of the guard.**

An improperly installed disc can project burrs out of the plane of the guard and cannot be adequately protected;

**c) The guard should be securely fastened to the power tool and positioned to provide maximum safety so that the least amount of the disc is exposed to the operator.**

**d) Discs should be used only for their recommended applications. For example: do not grind with the side of an abrasive cut-off disc.**

Abrasive discs are used for peripheral grinding, if lateral forces are applied, they may break.

**e) Always use flanges in perfect condition, of the correct size according to the shape of the selected disc.**

A flange with the correct characteristics supports the disc, which reduces the possibility of disc breakage. Flanges for cutting discs may be different from flanges for grinding discs.

**f) Do not use worn discs from larger or higher capacity tools.**

Discs that are designed for larger or higher capacity tools are not suitable for the increased speed that occurs in the operation of a smaller size or capacity tool and may defragment.

### Safety for abrasive cutting operations

**a) Avoid jamming or applying excessive pressure to the abrasive cut-off disc. Do not attempt to make an excessively deep cut.**

Applying excessive force to the disc increases the load on the power tool and susceptibility to deformation in the cutting zone and increases the possibility of kickback (kickback) or disc breakage.

**b) Do not position your body in line with and behind the rotating blade.**

When the blade, at the point of operation is aligned with your body, the possibility of kickback can propel the rotating blade and the power tool directly against you.

**c) When blade operation is interrupted or cutting stops for any reason, turn the power tool off and hold it stationary until the blade comes to a complete stop. Do not attempt to remove the cut-off disc while it is moving otherwise kickback or similar effect may occur.**

Investigate and take corrective action to eliminate the cause of the spinning interruption;

**d) Do not restart the cutting operation on the workpiece. Allow the disc to reach full speed off the workpiece and cautiously restart cutting.**

The abrasive cut-off disc may jam, move upward or produce kickback if cutting is restarted on the workpiece;

**e) Support large workpieces on presses or clamping supports to reduce the risk of jamming the abrasive cut-off disc or kickback.** Large workpieces tend to sink under their own weight. Supports should be placed under the workpiece close to the cutting line and close to the edge of the workpiece on both sides of the abrasive cut-off disc.

**f) Use caution when making a "very small cut" on walls or other blind areas or where there is no visibility of internal components.**

The protruding abrasive cut-off disc may cut gas or water pipes, electrical wiring or objects that can cause kickback.

# Safety warnings for the use of cordless grinders

**TRUPER**  
max

## Wrong way of operating the grinder

- Operations for which this power tool is not designed may result in an accident and cause personal injury.
- It is not recommended to use in operations such as grinding, sanding, planing, polishing with this power tool.
- Do not use accessories that are not specifically designed and recommended by the manufacturer.

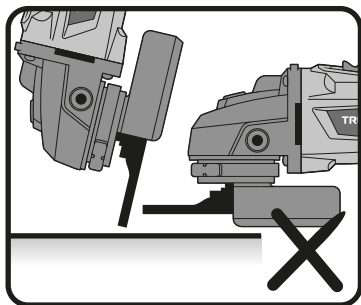

## Right way of operating the grinder

- The outside diameter and thickness of the fittings must be within the rated capacity.
- The incorrectly sized fittings cannot be adequately protected or controlled. For best results use 4 1/2" (115 mm) cut-off and/or 4 1/2" (115 mm) thickness of 1/32" - 1/4" (1 mm - 6.4 mm).

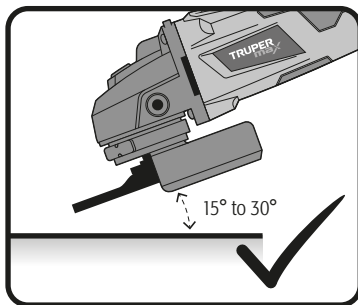

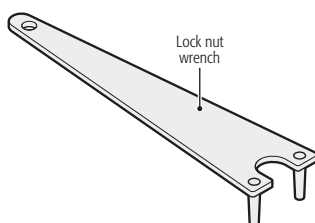
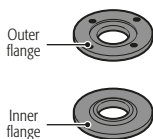
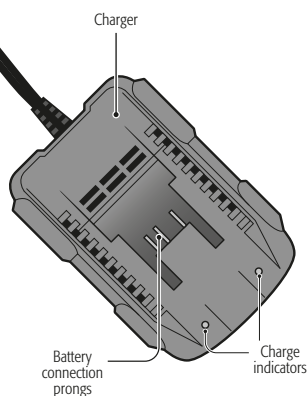
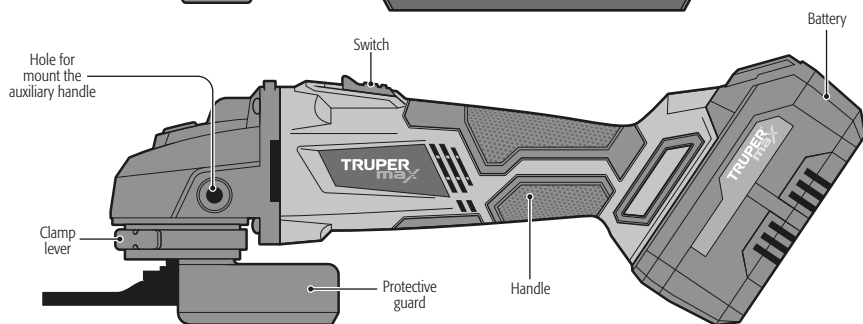
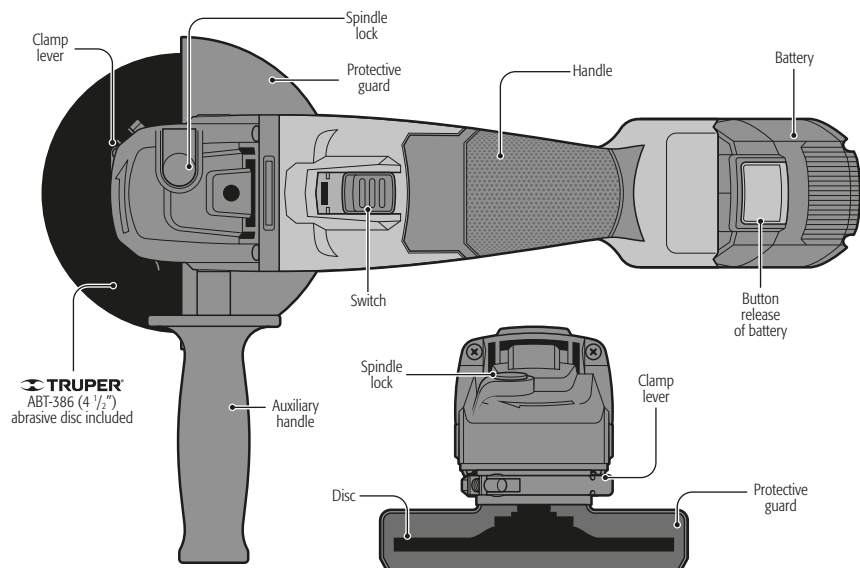

## Battery charging

1. Plug the charger plug into a 127 V~ socket.
2. The green light of the charging indicator will turn on.
3. Insert the battery into the charger by sliding it as shown in the picture. The green light will turn off and the red light should turn on, indicating that charging has started.
4. When the battery is fully charged, the green light will turn on and the red light will turn off.
5. Disconnect the charger from the power supply when charging is complete.

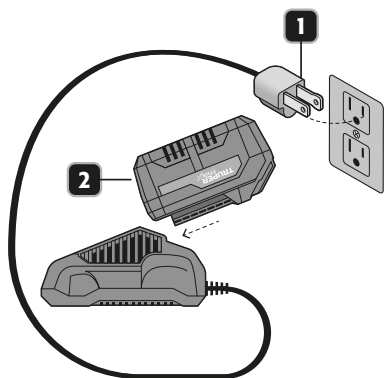

## Battery failures

- If the red light flashes, it is a sign that the battery has a delay caused by the heat; wait until the battery temperature is in the proper range to be able to charge.
- The red light remains on exceeding the recommended charging time or if the red and green light flash alternately it is a sign that the battery is defective; you must replace it or use a **TRUPER** Authorized Service Center.

## Considerations for battery use

- Longer life and better performance can be obtained if the battery unit is charged in room temperature between 41°F and 113°F. Allow a hot battery pack to cool before charging.
- The charger and battery unit may heat up slightly during the charging process. This is normal and does not represent any problem. To make it easier to cool the battery unit after use, avoid placing the charger or battery unit in a warm place, such as a metal shed or trailer without thermal insulation.
- The battery unit should be recharged when it is not able to produce enough power for jobs that were easily performed before. DO NOT CONTINUE to use it under these circumstances. Follow the charging procedure.
- The best storage place is one that is cool and dry, away from direct sunlight and excess heat or cold.
- For optimal results during extended storage times, it is recommended to store the fully charged battery unit in a cool, dry place outside the charger.

## Batteries

- Once the battery is charged, insert it into the receptacle on the back of the tool.
- Slide the battery into the receptacle until you hear a click to make sure it is properly seated.
- To remove the battery, press the latch (A) and slide the battery out.
- To make sure the battery is charged, press the indicator button (B). The color of the light indicates the charge level.

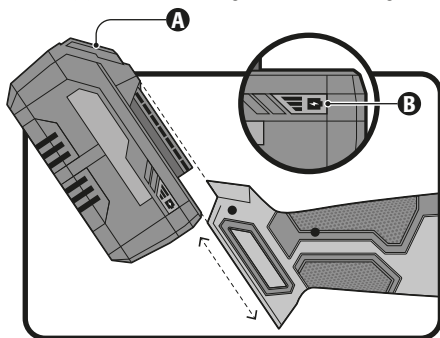

## Tool/battery protection system

**CAUTION** • The tool is equipped with a system that automatically stops the tool to prolong both its useful life and that of the batteries, this happens in the following cases:

**Overload.** When the tool is forced, the battery consumes abnormally high current levels. Suspend overexertion work and turn the tool back on.

**Overheating.** Let the tool and battery cool before turning it back on.

**Over-discharge.** The battery level is low. In this case, remove the battery from the tool and charge it.

## Remaining battery capacity

Indicator lamp	Green	51% to 100%
	Orange	
	Red	
Illuminated	Orange	26% to 50%
	Red	
	Red	10% to 25%
OFF		

**NOTE:** Depending on the conditions of use and ambient temperature, the indication may differ slightly from the actual capacity.

## Protection guard mounting

- Open the clamp lever and match the protruding parts on the inside of the guard protection, push the guard protection down until the protruding parts engage and rotate freely with the corresponding slots in the shaft cover.
- With the clamp lever open, rotate the protection guard to the desired working position.
- Secure it by pushing the clamp lever.

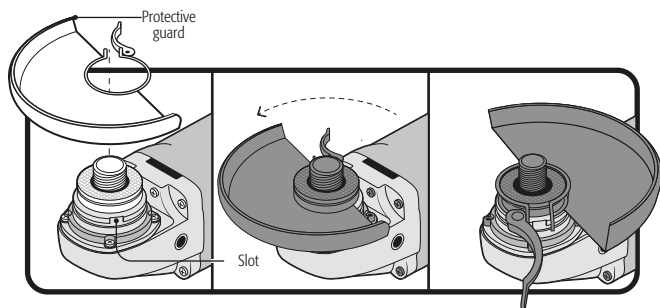

## Disc Assembly

1. Fit the inner flange onto the axis.
2. Set the disc onto the inner flange.
3. Set the outer flange onto the axis.
- Press the axis lock into the grinder head.
4. Screw the outer flange with the lock nut wrench until securely fastened.

- ⚠ DANGER** The shaft lock must only be used to change the discs. Never to stop the disc while it is rotating.
- Always use flanges in perfect condition, of the correct size according to the shape of the selected disc.
  - A flange with the correct characteristics supports the blade, which reduces the possibility of blade breakage. Flanges for cutting discs can be different from flanges for grinding discs.
  - The grinding surface of discs with a sunken center should be installed below the plane of the guard.
  - An improperly installed disk can project burrs outside the plane of the guard and cannot be properly protected.

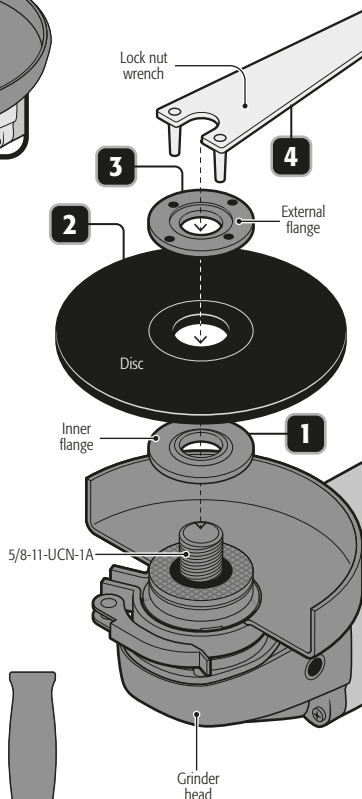

## Auxiliary handle assembly

- For safe operation use the auxiliary handle, place it in one of the three mounting holes to make your work easier.

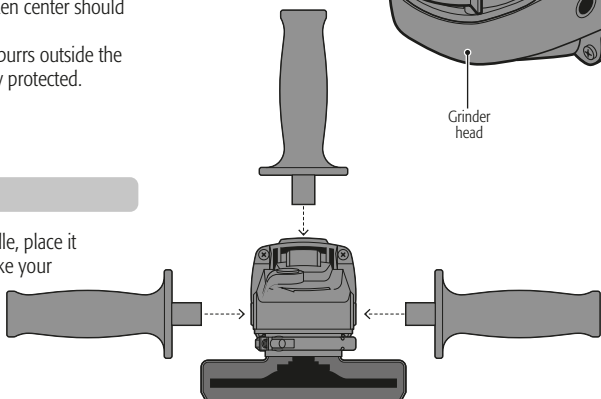

The angle grinder is a hand-held power tool, used to grind and cut steel, pipe, angle iron, brick, tile, stone and/or ceramic pieces; to remove burrs from metal surfaces, to level and smooth welds.

## Turning On

- Press the switch exactly in the pressure position **(A)**, without releasing it, direct the pressure forward **(B)** and push slightly down, release the switch so that it remains locked.
- To interrupt its operation, press on the pressure position **(A)** and then release the switch.

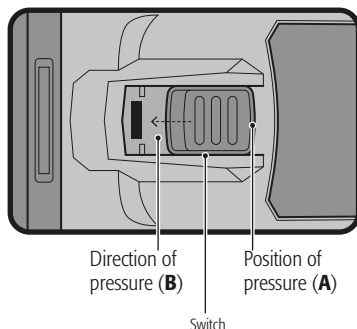

## How to hold the tool properly

Always hold the tool with both hands. One hand holding the handle and the other the auxiliary handle. Be careful not to obstruct the ventilation slots.

### • Grinding:

For best results hold the tool 15° to 30° with respect to the workpiece. Make back and forth movements with light pressure at a steady pace. This way the workpiece does not get too hot, does not discolor and does not produce sharp edges.

### • Cutting:

Do not press, tilt or oscillate the tool. Work at a moderate speed.

The blade should always rotate in the opposite direction to the cutting movement, never in the other direction, as there is a risk of the tool being thrown out of control. When cutting hard stones, it is recommended to use a diamond cutting disc.

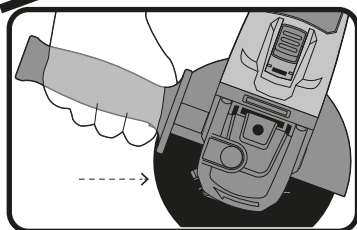
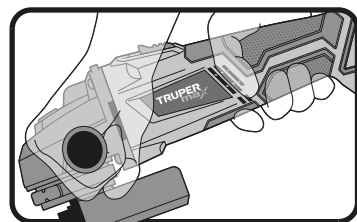

## Useful tips



- Work with the blade in the correct position to avoid damage to the blade.
- Press on the workpiece with a force less than the weight of the tool to avoid overload damage to the motor and blade.
- After installing a new blade allow the blade to rotate without working for at least one minute. If it vibrates, replace it immediately.

**⚠ CAUTION** • Avoid working with wood or soft metals such as lead. These materials saturate the disc very quickly and make it useless.

## Accidental ignition protection

- If for any reason the battery cartridge was removed from the tool with the slide switch in the "I" (on) position, the tool will not start when the battery is placed again.
- To start the tool, first slide the switch to the "O" (off) position and then slide it to the "I" (on) position.

## General maintenance

- Remember to remove the batteries from the tool before cleaning or servicing.
- All tool components are an important part of the insulation system and should only be serviced by a  **TRUPER**<sup>®</sup> Authorized Service Center.
- When servicing the tool, ALWAYS ask for  **TRUPER**<sup>®</sup> original spare parts.
- When cleaning plastic parts, avoid using solvents. Most plastic materials are susceptible to damage from various types of commercial solvents.
- To clean dirt, carbon or dust use a clean cloth or pressurized air.

 **WARNING** NEVER bring the tool into contact with brake oil, petroleum-based products, penetrating oils, etc. They contain chemicals that can damage or destroy the plastic.

 **WARNING** • When using pressurized air to clean particles ALWAYS wear safety glasses with side shields or face shield, in case of high dust ejection, also wear a dust mask.

• It is not recommended that this tool is used for extensive work on fiberglass, plasterboard, drywall or plaster materials, since its particles are highly abrasive to the components of any power tool. In case of using the tool in any of these materials it is very important that it is frequently cleaned with pressurized air to increase the useful life of the tool.



## Repairs

- Use only spare parts and accessories recommended by the manufacturer. In case the tool is not working, repairs should be done in a  **TRUPER**<sup>®</sup> Authorized Service Center.

## Storage

Neatly store the tool in a dry place and protected from dust and water.

# Environmental protection

- Electrical appliances and batteries must not be disposed of with household waste. Please deliver this appliance and its batteries with the contacts insulated with adhesive cloth to a recycling center. Check the location of the nearest center in your community.

In the event of any problem contacting a  **TRUPER**® Authorized Service Center, please see our webpage [www.truper.com](http://www.truper.com) to get an updated list, or call our toll-free numbers **800 690-6990** or **800 018-7873** to get information about the nearest Service Center.

**AGUASCALIENTES** **DE TODO PARA LA CONSTRUCCIÓN**  
GRAL. BARRAGÁN #1201, COL. GREMIAL, C.P. 20030,  
AGUASCALIENTES, AGS. TEL.: 449 994 0537

**BAJA CALIFORNIA** **SUCURSAL TIJUANA**  
AV. LA ENCANTADA, LOTE #5, PARQUE INDUSTRIAL EL  
FLORIDO II, C.P. 22244, TIJUANA, B.C.  
TEL.: 664 969 5100

**BAJA CALIFORNIA SUR** **FIX FERRETERÍAS**  
FELIPE ANGELES ESQ. RUIZ CORTÉZ S/N, COL. PUEBLO  
NUEVO, C.P. 23670, CD. CONSTITUCIÓN, B.C.S.  
TEL.: 613 132 1115

**CAMPECHE** **TORNILLERÍA Y FERRETERÍA AAA**  
AV. ALVARO OBREGÓN #324, COL. ESPERANZA  
C.P. 24080 CAMPECHE, CAMP. TEL.: 981 815 2808

**CHIAPAS** **FIX FERRETERÍAS**  
AV. CENTRAL SUR #27, COL. CENTRO, C.P. 30700,  
TAPACHULA, CHIS. TEL.: 962 118 4083

**CHIHUAHUA** **SUCURSAL CHIHUAHUA**  
AV. SILVESTRE TERRAZAS #128-11, PARQUE INDUSTRIAL  
BAFAR, CARRETERA MÉXICO CUAUHTÉMOC, C.P. 31415,  
CHIHUAHUA, CHIH. TEL.: 614 434 0052

**MEXICO CITY** **FIX FERRETERÍAS**  
EL MONSTRUO DE CORREGIDORA, CORREGIDORA # 35,  
COL. CENTRO, C.P. 06060, CUAUHTÉMOC, CDMX.  
TEL.: 55 5522 5031 / 5522 4861

**COAHUILA** **SUCURSAL TORREÓN**  
CALLE METAL MECÁNICA #280, PARQUE INDUSTRIAL  
ORIENTE, C.P. 27278, TORREÓN, COAH.  
TEL.: 871 209 68 23

**COLIMA** **BOMBAS Y MOTORES BYMATES DE MANZANILLO**  
BLVD. MIGUEL DE LA MADRID #190, COL. 16 DE  
SEPTIEMBRE, C.P. 28239, MANZANILLO, COL.  
TEL.: 314 332 1986 / 332 8013

**DURANGO** **TORNILLOS ÁGUILA, S.A. DE C.V.**  
MAZURIO #200, COL. LUIS ECHEVERRÍA, DURANGO,  
DGO. TEL.: 618 817 1946 / 618 818 2844

**ESTADO DE MÉXICO** **SUCURSAL CENTRO JILOTEPEC**  
PARQUE INDUSTRIAL # 1, COL. PARQUE INDUSTRIAL  
JILOTEPEC, JILOTEPEC, EDO. DE MÉX. C.P. 54257  
TEL.: 761 782 9101 EXT. 5728 Y 5102

**GUANAJUATO** **CÍA. FERRETERA NUEVO MUNDO S.A. DE C.V.**  
AV. MÉXICO - JAPÓN #225, CD. INDUSTRIAL, C.P. 38010,  
CELAYA, GTO. TEL.: 461 617 7578 / 79 / 80 / 88

**GUERRERO** **CENTRO DE SERVICIO ECLIPSE**  
CALLE PRINCIPAL MZ.1 LT. 1, COL. SANTA FE, C.P. 39010,  
CHILPANCIÑO, GRO. TEL.: 747 478 5793

**HIDALGO** **FERREPRECIOS S.A. DE C.V.**  
LIBERTAD ORIENTE #304 LOCAL 30, INTERIOR DE PASAJE  
ROBLEDO, COL. CENTRO, C.P. 43600, TULANCINGO,  
HGO. TEL.: 775 753 6615 / 775 753 6616

**JALISCO** **SUCURSAL GUADALAJARA**  
AV. ADOLFO B. HORN # 6800, COL. SANTA CRUZ DEL  
VALLE, C.P.: 45655, TLAJOMULCO DE ZUÑIGA, JAL.  
TEL.: 33 3606 5285 AL 90

**MICHOACÁN** **FIX FERRETERÍAS**  
AV. PASEO DE LA REPÚBLICA #3140-A, COL.  
EX-HACIENDA DE LA HUERTA, C.P. 58050, MORELIA,  
MICH. TEL.: 443 334 6858

**MORELOS** **FIX FERRETERÍAS**  
CAPITÁN ANZURES #95, ESQ. JOSÉ PERDIZ, COL.  
CENTRO, C.P. 62740, CUAUTLA, MOR.  
TEL.: 735 352 8951

**NAYARIT** **HERRAMIENTAS DE TEPEC**  
MAZATLAN #117, COL. CENTRO, C.P. 63000, TEPEC, NAY.  
TEL.: 311 258 0540

**NUEVO LEÓN** **SUCURSAL MONTERREY**  
CARRETERA LAREDO #300, 1B MONTERREY PARKS,  
COLONIA PUERTA DE ANAHUAC, C.P. 66052, ESCOBEDO,  
NUEVO LEÓN, TEL.: 81 8352 8791 / 81 8352 8790

**OAXACA** **FIX FERRETERÍAS**  
AV. 20 DE NOVIEMBRE #910, COL. CENTRO, C.P. 68300,  
TUXTEPEC, OAX. TEL.: 287 106 3092

**PUEBLA** **SUCURSAL PUEBLA**  
AV. PERIFÉRICO #2-2, SAN LORENZO ALMECATLA,  
C.P. 72710, CUAUHTLACINGO, PUE.  
TEL.: 222 282 8282 / 84 / 85 / 86

**QUERÉTARO** **ARU HERRAMIENTAS S.A. DE C.V.**  
AV. PUERTO DE VERACRUZ #110, COL. RANCHO DE  
ENMEDIO, C.P. 76842, SAN JUAN DEL RÍO, QRO.  
TEL.: 427 268 4544

**QUINTANA ROO** **FIX FERRETERÍAS**  
CARRETERA FEDERAL MZ. 46 LT. 3 LOCAL 2, COL. EJIDAL,  
C.P. 77710 PLAYA DEL CARMEN, Q.R.  
TEL.: 984 267 3140

**SAN LUIS POTOSÍ** **FIX FERRETERÍAS**  
AV. UNIVERSIDAD #1850, COL. EL PASEO, C.P. 78320,  
SAN LUIS POTOSÍ, S.L.P. TEL.: 444 822 4341

**SINALOA** **SUCURSAL CULIACÁN**  
AV. JESÚS KUMATE SUR #4301, COL. HACIENDA DE LA  
MORA, C.P. 80143, CULIACÁN, SIN.  
TEL.: 667 173 9139 / 173 8400

**SONORA** **FIX FERRETERÍAS**  
CALLE 5 DE FEBRERO #517, SUR LT. 25 MZ. 10, COL.  
CENTRO, C.P. 85000, CD. OBREGÓN, SON.  
TEL.: 644 413 2392

**TABASCO** **SUCURSAL VILLAHERMOSA**  
CALLE HELIO LOTES 1, 2 Y 3 MZ. #1, COL. INDUSTRIAL,  
2A ETAPA, C.P. 86010, VILLAHERMOSA, TAB.  
TEL.: 993 353 7444

**TAMAULIPAS** **VM ORINGS Y REFACCIONES**  
CALLE ROSITA #527 ENTRE 20 DE NOVIEMBRE Y GRAL.  
RODRÍGUEZ, FRACC. REYNOSA, C.P. 88780, REYNOSA,  
TAMS. TEL.: 899 926 7552

**TLAXCALA** **SERVICIOS Y HERRAMIENTAS INDUSTRIALES**  
PABLO SIDAR #132, COL. BARRIO DE SAN BARTOLOMÉ,  
C.P. 90970, SAN PABLO DEL MONTE, TLAX.  
TEL.: 222 271 7502

**VERACRUZ** **LA CASA DISTRIBUIDORA TRUPER**  
BLVD. PRIMAVERA ESQ. HORTENSIA S/N, COL.  
PRIMAVERA C.P. 93308, POZA RICA, VER.  
TEL.: 782 823 8100 / 826 8484

**YUCATÁN** **SUCURSAL MÉRIDA**  
CALLE 33 #600 Y 602, LOCALIDAD ITZINCAB Y MULSAV,  
MPIO. UMAN, C.P. 97390, MÉRIDA, YUC.  
TEL.: 999 912 2451

Code	Model	Brand
102449	MAX-20E	TRUPER max

Warranty. Duration: 5 year. Coverage: parts, components and workmanship against manufacturing or operating defects, except if used under conditions other than normal; when it was not operated in accordance with the instructive; was altered or repaired by personnel not authorized by TRUPER®. To make the warranty valid, only present the product in the establishment where you bought it or in Corregidora 35, Centro, Cuauhtémoc, CDMX, 06060, where you can also purchase parts, components, consumables and accessories. The costs of transportation of the product that derive from its fulfillment of its service network are included. TRUPER will not require any proof of purchase to make the warranty effective. Phone number 800-018-7873. Made in China. Imported by TRUPER, S.A. de C.V. Parque Industrial 1, Parque Industrial Jilotepec, Jilotepec, Edo. de Méx. C.P. 54257, Phone number 761 782 9100.

Stamp of the business. Delivery date:

