

ENGLISH
ESPAÑOL

TRUPER[®] INDUSTRIAL

Manual

Electric hand planer

5.6 A

Motor

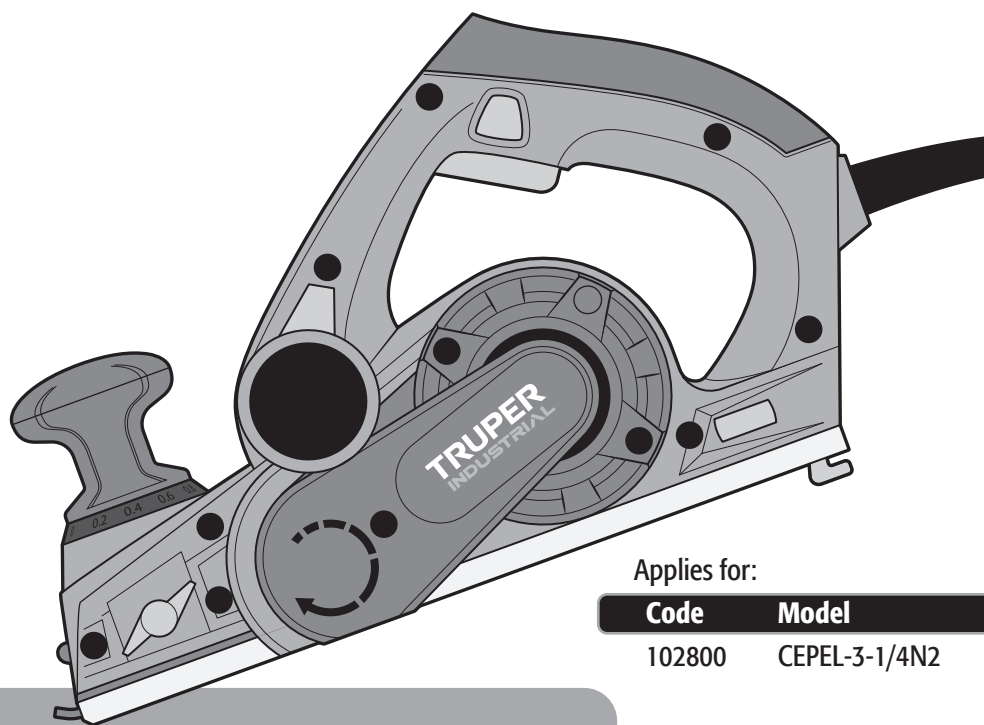

Applies for:

Code	Model
102800	CEPEL-3-1/4N2

CEPEL-3-1/4N2

CAUTION





Read the user's manual thoroughly
before operating this tool.



Technical data 3

Power requirements 3

 General power tool safety warnings 4

 Safety warnings for electric planers 5

Parts 6

Preparation 7

Startup 10

Maintenance 11

Authorized service centers 13

Warranty policy 14

 **CAUTION**

To gain the best performance of the tool, prolong the duty life, make the Warranty valid if necessary, and to avoid hazards of fatal injuries please read and understand this Manual before using the tool.

Keep this manual for future references.

The illustrations in this manual are for reference only. They might be different from the real tool.

Use and maintenance recommendations



RESPECT THE WORK CYCLES.

50 minutes of work per 20 minutes of rest. Maximum 6 hours daily.



AVOID using the cord to move, lift or disconnect the tool.



DO NOT TURN ON the tool with the cutting blades resting on the workpiece, as it could cause kickback.



DO NOT press the lock button while the disc is in motion.



To **EXTEND** the life of your tool, use compressed air (blow) to clean it after each use.



Keep the tool's ventilation slots **CLEAN**.



Perform regular **MAINTENANCE** on your machine (pages 11 & 12).

CEPEL-3-1/4N2

Code	•	102800
Description	•	Electric hand planer
Voltage	•	127 V~
Frequency	•	60 Hz
Current	•	5.6 A
Power	•	720 W
Speed	•	19 000 RPM
Cuts per minute	•	38 000 cuts/min
Depth levels	•	10 levels, 0.007" each one
Planing	•	Cutting depth: 0" - 0.07" Planing width: 3 1/4"
Dust collecting system	•	left-right
Duty cycle	•	50 minutes of work per 20 minutes of rest. Maximum 6 hours daily.
Conductors	•	18 AWG x 2C with 221°F insulating temperature.
Insulation	•	Class II
IP Grade	•	IP20

Power cord grips used in this product: Type "Y".
Build quality: Reinforced insulation.
Thermal insulation on motor winding: Class A

⚠ WARNING Avoid the risk of electric shock or severe injury. When the power cable gets damaged it should only be replaced by the manufacturer or at a Truper Authorized Service Center.
The build quality of the electric insulation is altered if spills or liquid gets into the tool while in use.
Do not expose to rain, liquids and/or dampness.

⚠ WARNING Before gaining access to the terminals all power sources should be disconnected.



Power requirements

⚠ WARNING Tools with double insulation and reinforced insulation are equipped with a polarized plug (one prong is wider than the other). This plug will only fit in the right way into a polarized outlet. If the plug cannot be introduced into the outlet, reverse the plug. If it still doesn't fit, call a qualified electrician to install for you a polarized outlet. Do not alter the plug in any way. Both types of insulation eliminate the need of both a grounded third power cord with three prongs or a grounded power connection.

⚠ WARNING When using an extension cable, verify the gauge is enough for the power that your product needs. A lower gauge cable will cause voltage drop in the line, resulting in power loss and overheating. The following table shows the right size to use depending on cable's length and the ampere capability shown in the tool's nameplate. When in doubt use the next higher gauge.

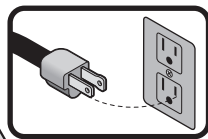

Ampere capacity	Number of conductors	Extension gauge	
		From 6 ft to 49 ft	Higher than 49 ft
From 0 A and up to 10 A	3 (one grounded)	18 AWG (*)	16 AWG
From 10 A and up to 13 A		16 AWG	14 AWG
From 13 A and up to 15 A		14 AWG	12 AWG
From 15 A and up to 20 A		8 AWG	6 AWG

* It is safe to use only if the extensions have a built-in artifact for over current protection.
AWG = American Wire Gauge - Reference NMX-J-195-ANCE

⚠ WARNING When operating power tools outdoors, use a **volteck** grounded extension cable labeled "For Outdoors Use". These extensions are especially designed for operating outdoors and reduce the risk of electric shock.





General power tool safety warnings



⚠ WARNING! Read carefully all safety warnings and instruction listed below. Failure to comply with any of these warnings may result in electric shock, fire and / or severe damage. **Save all warnings and instructions for future references.**

Work area

Keep your work area clean, and well lit.

Cluttered and dark areas may cause accidents.



Never use the tool in explosive atmospheres, such as in the presence of flammable liquids, gases or dust.

Sparks generated by power tools may ignite the flammable material.



Keep children and bystanders at a safe distance while operating the tool.

Distractions may cause losing control.



Electrical safety

The tool plug must match the power outlet. Never modify the plug in any way. Do not use any adapter plugs with grounded power tools.

Modified plugs and different power outlets increase the risk of electric shock.



Avoid body contact with grounded surfaces, such as pipes, radiators, electric ranges and refrigerators.

The risk of electric shock increases if your body is grounded.

Do not expose the tool to rain or wet conditions.

Water entering into the tool increases the risk of electric shock.

Do not force the cord. Never use the cord to carry, lift or unplug the tool. Keep the cord away from heat, oil, sharp edges or moving parts.

Damaged or entangled cords increase the risk of electric shock.

When operating a tool outdoors, use an extension cord suitable for outdoor use.

Using an adequate outdoor extension cord reduces the risk of electric shock.

If operating the tool in a damp location cannot be avoided, use a ground fault circuit interrupter (GFCI) protected supply.

Using a GFCI reduces the risk of electric shock.

Personal safety

Stay alert, watch what you are doing and use common sense when operating a tool. Do not use a power tool while you are tired or under the influence of drugs, alcohol or medication.

A moment of distraction while operating the tool may result in personal injury.

Use personal protective equipment. Always wear eye protection.

Protective equipment such as safety glasses, anti-dust mask, non-skid shoes, hard hats and hearing protection used in the right conditions significantly reduce personal injury.



Prevent unintentional starting up. Ensure the switch is in the "OFF" position before connecting into the power source and / or battery as well as when carrying the tool.

Transporting power tools with the finger on the switch or connecting power tools with the switch in the "ON" position may cause accidents.

Remove any wrench or vice before turning the power tool on.

Wrenches or vices left attached to rotating parts of the tool may result in personal injury.

Do not overreach. Keep proper footing and balance at all times.

This enables a better control on the tool during unexpected situations.

Dress properly. Do not wear loose clothing or jewelry. Keep hair, clothes and gloves away from the moving parts.

Loose clothes, jewelry or long hair may get caught in moving parts.



If you have dust extraction and recollection devices connected onto the tool, inspect their connections and use them correctly. Using these devices reduce dust-related risks.

Power tools use and care

Do not force the tool. Use the adequate tool for your application.

The correct tool delivers a better and safer job at the rate for which it was designed.



Do not use the tool if the switch is not working properly.

Any power tool that cannot be turned ON or OFF is dangerous and should be repaired before operating.

Disconnect the tool from the power source and / or battery before making any adjustments, changing accessories or storing.

These measures reduce the risk of accidentally starting the tool.

Store tools out of the reach of children. Do not allow persons that are not familiar with the tool or its instructions to operate the tool.

Power tools are dangerous in the hands of untrained users.



Service the tool. Check the mobile parts are not misaligned or stuck. There should not be broken parts or other conditions that may affect its operation. Repair any damage before using the tool.

Most accidents are caused due to poor maintenance to the tools.



Keep the cutting accessories sharp and clean.

Cutting accessories in good working conditions are less likely to bind and are easier to control.

Use the tool, components and accessories in accordance with these instructions and the projected way to use it for the type of tool when in adequate working conditions.

Using the tool for applications different from those it was designed for, could result in a hazardous situation.

Service

Repair the tool in a TRUPER Authorized Service Center using only identical spare parts.

This will ensure that the safety of the power tool is maintained.



This tool is in compliance with the Official Mexican Standard (NOM - Norma Oficial Mexicana).

Safety warnings for electric planers

TRUPER
INDUSTRIAL

Before operating the tool

- Unroll completely the extension cord to prevent potential overheating.

- Double check the power outlet voltage matches the rated voltage described in the tool nameplate. ⚡

⚠ CAUTION • Remove from the workplace all the rags, clothes, cables, ropes or any object that could get caught in the tool's blades.

⚠ WARNING • Remove nails, screws or any object from the workpiece. These materials would damage the blades and the tool and represent a risk for your safety.

⚠ CAUTION • Before starting any job, double check the blades fixing screws are perfectly tight.

- Before operating the tool, turn it ON and let it run for a few moments. Check if there are vibrations indicating a poor setting or an unbalanced blade.

While operating the tool

- When possible, use a dust extraction system.

⚠ CAUTION • When operating the tool, hold it only by the handle and the insulated parts. In the event of making contact with a hidden cable in the tool, the exposed metallic parts may pass a discharge to the operator.

- Hold the tool firmly using both hands.

⚠ DANGER • Keep your hands away from the rotating parts.

⚠ CAUTION • Double check the blades are not making contact with the work piece when turning ON the machine.

- Before cutting, wait until the blades reach the maximum speed.

- Work with the machine setting it at least 8" away from your face and body.

⚠ CAUTION • Never leave the tool running with no supervision. Handle the tool only when you can control it with both hands. Turn it OFF before leaving it aside.

- After long periods of functioning, the tool metallic parts may be very hot.

After operating the tool

- When finishing operating the tool, turn it OFF and activate the rest support turning it downwards on top of a wood block, so that the blades are not making contact with any type of materials.

- Before trying to carry out adjustments, turn the machine OFF and wait for the blades to stop completely.

⚠ DANGER • Never put your finger into the shavings discharge orifice. To remove excess of shavings, turn OFF and disconnect the tool. Use a stick to remove the shavings.

- When necessary, replace both blades at the same time. Otherwise, the resulting imbalance will cause vibrations and will shorten the useful life of the blades and the tool. Handle blades with extreme caution!

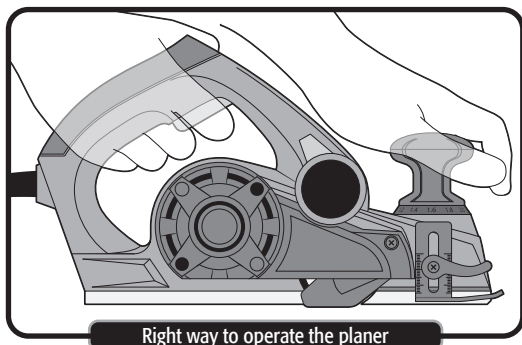

Right way to operate the planer

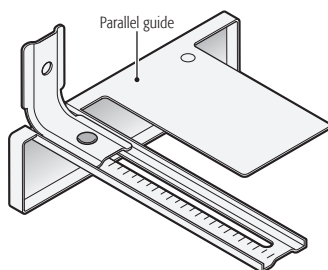
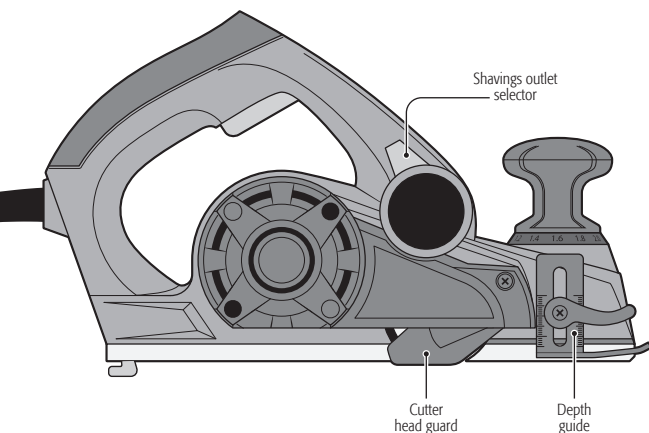
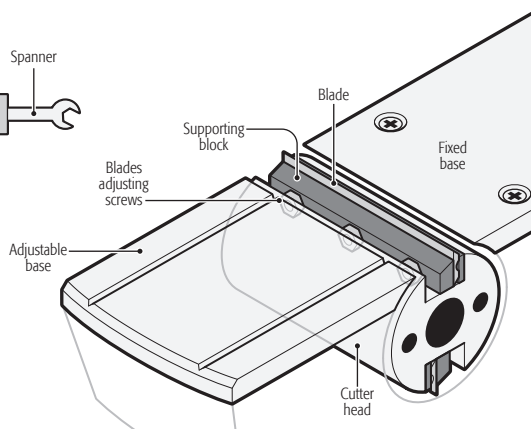
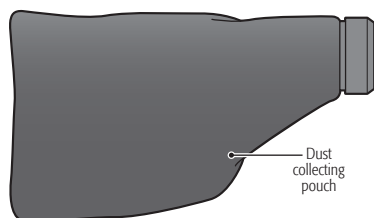
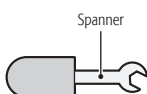
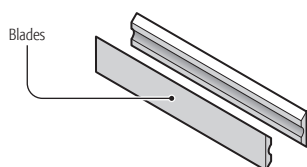
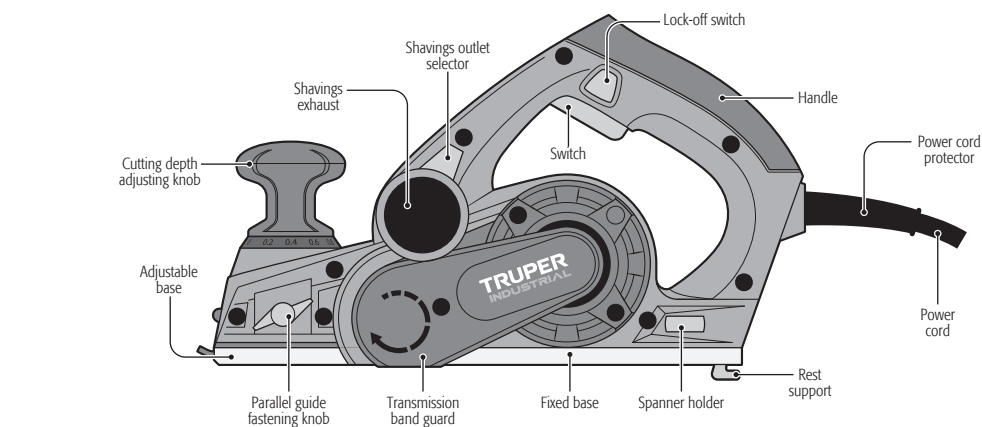

Blades set up

The blades must be adjusted so that the cutting edge is level with the fixed base. (See "Blade leveling" below).

⚠ ATTENTION

- Always make sure the tool is turned off and unplugged before making any adjustments to it.
- Firmly and carefully tighten the screws that fix the blades to the tool. A loose screw can be dangerous.
- Handle the blades carefully, wear safety gloves when mounting or removing the blades to protect your hands.
- Use only the included wrench to tighten or loosen the screws. Failure to do so could result in over- or under-tightening and cause accidents.

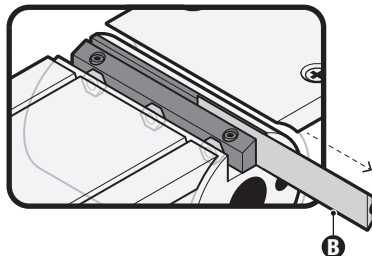
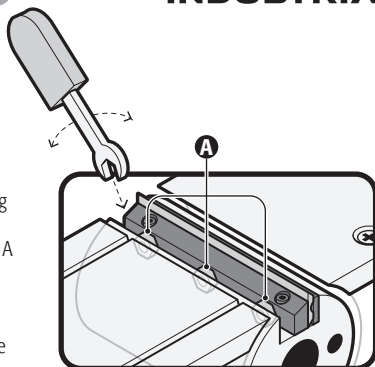

Removing the planer blades

- To reverse or replace the planer blades, rotate the cutter head until the support block is parallel to planer base.
- To remove the worn blades, loosen the three bolts that secure the blades in place (A) with the included 8 mm wrench, turning them counter clockwise.
- Slide the worn knife (B) out of the cutter head. You can use a piece of wood to do this.
- The knives are sharpened on both sides. Turn the knife around to reinstall it. If you have already done this then you will need to replace the knife.

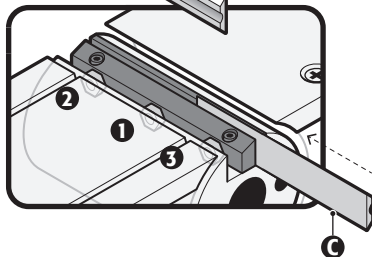
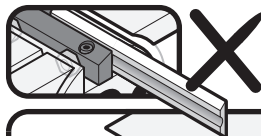

Assembly of the blades

- With the worn blade out, slide the new blade (C) through the block and align the blades to the width of the block. The blade groove should point towards the fixed base of the tool. Tighten evenly the three adjustment screws in the tightening order (1 / 2 / 3). Repeat the operation with the other blade.

⚠ ATTENTION Before turning the tool on, check that adjustment screws are tighten. Turn the cutting head by hand and make sure the planer blade does not touch any part of the tool.

Blades leveling

The blades must be adjusted to the height of the base **(D)**. If this is not the case, follow the instructions below:

- Slightly loosen the adjusting screws **(A)** with the 8 mm wrench.
- With the aid of a 2.5 mm hexagonal wrench, turn the height control screws **(E)** clockwise to go up, and counterclockwise to go down, as required by the planner.
- Level the height by resting a set square **(F)** on the fixed base and the adjustable base (set to 0).
- Finally, tighten the adjusting screws with the 8 mm wrench.

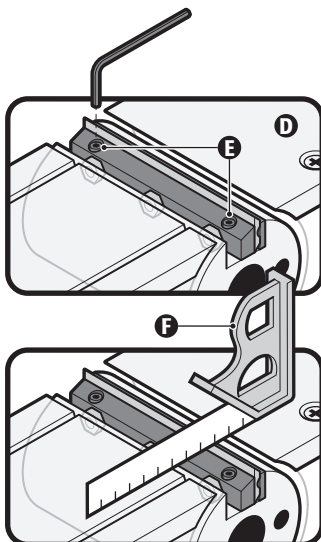

Replacement of jaws

- 1:** The blades must be adjusted so that the cutting edge is level with the fixed base see "Blade leveling".
- 2:** Remove the blade holder displacing it to the right **(G)**.
- 3:** Assemble the fastener to the blade holder to ensure the double pins have a coincidence **(H)**.
- 4:** Place the blade holder assembly inside the tool **(I)**.
- 5:** Insert the blade from right to left inside the blade holder, ensuring the blade is smooth in the guides.
- 6:** Align the blades following the steps in the "Blade Leveling" section.

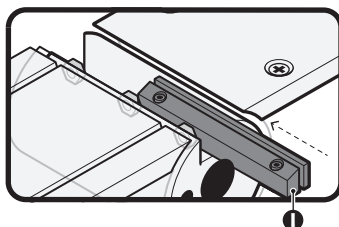
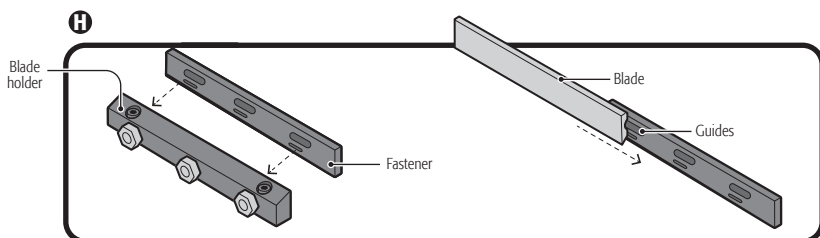
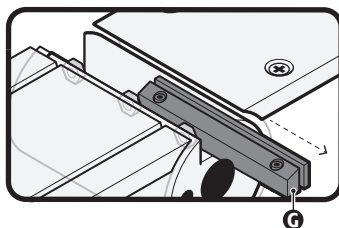

Parallel guide set up

- Install the parallel guide on the opposite side of the depth guide (1).
- The parallel guide is secured in place with a clamping knob (2).

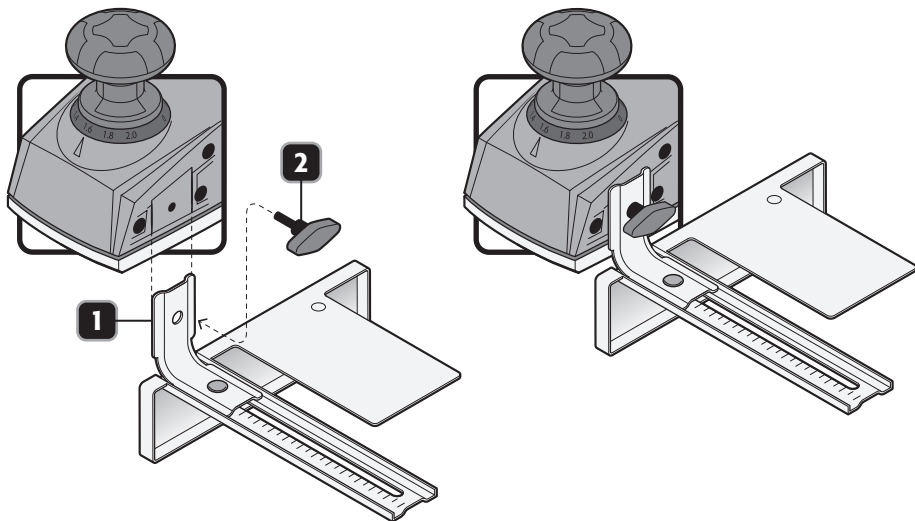

Dust collection bag installation

- Attach the dust bag to the chip ejector port, push it all the way into the port so it is secure.
- When the dust bag is half full, remove it from the tool and pull the closure. Empty the dust collection bag and lightly tap it to remove particles stuck inside.
- Connecting a vacuum to this tool may result in more efficient performance and cleaner operation.

Installing a vacuum

- For more efficient performance and cleaner operation, you can connect a vacuum to the chip ejector port instead of the dust bag.
- Connect the vacuum hose to the nozzle as shown in the image.
- The port is not compatible with Truper line vacuum cleaners.

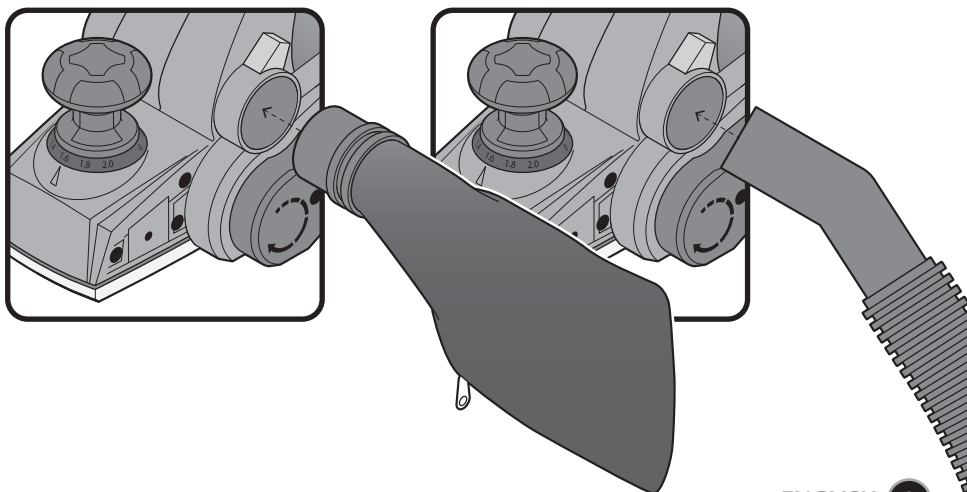

Start and operation control

- Connect the plug into the power outlet.
- Keep the lock-off switch **(B)** pressed to unlock the switch **(A)**. The lock-off switch prevents from accidentally starting up the tool.
- Press the switch **(A)** to start the cutter head in motion.
- To stop the cutter head, release the switch **(A)**.

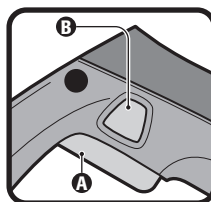

Cutting depth adjustment

- Turn the cutting depth adjusting knob and match the measurement in millimeters indicated in the knob graded ring with the triangular mark so that the adjustable base is set in the desired height.
- To determine precise cutting depths, plan a piece of scrap wood, measure the thickness difference and if necessary, adjust to the needed value.

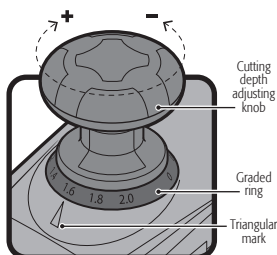

Shavings removal

- Turn the shavings outlet dial so that the arrow points towards the planer side where you want shavings to be expelled.
- You can connect the dust collecting pouch to the selected shavings exhaust to facilitate disposal.
- You can also connect a workshop dust extracting system or a household vacuum cleaner into the exhaust. This will make a safer and cleaner work place.

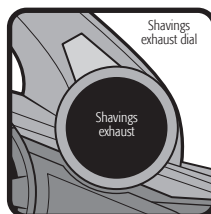

Planing

- Set the adjustable base onto the work piece surface. The blades should not make contact with the piece (figure 1).
- Start the tool and wait for the blades to reach the maximum speed.
- Holding the tool with both hands, run it smoothly applying pressure in the front on the depth adjusting knob **(2)**. The job will be easier if the work piece is slightly tilted to allow a downwards planing.
- Push the tool beyond the work piece but not leaning downwards **(3)**.
- The planing speed and cutting depth determine the finish quality. To get a rough cut increase the cutting depth. To get a fine finish diminish the cutting depth and push the tool slower.

CAUTION An extremely fast pass of the tool may produce bad quality cuts and will damage the blades or the motor. If the movement is too slow, you may burn or damage the cut.

The right advancing speed will be dependent of the type of material being cut and the planing depth. Before planing the work piece, make some tests using a piece of scrap wood to gauge the right speed and the dimensions of the cut.

WARNING Secure the work piece using clamps to prevent accidents and defects in the cut.

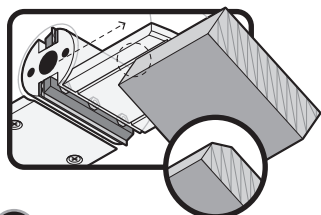
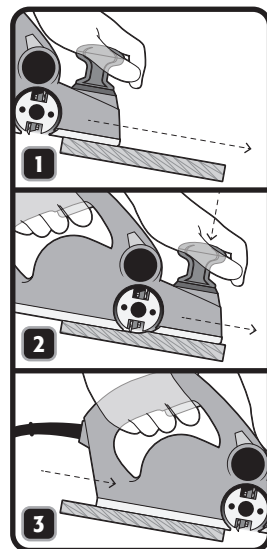

Bevel cuts

- For bevel cuts or chamfers, match the work piece edge with one of the two notches in the adjustable base.
- Make passes with the planer aligning the notch on the corner edge.

Staggered cuts

- To make staggered cuts, assemble the parallel guide on the planer as indicated in the "Assembly" section.
- Raise or lower the depth guide so that it is at the height of the step to be made. The triangular mark **(A)** will indicate the step height in millimeters and inches.
- Run the arm of the parallel guide until the marks **(B)** match the measurement with the width measurement of the cut to be made. The scale on the guide is in millimeters and inches.
- Once the position of both guides has been defined, tighten all the knobs to avoid misalignment during the cut.
- Adjust the depth of the planer (See. Depth of cut adjustment). It is recommended to cut small amounts of material.
- Perform the cut by exerting lateral pressure against the face of the workpiece. Otherwise, you will get an uneven result.

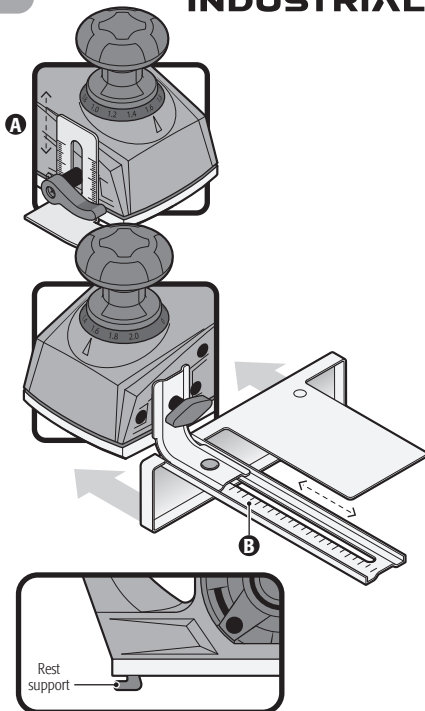

Foot stand

- After performing a cutting operation, lift the back of the tool to display the foot stand under the level of the fixed base.
- This prevents damage to the blades of the tool.

Maintenance

⚠ WARNING Disconnect the cable from the power outlet before carrying out any adjustment, service or maintenance to the tool.

Cleaning and care

- Keep the tool dust-free. Never use water or chemical substances to clean the tool. Clean the machine with compressed air after each use.
- Always keep the ventilation slots clean and free of obstructions to guarantee the adequate cooling of the motor.
- Inspect regularly all the mounting screws. Make sure that are tightly fastened. If a screw is loose, tighten immediately.
- The armature and motor are the power tool's heart. Use extreme care not to affect the tool with oil or water.
- In a regular basis, double-check the power cable. Look for any type of damage. If the cable is damaged take it to a TRUPER Authorized Service Center.

Carbon brush replacement



- Carbon Brushes should be periodically checked and when worn, replaced always in a TRUPER Authorized Service Center.
- After replacing the carbon brushes request to inspect if the new carbon brushes can move freely in the carbon housing. Also request to run the tool 5 minutes to make even the contact with the carbon brushes and the commutator.
- Use only original TRUPER spare carbon brushes specifically designed with the hardness and resistance adequate for each type of motor. Carbons that are out of specification could damage the motor.
- When replacing carbon brushes, always replace both.

Service

Servicing the tool shall only be carried out in a TRUPER Authorized Service Center.

Service and maintenance carried out by non-qualified people may be dangerous and may cause personal injuries. It also makes the Warranty void.

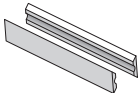
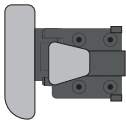
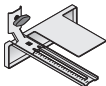
Replacements

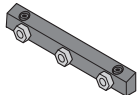
Replacement	Code	Item
 <p>Tungsten carbide blades (2 pieces)</p>	100649	CU-CE-3-1/4
 <p>Switch</p>	101264	INT-CE-N
 <p>Parallel guide</p>	101290	GUIA-CE-3-1/4N
 <p>Dust collecting pouch</p>	101291	BOL-CE-3-1/4N
 <p>Replacement belt</p>	101266	BAN-CE-3-1/4N
 <p>Blade holder set</p>	101267	JGO-CE-3-1/4N

In the event of any problem contacting a TRUPER Authorized Service Center, please see our webpage WWW.TRUPER.COM to get an updated list, or call our toll-free numbers 800 690-6990 or 800-018-7873 to get information about the nearest Service Center.

AGUASCALIENTES **DE TODO PARA LA CONSTRUCCIÓN**
GRAL. BARRAGÁN #1201, COL. GREMIAL, C.P. 20030,
AGUASCALIENTES, AGS. TEL.: 449 994 0537

BAJA CALIFORNIA **SUCURSAL TIJUANA**
AV. LA ENCANITADA, LOTE #5, PARQUE INDUSTRIAL EL
FLORIDO II, C.P. 2244, TIJUANA, B.C.
TEL.: 664 969 5100

BAJA CALIFORNIA SUR **FIX FERRETERÍAS**
FELIPE ÁNGELES ESQ. RUIZ CORTÍNEZ S/N, COL. PUEBLO
NUOVO, C.P. 23670, CD. CONSTITUCIÓN, B.C.S.
TEL.: 613 132 1115

CAMPECHE **TORNILLERÍA Y FERRETERÍA AAA**
AV. ÁLVARO OBREGÓN #324, COL. ESPERANZA
C.P. 24080 CAMPECHE, CAMP. TEL.: 981 815 2808

CHIAPAS **FIX FERRETERÍAS**
AV. CENTRAL SUR #27, COL. CENTRO, C.P. 30700,
TAPACHULA, CHIS. TEL.: 962 118 4083

CHIHUAHUA **SUCURSAL CHIHUAHUA**
AV. SILVESTRE TERRAZAS #128-11, PARQUE INDUSTRIAL
BAFAR, CARRETERA MÉXICO CUAUHTÉMOC, C.P. 31415,
CHIHUAHUA, CHIH. TEL.: 614 434 0052

CIUDAD DE MÉXICO **FIX FERRETERÍAS**
EL MONSTRUO DE CORREGIDORA, CORREGIDORA #35,
COL. CENTRO, C.P. 06060, CUAUHTÉMOC, CDMX.
TEL.: 55 5522 5031 / 5522 4861

COAHUILA **SUCURSAL TORREÓN**
CALLE METAL MECÁNICA #280, PARQUE INDUSTRIAL
ORIENTE, C.P. 27278, TORREÓN, COAH.
TEL.: 871 209 68 23

COLIMA **BOMBAS Y MOTORES BYMTESSA DE MANZANILLO**
BLVD. MIGUEL DE LA MADRID #190, COL. 16 DE
SEPTIEMBRE, C.P. 28239, MANZANILLO, COL.
TEL.: 314 352 1986 / 352 8013

DURANGO **TORNILLOS ÁGUILA, S.A. DE C.V.**
MAZURIO #200, COL. LUIS ECHEVERRÍA, DURANGO,
DGO. TEL.: 618 817 1946 / 618 818 2844

ESTADO DE MÉXICO **SUCURSAL CENTRO JILOTEPEC**
PARQUE INDUSTRIAL #1, COL. PARQUE INDUSTRIAL
JILOTEPEC, JILOTEPEC, EDO. DE MÉX. C.P. 54257
TEL.: 761 782 9101 EXT. 5728 Y 5102

GUANAJUATO **CÍA. FERRETERA NUEVO MUNDO S.A. DE C.V.**
AV. MÉXICO - JAPÓN #225, CD. INDUSTRIAL, C.P. 38010,
CELAYA, GTO. TEL.: 461 617 7578 / 79 / 80 / 88

GUERRERO **CENTRO DE SERVICIO ECLIPSE**
CALLE PRINCIPAL MZ.1 LT. 1, COL. SANTA FE, C.P. 39010,
CHILPANCIÑO, GRO. TEL.: 747 478 5793

HIDALGO **FERREPRECIOS S.A. DE C.V.**
LIBERTAD ORIENTE #304 LOCAL 30, INTERIOR DE PASAJE
ROBLEDO, COL. CENTRO, C.P. 43600, TULANCINGO,
HGO. TEL.: 775 753 6615 / 775 753 6616

JALISCO **SUCURSAL GUADALAJARA**
AV. ADOLFO B. HORN # 6800, COL. SANTA CRUZ DEL
VALLE, C.P.: 45655, TLAJOMULCO DE ZUÑIGA, JAL.
TEL.: 33 3606 5285 AL 90

MICHOACÁN **FIX FERRETERÍAS**
AV. PASEO DE LA REPÚBLICA #3140-A, COL.
EX-HACIENDA DE LA HUERTA, C.P. 58050, MORELIA,
MICH. TEL.: 443 334 6858

MORELOS **FIX FERRETERÍAS**
CAPITÁN ANZURES #95, ESQ. JOSÉ PERDIZ, COL. CENTRO,
C.P. 62740, CUAUTLA, MOR.
TEL.: 735 352 8951

NAYARIT **HERRAMIENTAS DE TEPEC**
MAZATLÁN #117, COL. CENTRO, C.P. 65000, TEPEC, NAY.
TEL.: 311 258 0540

NUOVO LEÓN **SUCURSAL MONTERREY**
CARRETERA LAREDO #300, 1B MONTERREY PARKS,
COLONIA PUERTA DE ANAHUAC, C.P. 66052, ESCOBEDO,
NUOVO LEÓN, TEL.: 81 8352 8791 / 81 8352 8790

OAXACA **FIX FERRETERÍAS**
AV. 20 DE NOVIEMBRE #910, COL. CENTRO, C.P. 68300,
TUXTEPEC, OAX. TEL.: 287 106 3092

PUEBLA **SUCURSAL PUEBLA**
AV. PERIFÉRICO #2-A, SAN LORENZO ALMECATLA,
C.P. 72710, CUAUTLACINGO, PUE.
TEL.: 222 282 8282 / 84 / 85 / 86

QUERÉTARO **ARU HERRAMIENTAS S.A. DE C.V.**
AV. PUERTO DE VERACRUZ #110, COL. RANCHO DE
ENMIEDO, C.P. 76842, SAN JUAN DEL RÍO, QRO.
TEL.: 427 268 4544

QUINTANA ROO **FIX FERRETERÍAS**
CARRETERA FEDERAL MZ. 46 LT. 3 LOCAL 2, COL. EJIDAL,
C.P. 77710 PLAYA DEL CARMEN, Q.R.
TEL.: 984 267 3140

SAN LUIS POTOSÍ **FIX FERRETERÍAS**
AV. UNIVERSIDAD #1850, COL. EL PASEO, C.P. 78320,
SAN LUIS POTOSÍ, S.L.P. TEL.: 444 822 4341

SINALOA **SUCURSAL CULIACÁN**
AV. JESÚS KUMATE SUR #4301, COL. HACIENDA DE LA
MORA, C.P. 80143, CULIACÁN, SIN.
TEL.: 667 173 9139 / 173 8400

SONORA **FIX FERRETERÍAS**
CALLE 5 DE FEBRERO #517, SUR LT. 25 MZ. 10, COL.
CENTRO, C.P. 85000, CD. OBREGÓN, SON.
TEL.: 644 413 2392

TABASCO **SUCURSAL VILLAHERMOSA**
CALLE HELIO LOTES 1, 2 Y 3 MZ. #1, COL. INDUSTRIAL,
2A ETAPA, C.P. 86010, VILLAHERMOSA, TAB.
TEL.: 993 353 7244

TAMAULIPAS **VM ORINGS Y REFACCIONES**
CALLE ROSITA #527 ENTRE 20 DE NOVIEMBRE Y GRAL.
RODRÍGUEZ, FRACC. REYNOSA, C.P. 88780, REYNOSA,
TAMS. TEL.: 899 926 7552

TLAXCALA **SERVICIOS Y HERRAMIENTAS INDUSTRIALES**
PABLO SIDAR #132, COL. BARRIO DE SAN BARTOLOMÉ,
C.P. 90970, SAN PABLO DEL MONTE, TLAX.
TEL.: 222 271 7502

VERACRUZ **LA CASA DISTRIBUIDORA TRUPER**
BLVD. PRIMAVERA, ESQ. HORTENSIA S/N, COL.
PRIMAVERA, C.P. 93308, POZA RICA, VER.
TEL.: 782 823 8100 / 826 8484

YUCATÁN **SUCURSAL MÉRIDA**
CALLE 33 #600 Y 602, LOCALIDAD ITZINCAB Y MULSA,
MPIO. UMIÁN, C.P. 97390, MÉRIDA, YUC.
TEL.: 999 912 2451

Code	Model	Brand
102800	CEPEL-3-1/4N2	TRUPER INDUSTRIAL

Warranty. Duration: 5 years. Coverage: parts, components and workmanship against manufacturing or operating defects, except if used under conditions other than normal; when it was not operated in accordance with the instructive; was altered or repaired by personnel not authorized by TRUPER®. To make the warranty valid, only present the product in the establishment where you bought it or in Corregidora 35, Centro, Cuauhtémoc, CDMX, 06060, where you can also purchase parts, components, consumables and accessories. The costs of transportation of the product that derive from its fulfillment of its service network are included. TRUPER will not require any proof of purchase to make the warranty effective. Phone number 800-018-7873. Made in China. Imported by TRUPER, S.A. de C.V. Parque Industrial 1, Parque Industrial Jilotepec, Jilotepec, Edo. de Méx. C.P. 54257, Phone number 761 782 9100.



Stamp of the business. Delivery date: