

Manual

Tamping rammer

4 100 W

5.5 Hp

Power

Applies for:

Code

Model

102971

BAI-55

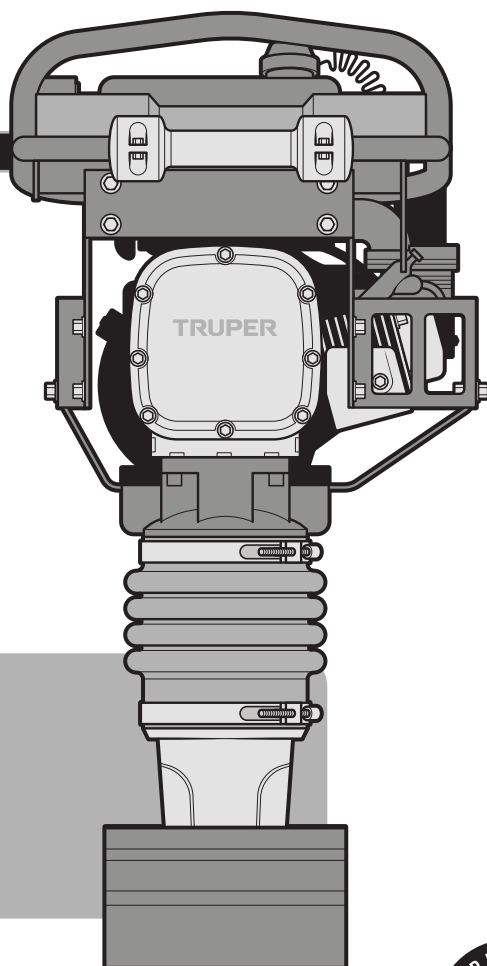



BAI-55



Read the user's manual thoroughly
before operating this tool.



Technical data	3
Fuel specifications	3
 General safety warnings for the use of motorized tools	4
 Safety warnings for the use of a tamping rammer	5
Parts	6
Fuel and oil	7
Startup	8
Operation	9
Maintenance	10
Troubleshooting	14
Authorized service centers	15
Warranty policy	16

CAUTION

To gain the best performance of the tool, prolong the duty life, make the Warranty valid if necessary, and to avoid hazards of fatal injuries please read and understand this Manual before using the tool.

Keep this manual for future references.

The illustrations in this manual are for reference only. They might be different from the real tool.

Use and care recommendations



DO NOT start the machine **WITHOUT OIL** or the engine will suffer serious damage due to lack of lubrication.



For better performance and durability use higher-octane gasoline. In Mexico, we suggest using **PREMIUM** gasoline. Never use gasoline that is contaminated and/or mixed with additives or oils.



Keep the engine's ventilation slots **CLEAR**.



Perform regular **MAINTENANCE** on your machine (page 10)

Technical data

TRUPER

BAI-55

Code •	102971
Description •	Tamping rammer
Engine •	4-stroke OHV
Rated engine power •	4 100 W (5.5 Hp)
Impact force •	12 kN (1 223 kgf)
Impacts per minute •	640 impacts/min - 680 impacts/min
Jumping height •	40 mm - 75 mm
Forward speed •	9 m/min - 12 m/min
Gasoline tank capacity •	2.5 L
Oil reservoir •	0.5 L
Fuel type •	Gasoline
Duty cycle •	30 min of rest per consumed tank
Plate dimensions •	13" x 11 1/2"
Engine speed •	3 600 RPM

Fuel Specifications



For better performance and durability use higher-octane gasoline. In Mexico, we suggest using PREMIUM gasoline.

- The equipment has an air-cooled 4-stroke motor using pure unleaded gasoline.
- For no reason at all mix oil with the fuel.

⚠ WARNING • For no reason at all use fuel mixed with ethyl alcohol (gasohol), ethanol or methanol. These attract humidity causing separation and acid build up when stored. Acidity can damage the motor fuel system when stored.

- To avoid having problems with the motor, please drain the fuel system before storing the equipment 30 days or longer. Drain the gasoline tank, start the motor and leave it running

until the fuel lines are empty. Next season, use fresh gasoline.

- Never use inside the gasoline tank products to clean motors or carburetors. Those products can cause permanent damage to the Motor.

Do not use the equipment in closed areas.

⚠ DANGER Prevent breathing accumulated carbon monoxide, an odorless, toxic and potentially fatal gas.



Never smoke near fuel.

⚠ DANGER Do not smoke near the filling-up area or while operating the equipment.



General safety warnings for motor tools



Keep your work area tidy and with good lighting.

CAUTION Cluttered and dark areas can cause injuries.



Never use the mixer in explosive environments or where there are flammable liquids present.

DANGER Set the mixer 30 ft. away from the fuel filling up area before starting the motor.



Keep children and passersby at a safe distance while the mixer is operating.

WARNING Distractions can make you loose control and cause accidents.



Avoid making contact with power lines and circuits.

DANGER Find and avoid all power lines and circuits, especially hidden wiring. Also keep away from grounded objects.



Stay always alert, be prudent and use common sense.

CAUTION Even tough you are familiar with the use of the mixer do not get distracted while operating the machine. It can cause accidents.

Do not operate the equipment when tired or under the influence of drugs, alcohol or medication.

DANGER A moment of distraction while operating the mixer can cause severe personal injury.

Use the equipment with the guards and protector installed and in good repair.

WARNING Failure to comply with this warning leads to severe personal injury.

Never force the tamping rammer.

CAUTION Working within the range designed assures a better job and is safer.



Store the tamping rammer is a safe place away from the reach of children.

WARNING Motor concrete mixers are dangerous near inexperienced hands.



Wear the right clothes.

WARNING Loose clothes, jewelry or long hair may get tangled in the moving parts.



Keep your hands away from the rotating or moving parts.

WARNING Failure to comply with this warning leads to severe personal injury.



Do not use the equipment in enclosed areas.

DANGER To prevent accumulation of carbon monoxide, an odorless toxic gas potentially deadly.



Use the right personal protection equipment.

CAUTION Using eye protection, anti-dust masks, non-skid safety shoes, helmet, hearing protection and safety gloves considerably reduce the risk of injury.



Turn off the tamping rammer before adjusting, changing accessories or storing.

WARNING Double-check the mixer motor switch is in the OFF position.

Never run the equipment if the switch is not working or is not duly assembled.

WARNING The operator is exposed to severe injury. Take it to repair immediately to a TRUPER Authorized Service Center.

Do not overreach.

CAUTION Good footing and balance give better control of the equipment in unexpected situations.

Prevent unintentional starting.

WARNING Double-check the equipment motor is OFF before leaving or servicing.



Remove any vise fixed in the equipment before starting it.

DANGER Additional tools or wrenches fixed in a rotating part in the mixer can cause severe personal injury.

Service the equipment and double-check it is in the best conditions before starting it.

CAUTION Check carefully the moving parts. See alignment and assembly. Do it periodically. Look for damaged elements or part that is not functioning correctly. Repair immediately in a TRUPER Authorized Service Center.



Accessories.

CAUTION Use only accessories or spare parts indicated in this Manual or certified by

Never leave the tamping rammer running and unattended.

DANGER To prevent severe accidents turn off the equipment after operating and before setting it in a safe place.

Never smoke near fuel.

DANGER Do not smoke near the area where fuel is being supplied or when operating the equipment.



Safety warnings for the use of tamping rammers

TRUPER

Fuel handling

- Never smoke near fuel, the fueling area, or while operating the tool.
- To reduce the risk of fire or burns, handle fuel with care, as it is highly flammable.
- Do not allow gasoline or oil to encounter the skin.
- Protect your eyes to prevent splashes of gasoline and oil. In case of accidental contact, wash them immediately with clean water. If irritation persists, seek medical attention.
- Store fuel in a container designed for that purpose.

⚠ WARNING • Before refueling the tool, turn off the engine, place it on clear ground, and wait for the engine to cool down.

⚠ CAUTION • Clean any fuel that may have spilled on the tool before operating it.

⚠ CAUTION • Check for fuel leaks; if present, fix them before using the tool to prevent fires or burn injuries.

- Move the tool at least 30 feet away from the fueling area before starting the engine.
- Under no circumstances should you burn spilled fuel to dispose of it.
- Never use any fuel other than what is specified for the tool in this manual.



• **NEVER** touch the engine or the muffler while the engine is running or immediately after shutting it off. These areas become hot and can cause burns.

• **NEVER** leave the machine running unattended.

• **NEVER** alter or disable the function of the operating controls.

• **NEVER** use the choke to stop the engine.

• **ALWAYS** ensure that all other persons are at a safe distance from the machine. Stop the machine if someone enters the machine's work area.

• Use hearing protection when operating the equipment.

• Keep hands, feet, and loose clothing away from the machine's moving parts.

• **ALWAYS** guide the compactor so that the operator is not trapped between the compactor and solid objects. Special care is needed when working on uneven terrain or compacting thick material.

• Operate the compactor in a way that avoids the risk of tipping or falling when working near edges, pits, slopes, trenches, and platforms.

Before operating the compactor

• **NEVER** perform tasks for which the equipment is not designed.

• **NEVER** allow untrained individuals to operate the equipment.

⚠ CAUTION • Ensure that the operator is familiar with safety precautions and proper operating techniques before using the machine.

• **NEVER** use accessories not recommended by the manufacturer. Otherwise, equipment damage and user injuries may occur.

• **NEVER** operate the machine in explosive environments.

• Equip yourself with appropriate protective clothing for the workplace when operating the equipment, including safety footwear.

When operating the compactor

• **ALWAYS** operate the machine with all safety devices and guards in place and in good working condition. DO NOT modify or bypass safety devices. DO NOT operate the machine if safety devices or guards are missing or not functioning.

⚠ CAUTION • Hold the compactor with both hands on the handle.

After operating the compactor

• **TURN OFF** the engine when the compactor is not in use.

• Ensure that the compactor does not tip over, roll, slide, or fall when not in operation.

• **ALWAYS** store the equipment properly when not in use.

• **ALWAYS** close the fuel valve on engines equipped with one when the machine is not in operation.

Maintenance recommendations

⚠ WARNING • If you are missing parts, do not operate the tool until they are replaced. Otherwise, you may suffer serious personal injuries.

⚠ WARNING • Do not attempt to modify the tool or manufacture accessories not recommended for it. Otherwise, you may suffer injuries and void the warranty.

⚠ WARNING • Whenever you have access to moving parts, disconnect the spark plug wire from the engine to prevent accidental starting that can cause serious personal injuries.

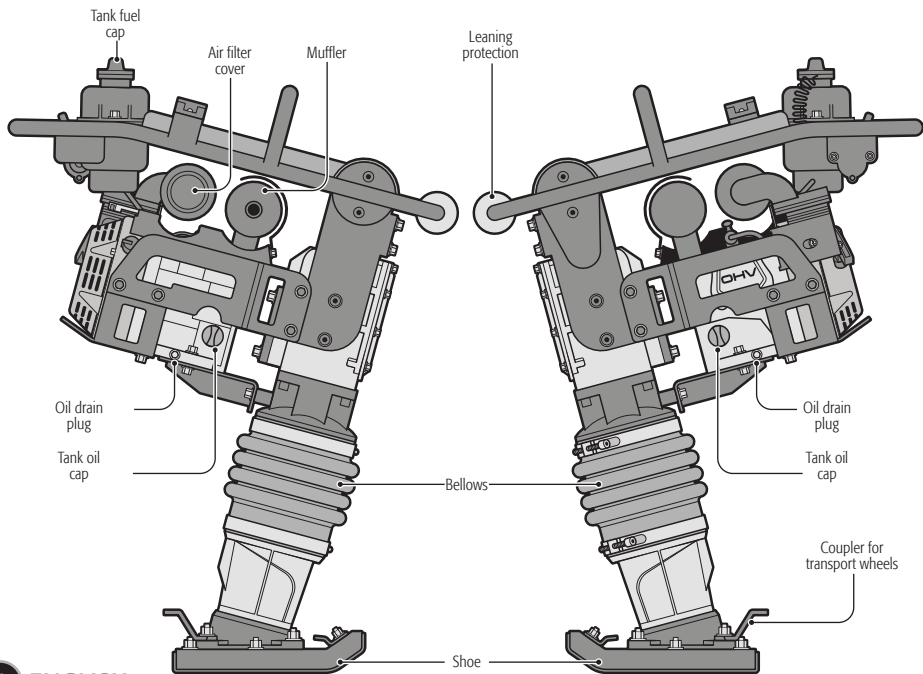
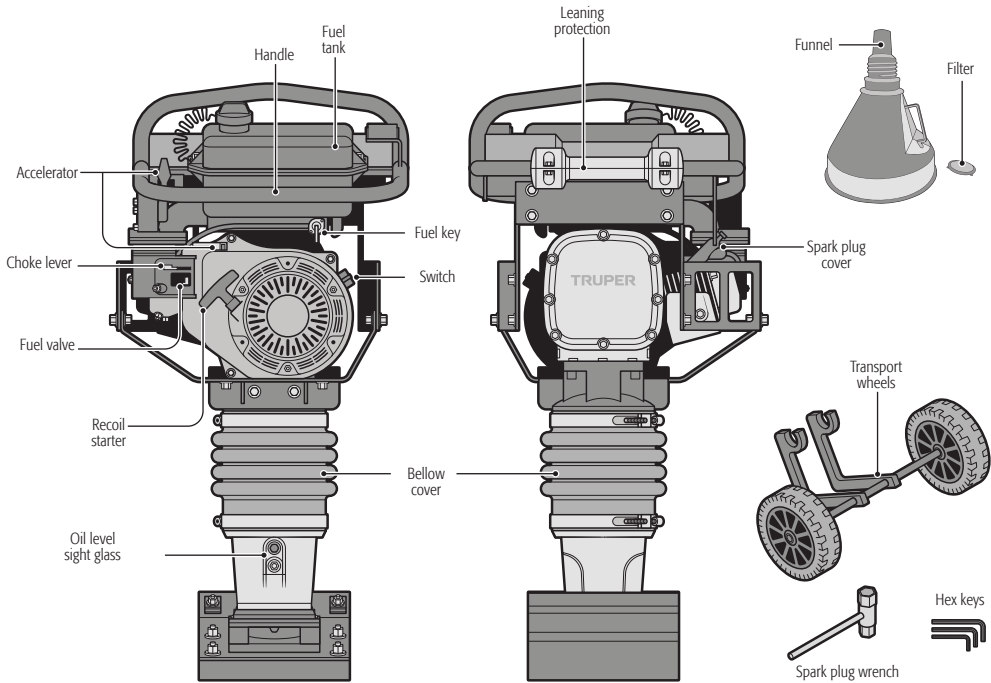

Oil filling (A)

- Place the equipment on a flat and level surface.
- Turn and remove the oil filling cap.
- Use 4-stroke engine oil. SAE 10W-30 is recommended for general use at any temperature. As indicated in the following table, other viscosities can be used when the average temperature in your area falls within the specified range.

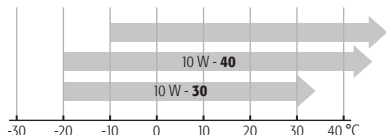

- Replace the cap and remove it to check the oil level on the cap dipstick.
- Once the tank has the correct oil level indicated on the dipstick, tighten the cap to prevent leaks.

CAUTION • Do not exceed the maximum oil level, as excessive smoke may come out of the exhaust when starting the engine.

CAUTION • Check the oil level before each use. If necessary, add oil until the level is within the limits on the dipstick.

CAUTION • Perform the first oil change after the first 20 hours, then change the oil every 100 hours of use. In dusty or dirty conditions, more frequent oil changes may be necessary.

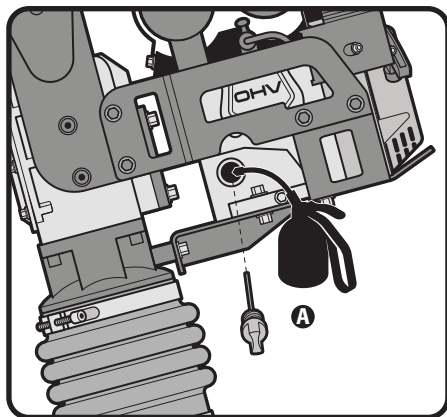

Engine fueling (B)

- Place the equipment on a flat and level surface.
- Clean and dry the area around the fuel cap.
- Remove the fuel cap.
- Using a funnel, slowly fill the fuel tank to the bottom of the tank neck. Do not overfill to allow for fuel expansion and to prevent spills.
- Clean up any fuel spills.
- Secure the tank by turning the cap until it clicks.
- Clean any fuel spills before starting.

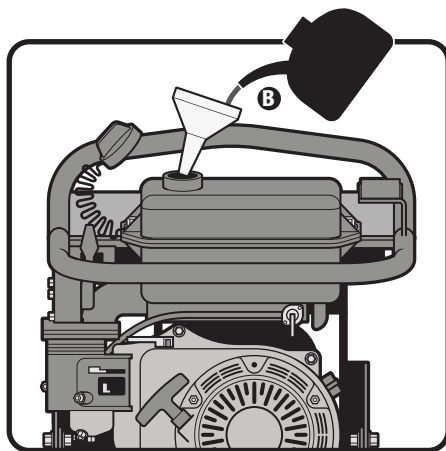

Supply of oil to the bellows (C)

- For proper lubrication of the impact system (bellows), check the oil level through the indicator window C before each use (See page 12). If necessary, use SAE 10W-30 oil to refill and follow the scheduled changes according to the maintenance program.

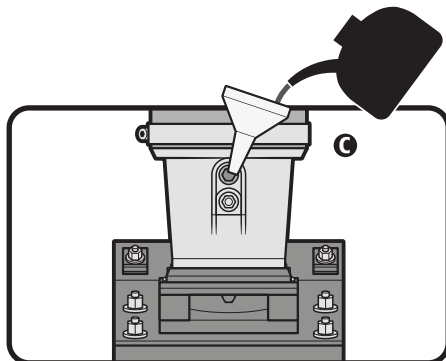

Ignition

⚠ CAUTION Before starting the equipment, it is essential to ensure that the gasoline and oil levels are met.

- Open the fuel valve at the bottom of the fuel tank.

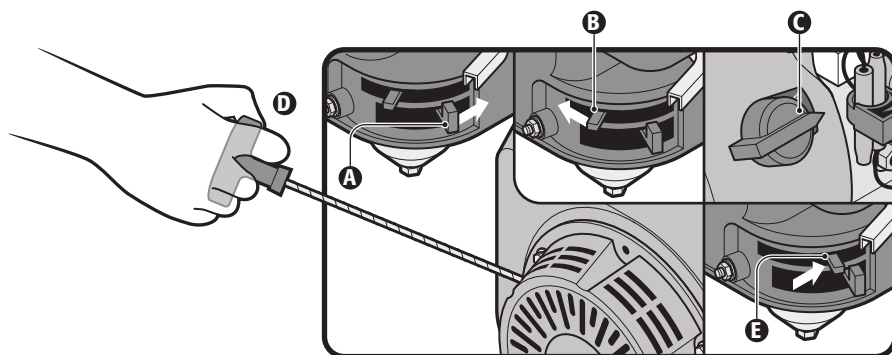
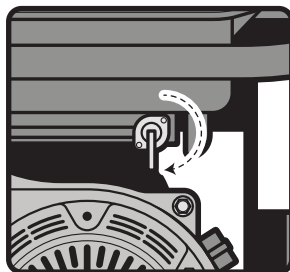

- Open the motor fuel valve (A).
- Move the choke lever to the "off" position (B).
- Set the switch (C) to the "on" position (I).
- Gently pull the starter handle (D) until you feel resistance in the line. Then pull forcefully to start the engine.

⚠ CAUTION Return the handle to its place carefully. Do not release it, otherwise, it will return abruptly and could be damaged.

- Allow the engine to run for 5 seconds and then move the choke lever to the "on" position (E).
- Move the throttle lever (G) to the full throttle position to begin working.

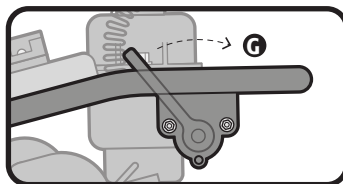

Turning OFF

- Move the throttle lever (G) to the minimum speed position.
- Turn off the switch (C).
- Close the fuel valve (A) by moving the lever to the closed position (OFF).
- Move the choke lever (B) to the off position (OFF).

⚠ CAUTION • In case of emergency engine shutdown, immediately place the engine switch (C) in the "off" position.

Tamping rammers are designed to compact loose soils and gravel to prevent unintended settlements, providing a firm and solid base for the placement of foundations, concrete slabs, and other structures.

Preparations

- Before starting to use the plate compactor:
- Read the safety instructions at the beginning of this manual.
- Ensure that the gasoline tank is full.
- Check the engine oil level.
- Note that after transporting the plate compactor horizontally, when placing it in the vertical position, you should allow the oil to drain through the engine. The oil level may take up to 2 minutes to recover.
- Place the plate compactor in the work area on loose soil or gravel. DO NOT start the plate compactor on hard surfaces such as asphalt or concrete. DO NOT start the plate compactor on inclined surfaces.

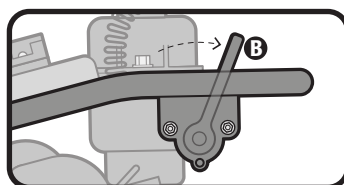
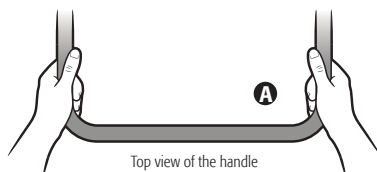

Operation

- Start the tamping rammer.
- For optimal control and performance with minimal hand or arm vibration, hold the handle as shown in graphic (A).
- Operate the rammer in the full-throttle position (B) to achieve maximum performance.
- Guide the rammer by always holding the handle. Let the machine move forward on its own.
- DO NOT attempt to overload the machine.
- For better compaction, the baseplate should fully touch the ground (C), not just the tip or heel. This will prevent excessive wear on the baseplate.
- Avoid hitting without a load.
- Never push or lift the plate compactor while it is running at maximum speed.

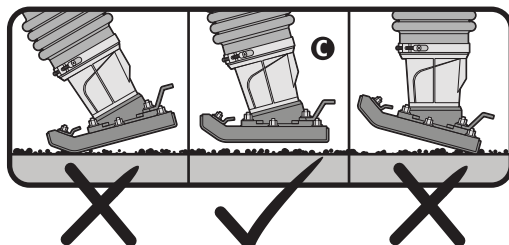

CAUTION • To prevent damage to the rammer, do not allow it to operate on sloped ground. If the rammer were to tip over on its side, place it in the position shown in graphic (D), shut off the fuel flow, and turn off the engine by rotating the engine switch to "OFF".

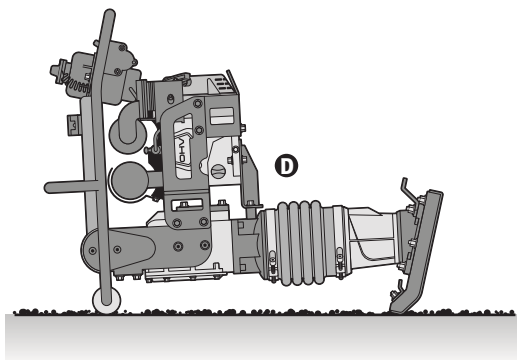

⚠ CAUTION • Regular and careful maintenance is essential to maintain optimal safety levels and equipment performance.

- Before cleaning, repairing, inspecting, or storing the equipment, turn off the engine and wait for the engine to cool completely.
- Keep nuts, bolts, and screws tightened to ensure the equipment is in a safe working condition.

- Do not alter safety devices. Verify their proper functioning regularly.
- Any worn or damaged parts should be replaced before using the equipment. Do not attempt to repair the parts, as it can damage the equipment and jeopardize your safety.
- Any repairs or maintenance not described in this section, such as carburetor adjustment, should be carried out only at an authorized TRUPER Service Center.

Periodic maintenance	Before each use	Every 20 hrs of work	Every 50 hrs or 1 week	Every 100 hrs or 1 month	Every 300 hrs or 3 months
Fuel	Check (fill if necessary)				
Engine oil	Check (fill if necessary)	*Change		Change	
Air filter	Check (clean if necessary)		Clean	Change	
Bellows oil	Check	*Change		Change	
Fuel line and accessories	Check (replace if necessary)				(1) Change
Shoe	Check (tighten if necessary)				(1) Change
External structure		Check			
Engine cooling fins			Clean		
Spark plug		Clean		Change	
Recoil starter				Change	(1) Change
Fuel filter					(1) Change

*Only applies for the first oil change.
(1) Take the machine to the nearest service center.

Air filter

The engine is equipped with a two-element air filter. Perform air filter maintenance regularly to prevent carburetor malfunctions.

CAUTION NEVER operate the engine without the air filter. Severe engine damage will occur.

CAUTION NEVER use gasoline or other low flashpoint solvents to clean the air filter. This could result in a fire or explosion.

Inspection:

- Release the retaining clip (A) and remove the air filter cover (B).
- Remove and inspect the filters. If they are dirty, clean them as described below. Replace damaged filters. Always replace the paper filter (C) at the scheduled interval.
- Place the foam filter (D) over the paper filter and reinstall them as a combined unit. Insert the open end of the air filter elements into the box as shown, with the closed end facing the air filter cover.
- Hook the lower edge of the air filter cover onto the box, then secure the cover with the retaining clip.

Cleaning:

- Clean the air filter elements if they are going to be reused.
- Paper air filter element (C): Tap the filter element several times on a hard surface to remove dirt or blow compressed air [not exceeding 207 kPa (2.1 kgf/cm², 30 psi)] through the filter element from the inside. Never attempt to brush off the dirt; brushing will force dirt into the fibers.
- Foam air filter element (D): Clean with warm soapy water, rinse, and allow to dry completely. Or clean it with a non-flammable solvent and let it dry. Dip the filter element in clean motor oil and then squeeze out all excess oil. The engine will smoke when starting if too much oil remains in the foam.

Oil Change

- The oil drain plug is located under the engine (F).
- Place a suitable container under the engine to catch the oil, remove the drain plug, and then the tank plug (G). Once the oil has drained, replace the drain plug.
- Clean up any spills or splashes.
- Fill the tank with SAE 10W-30 oil.
- Check the oil level by placing the tank cap without screwing it in. The oil level should be between the minimum and maximum marks on the dipstick. Ensure the level does not exceed the maximum mark. Tighten the tank cap when the level is correct.
- Start the engine and let it run briefly. Stop the engine, wait one minute, and check the oil level again. Refill if necessary.
- Under no circumstances dispose of the oil down the drain. Take the used oil and oil filter to a recycling center.

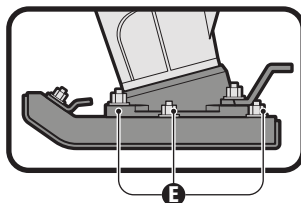
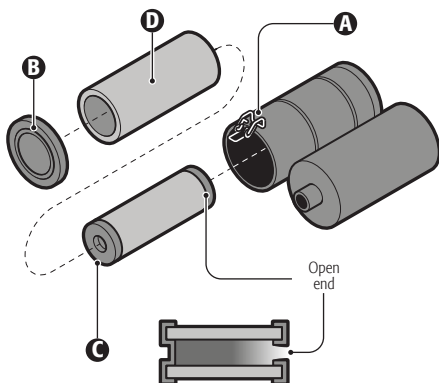
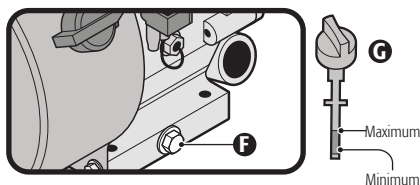

Shoe

On new machines, or after replacing the shoe, check and tighten the shoe fasteners (E) after the first 5 hours of operation. Inspect the fasteners every week thereafter.

Oil level for the bellows

- Place the compactor on a level surface so that it rests on its shoe.
- Check the oil level through the oil sight glass (A). Proper lubrication of the compaction system is indicated when approximately 3/4 of the sight glass is full.
- If the oil is not visible, it must be filled through the oil fill port (B). Refer to the technical specifications section for the quantity and type of oil.
- After refilling, wrap the oil fill cap with Teflon tape before installing it and tighten to 9 Nm.

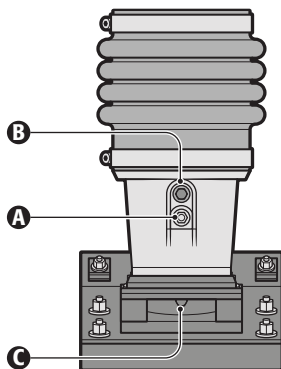

Bellows oil replacement

- To change the oil, unscrew the oil drain plug (C) located under the oil sight glass.
- Tilt the compactor backward until it rests on its handle and allow the oil to drain (D).
- To protect the environment, place a plastic sheet and a container underneath the machine to collect any dripping fluid. Dispose of this liquid in accordance with environmental protection regulations.
- Screw the oil drain plug (C) back on. Tighten to 54 Nm
- Remove the oil fill cap (B) and fill with oil as indicated above.

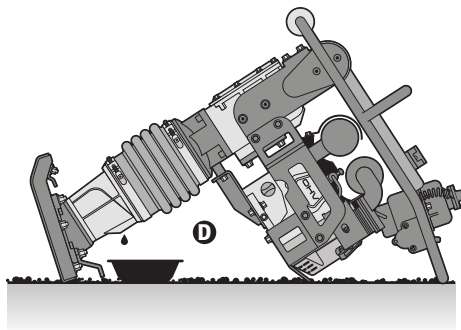

Storage

- When moving the equipment to storage, turn off the engine switch and close the fuel valve. Keep the equipment level and upright to prevent fuel spills.

When storing the equipment for extended periods:

- Drain all fuel from the tank completely. Then, start the engine and let it run until the carburetor is empty.
- Drain the engine oil entirely to prevent leaks.
- Remove the spark plug and pour a tablespoon of SAE 10W-30 oil into the cylinder. Pull the starter handle gently to distribute the oil throughout the system. Then replace the spark plug.
- Pull the starter handle gently until you feel resistance, indicating that the cylinder is reaching its compression phase, and the exhaust and intake valves are closed. Storing the equipment in these conditions prevents internal corrosion.
- Clean the equipment with a damp cloth and cover it to prevent the accumulation and entry of dust.
- Store the equipment in a clean, dry place, out of the reach of children, and in the storage position (E) to prevent tipping.

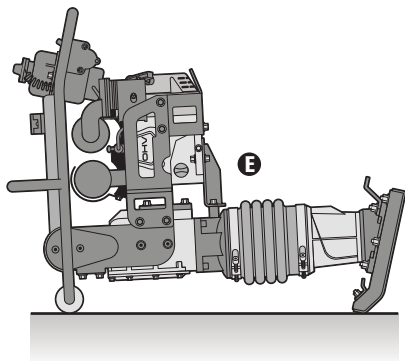

Spark plug

- Before removing the spark plug, clean the area around the base of the spark plug to prevent dust and debris from entering the engine. Then remove the spark plug with the help of a wrench.
- Clean the carbon deposits from the spark plug electrodes using a spark plug cleaner or a wire brush.
- Replace the spark plug with another of the same model BPR6ES if it is damaged, worn, or its reuse is uncertain.
- Measure the gap between the two electrodes with a spark plug gap tool. The distance between the center electrode and the side electrode should be between 0.02" and 0.03".
- Check that the spark plug washer is in good condition, and insert the spark plug manually to prevent incorrect positioning that could damage the engine threads.
- Once the spark plug is in place, tighten it with the spark plug wrench to compress the washer.

⚠ CAUTION If installing a new spark plug, tighten it half a turn after it is in place and the washer is compressed. If installing a used spark plug, tighten it 1/8 - 1/4 turn after it is in place and the washer is compressed.

⚠ WARNING Incorrectly installed or out-of-range spark plugs can overheat and damage the engine.

Transportation

- When transporting the equipment, turn off the engine switch, close the fuel valve, and keep it level at all times to avoid fuel and oil spills.
- Use the transport wheels to easily move the equipment. To place the wheels on the equipment's shoe, follow these steps with the help of another person.

1. With the compactor in an upright position, position the wheels behind the shoe. The hooks on the wheels (A) should point upward and away from the shoe.

2. Tilt the compactor forward so that the heel is lifted while another person pushes the wheels toward the shoe and at the same time rotates the hooks to contact the wheel coupling (B).

3. Once the hooks are securely attached to the coupling, return the compactor to its upright position. To remove the transport wheels, follow the steps in reverse order.

⚠ CAUTION The transport wheels are for easily moving the equipment from one place to another. Once the equipment is in its place, remove the transport wheels. Do not release the transport handle while the wheels are installed.

Note: If you need to transport the machine horizontally, drain the fuel tank to prevent spills.

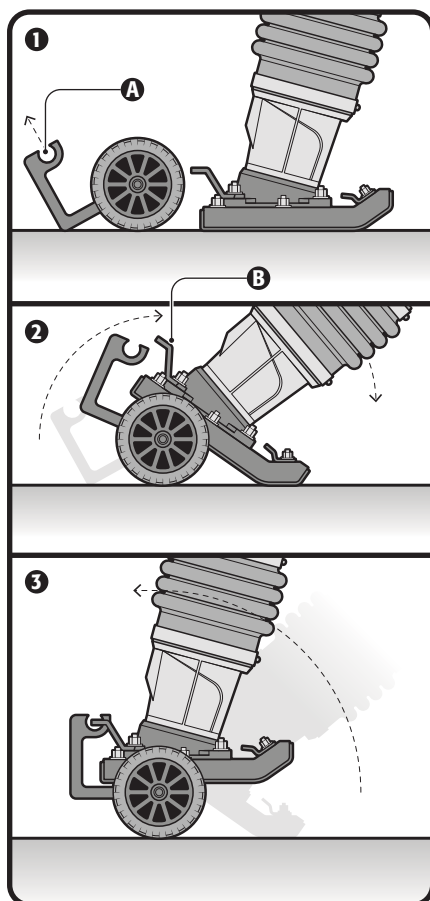

Problem

Solution

The engine won't start or stops.

- No gasoline in the tank.
- Check the engine oil level.
- Dirty spark plug.
- Fuel valve closed.
- The engine switch is in the "OFF" position.

The engine doesn't accelerate, is hard to start, or runs erratically.

- Dirty spark plug.
- Crankshaft seals are leaking.
- Check the air filter.
- Check the engine oil level.

The engine overheats.

- Clean the cooling fins and fan blades.

The engine is running, but the compactor is not compacting.

- Inspect the clutch for damage. Replace it if necessary.
- Broken connecting rod or crankshaft.
- Engine underperforming. Loss of compression.

The tamper's operation is erratic.

- Oil/grease in the clutch.
- Broken/worn springs.
- Accumulation of dirt on the compaction plate.
- Broken parts in the compaction system or crankcase.
- The engine's operating speed is too high.

Authorized service centers

TRUPER

In the event of any problem contacting a TRUPER Authorized Service Center, please see our webpage WWW.TRUPER.COM to get an updated list, or call our toll-free numbers **800 690-6990** or **800-018-7873** to get information about the nearest Service Center.

AGUASCALIENTES **DE TODO PARA LA CONSTRUCCIÓN**
GRAL. BARRAGÁN #1201, COL. GREMIAL, C.P. 20030,
AGUASCALIENTES, AGS. TEL.: 449 994 0537

BAJA CALIFORNIA **SUCURSAL TIJUANA**
AV. LA ENCANTADA, LOTE #5, PARQUE INDUSTRIAL EL
FLORIDO II, C.P. 22244, TIJUANA, B.C.
TEL.: 664 969 5100

BAJA CALIFORNIA SUR **FIX FERRETERÍAS**
FELIPE ÁNGELES ESQ. RUIZ CORTÍNEZ S/N, COL. PUEBLO
NUEVO, C.P. 23670, CD. CONSTITUCIÓN, B.C.S.
TEL.: 613 132 1115

CAMPECHE **TORNILLERÍA Y FERRETERÍA AAA**
AV. ÁLVARO OBREGÓN #324, COL. ESPERANZA
C.P. 24080 CAMPECHE, CAMP. TEL.: 981 815 2808

CHIAPAS **FIX FERRETERÍAS**
AV. CENTRAL SUR #27, COL. CENTRO, C.P. 30700,
TAPACHULA, CHIS. TEL.: 962 118 4083

CHIHUAHUA **SUCURSAL CHIHUAHUA**
AV. SILVESTRE TERRAZAS #128-11, PARQUE INDUSTRIAL
BAFAR, CARRETERA MÉXICO CUAUHTÉMOC, C.P. 31415,
CHIHUAHUA, CHIH. TEL.: 614 434 0052

MEXICO CITY **FIX FERRETERÍAS**
EL MONSTRUO DE CORREGIDORA, CORREGIDORA # 35,
COL. CENTRO, C.P. 06060, CUAUHTÉMOC, CDMX.
TEL.: 55 5522 5031 / 5522 4861

COAHUILA **SUCURSAL TORREÓN**
CALLE METAL MECÁNICA #280, PARQUE INDUSTRIAL
ORIENTE, C.P. 27278, TORREÓN, COAH.
TEL.: 871 209 68 23

COLIMA **BOMBAS Y MOTORES BYMTESSA DE MANZANILLO**
BLVD. MIGUEL DE LA MADRID #190, COL. 16 DE
SEPTIEMBRE, C.P. 28239, MANZANILLO, COL.
TEL.: 314 332 1986 / 332 8015

DURANGO **TORNILLOS ÁGUILA, S.A. DE C.V.**
MAZURIO #200, COL. LUIS ECHEVERRÍA, DURANGO,
DGO. TEL.: 618 817 1946 / 618 818 2844

ESTADO DE MÉXICO **SUCURSAL CENTRO JILOTEPEC**
PARQUE INDUSTRIAL # 1, COL. PARQUE INDUSTRIAL
JILOTEPEC, JILOTEPEC, EDO. DE MÉX. C.P. 54257
TEL.: 761 782 9101 EXT. 5728 Y 5102

GUANAJUATO **CÍA. FERRETERA NUEVO MUNDO S.A. DE C.V.**
AV. MÉXICO - JAPÓN #225, CD. INDUSTRIAL, C.P. 38010,
CELAYA, GTO. TEL.: 461 617 7578 / 79 / 80 / 88

GUERRERO **CENTRO DE SERVICIO ECLIPSE**
CALLE PRINCIPAL MZ.1 LT. 1, COL. SANTA FE, C.P. 39010,
CHILPANCIÑO, GRO. TEL.: 747 478 5793

HIDALGO **FERREPRECIOS S.A. DE C.V.**
LIBERTAD ORIENTE #304 LOCAL 30, INTERIOR DE PASAJE
ROBLEDO, COL. CENTRO, C.P. 43600, TULANCINGO,
HGO. TEL.: 775 753 6615 / 775 753 6616

JALISCO **SUCURSAL GUADALAJARA**
AV. ADOLFO B. HORN # 6800, COL. SANTA CRUZ DEL
VALLE, C.P.: 45655, TLAJOMULCO DE ZUÑIGA, JAL.
TEL.: 33 3606 5285 AL 90

MICHOACÁN **FIX FERRETERÍAS**
AV. PASEO DE LA REPÚBLICA #3140-A, COL.
EX-HACIENDA DE LA HUERTA, C.P. 58050, MORELIA,
MICH. TEL.: 443 334 6858

MORELOS **FIX FERRETERÍAS**
CAPITÁN ANZURES #95, ESQ. JOSÉ PERDIZ, COL.
CENTRO, C.P. 62740, CUAUTLA, MOR.
TEL.: 735 352 8931

NAYARIT **HERRAMIENTAS DE TEPEC**
MAZATLAN #117, COL. CENTRO, C.P. 63000, TEPEC, NAY.
TEL.: 311 258 0540

NUEVO LEÓN **SUCURSAL MONTERREY**
CARRETERA LAREDO #300, 1B MONTERREY PARKS,
COLONIA PUERTA DE ANÁHUAC, C.P. 66052, ESCOBEDO,
NUEVO LEÓN, TEL.: 81 8352 8791 / 81 8352 8790

OAXACA **FIX FERRETERÍAS**
AV. 20 DE NOVIEMBRE #910, COL. CENTRO, C.P. 68300,
TUXTEPEC, OAX. TEL.: 287 106 3092

PUEBLA **SUCURSAL PUEBLA**
AV. PERIFÉRICO #2-A, SAN LORENZO ALMECATLA,
C.P. 72710, CUAUTLACINGO, PUE.
TEL.: 222 282 8282 / 84 / 85 / 86

QUERÉTARO **ARU HERRAMIENTAS S.A. DE C.V.**
AV. PUERTO DE VERACRUZ #110, COL. RANCHO DE
ENMEDIO, C.P. 76842, SAN JUAN DEL RÍO, QRO.
TEL.: 427 268 4544

QUINTANA ROO **FIX FERRETERÍAS**
CARRETERA FEDERAL MZ. 46 LT. 3 LOCAL 2, COL. EJIDAL,
C.P. 77710 PLAYA DEL CARMEN, Q.R.
TEL.: 984 267 3140

SAN LUIS POTOSÍ **FIX FERRETERÍAS**
AV. UNIVERSIDAD #1850, COL. EL PASEO, C.P. 78320,
SAN LUIS POTOSÍ, S.L.P. TEL.: 444 822 4341

SINALOA **SUCURSAL CULIACÁN**
AV. JESÚS KUMATE SUR #4301, COL. HACIENDA DE LA
MORA, C.P. 80143, CULIACÁN, SIN.
TEL.: 667 173 9139 / 173 8400

SONORA **FIX FERRETERÍAS**
CALLE 5 DE FEBRERO #517, SUR LT. 25 MZ. 10, COL.
CENTRO, C.P. 85000, CD. OBREGÓN, SON.
TEL.: 644 413 2392

TABASCO **SUCURSAL VILLAHERMOSA**
CALLE HELIO LOTES 1, 2 Y 3 MZ. #1, COL. INDUSTRIAL,
2A ETAPA, C.P. 86010, VILLAHERMOSA, TAB.
TEL.: 993 353 7244

TAMAULIPAS **VM ORINGS Y REFACCIONES**
CALLE ROSITA #527 ENTRE 20 DE NOVIEMBRE Y GRAL.
RODRÍGUEZ, FRACC. REYNOSA, C.P. 88780, REYNOSA,
TAMS. TEL.: 899 926 7552

TLAXCALA **SERVICIOS Y HERRAMIENTAS INDUSTRIALES**
PABLO SIDAR #132, COL. BARRIO DE SAN BARTOLOMÉ,
C.P. 90970, SAN PABLO DEL MONTE, TLAX.
TEL.: 222 271 7502

VERACRUZ **LA CASA DISTRIBUIDORA TRUPER**
BLVD. PRIMAVERA ESQ. HORTENSIA S/N, COL.
PRIMAVERA C.P. 93308, POZA RICA, VER.
TEL.: 782 823 8100 / 826 8484

YUCATÁN **SUCURSAL MÉRIDA**
CALLE 33 #600 Y 602, LOCALIDAD ITZINCAB Y MULSA,
MPIO. UMAN, C.P. 97390, MÉRIDA, YUC.
TEL.: 999 912 2451

Code	Model	Brand
102971	BAI-55	TRUPER
<p>Warranty. Duration: 1 year. Coverage: parts, components and workmanship against manufacturing or operating defects, except if used under conditions other than normal; when it was not operated in accordance with the instructive; was altered or repaired by personnel not authorized by TRUPER®. To make the warranty valid, present the product, stamped policy or invoice or receipt or voucher, in the establishment where you bought it or in Corregidora 35, Centro, Cuauhtémoc, CDMX, 06060, where you can also purchase parts, components, consumables and accessories. It includes the costs of transportation of the product that derive from its fulfillment of its service network. Phone number 800-018-7873. Made in China. Imported by TRUPER, S.A. de C.V. Parque Industrial 1, Parque Industrial Jilotepec, Jilotepec, Edo. de Méx. C.P. 54257, Phone number 761 782 9100.</p>		



Stamp of the business. Delivery date: