

## Manual Benchtop jointer

1 500 W  
**2 Hp**

Applies for:

Code	Model
102973	CANT-6B

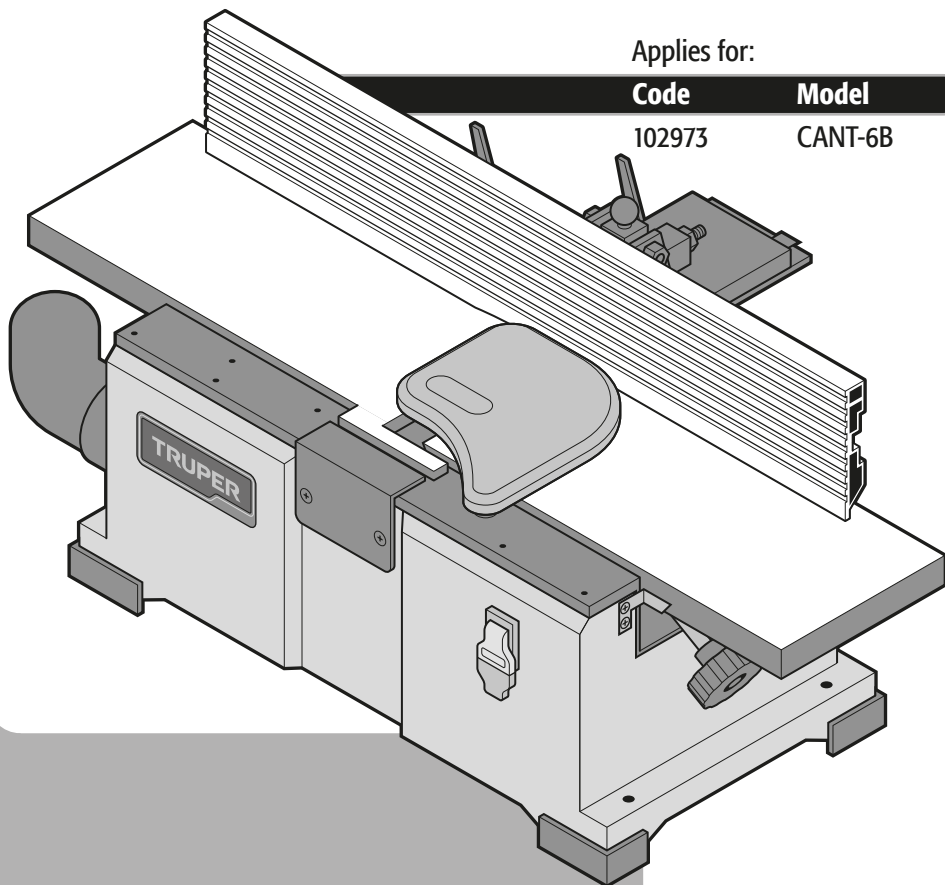

# CANT-6B



Read this manual thoroughly  
before using the tool.



Technical data .....	<b>3</b>
Electrical requirements .....	<b>3</b>
 General safety warnings for power tools .....	<b>4</b>
 Safety warnings for the use of jointers .....	<b>5</b>
Parts list .....	<b>6</b>
Assembly .....	<b>7</b>
Parts .....	<b>10</b>
Adjustments .....	<b>11</b>
Start-up .....	<b>14</b>
Maintenance .....	<b>15</b>
Notes .....	<b>16</b>
Authorized Service Centers .....	<b>17</b>
Warranty Policy .....	<b>18</b>

## **CAUTION**

To gain the best performance of the tool, prolong the duty life, make the Warranty valid if necessary, and to avoid hazards of fatal injuries please read and understand this Manual before using the tool.

Keep this manual for future references.

The illustrations in this manual are for reference only. They might be different from the real tool.

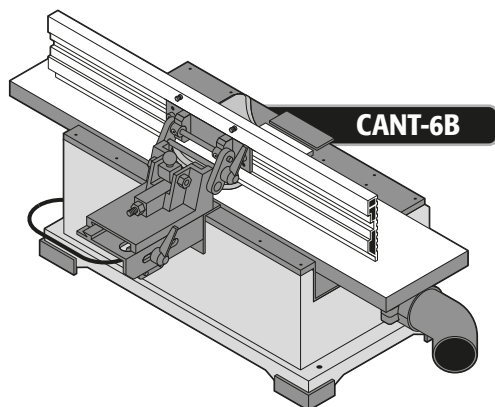

## CANT-6B

Code	102973
Description	Benchtop jointer
Voltage	127 V~
Current	12 A
Frequency	60 Hz
No-load speed	20 000 RPM
Cutting head speed	10 000 RPM
Weight	61.7 lb
Dimensions	Length: 28 1/2"   Width: 6"   Height: 8"
Duty cycle	120 minutes of work per 30 minutes of rest. Maximum daily 6 hours
Conductors	16 AWG x 3C with an insulation temperature of 221 °F
Insulation	Class I
	IP Grade IP20

The power cord has Y-type cable clips.  
The construction class of the tool is Basic Insulation.  
The thermal insulation class of the motor windings is Class B.

**⚠ WARNING** Avoid the risk of electric shock or severe injury. When the power cable gets damaged it should only be replaced by the manufacturer or at a  **TRUPER** Authorized Service Center. The build quality of the electric insulation is altered if spills or liquid gets into the tool while in use. Do not expose to rain, liquids and/or dampness.

**⚠ WARNING** Before gaining access to the terminals all power sources should be disconnected.



## Power requirements

**⚠ WARNING** To prevent electric shock, the tool shall be grounded while in use. • Connect the plug into a correctly grounded outlet as shown in example A. Not all the outlets are properly grounded. If in doubt, verify with a qualified electrician. • If the outlet where you will connect the tool has two poles (2 orifices). **UNDER ANY CIRCUMSTANCE, DO NOT REMOVE OR ALTER THE PLUG'S GROUND CONNECTOR.** Use a temporary adaptor as shown in example B and always connect the ground conductor lug as shown.

**⚠ CAUTION** When using an extension cord, make sure to use the appropriate gauge to carry the current your tool will consume. A lower gauge cord will cause voltage drops in the line, resulting in power loss and motor overheating. The following table shows the correct size to be used depending on the cable length and amperage capacity indicated on the tool's data plate. If in doubt, use the next higher gauge.

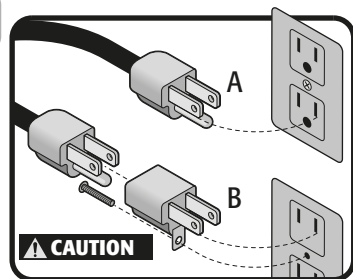

Ampere Capacity	Number of Conductors	Extension Gauge	
		From 6 ft to 49 ft	Higher than 49 ft
From 0 and up to 10 A	3 (one grounded)	18 AWG	16 AWG
From 10 and up to 13 A		16 AWG	14 AWG
From 13 and up to 15 A		14 AWG	12 AWG
From 15 and up to 20 A		8 AWG	6 AWG

\* It is allowed to use it if the extensions themselves have an overcurrent protection device.

AWG = American Wire Gauge. Reference: NMX-J-195-ANCE

**⚠ WARNING** When using power tools outdoors use a  **VOLTECK** grounded extension cable labeled "Outdoors Use". These extension cables are specially manufactured for outdoors use and reduce the risk of electric shock.





## General power tool safety warnings



**⚠ WARNING! Read carefully all safety warnings and instructions listed below.** Failure to comply with any of these warnings may result in electric shock, fire and / or severe damage. **Save all warnings and instructions for future references.**

### Work area

**Keep your work area clean, and well lit.**

Cluttered and dark areas may cause accidents.



**Never use the tool in explosive atmospheres, such as in the presence of flammable liquids, gases or dust.**

Sparks generated by power tools may ignite the flammable material.



**Keep children and bystanders at a safe distance while operating the tool.**

Distractions may cause losing control.



### Electrical Safety

**The tool plug must match the power outlet. Never modify the plug in any way. Do not use any adapter plugs with grounded power tools.**

Modified plugs and different power outlets increase the risk of electric shock.



**Avoid body contact with grounded surfaces, such as pipes, radiators, electric ranges and refrigerators.**

The risk of electric shock increases if your body is grounded.

**Do not expose the tool to rain or wet conditions.**

Water entering into the tool increases the risk of electric shock.

**Do not force the cord. Never use the cord to carry, lift or unplug the tool. Keep the cord away from heat, oil, sharp edges or moving parts.**

Damaged or entangled cords increase the risk of electric shock.

**When operating a tool outdoors, use an extension cord suitable for outdoor use.**

Using an adequate outdoor extension cord reduces the risk of electric shock.

**If operating the tool in a damp location cannot be avoided, use a ground fault circuit interrupter (GFCI) protected supply.**

Using a GFCI reduces the risk of electric shock.

### Personal safety

**Stay alert, watch what you are doing and use common sense when operating a tool. Do not use a power tool while you are tired or under the influence of drugs, alcohol or medication.**

A moment of distraction while operating the tool may result in personal injury.

**Use personal protective equipment. Always wear eye protection.**

Protective equipment such as safety glasses, anti-dust mask, non-skid shoes, hard hats and hearing protection used in the right conditions significantly reduce personal injury.



**Prevent unintentional starting up. Ensure the switch is in the "OFF" position before connecting into the power source and / or battery as well as when carrying the tool.**

Transporting power tools with the finger on the switch or connecting power tools with the switch in the "ON" position may cause accidents.

**Remove any wrench or vice before turning the power tool on.**

Wrenches or vices left attached to rotating parts of the tool may result in personal injury.

**Do not overreach. Keep proper footing and balance at all times.**

This enables a better control on the tool during unexpected situations.

**Dress properly. Do not wear loose clothing or jewelry. Keep hair, clothes and gloves away from the moving parts.**

Loose clothes, jewelry or long hair may get caught in moving parts.



**If you have dust extraction and recollection devices connected onto the tool, inspect their connections and use them correctly.**

Using these devices reduce dust-related risks.

### Power Tools Use and Care

**Do not force the tool. Use the adequate tool for your application.**

The correct tool delivers a better and safer job at the rate for which it was designed.



**Do not use the tool if the switch is not working properly.**

Any power tool that cannot be turned ON or OFF is dangerous and should be repaired before operating.

**Disconnect the tool from the power source and / or battery before making any adjustments, changing accessories or storing.**

These measures reduce the risk of accidentally starting the tool.

**Store tools out of the reach of children. Do not allow persons that are not familiar with the tool or its instructions to operate the tool.**

Power tools are dangerous in the hands of untrained users.



**Service the tool. Check the mobile parts are not misaligned or stuck. There should not be broken parts or other conditions that may affect its operation. Repair any damage before using the tool.**

Most accidents are caused due to poor maintenance to the tools.



**Keep the cutting accessories sharp and clean.**

Cutting accessories in good working conditions are less likely to bind and are easier to control.

**Use the tool, components and accessories in accordance with these instructions and the projected way to use it for the type of tool when in adequate working conditions.**

Using the tool for applications different from those it was designed for, could result in a hazardous situation.

### Service

**Repair the tool in a TRUPER Authorized Service Center using only identical spare parts.**

This will ensure that the safety of the power tool is maintained.

**Children or people with reduced physical, sensory or mental capabilities shall not operate the tool, neither inexperienced people or without knowledge in the use of the tool, unless supervised by a person responsible of their safety or if receiving previous instructions about the tool operation.**

Children shall be kept under supervision to double-check they will not play with the tool. Tight supervision shall be used with children or disabled persons to prevent from using or being close to any household tool.



# Safety warnings for jointers



## Before operating the jointer

- CAUTION** • Seek for training from a qualified operator familiar with the tool and its functioning.
- CAUTION** • Do not operate the jointer until completely assembled and installed according to the instructions.
- Keep the cutter head well honed, free of oxide and resins. The screws shall be tightened.
- CAUTION** • Before starting the tool, double-check the cutter head guard is not damaged and it operates with no obstructions.
- CAUTION** • Double check the exposed side of the cutter head behind the rip fence is covered, especially when working near the edge.

## While operating the jointer

- WARNING** • Never make edging or planning operations if the cutter head protective guard is not in place.
  - Verify the height of the in feed table and out feed table is blocked before turning on he tool.
  - Never start the jointer with the workpiece making contact with the cutter head.
  - CAUTION** • Always hold firmly the work piece against the worktables and the rip fence to guide and support the piece correctly. Never make any operation with your bare hands. Support all the time the work piece correctly. Keep control of the job at all times.
  - CAUTION** • Do not return the work piece trough the in feed table.
  - WARNING** • Avoid making strange operations and hands positions that suddenly could make you touch de cutter head. DO NOT try to make abnormal or small operations without studying beforehand and using an adequate support block.
  - Keep an adequate relationship of the in feed table and the out feed table with the cutter head.
  - Always use blocks or push poles (A) to edge materials smaller than 3" in height or plan materials lower than 3" thick.
  - DO NOT edge materials smaller than 10" long, 3/4" narrow or 1/2" thick.
  - DO NOT make any edging or leveling operation in materials smaller than 10" long, narrower than 3/4" ; wider than 6" or thinner than 1/2"
  - DO NOT edge or plane cuts deeper than 1/8".
- In cuts larger than 1 1/2" width, adjust cutting depth to 1/16" or less to prevent overheating the machine and to minimize the possibility of kickback (that the tool reverses against the operator).

## Additional caution measures

- WARNING** • DO NOT ASSEMBLE the tool until you double-check it is not connected and the power switch is in the "O" position.
- WARNING** • DO NOT CONNECT the tool to the power source until it is completely assembled and you have read and understood the Manual.
- Only people with the experience, knowledge and trained to work with wood in stationary machines shall be allowed to use it.
- Wear anti-dust mask to reduce the risk of inhaling dangerous dust.
- Wear hearing protection.
- When running the machine may send debris toward the eyes causing severe damage. Wear safety glasses that comply the ANSI Z87.1. Standard.
- Use care when manipulating the cutting discs when they are inside or out of the tool. To prevent cuts wear gloves.
- Do not try to remove woodchips while the cutter head is moving and the tool is ON.
- Do not stand on top of the tool.
- In order to service the tool there shall be enough space around it and the cabinets need to function properly.
- The final user shall provide an over-current protection device.



## Unpacking

- The Jointer and its cabinet are shipped in two packages. Carefully unpack the Jointer, the cabinet and all the small parts in each of the packages.
- CAUTION** • The Jointer is extremely heavy. At least two persons are needed to lift or carry it.
- Remove the protective layer from the table surface and all the parts that are not painted. This layer can be removed with a soft cloth wet with kerosene (do not use acetone, gasoline or thinner for this purpose).
- After cleaning it cover the table surface with a good quality wax paste. Extend the wax perfectly on the worktable to prevent friction with the work piece.

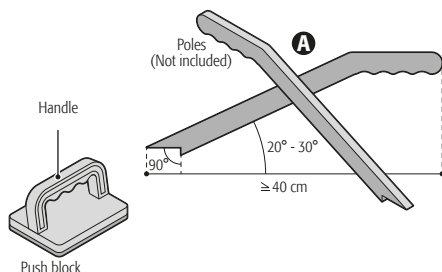

- Unpack the equipment and check for any damage during transport.
- Clearly identify the individual parts as shown in the parts list.

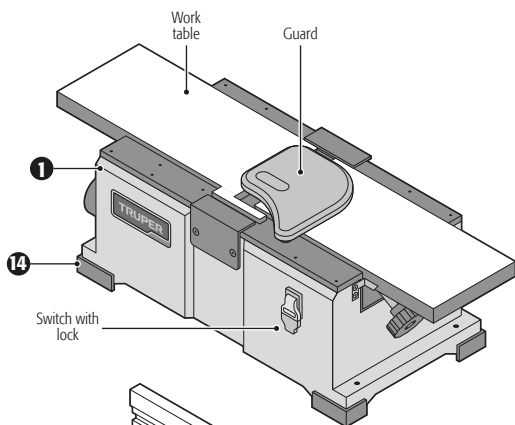

1. Benchtop jointer.
2. Fence guide.
3. Limit block.
4. Fence guide hinge.
5. Fence guide bracket.
6. Locking plate.
7. Depth locking lever.
8. Angle locking lever.
9. Dust extraction system connector.
10. Dust collection bag.
11. Push blocks (2).
12. Torx key.
13. Allen key.
14. Anti-vibration pads.

Screws for component assembly:

15. M8 screws (2)
16. 8 mm lock washers (2)
17. M6 screws (2)
18. 6 mm lock washers (2)

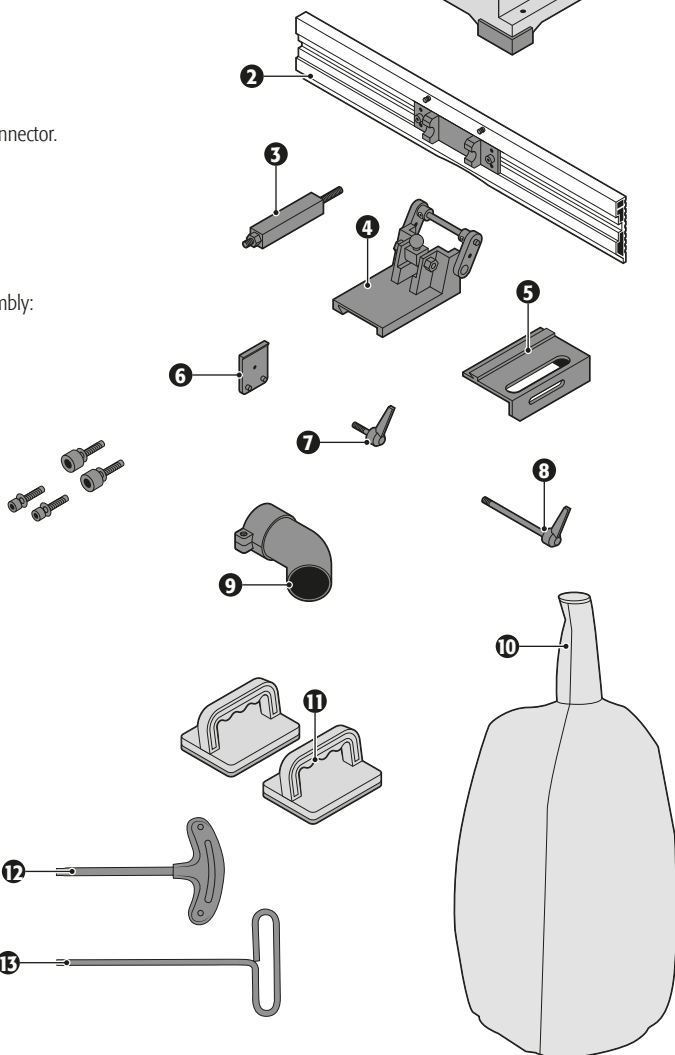

- Assemble the equipment in the location where it will be operated, on a well-leveled and weight-capable stand or base. The area should have good lighting and ventilation.
- The equipment includes all the necessary screws for assembly, as well as a set of Allen and Torx keys in the required sizes for assembly.

## Mounting to the workbench

- The equipment's base has mounting holes that allow you to secure it to a workbench or another mounting surface to prevent it from moving during operation and causing injuries or accidental damage.
- Drill holes in the workbench that align with the equipment's mounting holes.
- Use hexagonal bolts, washers, and hexagonal nuts to secure the machine in place, as shown in the diagram (not included).

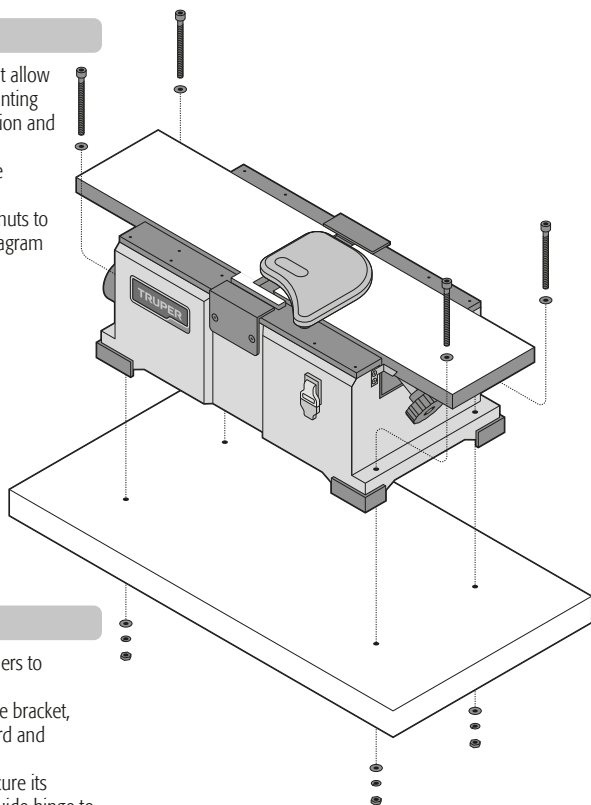

## Fence guide bracket

- Use two M8 head screws and 8 mm lock washers to secure the fence guide bracket to the edger (**A**).
- Insert the locking plate (**B**) into the fence guide bracket, positioning it so that both pins are facing outward and below the bracket.
- Place the locking lever (**C**) and tighten it to secure its position, but not too tightly to allow the fence guide hinge to slide easily when mounting it (page 8).

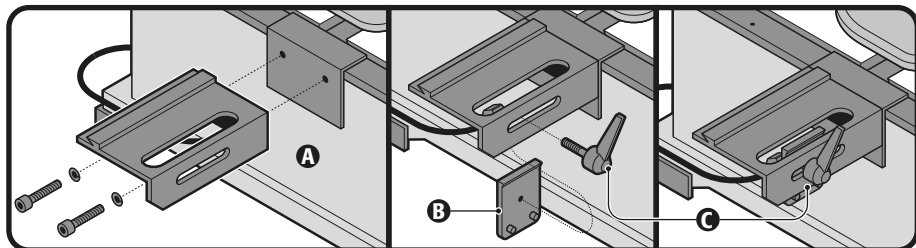

**Fence guide hinge**

- Slide the hinge assembly into the base of the fence guide **(A)**. Ensure that the assembly fits into the dovetail on the base and the locking plate.

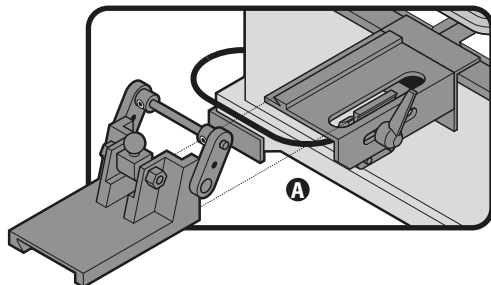

- Push the hinge pin **(B)** to insert the limit block **(C)** with the notched side facing up.
- Place the angle locking lever **(D)** on the hinge without tightening it.

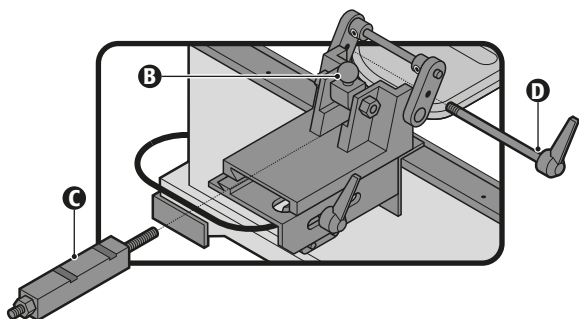

## Fence guide

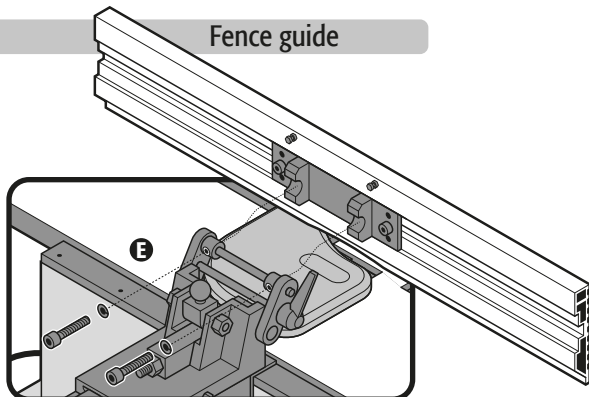

- Use two M6 head screws and two 6 mm lock washers to attach the fence guide to the hinge (E).

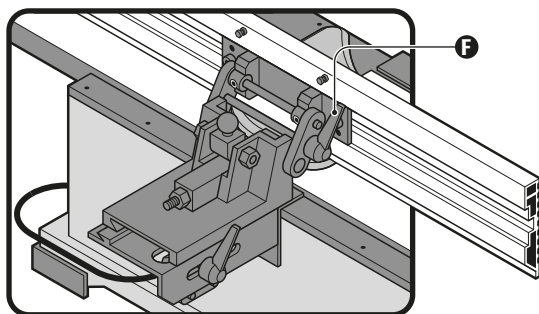

- Adjust the guide to be at 90° and tighten the angle locking lever (F).
- Slide the guide forward until it makes contact with the cutting head guard (G).

**CAUTION** The guard should completely cover the cutting head.

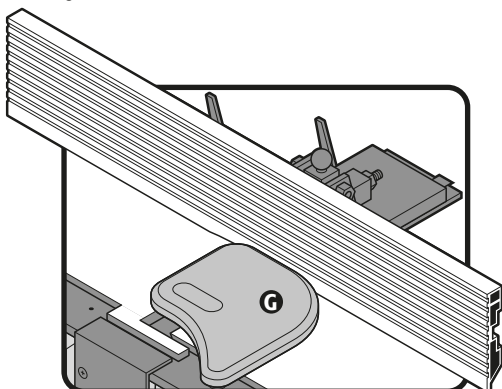

## Dust extraction system connector

- Place the Dust Extraction System Connector on the dust outlet port (H).
- Rotate the duct to direct the extraction in the most convenient direction and tighten the screw to secure the duct's position. The dust collection bag can be attached to the duct outlet.

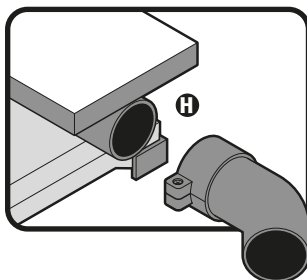

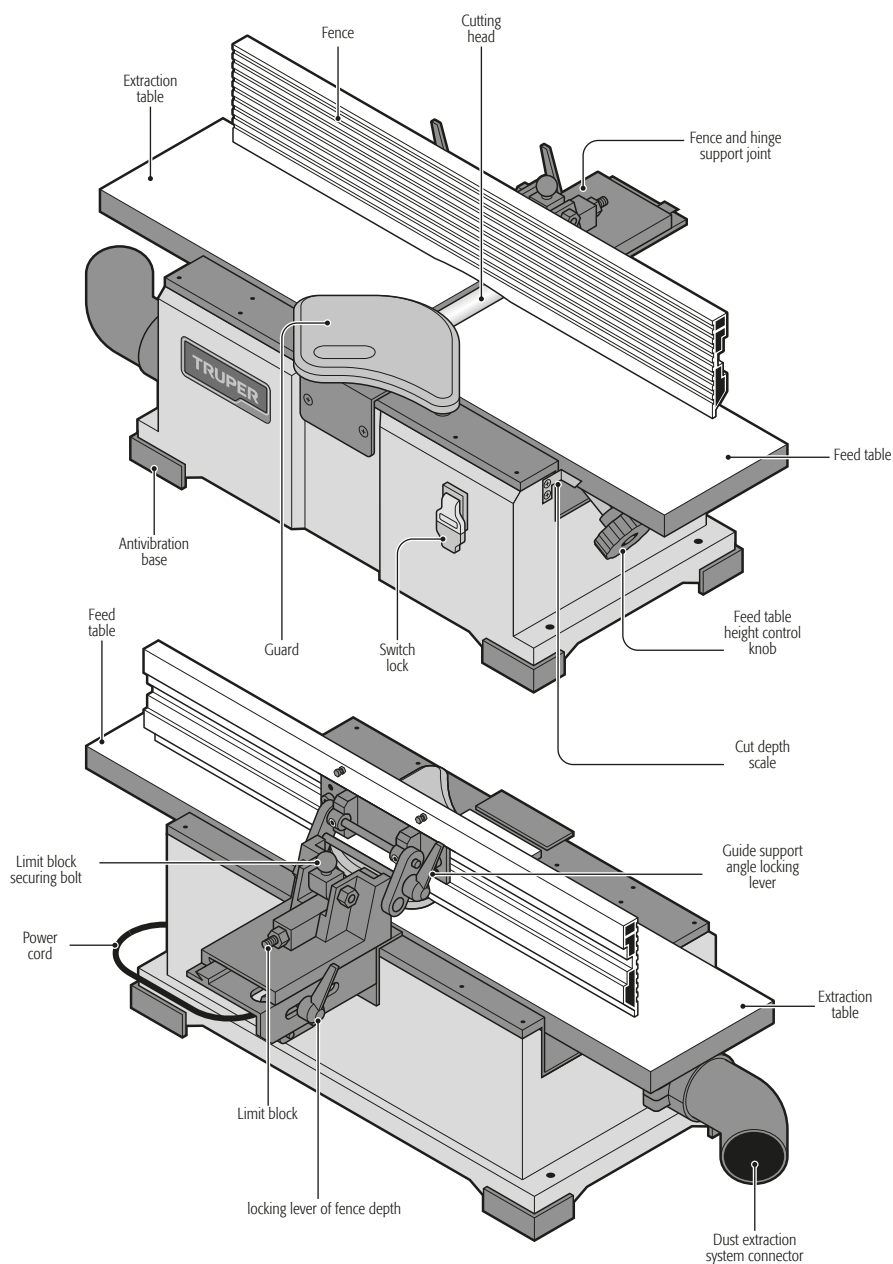

## Feed table height

- To adjust the height of the feed table, turn the feed table adjustment knob **(A)** to raise or lower the table.
- To determine the table height, check the depth scale **(B)**.

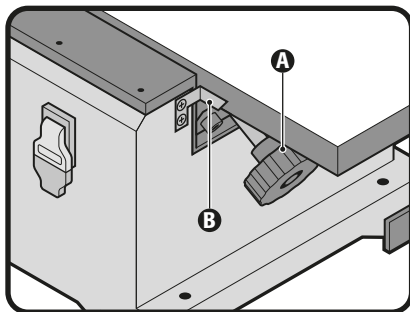

## Feed table height stop

- When turning the knob to raise the feed table, it stops when it reaches the height of the extraction table, preventing the cutting head from making a cut (zero depth).
- The stop is factory calibrated, but in case of misalignment:
- Place a ruler on top of the extraction table to check when both tables contact the ruler along their entire length.
- Turn the knob to raise or lower the feed table until it is as closely aligned with the extraction table as possible.
- Loosen the nut **(C)** to adjust the stop screw **(D)**.
- Turn the stop screw until both tables are perfectly aligned.
- Tighten the nut **(C)** after making the adjustment.

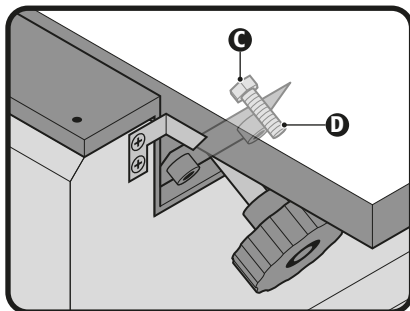

## Blade adjustment

**⚠ ATENCIÓN** • To ensure accurate edging and prevent defective work, the blades must be perfectly aligned and leveled with the surface of the extraction table.

- Before adjusting the blades, remove the cutting head guard and lower the feed table as indicated above.
- Place a steel ruler on the extraction table and the cutting head to check the height of the blades at their highest point in the cutting head's rotation.
- Turn the cutting head by hand to verify that all blades lightly touch the ruler without lifting it from the extraction table (A).

**⚠ WARNING** • Use gloves when handling the cutting head by hand, or you risk serious injuries. Check the blade height at various points along the blade.

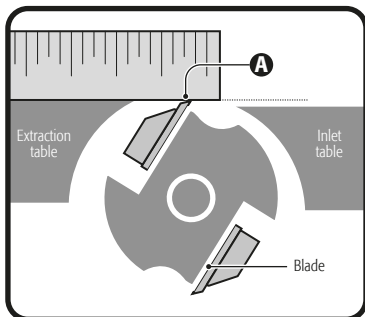

- If the blades push against the ruler or fail to touch it, their height needs to be adjusted.
- Slightly loosen the four screws (B) using the included wrench in a clockwise direction.
- Adjust the blade height by turning the elevation screws (C) with one of the included Allen keys. Clockwise rotation raises the blade, and counterclockwise rotation lowers it.

**⚠ CAUTION** • If it's necessary to lower the blade, a piece of wood should be used to push it down after turning the screws (C).

**⚠ CAUTION** • Immediately tighten the four screws (B) after making the adjustment.

- Follow the same procedure for the rest of the blades, complete the adjustment of each blade before attempting to adjust the others.

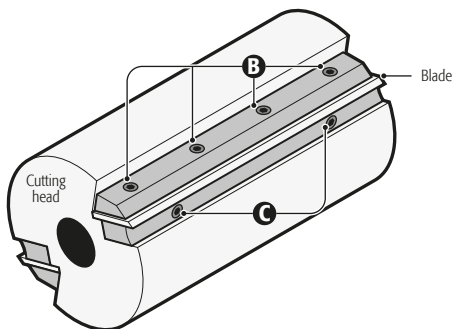

## Fence guide stops adjustment

• The fence guide tilting system has stops for quickly selecting angles of  $\pm 45^\circ$  and  $90^\circ$ . Use a combination square to check them. If the angles are incorrect, you can adjust the stops.

• **90° Stop:** Push the knob (C) forward and pull the limit block to secure it in its first slot (D). Position the fence guide at  $90^\circ$  until it contacts the limit block stop (E).

• If the angle of the fence guide is not  $90^\circ$ , loosen the safety nut (F). Turn the screw (G) until the fence guide is at  $90^\circ$ . Tighten the safety nut (F).

• **-45° Stop:** Push the knob (C) forward and push the limit block to secure it in its second slot (H). Position the fence guide at  $-45^\circ$  until it contacts the limit block stop (E).

• If the angle of the table is not  $-45^\circ$ , loosen the safety nut (F). Turn the screw (G) until the fence guide is at  $-45^\circ$ . Tighten the safety nut (F).

• **+45° Stop:** Position the fence guide at  $+45^\circ$  until the stop screws (I) contact the support of the fence guide.

• If the angle of the table is not  $-45^\circ$ , loosen the safety nuts of the screws. Turn the stop screws until the fence guide is at  $45^\circ$ . Tighten the safety nuts.

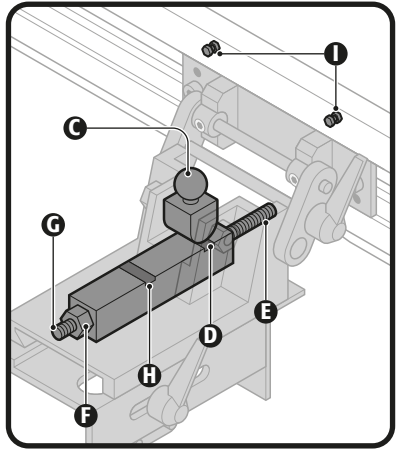

## Fence guide verification

• The fence guide can be moved forward or backward along the work tables and/or adjusted to  $\pm 45^\circ$ , depending on the requirements of the task.

• To move the fence guide forward or backward, loosen the clamp (A), slide it to the desired position, and then tighten the clamp.

• To change the angle of the fence guide, loosen the lever (B) while holding the fence guide at the desired angle. It is recommended to use a combination square to achieve the exact angle. Tighten the lever (B) before starting the task.

• Be cautious when holding the workpiece

**CAUTION** • Be cautious when holding the workpiece at an angle other than  $90^\circ$ , as it is more challenging to hold it at this angle than at an angle less than  $90^\circ$ . Take this into account to prevent accidents.

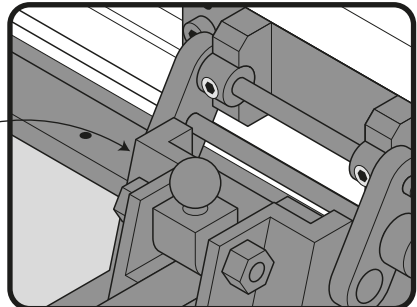
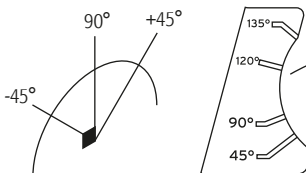
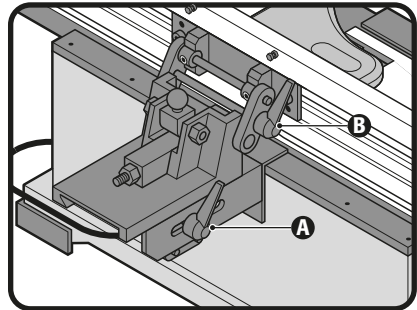

## Power On

- Plug the jointer to the power outlet.
- Lift the lever to turn on the jointer.
- Lower the lever to turn off the jointer.
- To prevent accidental starts, remove the key to disable the switch.

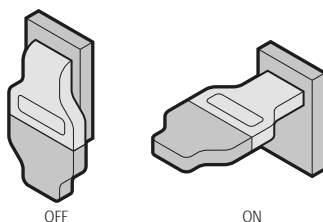

## Workpiece

- Do not work with pieces that are smaller than those indicated in diagram (E)
- If working with curved or uneven material, make light cuts until the piece is flat and aligned. Do not force the piece against the table.
- Always feed the material with the wood grain pointing toward the cutting head. Do not feed the material with the wood grain parallel to the cutting head, or the piece will splinter.

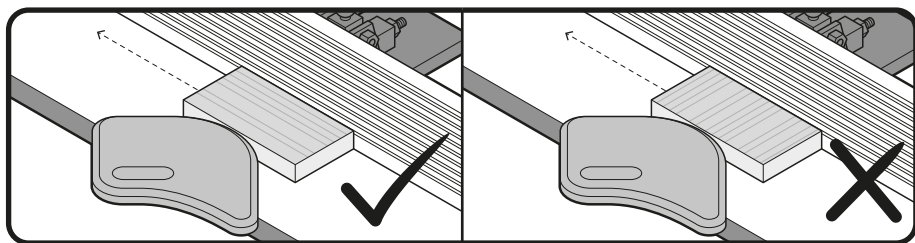
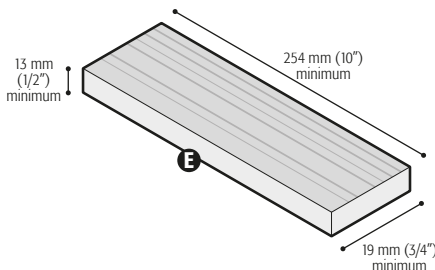

## Operation

- Before working the final piece, use scrap material to get familiar in the use of the jointer.
- ⚠ **CAUTION** • Remember keeping your hands away from the cutter head. Use the cutter head guard and using push blocks or poles to push the material towards the cutter head.
- Once all the adjustments are performed in the jointer start the edging or planing job.
- Start the jointer (see page 14) and wait until it reaches its full speed to start working.
- Set the work piece onto the in feed table and rip fence. Push the work piece towards the cutter head. The piece will make contact with the guard and will push it aside to make contact with the blade. Continue pushing the piece while applying pressure down on the side of the piece resting onto the extraction table. Keep pushing until the work piece is completely set onto the out feed table and the guard returns to its place.

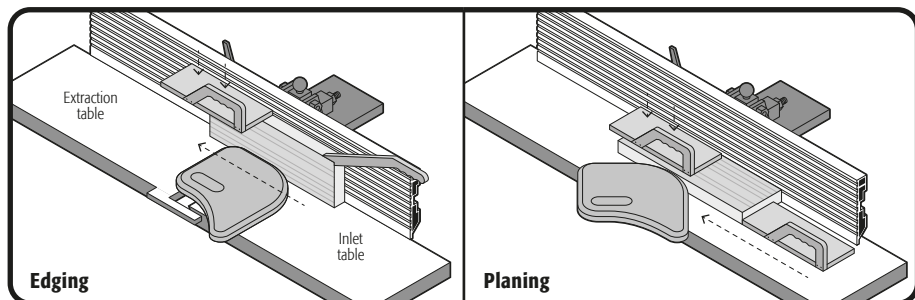

- Any repair or maintenance must be carried out exclusively at a TRUPER Authorized Service Center.
- It is recommended to take the equipment for maintenance once a year for the inspection of components such as brushes, bearings, etc.

## Cleaning

- Keep the interior of the cabinet free of sawdust and wood dust. Disconnect the edge planner. Vacuum the inside of the cabinet or blow with an air hose.
- Double-check not to use air pressure not higher than 344.7 kPa (50 PSI) since the air pressure may damage insulating.
- The jointer mechanisms can be cleaned with a strong brush.
- Tar or resin accumulation shall be cleaned with a solvent like turpentine or mineral alcohol, a strong wire brush and steel fiber.

## Blade replacement

- Move the rip extraction table until it stops and remove the guard to uncover the cutter head.
- Loosen the screws (A) to remove the blade and the counter-blade.
- Turn the lifting screws (C) counterclockwise until they stop.
- Follow the same mechanism to remove the remaining two sets of blades and counter-blades.
- Before replacing blades double-check the counter-blades are completely clean and free of gum or resin.
- Set the counter-blades and blades inside the cutter head slots.
- Push the blades down as much as possible using a piece of wood and tighten the screws (A).
- Adjust the blades according to the instructions on page 12 "Blade Adjustment".

## Honing the blades

- After a long period of use the blades can get dull.
- hone the worn blades assembled in the cutter head to prevent the blades loose alignment.
- Cover the in feed table with paper to prevent damages. Lower it.
- Move the cutter head until the bevel in the blade is aligned with the table surface.
- With silica carbide stone hone the blade manually. Use the previously protected with paper in feed table as a guide.

## Carbon brush replacement

- The carbon brushes should be periodically checked and replaced by an Authorized Truper Service Center when worn out. After replacement, request an inspection to ensure that the new carbon brushes can move freely in the brush holder and ask them to run the tool for 15 minutes to seat the carbon brush contact and the commutator.
  - Only original replacement carbon brushes designed specifically for each motor type, with the appropriate hardness and electrical resistance, should be used. Carbon brushes that do not meet specifications can damage the motor.
- When changing carbon brushes, both carbon brushes must be replaced.

## Tables surface

- The table surface is made of unfinished metal. With the passing of time it accumulates oxide when not serviced. When using a brush apply a thin layer of WD-40 to prevent oxidation.
- If oxide has accumulated already on the table surface, use WD-40 and a fine wire flannel to remove it.
- A good preventive measure to prevent the setting of oxide is using quality wax paste onto the table surface.

## Lubrication

- The jointer is built with sealed bearings into the motor housing and also into the assembly on the disc center therefore it needs no additional lubrication.

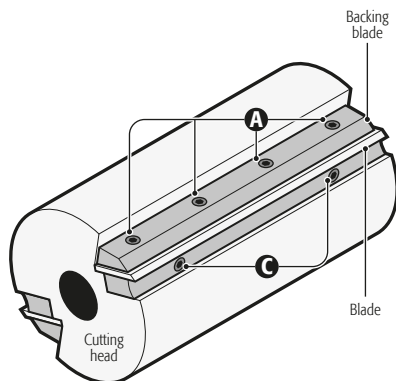



In the event of any problem contacting a Truper Authorized Service Center, please see our webpage [www.truper.com](http://www.truper.com) to get an updated list, or call our toll-free numbers **800 690-6990** or **800-018-7873** to get information about the nearest Service Center.

**AGUASCALIENTES** **DE TODO PARA LA CONSTRUCCIÓN**  
GRAL. BARRAGÁN #1201, COL. GREMIAL, C.P. 20030,  
AGUASCALIENTES, AGS. TEL.: 449 994 0537

**BAJA CALIFORNIA** **SUCURSAL TIJUANA**  
AV. LA ENCANTADA, LOTE #5, PARQUE INDUSTRIAL EL  
FLORIDO II, C.P. 2244, TIJUANA, B.C.  
TEL.: 664 969 5100

**BAJA CALIFORNIA SUR** **FIX FERRETERÍAS**  
FELIPE ÁNGELES ESQ. RUIZ CORTÍNEZ S/N, COL. PUEBLO  
NUEVO, C.P. 23670, CD. CONSTITUCIÓN, B.C.S.  
TEL.: 613 132 1115

**CAMPECHE** **TORNILLERÍA Y FERRETERÍA AAA**  
AV. ÁLVARO OBREGÓN #324, COL. ESPERANZA  
C.P. 24080 CAMPECHE, CAMP. TEL.: 981 815 2808

**CHIAPAS** **FIX FERRETERÍAS**  
AV. CENTRAL SUR #27, COL. CENTRO, C.P. 30700,  
TAPACHULA, CHIS. TEL.: 962 118 4083

**CHIHUAHUA** **SUCURSAL CHIHUAHUA**  
AV. SILVESTRE TERRAZAS #128-11, PARQUE INDUSTRIAL  
BAFAR, CARRETERA MÉXICO CUAUHTÉMOC, C.P. 31415,  
CHIHUAHUA, CHIH. TEL.: 614 434 0052

**MEXICO CITY** **FIX FERRETERÍAS**  
EL MONSTRUO DE CORREGIDORA, CORREGIDORA # 35,  
COL. CENTRO, C.P. 06060, CUAUHTÉMOC, CDMX.  
TEL.: 55 5522 5031 / 5522 4861

**COAHUILA** **SUCURSAL TORREÓN**  
CALLE METAL MECÁNICA #280, PARQUE INDUSTRIAL  
ORIENTE, C.P. 27278, TORREÓN, COAH.  
TEL.: 871 209 68 23

**COLIMA** **BOMBAS Y MOTORES BYMTESA DE MANZANILLO**  
BLVD. MIGUEL DE LA MADRID #190, COL. 16 DE  
SEPTIEMBRE, C.P. 28239, MANZANILLO, COL.  
TEL.: 314 332 1986 / 332 8013

**DURANGO** **TORNILLOS ÁGUILA, S.A. DE C.V.**  
MAZURIO #200, COL. LUIS ECHEVERRÍA, DURANGO,  
DGO. TEL.: 618 817 1946 / 618 818 2844

**ESTADO DE MÉXICO** **SUCURSAL CENTRO JILOTEPEC**  
PARQUE INDUSTRIAL # 1, COL. PARQUE INDUSTRIAL  
JILOTEPEC, JILOTEPEC, EDO. DE MÉX. C.P. 54257  
TEL.: 761 782 9101 EXT. 5728 Y 5102

**GUANAJUATO** **CÍA. FERRETERA NUEVO MUNDO S.A. DE C.V.**  
AV. MÉXICO - JAPÓN #225, CD. INDUSTRIAL, C.P. 38010,  
CELAYA, GTO. TEL.: 461 617 7578 / 79 / 80 / 88

**GUERRERO** **CENTRO DE SERVICIO ECLIPSE**  
CALLE PRINCIPAL MZ 1 LT. 1, COL. SANTA FE, C.P. 39010,  
CHILPANCIÑO, GRO. TEL.: 747 478 5793

**HIDALGO** **FERREPRECIOS S.A. DE C.V.**  
LIBERTAD ORIENTE #304 LOCAL 50, INTERIOR DE PASAJE  
ROBLEDO, COL. CENTRO, C.P. 43600, TULANCINGO,  
HGO. TEL.: 775 753 6615 / 775 753 6616

**JALISCO** **SUCURSAL GUADALAJARA**  
AV. ADOLFO B. HORN # 6800, COL: SANTA CRUZ DEL  
VALLE, C.P.: 45655, TLAJOMULCO DE ZUÑIGA, JAL.  
TEL.: 33 3606 5285 AL 90

**MICHOACÁN** **FIX FERRETERÍAS**  
AV. PASEO DE LA REPÚBLICA #3140-A, COL.  
EX-HACIENDA DE LA HUERTA, C.P. 58050, MORELIA,  
MICH. TEL.: 443 334 6858

**MORELOS** **FIX FERRETERÍAS**  
CAPITÁN ANZÚRES #95, ESQ. JOSÉ PERDIZ, COL.  
CENTRO, C.P. 62740, CUAUTLA, MOR.  
TEL.: 735 352 8931

**NAYARIT** **HERRAMIENTAS DE TEPIC**  
MAZATLÁN #117, COL. CENTRO, C.P. 63000, TEPIC, NAY.  
TEL.: 311 258 0540

**NUEVO LEÓN** **SUCURSAL MONTERREY**  
CARRETERA LAREDO #300, 1B MONTERREY PARKS,  
COLONIA PUERTA DE ANAHUAC, C.P. 66052, ESCOBEDO,  
NUEVO LEÓN, TEL.: 81 8352 8791 / 81 8352 8790

**OAXACA** **FIX FERRETERÍAS**  
AV. 20 DE NOVIEMBRE #910, COL. CENTRO, C.P. 68300,  
TUXTEPEC, OAX. TEL.: 287 106 5092

**PUEBLA** **SUCURSAL PUEBLA**  
AV. PERIFÉRICO #2-A, SAN LORENZO ALMECATLA,  
C.P. 72710, CUAUHTLACINGO, PUE.  
TEL.: 222 282 8282 / 84 / 85 / 86

**QUERÉTARO** **ARU HERRAMIENTAS S.A. DE C.V.**  
AV. PUERTO DE VERACRUZ #110, COL. RANCHO DE  
ENMEDIO, C.P. 76842, SAN JUAN DEL RÍO, QRO.  
TEL.: 427 268 4544

**QUINTANA ROO** **FIX FERRETERÍAS**  
CARRETERA FEDERAL MZ. 46 LT. 3 LOCAL 2, COL. EJIDAL,  
C.P. 77710 PLAYA DEL CARMEN, Q.R.  
TEL.: 984 267 3140

**SAN LUIS POTOSÍ** **FIX FERRETERÍAS**  
AV. UNIVERSIDAD #1850, COL. EL PASEO, C.P. 78320,  
SAN LUIS POTOSÍ, S.L.P. TEL.: 444 822 4341

**SINALOA** **SUCURSAL CULIACÁN**  
AV. JESÚS KUMATE SUR #4301, COL. HACIENDA DE LA  
MORA, C.P. 80143, CULIACÁN, SIN.  
TEL.: 667 173 9139 / 173 8400

**SONORA** **FIX FERRETERÍAS**  
CALLE 5 DE FEBRERO #517, SUR LT. 25 MZ. 10, COL.  
CENTRO, C.P. 85000, CD. OBREGÓN, SON.  
TEL.: 644 413 2392

**TABASCO** **SUCURSAL VILLAHERMOSA**  
CALLE HELIO LOTES 1, 2 Y 3 MZ. #1, COL. INDUSTRIAL,  
2A ETAPA, C.P. 86010, VILLAHERMOSA, TAB.  
TEL.: 993 355 7244

**TAMAULIPAS** **VM ORINGS Y REFACCIONES**  
CALLE ROSITA #527 ENTRE 20 DE NOVIEMBRE Y GRAL.  
RODRÍGUEZ, FRACC. REYNOSA, C.P. 88780, REYNOSA,  
TAMS. TEL.: 899 926 7552

**TLAXCALA** **SERVICIOS Y HERRAMIENTAS INDUSTRIALES**  
PABLO SIDAR #132, COL. BARRIO DE SAN BARTOLOMÉ,  
C.P. 90970, SAN PABLO DEL MONTE, TLAX.  
TEL.: 222 271 7502

**VERACRUZ** **LA CASA DISTRIBUIDORA TRUPER**  
BLVD. PRIMAVERA ESQ. HORTENSIA S/N, COL.  
PRIMAVERA C.P. 93308, POZA RICA, VER.  
TEL.: 782 823 8100 / 826 8484

**YUCATÁN** **SUCURSAL MÉRIDA**  
CALLE 33 #600 Y 602, LOCALIDAD ITZINCAB Y Mulsay,  
MPIO. UMAN, C.P. 97390, MÉRIDA, YUC.  
TEL.: 999 912 2451

Code	Model	Brand
102973	CANT-6B	 <b>TRUPER®</b>

**Warranty.** Duration: 1 year. Coverage: parts, components and workmanship against manufacturing or operating defects, except if used under conditions other than normal; when it was not operated in accordance with the instructive; was altered or repaired by personnel not authorized by **Truper®**. To make the warranty valid, present the product, stamped policy or invoice or receipt or voucher, in the establishment where you bought it or in Corregidora 35, Centro, Cuauhtémoc, CDMX, 06060, where you can also purchase parts, components, consumables and accessories. It includes the costs of transportation of the product that derive from its fulfillment of its service network. Phone number **800-018-7873**. Made in China. Imported by Truper, S.A. de C.V. Parque Industrial 1, Parque Industrial Jilotepec, Jilotepec, Edo. de Méx. C.P. 54257, Phone number 761 782 9100.

Stamp of the business. Delivery date:

