

## Manual Circular saw

**13 A**  
Power

**7-1/4"**  
Blade

Applies for

Code	Model
11004	SICI-7-1/4A3

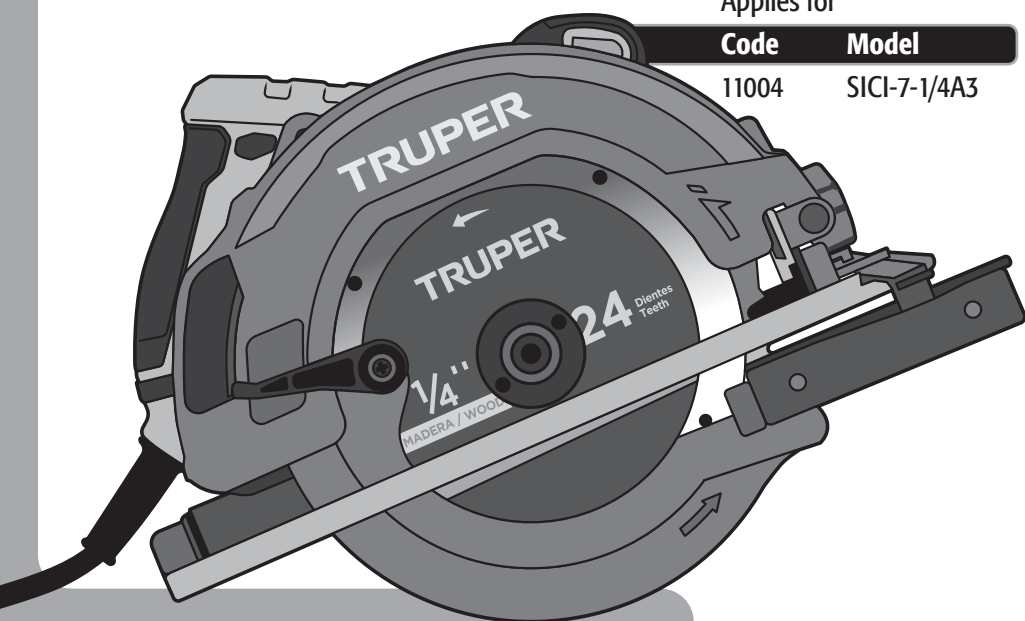



# SICI-7-1/4A3

**CAUTION**



Read this manual thoroughly  
before using the tool.



Technical data .....	3
Power requirements .....	3
 General power tool safety warnings .....	4
 Safety warnings for circular saws .....	5
Parts .....	7
Preparation .....	8
Startup .....	8
Maintenance .....	10
Authorized service centers .....	11
Warranty policy .....	12

## CAUTION

To gain the best performance of the tool, prolong the duty life, make the Warranty valid if necessary, and to avoid hazards of fatal injuries please read and understand this manual before using the tool.

Keep this manual for future references.

The illustrations in this manual are for reference only. They might be different from the real tool.

## Use and care recommendations



### **RESPECT THE WORK CYCLES**

30 min of work per 15 min of rest. Maximum 3 hours daily.



**NEVER** use the cord to hold, carry, lift or disconnect the tool.



**DO NOT TURN ON** the tool with the cutting teeth resting on the workpiece, as it could cause kickback.



**DO NOT** press the lock button while the disc is in motion.



To **EXTEND** the life of your tool, use compressed air (blow) to clean it after each use.



Keep the tool's ventilation slots **CLEAN**.



Perform regular **MAINTENANCE** on your machine (page 10).

## SICI-7-1/4A3

Code	•	11004
Description	•	Circular saw
Diameter blade	•	7-1/4"
Maximum cut depth	•	90° 2 7/16"   45° 1 11/16"
Voltage	•	127 V~
Frequency	•	60 Hz
Current	•	13 A
Power	•	1750 W
Speed without load	•	5 500 RPM
Thread size	•	5/16 X 20 UN
Arbor size	•	5/8"
Duty cycle	•	30 min of work per 15 min of rest. Maximum 3 hours daily.
Conductors	•	16 AWG x 2C with insulating temperature of 221 °F
Insulation	•	Class II
IP Grade	•	IP20

Power Cord Grips used in this product: Type Y.  
Tool Build Quality: Reinforced insulation.  
Thermal insulation on motor winding: Class E.

**⚠ WARNING** Avoid the risk of electric shock or severe injury. When the power cable gets damaged it should only be replaced by the manufacturer or at a TRUPER Authorized Service Center. The build quality of the electric insulation is altered if spills or liquid gets into the tool while in use. Do not expose to rain, liquids and/or dampness.

**⚠ WARNING** Before gaining access to the terminals all power sources should be disconnected.



## Power Requirements

**⚠ WARNING** Tools with double insulation and reinforced insulation are equipped with a polarized plug (one prong is wider than the other). This plug will only fit in the right way into a polarized outlet. If the plug cannot be introduced into the outlet, reverse the plug. If it still doesn't fit, call a qualified electrician to install for you a polarized outlet. Do not alter the plug in any way. Both insulation types eliminate the need of both a grounded third power cord with three prongs or a grounded power connection.

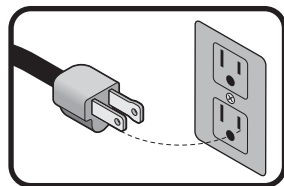

**⚠ WARNING** When using an extension cable, verify the gauge is enough for the power that your product needs. A lower gauge cable will cause voltage drop in the line, resulting in power loss and overheating. The following table shows the right size to use depending on cable's length and the ampere capability shown in the tool's nameplate. When in doubt use the next higher gauge.

Ampere Capacity	Number of Conductors	Extension gauge	
		from 5.9' to 49.2'	higher than 49.2'
from 0 A and up to 10 A	3 (one grounded)	18 AWG (*)	16 AWG
from 10 A and up to 13 A		16 AWG	14 AWG
from 13 A and up to 15 A		14 AWG	12 AWG
from 15 A and up to 20 A		8 AWG	6 AWG

\* It is safe to use only if the extensions have a built-in artifact for over current protection.

AWG = American Wire Gauge. Reference: NMX-I-195-ANCE

**⚠ WARNING** When operating power tools outdoors, use a **VOLTECK** grounded extension cable labeled "For Outdoors Use". These extensions are specially designed for operating outdoors and reduce the risk of electric shock.





## General power tool safety warnings



**⚠ WARNING! Read carefully all safety warnings and instructions listed below.** Failure to comply with any of these warnings may result in electric shock, fire and / or severe damage. **Save all warnings and instructions for future references.**

### Work area

**Keep your work area clean, and well lit.**

Cluttered and dark areas may cause accidents.



**Never use the tool in explosive atmospheres, such as in the presence of flammable liquids, gases or dust.**

Sparks generated by power tools may ignite the flammable material.



**Keep children and bystanders at a safe distance while operating the tool.**

Distractions may cause losing control.



### Electrical Safety

**The tool plug must match the power outlet. Never modify the plug in any way. Do not use any adapter plugs with grounded power tools.**

Modified plugs and different power outlets increase the risk of electric shock.



**Avoid body contact with grounded surfaces, such as pipes, radiators, electric ranges and refrigerators.**

The risk of electric shock increases if your body is grounded.

**Do not expose the tool to rain or wet conditions.**

Water entering into the tool increases the risk of electric shock.

**Do not force the cord. Never use the cord to carry, lift or unplug the tool. Keep the cord away from heat, oil, sharp edges or moving parts.**

Damaged or entangled cords increase the risk of electric shock.

**When operating a tool outdoors, use an extension cord suitable for outdoor use.**

Using an adequate outdoor extension cord reduces the risk of electric shock.

**If operating the tool in a damp location cannot be avoided, use a ground fault circuit interrupter (GFCI) protected supply.**

Using a GFCI reduces the risk of electric shock.

### Personal safety

**Stay alert, watch what you are doing and use common sense when operating a tool. Do not use a power tool while you are tired or under the influence of drugs, alcohol or medication.**

A moment of distraction while operating the tool may result in personal injury.

**Use personal protective equipment. Always wear eye protection.**

Protective equipment such as safety glasses, anti-dust mask, non-skid shoes, hard hats and hearing protection used in the right conditions significantly reduce personal injury.



**Prevent unintentional starting up. Ensure the switch is in the "OFF" position before connecting into the power source and / or battery as well as when carrying the tool.**

Transporting power tools with the finger on the switch or connecting power tools with the switch in the "ON" position may cause accidents.

**Remove any wrench or vice before turning the power tool on.**

Wrenches or vices left attached to rotating parts of the tool may result in personal injury.

**Do not overreach. Keep proper footing and balance at all times.**

This enables a better control on the tool during unexpected situations.

**Dress properly. Do not wear loose clothing or jewelry. Keep hair, clothes and gloves away from the moving parts.**

Loose clothes, jewelry or long hair may get caught in moving parts.



**If you have dust extraction and recollection devices connected onto the tool, inspect their connections and use them correctly.**

Using these devices reduce dust-related risks.

### Power Tools Use and Care

**Do not force the tool. Use the adequate tool for your application.**

The correct tool delivers a better and safer job at the rate for which it was designed.



**Do not use the tool if the switch is not working properly.**

Any power tool that cannot be turned ON or OFF is dangerous and should be repaired before operating.

**Disconnect the tool from the power source and / or battery before making any adjustments, changing accessories or storing.**

These measures reduce the risk of accidentally starting the tool.

**Store tools out of the reach of children. Do not allow persons that are not familiar with the tool or its instructions to operate the tool.**

Power tools are dangerous in the hands of untrained users.



**Service the tool. Check the mobile parts are not misaligned or stuck. There should not be broken parts or other conditions that may affect its operation. Repair any damage before using the tool.**

Most accidents are caused due to poor maintenance to the tools.



**Keep the cutting accessories sharp and clean.**

Cutting accessories in good working conditions are less likely to bind and are easier to control.

**Use the tool, components and accessories in accordance with these instructions and the projected way to use it for the type of tool when in adequate working conditions.**

Using the tool for applications different from those it was designed for, could result in a hazardous situation.

### Service

**Repair the tool in a TRUPER Authorized Service Center using only identical spare parts.**

This will ensure that the safety of the power tool is maintained.



This tool is in compliance with the Official Mexican Standard (NOM - Norma Oficial Mexicana).

## Kickback

Kickback is the sudden and strong movement the tool experiences outwards from the work piece that can lead the operator to lose control or even cause him injuries. Usually this happens when the cutting blade is stuck into the piece or due to an inefficient operation. To avoid kickback the following caution measures should be used:

- Use perfectly maintained cutting discs. Double-check discs are properly mounted. Badly mounted, bent, damaged discs or with worn or dull teeth have a tendency to get stuck into the material causing kickback.
- When operating the tool, hold it firmly setting one hand on the handle and the other hand on the auxiliary handle. Always use both hands. Keep good balance and footing to be able to resist the force of possible kickback.
- To make cuts align the blade with the cut axle and wait for the blade to reach its highest speed before starting to cut. Do not try to cut setting the blade teeth on top of the work piece. It could cause kickback.
- To restart working inside the cut, center the blade into the cut and double-check the discs are not buried into the material.
- If while operating the tool you notice the blade is bending or the cut is interrupted, release the switch and hold the tool inside the work piece until the blade comes to a complete stop. Do not try to remove the blade while still moving. This could cause kickback.
- To minimize the risk of having the blade stuck and cause kickback, before cutting a wood piece remove all the nails. Damp, warped wood or chipboard needs special attention during the cut. When using large wood planks use supports close to both sides of the cutting line to avoid the plank to warp, close the cut and trap the disc. Wood resin and gum hardened on the blade make the saw run slow. Use resin and gum remover, hot water or kerosene to remove buildup. DO NOT use gasoline.
- Use extreme care when making a *pocket cut* on wall or blind spots. The blade may get into contact with hidden objects and cause kickback.
- While operating the tool, do not set your hand or body aligned with the cut axis, because if kickback sets there is a severe injury hazard.
- Before starting a cut, the levers to adjust cutting depth and bevel should be tight and secured. If they move during the cut, they may cause the blade to bend and cause kickback. Setting excessive cutting depth increases the load on the unit and the blade might bend inside the cut. It also increases the possibility that the cut closes and increases the available area on top of the cutting disc.

## General measures

**⚠ DANGER** • Move away your hands from the cutting area and the cutting disc. To prevent from accidental injury and losing control, firmly hold the tool with both hands by the handle and the auxiliary handle.

Do not place your hand under the workpiece. The guard cannot protect the operator if the cutting blade reaches the bottom of the workpiece.

**⚠ WARNING** • The accidental contact with a rotating cutting blade may cause severe personal injury.

**⚠ DANGER** • NEVER hold the work piece to cut with your hands or on top of your leg. Hold the work piece adequately to avoid your body making contact with the cutting disc, and to prevent the blade from bending or losing control of the tool or the work piece.

**⚠ DANGER** • Do not try to remove debris material when the blade is running.

**⚠ WARNING** • Remember that the guards do not protect you from the moving blade below the work piece. Therefore never squat or try to put your hand below the work piece when the machine is running.

**⚠ CAUTION** • Double-check retractable guard and the spring are working properly before each time you use the tool. If the guard is not moving freely or is not closing instantly, service the machine.

**⚠ WARNING** • Do not bring the blade near your body when carrying the tool. If it accidentally starts the retractable guard may open and make contact with your clothes.

• Always use a guide for a straight cut when performing continuous cutting. This action improves the quality of the cut and reduces the possibility of the cutting disc becoming deformed.

**⚠ CAUTION** • Operating the tools holding it by the insulated parts prevents the user from getting and electrical discharge if the blade makes contact with hidden cabling.

• ALWAYS keep the electric supply cord away from the cutting area. The electric supply cord SHALL NEVER hang on top of the work piece when making the cut.

• Wear always safety glasses with side protection. If dust is produced wear also a dust mask.



### Retractable guard

Before each use double-check if the retractable guard and the spring are working correctly. If the guard is not moving freely or not closing instantaneously service them before further operation with the tool.

The retractable guard could work slowly because of damaged parts, gummy deposits or debris accumulation. To prevent from this possibility clean regularly the insides of both guards and the blade axis. Use kerosene or compressed air. Before cleaning disconnect the machine and remove the cutting discs.

The retractable guard can be opened manually. Make this only when changing discs and when making cuts such as *cut marking* or *combined cut*. Using the guard lever open the retractable guard. As soon as the blade gets into the material, release the lever. For any other type of cuts the guard should operate automatically. Never leave the retractable guard in the open position.

The retractable guard might bend due to a stroke or if it falls. Before operating the tool, verify it moves freely in every angle and cutting depths. The guard should not touch the cutting blade or any other part of the tool.

**⚠ WARNING** Verify the retractable guard covers the blade before setting the saw on a bench or on the floor. A blade rotating due to inertia could cause the saw to move backwards cutting whatever objects in its way. Verify the blade stops moving after turning off the tool.

**⚠ WARNING** Remember that the guards do not protect you from the moving blade below the work piece. Never squat or put your hand below the work piece when the tool is running.

Never use flanges or bolts that are damaged or not suitable for the cutting disc.

The flanges and bolts are specifically designed for the saw, for optimal performance and safe operation.

Do not use abrasive discs.

### Toxic materials

Dust coming from some materials have chemical substances known to cause cancer, birth and reproductive defects. Some of these chemical substances are:

- Lead in lead-based paint.
- Crystal Silica in bricks, cement and other masonry products.
- Arsenic and Chromium in wood treated with chemical substances.
- Asbestos.

The risk involved due to exposure to these substances varies with the frequency this type of job is made. To reduce being exposed to the chemicals work in well-ventilated areas, use the adequate safety equipment, such as dust-mask specifically designed to filter microscopic particles.



**Saw Dust Ejector.**  
Saw dust is blown back and sideways as far away as possible from the operator. The motor-cooling air blows out from the housing helping to eject sawdust.

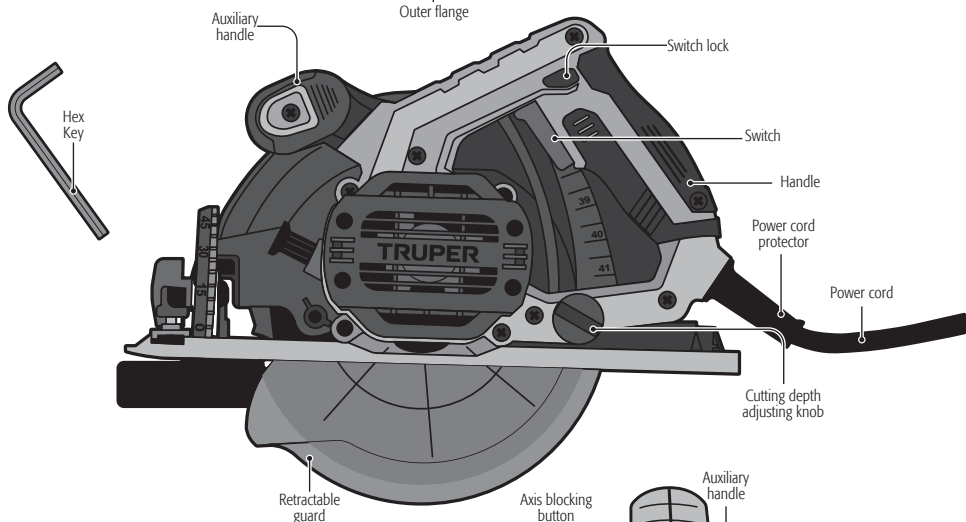
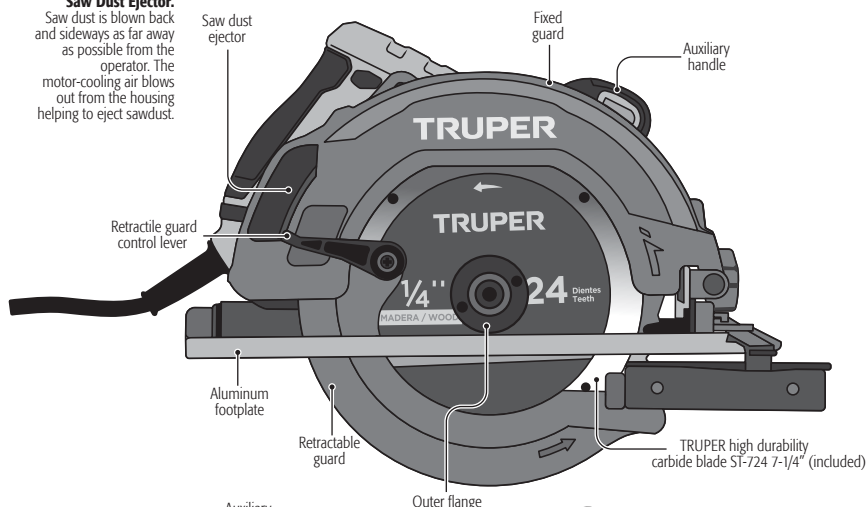

**Retractable guard.**  
The retractable guard opens automatically when the blade makes contact with the work piece. When the cut is finished, the retractable guard closes with a spring to cover the disc.

**Motor.**  
The saw's motor has the power you need. It is cooled with an extra large fan. Lengthy and heavy-duty use may overheat the motor! Cool it down by setting speed with no load.

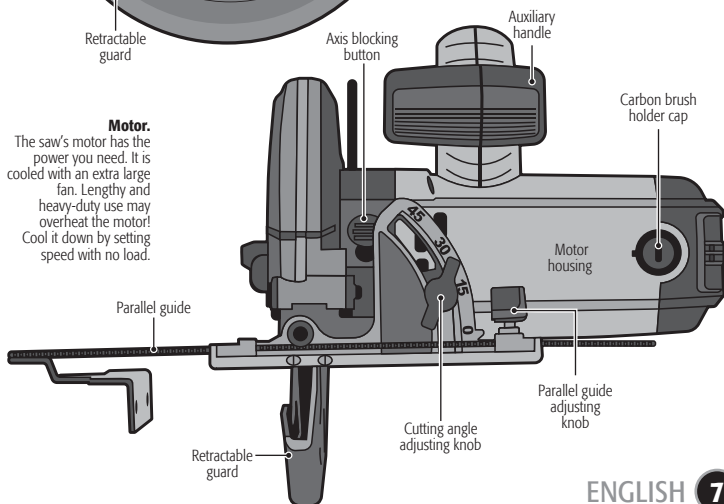

## Cutting blade installation/removal

**⚠ WARNING** The cutting discs' size specified for this tool are 7-1/4" Never use a cutting blade of different type or size. Otherwise it can cause severe personal injury or damage the tool permanently and making the warranty void.

Never use damaged or incorrect washers or bolts for discs. To get excellent and safe operation the washers and bolts included are specially designed for this model of tool.

Use cutting discs with an arbor hole of the right size and shape. Otherwise the blade may start rotating eccentrically causing loss of control.

1. Unplug the tool and adjust the cutting depth to the lowest setting. (See page 9).
2. Open the retractable guard all the way (A) and keep it in that position.
3. Insert the inner flange (B) in the axis.
4. Fix the cutting blade (C). Double-check the printed arrow in the blade matches the direction of the arrow embossed in the tool's guard.
5. Insert the outer flange (D) in the axis.
6. Fix the bolt (E) into the axis and tighten with the hex key (F) and press the axis blocking button (G).
7. To remove discs reverse the steps.

When the cutting discs wear out, replace them immediately

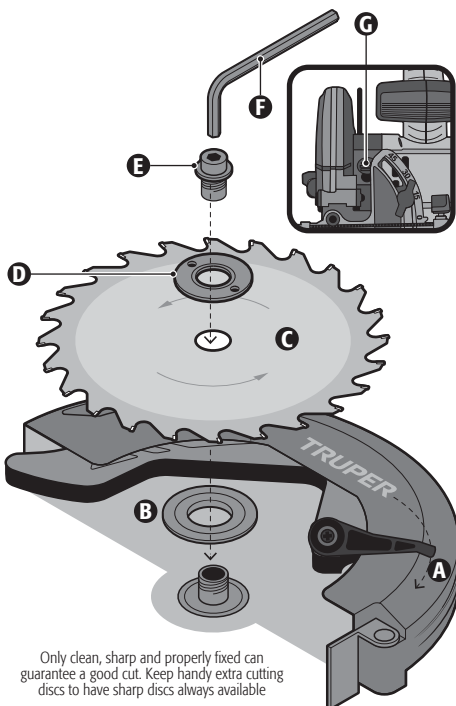

## Startup

The circular saw is a multi-use tool to cut hard or soft wood, plywood, Resopal covered materials, etc.

**⚠ CAUTION** This tool is not designed to cut metal material, masonry, cement or bricks.

## Turning On

- Connect the plug to the outlet.
  - To unblock the switch (H) keep the switch lock (G) pressed down.
- The switch lock prevents from accidental startup.
- Press the switch (H) to start the blade rotation.
  - To stop the blade release the switch (H).

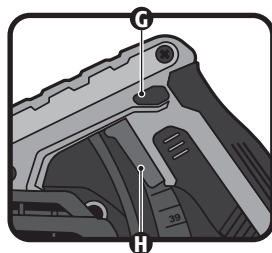



## Cutting depth adjustment

1. Loosen the cutting depth adjusting knob.
2. Having the base fixed, raise the housing until the blade sticks out to the desired depth from the base. Use the depth guide as reference.
3. Tighten the cutting depth adjusting knob to prevent the housing from moving during the cut.
4. Cutting depth can go up to 2.5"

**CAUTION** • The cutting depth should match the work piece thickness or stick out from the piece the size of one blade tooth at the most, to prevent causing an accident.

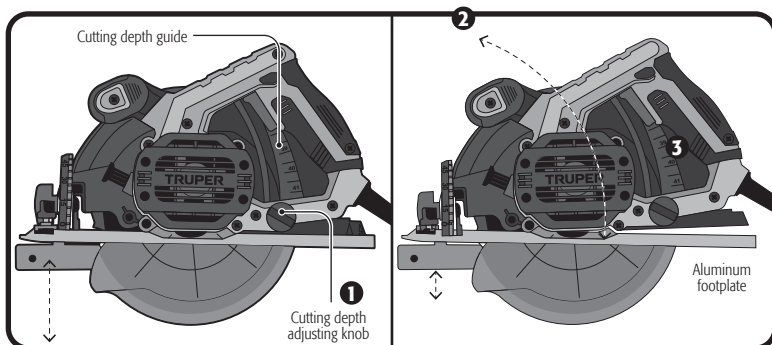

## Cutting angle adjustment

- Loosen the cutting angle adjustment knobs.
- Fix the base. Turn the housing until the blade sits on the desired angle.
- Tighten the angle adjustment knob to prevent the housing to move during the cut.
- The tool can make cuts from 0° to 45°

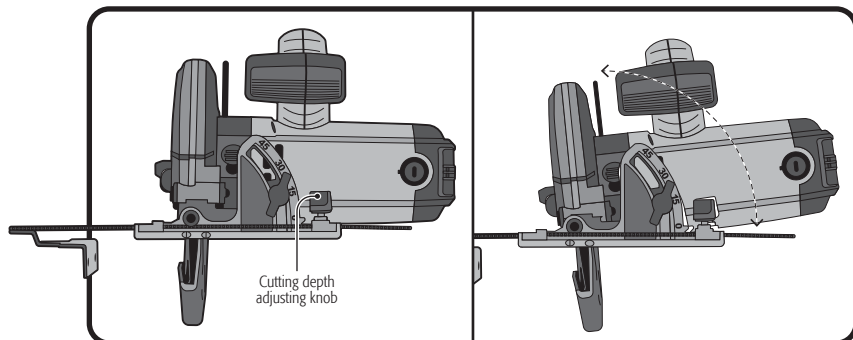

## Parallel guide adjustment

Use the parallel guide to fix the work piece while cutting. The parallel guide is inserted through the grooves of the saw shoe. To adjust width, loosen the knob and run the parallel guide into the desired position.

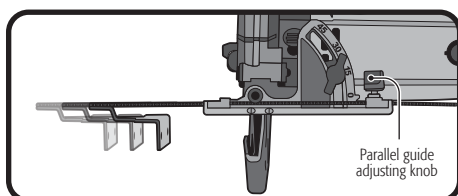

Keep in mind to disconnect the tool before cleaning or servicing.

Every component in the tool is an important part of the insulating system and should only be serviced in a TRUPER Authorized Service Center.

When sending the tool to a TRUPER Authorized Service Center, ALWAYS ask for original spare parts.

When cleaning the plastic parts of the tool, refrain from using solvents. Most plastic materials are susceptible to damage when commercial type solvents are applied.

Use a clean cloth or pressurized air to clean dirt, coal or dust.

**⚠ WARNING** NEVER expose the tool to oil, brake fluid, petroleum based products, penetrating oils, etc. They are made of chemical substances that may damage or destroy plastics.

**⚠ WARNING** When using pressurized air to blow off particles ALWAYS wear protective glasses with side protectors or a facemask. If too much dust is present use a dust-mask.



It is not advisable to use this tool for prolonged jobs with fiberglass, drywall or plaster. Their particles are highly abrasive for any power tool components. When using a tool in any of those materials, a very important measure is to frequently clean with compressed air to increase the useful life of the machine.

## Carbon brush replacement

- Replace worn (burnt, broken or smaller than 0.19" long) carbon brushes. Use new carbons.
- When changing carbons always change both carbons at the same time.
- Use a screwdriver to remove the brushes cap.
- Remove worn carbons from the housing. Clean dust with compressed air.
- Set the new carbons in a reverse order. Carbon should easily fall into the carbon housing.
- After setting up new carbon brushes let the machine to run a couple of minutes with no load. This way the carbon brushes will adjust better.
- Use only original TRUPER spare carbon brushes, designed specifically with the right strength and electric resistance for each type of motor. Carbon brushes with different specifications may damage the motor.

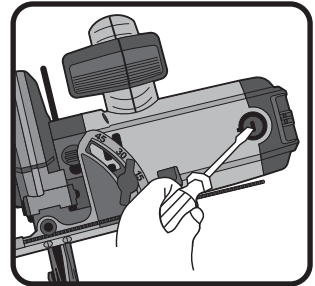

## Replacement

Replacement	Code	Model
Carbon brush	15029	CB-SC-7-1/4A3
Switch	102733	INT-SC-7-1/4A3

### Note

Follow instructions for replacement  
Go to Authorized TRUPER Service Center.

# Authorized service centers

# TRUPER PRO

In the event of any problem contacting a TRUPER Authorized Service Center, please see our webpage **WWW.TRUPER.COM** to get an updated list, or call our toll-free numbers **800 690-6990** or **800 018-7873** to get information about the nearest Service Center.

**AGUASCALIENTES** **DE TODO PARA LA CONSTRUCCIÓN**  
GRAL. BARRAGÁN #1201, COL. GREMIAL, C.P. 20030,  
AGUASCALIENTES, AGS. TEL.: 449 994 0537

**BAJA CALIFORNIA** **SUCURSAL TIJUANA**  
AV. LA ENCANTADA, LOTE #5, PARQUE INDUSTRIAL EL  
FLORIDO II, C.P. 22244, TIJUANA, B.C.  
TEL.: 664 969 5100

**BAJA CALIFORNIA SUR** **FIX FERRETERÍAS**  
FELIPE ÁNGELES ESQ. RUIZ CORTÍNEZ S/N, COL. PUEBLO  
NUEVO, C.P. 23670, CD. CONSTITUCIÓN, B.C.S.  
TEL.: 613 132 1115

**CAMPECHE** **TORNILLERÍA Y FERRETERÍA AAA**  
AV. ALVARO OBREGÓN #324, COL. ESPERANZA  
C.P. 24080 CAMPECHE, CAMP. TEL.: 981 815 2808

**CHIAPAS** **FIX FERRETERÍAS**  
AV. CENTRAL SUR #27, COL. CENTRO, C.P. 30700,  
TAPACHULA, CHIS. TEL.: 962 118 4083

**CHIHUAHUA** **SUCURSAL CHIHUAHUA**  
AV. SILVESTRE TERRAZAS #128-11, PARQUE INDUSTRIAL  
BAFAR, CARRETERA MÉXICO CUAUHTÉMOC, C.P. 31415,  
CHIHUAHUA, CHIH. TEL.: 614 434 0052

**MEXICO CITY** **FIX FERRETERÍAS**  
EL MONSTRUO DE CORREGIDORA, CORREGIDORA # 35,  
COL. CENTRO, C.P. 06060, CUAUHTÉMOC, CDMX.  
TEL.: 55 5522 5031 / 5522 4861

**COAHUILA** **SUCURSAL TORREÓN**  
CALLE METAL MECÁNICA #280, PARQUE INDUSTRIAL  
ORIENTE, C.P. 27278, TORREÓN, COAH.  
TEL.: 871 209 68 23

**COLIMA** **BOMBAS Y MOTORES BYMTESA DE MANZANILLO**  
BLVD. MIGUEL DE LA MADRID #190, COL. 16 DE  
SEPTIEMBRE, C.P. 28239, MANZANILLO, COL.  
TEL.: 314 332 1986 / 332 8013

**DURANGO** **TORNILLOS ÁGUILA, S.A. DE C.V.**  
MAZURIO #200, COL. LUIS ECHEVERRÍA, DURANGO,  
DGO. TEL.: 618 817 1946 / 618 818 2844

**ESTADO DE MÉXICO** **SUCURSAL CENTRO JILOTEPEC**  
PARQUE INDUSTRIAL # 1, COL. PARQUE INDUSTRIAL  
JILOTEPEC, JILOTEPEC, EDO. DE MÉX. C.P. 54257  
TEL.: 761 782 9101 EXT. 5728 Y 5102

**GUANAJUATO** **CÁ. FERRETERA NUEVO MUNDO S.A. DE C.V.**  
AV. MÉXICO - JAPÓN #225, CD. INDUSTRIAL, C.P. 38010,  
CELAYA, GTO. TEL.: 461 617 7578 / 79 / 80 / 88

**GUERRERO** **CENTRO DE SERVICIO ECLIPSE**  
CALLE PRINCIPAL MZ.1 LT. 1, COL. SANTA FE, C.P. 39010,  
CHILPANCINGO, GRO. TEL.: 747 478 5793

**HIDALGO** **FERREPRECIOS S.A. DE C.V.**  
LIBERTAD ORIENTE #304 LOCAL 30, INTERIOR DE PASAJE  
ROBLODO, COL. CENTRO, C.P. 43600, TULANCINGO,  
HGO. TEL.: 775 753 6615 / 775 753 6616

**JALISCO** **SUCURSAL GUADALAJARA**  
AV. ADOLFO B. HORN # 6800, COL. SANTA CRUZ DEL  
VALLE, C.P.: 45655, TLAJOMULCO DE ZÚNIGA, JAL.  
TEL.: 33 3606 5285 AL 90

**MICHOACÁN** **FIX FERRETERÍAS**  
AV. PASEO DE LA REPÚBLICA #5140-A, COL.  
EX-HACIENDA DE LA HUERTA, C.P. 58050, MORELIA,  
MICH. TEL.: 443 334 6858

**MORELOS** **FIX FERRETERÍAS**  
CAPITÁN ANZURES #95, ESQ. JOSÉ PERDIZ, COL.  
CENTRO, C.P. 62740, CUAUTLA, MOR.  
TEL.: 735 352 8931

**NAYARIT** **HERRAMIENTAS DE TEPEC**  
MAZATLAN #117, COL. CENTRO, C.P. 63000, TEPEC, NAY.  
TEL.: 311 258 0540

**NUEVO LEÓN** **SUCURSAL MONTERREY**  
CARRETERA LAREDO #300, 1B MONTERREY PARKS,  
COLONIA PUERTA DE ANAHUAC, C.P. 66052, ESCOBEDO,  
NUEVO LEÓN, TEL.: 81 8352 8791 / 81 8352 8790

**OAXACA** **FIX FERRETERÍAS**  
AV. 20 DE NOVIEMBRE #910, COL. CENTRO, C.P. 68300,  
TUXTEPEC, OAX. TEL.: 287 106 3092

**PUEBLA** **SUCURSAL PUEBLA**  
AV. PERIFÉRICO #2-A, SAN LORENZO ALMECATLA,  
C.P. 72710, CUAUTLACINGO, PUE.  
TEL.: 222 282 8282 / 84 / 85 / 86

**QUERÉTARO** **ARU HERRAMIENTAS S.A. DE C.V.**  
AV. PUERTO DE VERACRUZ #110, COL. RANCHO DE  
ENMEDIO, C.P. 76842, SAN JUAN DEL RÍO, QRO.  
TEL.: 427 268 4544

**QUINTANA ROO** **FIX FERRETERÍAS**  
CARRETERA FEDERAL MZ. 46 LT. 3 LOCAL 2, COL. EJIDAL,  
C.P. 77710 PLAYA DEL CARMEN, Q.R.  
TEL.: 984 267 3140

**SAN LUIS POTOSÍ** **FIX FERRETERÍAS**  
AV. UNIVERSIDAD #1850, COL. EL PASEO, C.P. 78320,  
SAN LUIS POTOSÍ, S.L.P. TEL.: 444 822 4341

**SINALOA** **SUCURSAL CULIACÁN**  
AV. JESÚS KUMATE SUR #4301, COL. HACIENDA DE LA  
MORA, C.P. 80143, CULIACÁN, SIN.  
TEL.: 667 173 9139 / 173 8400

**SONORA** **FIX FERRETERÍAS**  
CALLE 5 DE FEBRERO #517, SUR LT. 25 MZ. 10, COL.  
CENTRO, C.P. 85000, CD. OBREGÓN, SON.  
TEL.: 644 413 2392

**TABASCO** **SUCURSAL VILLAHERMOSA**  
CALLE HELIO LOTES 1, 2 Y 3 MZ. #1, COL. INDUSTRIAL,  
2A ETAPA, C.P. 86010, VILLAHERMOSA, TAB.  
TEL.: 993 353 7244

**TAMAULIPAS** **VM ORINGS Y REFACCIONES**  
CALLE ROSITA #527 ENTRE 20 DE NOVIEMBRE Y GRAL.  
RODRÍGUEZ, FRACC. REYNOSA, C.P. 88780, REYNOSA,  
TAMS. TEL.: 899 926 7552

**TLAXCALA** **SERVICIOS Y HERRAMIENTAS INDUSTRIALES**  
PABLO SIDAR #132, COL. BARRIO DE SAN BARTOLOMÉ,  
C.P. 90970, SAN PABLO DEL MONTE, TLAX.  
TEL.: 222 271 7502

**VERACRUZ** **LA CASA DISTRIBUIDORA TRUPER**  
BLVD. PRIMAVERA ESQ. HORTENSIA S/N, COL.  
PRIMAVERA C.P. 93308, POZA RICA, VER.  
TEL.: 782 823 8100 / 826 8484

**YUCATÁN** **SUCURSAL MÉRIDA**  
CALLE 33 #600 Y 602, LOCALIDAD ITZINCAB Y MULSA,  
MPIO. UMÁN, C.P. 97390, MÉRIDA, YUC.  
TEL.: 999 912 2451

Model	Code	Brand
SICI-7-1/4A3	11004	TRUPER PRO

Warranty. Duration: 3 years. Coverage: parts, components and workmanship against manufacturing or operating defects, except if used under conditions other than normal; when it was not operated in accordance with the instructive; was altered or repaired by personnel not authorized by TRUPER®. To make the warranty valid, present the product, stamped policy or invoice or receipt or voucher, in the establishment where you bought it or in Corregidora 35, Centro, Cuauhtémoc, CDMX, 06060, where you can also purchase parts, components, consumables and accessories. It includes the costs of transportation of the product that derive from its fulfillment of its service network. . Phone number 800-018-7873. Made in China. Imported by TRUPER, S.A. de C.V. Parque Industrial 1, Parque Industrial Jilotepec, Jilotepec, Edo. de Méx. C.P. 54257, Phone number 761 782 9100.

Stamp of the business. Delivery date:

