

Manual

Gas brushcutter

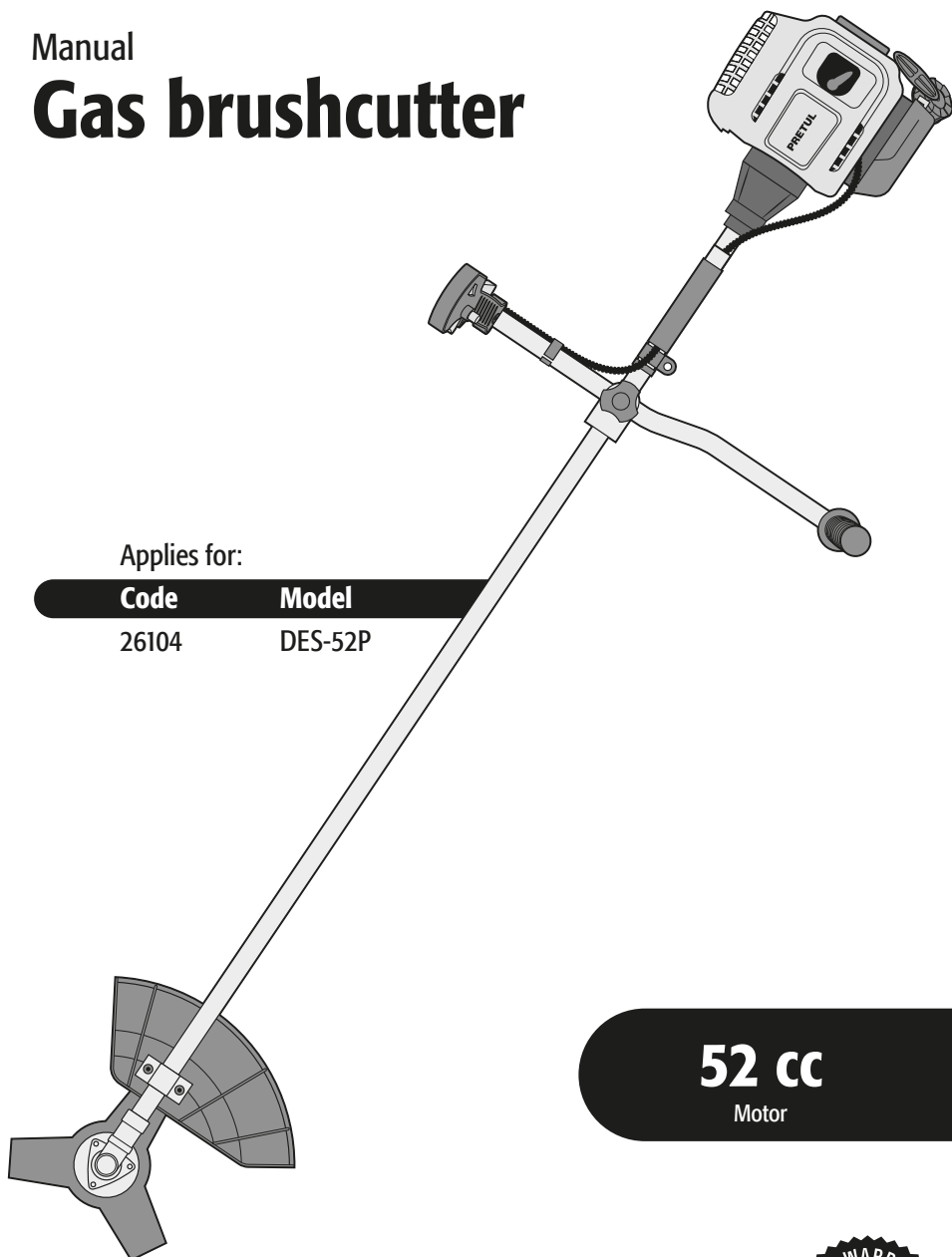

Applies for:

Code

Model

26104

DES-52P



52 cc

Motor



Read the user's manual thoroughly
before operating this tool.



Technical data.....	3
Fuel specifications.....	3
 General safety warnings for the use of motorized.....	4
 Safety warnings for the use of a gas brushcutter.....	5
Parts.....	6
Assembly.....	7
Fuel supply.....	10
Start up.....	10
Operation.....	11
Maintenance.....	12
Available accessories and replacement parts list.....	13
Troubleshooting.....	14
Authorized service centers.....	15
Warranty policy.....	16

CAUTION

To gain the best performance of the tool, prolong the duty life, make the Warranty valid if necessary, and to avoid hazards of fatal injuries please read and understand this Manual before using the tool.



Keep this manual for future references.

The illustrations in this manual are for reference only. They might be different from the real tool.

Use and care recommendations



 For better performance and durability, use high-octane gasoline. In Mexico, we recommend using **PREMIUM** gasoline mixed with **2-STROKE ENGINE OIL**. Using the wrong mixture can cause serious engine damage.

 +  = **40:1** Mix

 **DO NOT** use **GASOLINE MIXTURE** that has been stored for over 15 days.

 Always **USE** the **SAFETY GUARD** and nylon line with a **DIAMETER** of 0.080 in to 0.145 in.

 **ALWAYS** run your machine at **FULL POWER** with the throttle **FULLY** engaged.

 Perform regular **MAINTENANCE** on your machine (page 12)

DES-52P

Code	•	26104
Description	•	Gas brushcutter
Net weight	•	16.3 lb
Engine	•	52 cc
Engine rated power	•	1.87 HP
Fuel tank	•	20 oz
Speed	•	9 300 RPM
Cutting diameter	•	17"
Shaft length	•	54"
Cutting systems	•	Nylon thread spool and blade
Blade diameter	•	Outer: 10" Inner: 1"
Nylon thread diameter	•	From 0.080" to 0.145" (advisable)
Handle shape	•	Offset handle
Duty cycle	•	40 minutes rest per consumed tank. Daily maximum: 5 hours.

Fuel Specifications

- The gas brushcutter runs with an air-cooled two-cycle engine and uses a mix of unleaded gasoline and high quality, self-mixing motor oil with fuel stabilizer specified for air-cooled -2 stroke motor.
 - The motor is certified to run with unleaded gasoline for vehicles having an octane index of 87 (IR+MJ/2) or higher.
 - Do not use any type of gasoline and oil mix sold in Service stations, especially, used in motorcycles.
 - Do not use motor oil for self-propulsion, or two-cycle oil outboard motor.
 - The ratio for the mix shall be 40 parts gasoline per 1 part oil (40:1 Ratio). Prepare the mix in an approved fuel container.
- Always mix thoroughly before pouring it into the motor fuel tank.

CAUTION Do not use a fuel mix that has been stored longer than 15 days. Mix small quantities.

WARNING Never smoke near the fuel or where fuel is being supplied, or in the oil-gasoline mix preparing site or when operating the brushcutter.

WARNING Trying to start the gas brushcutter without mixing oil into the fuel will cause a faulty motor.



Use TRUPER ACES-2, ACES-5 or ACES-20 oil caps** to measure the mix.
Mix 4 capfuls oil per each gasoline liter.



A wrong mix may cause the gas brushcutter to throw a rod
causing expensive repairs!



5 capfuls oil



Gasoline
PREMIUM



40:1

Mix

To extend the motor's useful life use TRUPER synthetic oil for 2-stroke motors.

* 1 gallon = 3.78 liters

** Not included

Keep your work area clean, tidy and well lit.

CAUTION Cluttered and dark areas may cause accidents.



Never use the tool in explosive areas or in the presence of flammable liquids.

DANGER Before starting the motor keep the tool at least 9 meters (30 feet) away from the fill up area.



Keep children and passersby at a safe distance while operating the tool.

WARNING Distractions could cause losing control and cause accidents.



Avoid contact with power lines and circuits.

DANGER Find and avoid power lines and circuits, especially hidden wiring as well as any grounded object.



Stay alert, use care and common sense.

CAUTION Familiarity with the tool operation could lead to distractions. It could cause accidents.

Refrain from using the tool if tired or under the influence of drugs, alcohol or medication.

DANGER Being momentarily distracted while using the tool could cause severe personal injury.

Operate the tool with guards and protection devices in place and in good working condition.

WARNING Failure to comply with this warning is a hazard of severe personal injury.

Do not force the tool.

CAUTION Working within the tool's working design assures a better and safer job.



Keep the tool in a safe place and out of the reach of children.

WARNING Motor powered tools are dangerous to inexperienced people.



Wear proper clothes.

WARNING Loose clothes, jewelry or long hair could get caught in the mobile parts.



Keep hands away from rotating and/or mobile parts.

WARNING Failure to comply with this warning is a hazard of severe personal injury.



Do not operate the tool in enclosed areas.

DANGER Avoid breathing accumulated carbon monoxide, a potentially deadly odorless toxic gas.



Wear adequate protective safety accessories.

CAUTION Wear eye protection, dust mask, non-skid safety shoes, helmet and ear plugs. These safety gears reduce the risk of injury.



Turn off the tool before adjusting, changing accessories or storing.

WARNING Double check the tool switch is in the off position.

Refrain from operating the tool if the switch is not working or is not properly assembled.

WARNING Failure to comply with this warning is a hazard of personal injury. Immediately send it to a TRUPER Authorized Service Center.

Do not overreach.

CAUTION Good balance and support lead to better controlling the tool in unexpected situations.

Avoid the tool to unintentionally start.

WARNING Double-check the tool motor is off before maintenance or putting it away.



Remove brackets before turning on the tool.

DANGER Additional tools or vices installed in a rotating part could cause severe personal injury.

Service the tool and double-check it is in good working conditions before operating.

CAUTION Carefully check mobile parts, alignment and assembly. Do it periodically. Look for any damaged element or part not working properly. Repair immediately in a TRUPER Authorized Service Center.



Accessories.

CAUTION Use only accessories or spare parts indicated in this Manual or certified by TRUPER.

Never leave a running tool unattended.

DANGER Turn off and disconnect the tool after using. Set it in a safe position to avoid severe injury.

Never smoke in the proximity of fuel.

DANGER Do not smoke in the proximity of the fuelling area or when using the tool.



Do not touch parts with high temperatures.

The surface of the engine and the exhaust reach high temperatures during the operation of the tool.



Service and repair.

Always go to a TRUPER Authorized Service Center to use identical spare parts and maintain the security of the tool.

Safety warnings for brushcutters

PRETUL

Fuel handling

- Never smoke near fuel, or in the gas filling up zone or when preparing the oil mix, nor when operating the gas brushcutter. 
- To reduce fire risk or burns, use care when handling fuel. It is extremely flammable. 
- Do not allow gasoline or oil touching your skin.
- Protect your eyes to prevent gasoline and oil spills. In the event of accidental contact, wash your eyes with clean water. If eye irritation continues consult a physician.
- Mix and store fuel in a designated container.

⚠ WARNING • Mix fuel outdoors away from sparks or flames.





- Before filling up the gas brushcutter, turn off the motor, set in on clear ground and wait while the motor cools down.

⚠ CAUTION • Wipe clean any amount of fuel that might have spilled in the gas brushcutter before operating.

⚠ CAUTION • Look for fuel leakages. If finding any leaks fix them before using the gas brushcutter to prevent fire or burn injuries.

- Set the gas brushcutter at least 30 feet away from the oil filling up site before starting the motor.
- Under no circumstance at all burn spilled fuel to eliminate it.
- For no reason at all use any type of fuel different from the specified in this Manual for the gas brushcutter.

Before operating the gas brushcutter

- Wear suitable clothing to operate the gas brushcutter: tight clothes, sturdy pants, non-skid safety boots, heavy-duty protecting gloves and safety lenses with side protection under ANSI Z87.1. Standard.    

⚠ WARNING • Remove any loose accessory or clothes which could get caught in the moving blade teeth. Tie long hair to be set above the shoulders' level.

- Double check the gas brushcutter is in perfect conditions. Do not turn it on if it is ill adjusted or not totally assembled. Assure it runs properly, the fuel tank is not leaking or there are loose screws.

- Confirm the blade stops moving when releasing the throttle trigger. If it does not stop turn off the gas brushcutter and go to a TRUPER Authorized Service Center to fix the problem.
- Check the gas brushcutter is clean, dry and free of oil or fuel.
- Double check the work area is in an open and well ventilated area.
- Walk over the work area and remove any stone, broken glass, nails, wire or cord. Those elements can shoot out or tangle in the gas brushcutter.

- In extreme weather confirm there is no ice forming and condensation in the gas brushcutter.
- Confirm the visibility and light conditions are adequate to be able to see clearly. Otherwise, do not use the gas brushcutter.
- Do not use the gas brushcutter without its guards or if damaged or with parts missing.

When operating the gas brushcutter

⚠ CAUTION • Keep passersby, children and animals no less than 50 feet away.

- Confirm the blade is not making contact with foreign object before starting the motor.

⚠ WARNING • Keep both feet firmly set in the ground and use both hands to hold the gas brushcutter by the handles. Never operate single-handedly. Otherwise the operator and people present may be injured.

- Keep all parts of your body away from the cutter head.
- Keep the thread cutter head pointing downwards, below the waist level. Never raise it higher than 30" from the ground.

• Keep all parts of your body away from the muffler. Otherwise you may be severely burned.

- Keep the gas brushcutter from flammable materials.
- The blades are designed to cut brush or fleshy vines with a diameter over 0.5".

• Use the circular saw to cut woody brush.

- Be aware to risks around you. The gas brushcutter noise might prevent you from noticing the risks.

⚠ DANGER • When carrying out jobs close to roads with traffic, stop cutting until there are no vehicles in sight. The gas brushcutter could throw particles towards the moving vehicles and cause a severe accident.

After operating the gas brushcutter

⚠ WARNING • Do not try to stop the cutting head movement any other way than releasing the switch. Wait until the cutting head stops by itself after turning off the gas brushcutter. It will take a couple of seconds.

⚠ CAUTION • Always carry the gas brushcutter with the motor OFF and the muffler away from your body. Drain empty the fuel tank to place it in a vehicle

⚠ WARNING • Turn off the motor before setting the gas brushcutter idle. DO NOT leave the motor running unattended. Let it cool down before storing the gas brushcutter.

⚠ CAUTION • Service and repairs for the gas brushcutter shall only be carried out by highly trained staff.

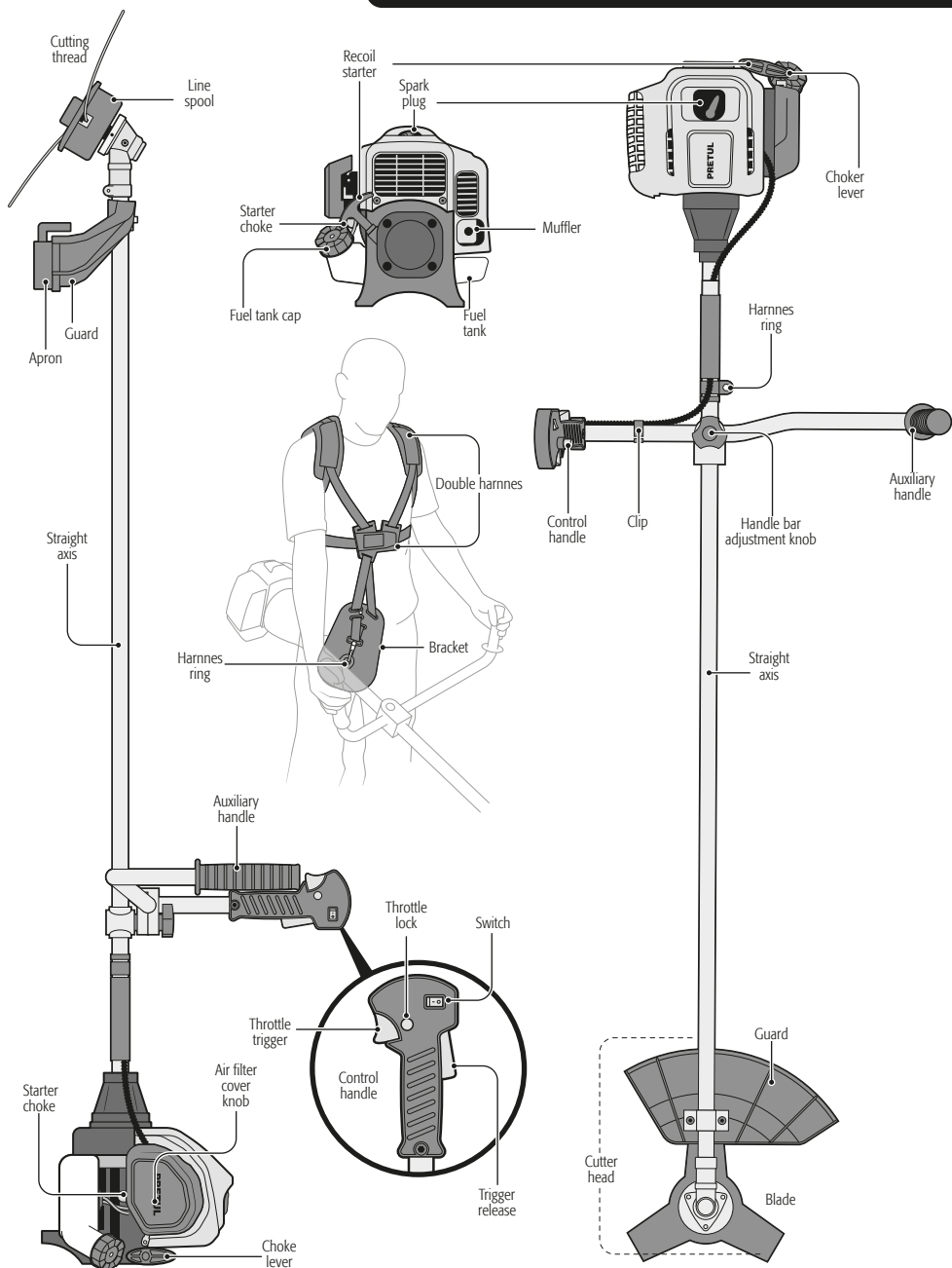

⚠ WARNING • Do not try to modify the gas brushcutter or manufacture accessories not recommended for this tool. Otherwise, there is danger of severe personal injury and the Warranty gets cancelled.

⚠ WARNING • Always when assembling parts, please disconnect the spark plug cable in the motor to prevent an accidental start up that causes severe personal injuries.

Handle

- Separate the clamp from the straight shaft mount by loosening the quick-adjust knob (a).
- Place the handle on the straight shaft mount.
- Secure the handle in place by fastening and tightening the quick-adjust knob firmly.

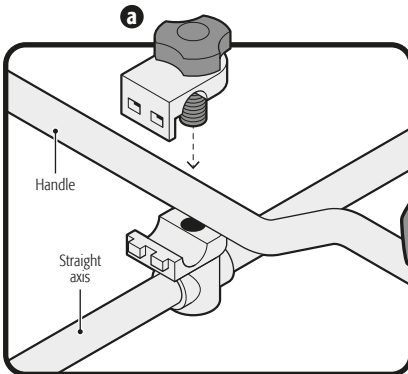

- To rotate the handle, loosen the quick-adjust knob and turn the handle 90° (b). This is useful for storing and transporting the brush cutter.

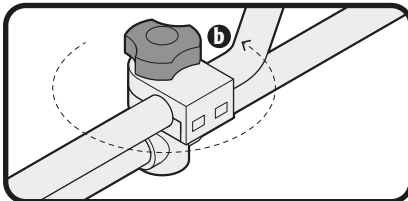

Guard

- Loosen the guard fixing screws, align the guard holes with those on the clamp mounted on the cutting head, and secure the assembly with the fixing screws.

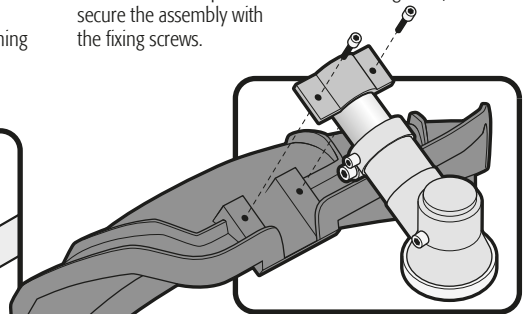

- If you are using the nylon thread spool, use the guard with the included skirt (A).
- If you are using the blade, remove the safety at the back of the guard (B), press the 2 clips (C) and take off the skirt.

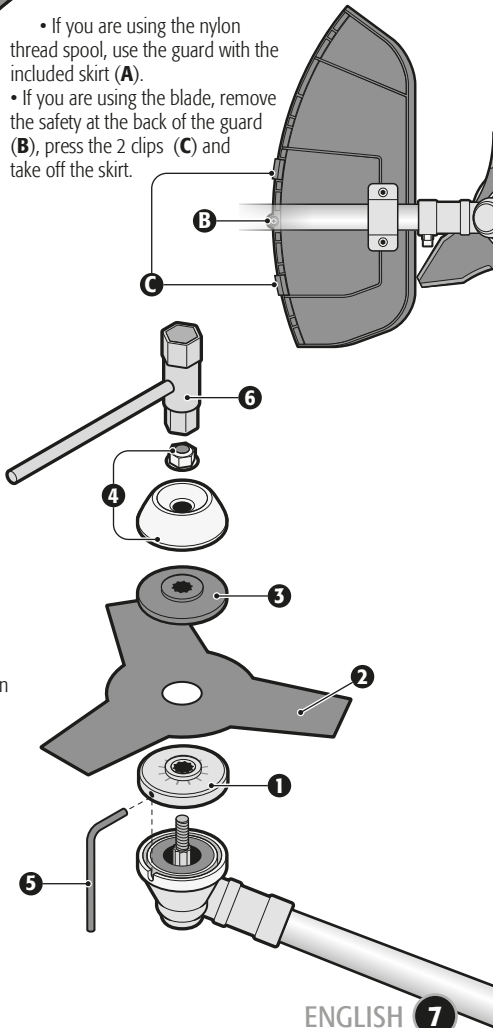

Blade set up

▲ NOTE • Before installing the cutting element, remove any previously installed components. Insert the hex wrench (5) into the side of the plate (1), apply pressure to secure the shaft, and turn the safety nut (6) clockwise to disassemble the pre-assembled element.

- Place the pressure plate on the cutting head (1).
- Position the blade on the pressure plate, ensuring that the direction of rotation of the blade matches the marking on the guard (2).
- Put the collar on the blade (3).
- Attach the cover and the safety nut (4).
- Insert the hexagonal wrench into the side of the pressure plate to lock the shaft (5) and tighten the safety nut counterclockwise using the provided wrench (6).
- Use the guard without the skirt, refer to the guard section.

Installation of the nylon thread spool

- Place the pressure plate on the cutting head (7).
- Insert the hexagonal wrench into the side of the pressure plate to lock the shaft (5).
- Thread the spool onto the shaft and tighten it by hand counterclockwise (8).
- Use the guard with the skirt, refer to the guard section.

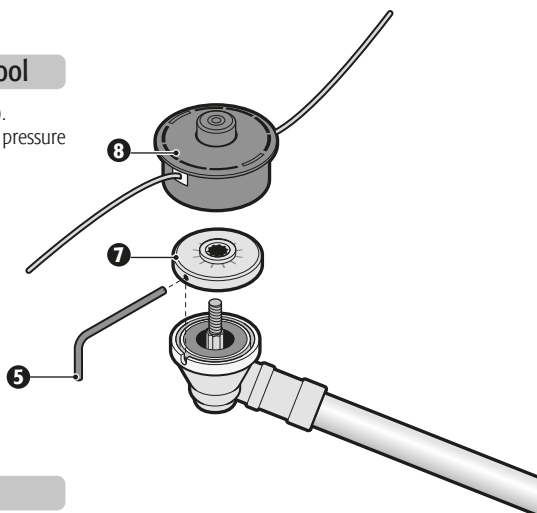

Refilling the trimmer line

1. Turn off the brushcutter and disconnect the spark plug wire to prevent accidental startup. Note: You don't need to remove the spool holder to refill the trimmer line.
2. Press the spool cover latches (A) while pulling the retainer (B) to release the assembly.
3. Remove the empty spool (C), being careful not to lose the spool spring.
4. Check all components for cracks, fissures, or excessive wear. Replace any damaged components immediately.
5. Cut a piece of line about 16.5 feet long.

6. Fold the line in half and insert it into slot (D).
7. Wind each end of the line clockwise onto the spool grooves (upper and lower).
8. Leave about 6 inches of each end of the line unwound. Insert the ends of the line through the additional notches (E) on the top of the spool.
9. Place the spool in the retainer and thread each end of the line through the corresponding slots (F).
10. Align the spool cover latches with the holes in the retainer and press until you hear a click (G).

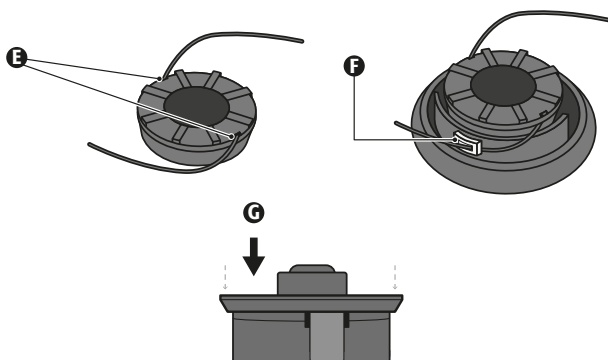
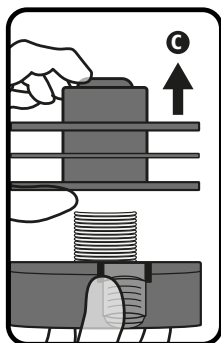
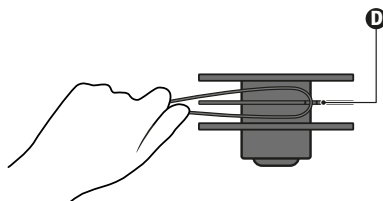
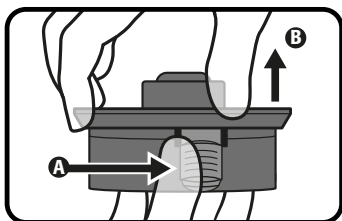

Brush cutter balance

- Put on the harness and adjust it to fit securely and comfortably.
- Attach the harness to the straight shaft harness ring on the brush cutter.
- Move the ring up and down until the brush cutter is balanced in a way that the cutting head points downwards, below your waist level, and no more than 29.5" off the ground.
- When using with a spool, the cutting head should lightly touch the ground (**A**).
- When using with a blade or circular saw, the cutting head should be approximately 8" above the ground (**B**).

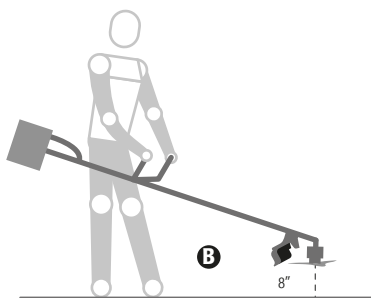
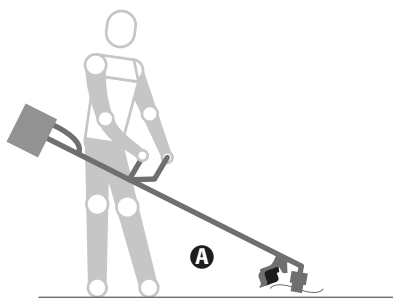
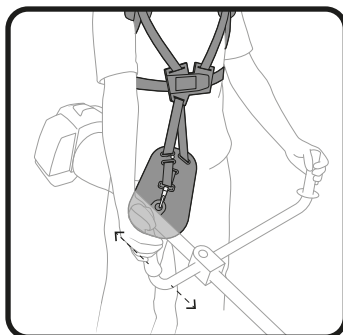

Fueling the engine

- Follow the safety guidelines for fuel handling (page 5).
- Wait for the engine to cool down completely before fueling.
- Place the brush cutter on a flat surface.
- Clean around the fuel tank cap to prevent contamination.
- Loosen the fuel tank cap slowly.
- Carefully pour the fuel mixture into the tank, taking care to avoid spills. **CAUTION** Follow the fuel specifications (page 3).
- Before replacing the fuel tank cap, inspect and clean the gaskets.
- Immediately replace the fuel tank cap and tighten it by hand.
- Clean up any fuel spills.

CAUTION In a new engine, it is normal to have smoke emissions during and after its first use.

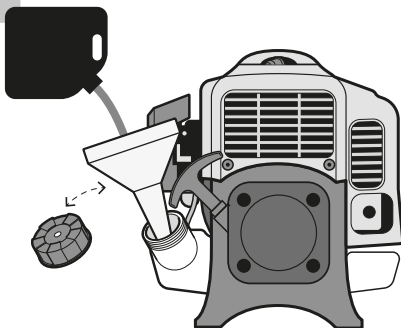

Start up

Cold start

- Set the gas brushcutter on levelled ground using care the blade is not making contact with any obstacle.
- Set the switch into the ON position (A).
- Press and release the Starter choke 10 times (B).
- Move the Starter choke lever upwards (C).
- Press simultaneously the trigger release and the throttle trigger. Still holding the trigger, push in the throttle lock button and release the trigger.
- Pull the jack-line (D) to start the motor. DO NOT pull more than 4 times to prevent flooding the motor.
- If the motor does not start, move the Starter choke lever downwards (E).
- Pull again the jack-line (F) until the motor starts. DO NOT pull more than 6 times (although, in cold weather the jack-line has to be pulled more time).
- If the motor is still not starting, repeat steps from (B) and on.
- Once the motor starts, leave it running a couple of seconds in that position.
- Press and release the throttle trigger to run the motor idle (G).
- The gas brushcutter is ready to operate. Hold both handles and lift it to start the job.

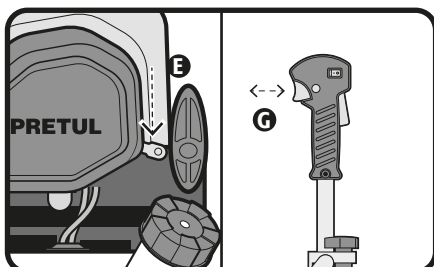
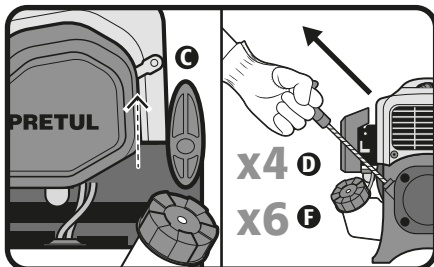
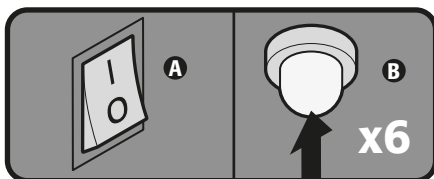

Start up

PRETUL

Starting the motor when hot

- Place the brush cutter on a level surface where the blade does not contact any obstacles.
- Set the switch to the "on" position (H).
- Pull the starter cord (J) until the engine starts.

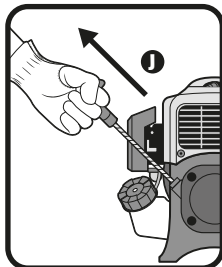
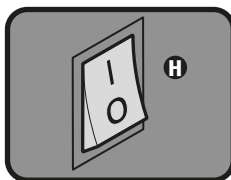

Shut down

- Press and hold the switch into the OFF position (E) until the motor stops.

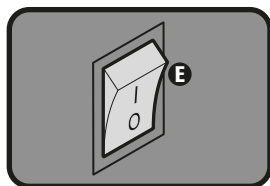

Operation

CAUTION • Keep in mind that you as a gas brushcutter operator are responsible of your safety as well as those who are close to the work area. Follow all safety standards (pages 4 and 5) before operating the gas brushcutter.

- Keep a balanced stance with both feet firmly supported on the ground.
- Firmly hold the gas brushcutter in front of you. One hand on the handle and the other hand on the auxiliary handle. Keep the gas brushcutter aligned to your body and point the cutter head 30° downwards away from your feet.

DANGER • Do not start or operate the gas brushcutter in a different stance.

- Start the gas brushcutter and cut from left to right while rotating your waist. Keep the gas brushcutter position.
- As you cut, the cutting thread will wear out and will fall apart. To release more thread from the spool, press the gas brushcutter against the ground to avoid wasting thread. The remaining thread is cut with the guard blade. At this moment stop pushing the gas brushcutter against the ground to avoid wasting thread.
- To cut brush or high grass make it gradually. Do not try to cut in one pass from the base because residues can get stuck in the cutter head or make you lose control over the gas brushcutter.

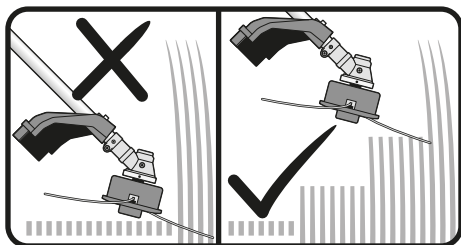
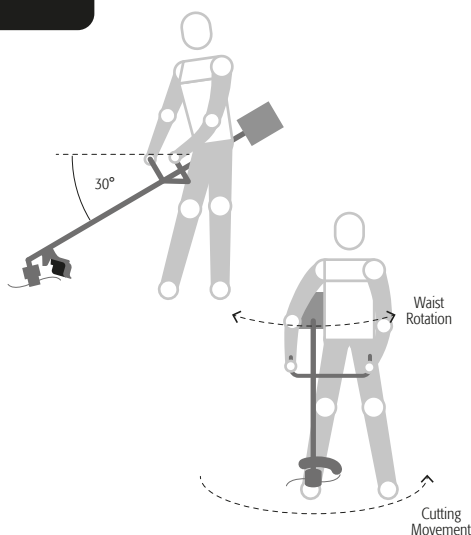

• Before inspecting, cleaning, or servicing the brush cutter, turn off the engine, wait for all moving parts to stop, disconnect the spark plug cable, and remove it from the spark plug. Otherwise, you may suffer severe injuries and/or damage to the equipment.

General cleaning

- Using a brush or compressed air, clean and clear the starter unit's ventilation slots whenever necessary.
- Similarly, periodically clean the engine cylinder fins and fan fins to remove any impurities. Failure to do so can cause the engine to overheat.

Air filter cleaning

- Remove the air filter cover by pressing the clip at the top of the cover.
- Take out the air filter.
- Depending on usage, you can give the filter a light cleaning by gently tapping it on a smooth, flat surface to dislodge most particles.
- You can also blow the filter with compressed air, doing so from both sides.
- For a more thorough cleaning, clean the air filter in warm soapy water, rinse it, and let it dry completely before reinstalling it in the weed trimmer.
- Reinstall the air filter, ensuring it fits into place.
- Clean the air filter as frequently as needed to always keep it clean; otherwise, the engine's efficiency may decrease.

Fuel filter

- Regularly check the gasoline filter.
- If the filter is dirty, it should be replaced.
- If the inside of the gasoline tank is dirty, rinse it with gasoline.

Carburetor adjustment

- It is recommended to have the carburetor adjustments done at a TRUPER Authorized Service Center.
- An incorrect adjustment can damage the engine and void the warranty.

Blade

- Always inspect and maintain the blade in optimal condition.
- Sharpen it, if necessary, with a flat file. Be careful not to alter the blade's profile and edge to ensure the weed trimmer's proper performance.

Changing the spark plug

- The engine uses a Torch L8RTC spark plug with a 0.025" electrode gap. Replace the spark plug with an identical one once a year.
- With the engine completely cold, loosen the worn spark plug to the left using a wrench and remove it.
- Insert the new spark plug and hand-tighten it to the right.

⚠ DANGER • Be careful not to damage the spark plug thread, as it could seriously damage the engine.

Exhaust and muffler cleaning

- The exhaust and muffler can become clogged with carbon deposits, depending on the type of fuel, the amount of oil used, and the operating conditions of the brush cutter. If you notice a loss of power, these deposits should be removed to restore performance. Visit a TRUPER Authorized Service Center for this service.
- The muffler is equipped with a spark arrester screen inside. After long periods of use, the screen becomes dirty, and the muffler should be replaced. Visit a TRUPER Authorized Service Center to perform the replacement.

⚠ DANGER • Constantly check that the muffler has securely fastened fasteners and that there are no damages or corrosion. If you find a leak, stop the brush cutter, and take it immediately to a TRUPER Authorized Service Center for repair.

Lubrication

- The inside of the cutting head gearbox is lubricated with lithium-based multi-purpose grease. Replenish the grease every 50 hours of use.
- Remove the bolts on the sides of the gearbox to introduce new grease through one of the holes while the used grease can exit through the other.

Gas brushcutter Storage

In the event of storing the gas brushcutter for one month or longer, bear in mind the following considerations:









- Drain all the fuel tank contents into an approved gasoline container. All the remaining fuel can be re-used in another tool that uses 2-stroke motor with a 40:1 ratio.
- Start the motor until the rest of fuel is consumed and the motor shuts down. This will eliminate the fuel residues and will prevent gum formations that damage the fuel system.
- Clean the gas brushcutter thoroughly.
- Store the unit in a well-ventilated space, away from corrosive agents such as garden chemical products or de-icing salts. And away from children's reach.
- Observe all the government rulings concerning safety in management and storing fuel.

Regular maintenance	Every use	Every 25 h of use	Every 50 h of use	Every 150 h of use	Every 250 h of use
General cleaning					
Air filter cleaning					
Cutterhead Gearbox Lubrication					
Carburetor cleaning *					
Spark plug inspection and adjustment *					
Fuel tank cleaning **					
Fuel filter change **					
Fuel chamber replacement **					
Combustion chamber cleaning **					

* Trained user or TRUPER Authorized Service Center

** TRUPER Authorized Service Center

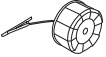
Available accessories and replacement parts list

Component	Code	Part	Description
	29031	RET-DES-52P	Spool retainer
	29032	TAP-DES-52P	Spool cap
	29033	REP-DES-52P	Trimmer spool and line
	29034	CUT-DES-52P	Brush cutter blade
	29035	CB-DES-52P	String trimmer carburetor
	29036	KC-DES-52P	Carburetor maintenance kit
	29040	TAPG-DES-52P	Fuel cap
	29041	FILG-DES-52P	Air filter

Problem	Cause	Solution
The motor does not start.	<ul style="list-style-type: none"> • There is no spark. • There is no fuel. • The motor is flooded. • The starter jack-line is harder to pull than when it was new. 	<ul style="list-style-type: none"> • Check the spark. Remove the motor cover. Remove the spark plug from the cylinder. Connect the spark plug cable and set it onto the motor cylinder, with the metal part touching the cylinder. Pull the jack-line and observe the spark in the spark plug electrode. If there is no spark, repeat the test using a new spark plug. • Press the starter choke until fuel is visible in the bulb. If fuel is not visible, it means the primary system in the fuel supply is blocked. Contact a TRUPER Authorized Service Center. If the starter choke is filled with fuel, the motor is flooded. • With the switch off, remove the spark plug. Move the choke lever downwards and pull the jack-line 15 to 20 times to eliminate excessive fuel from the motor. Clean the spark plug and set it back in place. Follow the normal starting procedure (see page 10). If the motor is not starting, repeat the procedure using a new spark plug. • Take the gas brushcutter to a TRUPER Authorized Service Center.
The motor starts but will not accelerate.	<ul style="list-style-type: none"> • The motor needs a couple of minutes to be hot. 	<ul style="list-style-type: none"> • Allow the motor to be completely hot. If the motor will not accelerate after three minutes, contact your TRUPER Authorized Service Center.
The motor starts but runs only in high speed with half a choke.	<ul style="list-style-type: none"> • The carburetor has to be adjusted. 	<ul style="list-style-type: none"> • Take the gas brushcutter to a TRUPER Authorized Service Center.
The motor is not reaching full speed and starts having smoke emissions.	<ul style="list-style-type: none"> • Check the oil / fuel mix. • The air filter is dirty. • The spark arrest screen is dirty. 	<ul style="list-style-type: none"> • Use new fuel and the right oil mix for a 2-stroke motor. • Clean the air filter. See page 12. • Take the gas brushcutter to a TRUPER Authorized Service Center.
The motor starts, runs, accelerates but there is no idle speed.	<ul style="list-style-type: none"> • The idle screw in the carburetor need to be adjusted. 	<ul style="list-style-type: none"> • Turn the idle screw clockwise to increase speed.

In the event of any problem contacting a TRUPER Authorized Service Center, please see our webpage WWW.TRUPER.COM to get an updated list, or call our toll-free numbers 800 690-6990 or 800-018-7873 to get information about the nearest Service Center.

AGUASCALIENTES **DE TODO PARA LA CONSTRUCCIÓN**
GRAL. BARRAGÁN #1201, COL. GREMIAL, C.P. 20030,
AGUASCALIENTES, AGS. TEL.: 449 994 0537

BAJA CALIFORNIA **SUCURSAL TIJUANA**
AV. LA ENCANTADA, LOTE #5, PARQUE INDUSTRIAL EL
FLORIDO II, C.P. 22244, TIJUANA, B.C.
TEL.: 664 969 5100

BAJA CALIFORNIA SUR **FIX FERRETERÍAS**
FELIPE ÁNGELES ESQ. RUIZ CORTÍNEZ S/N, COL. PUEBLO
NUEVO, C.P. 23670, CD. CONSTITUCIÓN, B.C.S.
TEL.: 613 132 1115

CAMPECHE **TORNILLERÍA Y FERRETERÍA AAA**
AV. ÁLVARO OBREGÓN #324, COL. ESPERANZA
C.P. 24080 CAMPECHE, CAMP. TEL.: 981 815 2808

CHIAPAS **FIX FERRETERÍAS**
AV. CENTRAL SUR #27, COL. CENTRO, C.P. 30700,
TAPACHULA, CHIS. TEL.: 962 118 4083

CHIHUAHUA **SUCURSAL CHIHUAHUA**
AV. SILVESTRE TERRAZAS #128-11, PARQUE INDUSTRIAL
BAFAR, CARRETERA MÉXICO CUAUHTÉMOC, C.P. 31415,
CHIHUAHUA, CHIH. TEL.: 614 434 0052

MEXICO CITY **FIX FERRETERÍAS**
EL MONSTRUO DE CORREGIDORA, CORREGIDORA # 35,
COL. CENTRO, C.P. 06060, CUAUHTÉMOC, CDMX.
TEL.: 55 5522 5031 / 5522 4861

COAHUILA **SUCURSAL TORREÓN**
CALLE METAL MECÁNICA #280, PARQUE INDUSTRIAL
ORIENTE, C.P. 27278, TORREÓN, COAH.
TEL.: 871 209 68 23

COLIMA **BOMBAS Y MOTORES BYMTESA DE MANZANILLO**
BLVD. MIGUEL DE LA MADRID #190, COL. 16 DE
SEPTIEMBRE, C.P. 28239, MANZANILLO, COL.
TEL.: 314 332 1986 / 332 8013

DURANGO **TORNILLOS ÁGUILA, S.A. DE C.V.**
MAZURIO #200, COL. LUIS ECHEVERRÍA, DURANGO,
DGO. TEL.: 618 817 1946 / 618 818 2844

ESTADO DE MÉXICO **SUCURSAL CENTRO JILOTEPEC**
PARQUE INDUSTRIAL # 1, COL. PARQUE INDUSTRIAL
JILOTEPEC, JILOTEPEC, EDO. DE MÉX. C.P. 54257
TEL.: 761 782 9101 EXT. 5728 Y 5102

GUANAJUATO **CÍA. FERRETERA NUEVO MUNDO S.A. DE C.V.**
AV. MÉXICO - JAPÓN #225, CD. INDUSTRIAL, C.P. 38010,
CELAYA, GTO. TEL.: 461 617 7578 / 79 / 80 / 88

GUERRERO **CENTRO DE SERVICIO ECLIPSE**
CALLE PRINCIPAL MZ 1 LT. 1, COL. SANTA FE, C.P. 39010,
CHILPANCINGO, GRO. TEL.: 747 478 5793

HIDALGO **FERREPRECIOS S.A. DE C.V.**
LIBERTAD ORIENTE #304 LOCAL 50, INTERIOR DE PASAJE
ROBLEDO, COL. CENTRO, C.P. 43600, TULANCINGO,
HGO. TEL.: 775 753 6615 / 775 753 6616

JALISCO **SUCURSAL GUADALAJARA**
AV. ADOLFO B. HORN # 6800, COL. SANTA CRUZ DEL
VALLE, C.P.: 45655, TLAJOMULCO DE ZUÑIGA, JAL.
TEL.: 33 3606 5285 AL 90

MICHOACÁN **FIX FERRETERÍAS**
AV. PASEO DE LA REPÚBLICA #3140-A, COL.
EX-HACIENDA DE LA HUERTA, C.P. 58050, MORELIA,
MICH. TEL.: 443 334 6858

MORELOS **FIX FERRETERÍAS**
CAPITÁN ANZÚRES #95, ESQ. JOSÉ PERDIZ, COL.
CENTRO, C.P. 62740, CUAUTLA, MOR.
TEL.: 735 352 8931

NAYARIT **HERRAMIENTAS DE TEPIC**
MAZATLAN #117, COL. CENTRO, C.P. 63000, TEPIC, NAY.
TEL.: 311 258 0540

NUEVO LEÓN **SUCURSAL MONTERREY**
CARRETERA LAREDO #300, 1B MONTERREY PARKS,
COLONIA PUERTA DE ANAHUAC, C.P. 66052, ESCOBEDO,
NUEVO LEÓN, TEL.: 81 8352 8791 / 81 8352 8790

OAXACA **FIX FERRETERÍAS**
AV. 20 DE NOVIEMBRE #910, COL. CENTRO, C.P. 68300,
TUXTEPEC, OAX. TEL.: 287 106 5092

PUEBLA **SUCURSAL PUEBLA**
AV. PERIFÉRICO #2-A, SAN LORENZO ALMECATLA,
C.P. 72710, CUAUHTLACINGO, PUE.
TEL.: 222 282 8282 / 84 / 85 / 86

QUERÉTARO **ARU HERRAMIENTAS S.A. DE C.V.**
AV. PUERTO DE VERACRUZ #110, COL. RANCHO DE
ENMEDIO, C.P. 76842, SAN JUAN DEL RÍO, QRO.
TEL.: 427 268 4544

QUINTANA ROO **FIX FERRETERÍAS**
CARRETERA FEDERAL MZ. 46 LT. 3 LOCAL 2, COL. EJIDAL,
C.P. 77710 PLAYA DEL CARMEN, Q.R.
TEL.: 984 267 5140

SAN LUIS POTOSÍ **FIX FERRETERÍAS**
AV. UNIVERSIDAD #1850, COL. EL PASEO, C.P. 78320,
SAN LUIS POTOSÍ, S.L.P. TEL.: 444 822 4341

SINALOA **SUCURSAL CULIACÁN**
AV. JESÚS KUMATE SUR #4301, COL. HACIENDA DE LA
MORA, C.P. 80143, CULIACÁN, SIN.
TEL.: 667 173 9139 / 173 8400

SONORA **FIX FERRETERÍAS**
CALLE 5 DE FEBRERO #517, SUR LT. 25 MZ. 10, COL.
CENTRO, C.P. 85000, CD. OBREGÓN, SON.
TEL.: 644 413 2392

TABASCO **SUCURSAL VILLAHERMOSA**
CALLE HELIO LOTES 1, 2 Y 3 MZ. #1, COL. INDUSTRIAL,
2A ETAPA, C.P. 86010, VILLAHERMOSA, TAB.
TEL.: 993 353 7244

TAMAULIPAS **VM ORINGS Y REFACCIONES**
CALLE ROSITA #527 ENTRE 20 DE NOVIEMBRE Y GRAL.
RODRÍGUEZ, FRACC. REYNOSA, C.P. 88780, REYNOSA,
TAMS. TEL.: 899 926 7552

TLAXCALA **SERVICIOS Y HERRAMIENTAS INDUSTRIALES**
PABLO SIDAR #132, COL. BARRIO DE SAN BARTOLOMÉ,
C.P. 90970, SAN PABLO DEL MONTE, TLAX.
TEL.: 222 271 7502

VERACRUZ **LA CASA DISTRIBUIDORA TRUPER**
BLVD. PRIMAVERA ESQ. HORTENSIA S/N, COL.
PRIMAVERA, C.P. 93308, POZA RICA, VER.
TEL.: 782 823 8100 / 826 8484

YUCATÁN **SUCURSAL MÉRIDA**
CALLE 33 #600 Y 602, LOCALIDAD ITZINCAB Y MULSA,
MPIO. UMAN, C.P. 97390, MÉRIDA, YUC.
TEL.: 999 912 2451

Code	Model	Brand
26104	DES-52P	PRETUL

Warranty. Duration: 1 year. Coverage: parts, components and workmanship against manufacturing or operating defects, except if used under conditions other than normal; when it was not operated in accordance with the instructive; was altered or repaired by personnel not authorized by TRUPER®. To make the warranty valid, present the product, stamped policy or invoice or receipt or voucher, in the establishment where you bought it or in Corregidora 35, Centro, Cuauhtémoc, CDMX, 06060, where you can also purchase parts, components, consumables and accessories. It includes the costs of transportation of the product that derive from its fulfillment of its service network. Phone number 800-018-7873. Made in China. Imported by TRUPER, S.A. de C.V. Parque Industrial 1, Parque Industrial Jilotepec, Jilotepec, Edo. de Méx. C.P. 54257, Phone number 761 782 9100.



Stamp of the business. Delivery date: