

Manual

Concrete mixer RECE-160P

42.2 Gallons

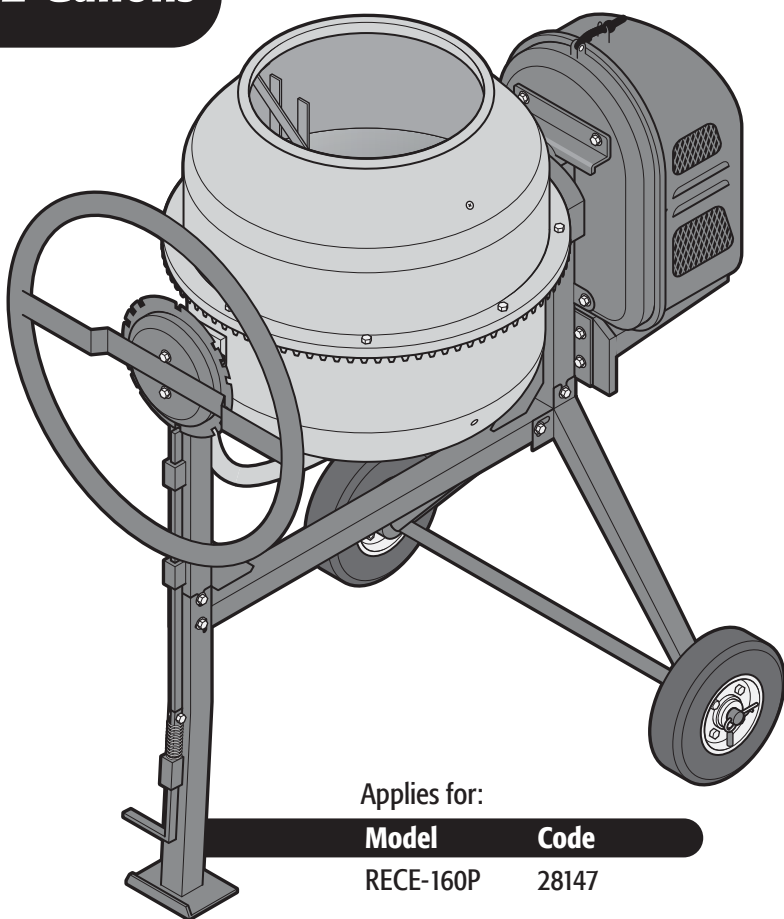

Applies for:

Model	Code
RECE-160P	28147



Read this manual thoroughly
before using the tool.



Technical data	3
Fuel requirements	3
 Safety warnings for motor tools	4
 Safety warnings for concrete mixers	5
Parts List	6
Assembly	7
Parts	9
Fuel and oil	10
Start up	11
Maintenance	13
Accessories and spare parts	14
Authorized Service Centers	15
Warranty policy	16

CAUTION

To gain the best performance, longer tool life span, make the warranty valid if needed, and to avoid risks or fatal injuries please read and understand the entire manual prior to using the tool.

Keep this manual for future references.

The illustrations in the manual are for reference only. May be different from the real tool.

Use and care recommendations



DO NOT start the machine **WITHOUT OIL** or the engine will suffer serious damage due to lack of lubrication.



For optimal **PERFORMANCE** and durability, use higher-octane gasoline. In Mexico, we recommend using **PREMIUM** gasoline. **AVOID USING** contaminated gasoline or gasoline mixed with additives or oils.



Keep the engine's ventilation slots **CLEAR**.



Perform regular **MAINTENANCE** on your machine (Page 13).

RECE-160P

Code •	28147
Description •	Gasoline motor Concrete mixer
Drum capacity •	42.2 Gallons
Mix capacity •	31.7 Gallons
Capacity per bag •	0.5
Production per hour •	634 Gal/h
Drum speed •	33 RPM
Drum's opening diameter •	15.75"
Motor •	4-cycle OHV
Motor cylinders capacity •	99 cc
Potency •	2.5 Hp
Maximum speed •	3 600 RPM
Production cycle •	3 minutes
Operating time •	2 h
Fuel •	Gasoline
Fuel tank •	0.34 Gallons
Work cycle •	60 minutes idle per tank consumed

Fuel requirements

- The concrete mixer has an air-cooled 4-stroke motor using pure unleaded gasoline.
- Leaded or dirty gasoline increase deposits in the motor and makes its life span shorter.
- Under no circumstance ever mix oil with the fuel.

⚠ WARNING • Do not smoke near fuel or the gasoline filling up area or when operating the concrete mixer.

⚠ WARNING • Under no circumstance ever use fuel mixed with ethylic alcohol (gasohol), ethanol or methanol. These substances attract humidity causing separation and acid formation while stored. Acidity can damage the motor fuel system when it is stored.

- Avoid having problems with the motor. Drain the fuel system before storing the mixer for periods of 30 days or longer. Drain the gasoline tank, start the motor and let it run until the fuel and carburetor lines are empty. Use fresh gasoline after long periods in storage.
- Do not use motor or carburetor cleaning products inside the gasoline tank. These products cause permanent damage.

⚠ CAUTION • The mixer motor is built with an oil deposit. It is fundamental for its performance prevents damaging the motor.

⚠ WARNING • Check oil level before using the Concrete Mixer. Fill up wit 4-cycle motor automotive oil SAE 10W-30.





Keep your work area tidy and with good lighting.

CAUTION Cluttered and dark areas can cause injuries.



Never use the mixer in explosive environments or where there are flammable liquids present.

DANGER Set the mixer 30 ft. away from the fuel filling up area before starting the motor.



Keep children and passersby at a safe distance while the mixer is operating.

WARNING Distractions can make you loose control and cause accidents.



Avoid making contact with power lines and circuits.

DANGER Find and avoid all power lines and circuits, especially hidden wiring. Also keep away from grounded objects.



Stay always alert, be prudent and use common sense.

CAUTION Even tough you are familiar with the use of the mixer do not get distracted while operating the machine. It can cause accidents.

Do not operate the mixer when tired or under the influence of drugs, alcohol or medication.

DANGER A moment of distraction while operating the mixer can cause severe personal injury.

Use the mixer with the guards and protector installed and in good repair.

WARNING Failure to comply with this warning leads to severe personal injury.

Never force the concrete mixer.

CAUTION Working within the range designed assures a better job and is safer.



Store the mixer in a safe place away from the reach of children.

WARNING Motor concrete mixers are dangerous near inexperienced hands.



Wear the right clothes.

WARNING Loose clothing, jewelry or long hair can get tangled in the moving parts.



Keep your hands away from the rotating or moving parts.

WARNING Failure to comply with this warning leads to severe personal injury.



Do not use the mixer in enclosed areas.

DANGER To prevent accumulation of carbon monoxide, an odorless toxic gas potentially deadly.



Use the right personal protection equipment.

CAUTION Using eye protection, anti-dust masks, non-skid safety shoes, helmet, hearing protection and safety gloves considerably reduce the risk of injury.



Turn off the mixer before adjusting, changing accessories or storing.

WARNING Double-check the mixer motor switch is in the OFF position.

Never run the mixer if the switch is not working or is not duly assembled.

WARNING The operator is exposed to severe injury. Take it to repair immediately to a Authorized Service Center.

Do not overreach.

Good footing and balance give better control of the mixer in unexpected situations.

CAUTION

Prevent unintentional starting.

Double-check the mixer motor is OFF before

leaving or servicing.

WARNING

Remove any vise fixed in the mixer before starting it.



Additional tools or wrenches fixed in a rotating part in the mixer can cause

DANGER severe personal injury.

Service the mixer and double-check it is in the best conditions before starting it.

Check carefully the moving parts. See alignment and assembly. Do it

CAUTION periodically. Look for damaged elements or part that is not functioning correctly. Repair immediately in a TRUPER Authorized Service Center.



Accessories.

CAUTION Use only accessories or spare parts indicated in this Manual or certified by TRUPER.

Never leave the concrete mixer running and unattended.

DANGER To prevent severe accidents turn off the mixer after operating and before setting it in a safe place.

Never smoke near fuel.



DANGER Do not smoke near the area where fuel is being supplied or when operating the mixer.



Safety warnings for concrete mixers

PRETUL

Fuel handling

- Never smoke near the fuel, nor the supply area or when operating the mixer. 
- Reduce the risk of fire or burns. Handle fuel with care. It is extremely flammable. 
- Prevent gasoline or oil has contact with your skin.
- Protect your eyes. Prevent gasoline or oil spilling into your eyes. In case of accidental contact wash your eyes immediately with clean water. If irritation persists visit your doctor.
- Store fuel in an approved container.
- **WARNING** • Before refueling the mixer turn off the motor, set it on clear floor and wait for the motor to cool down.
- **CAUTION** • Wipe clean all the fuel that dripped in the mixer before operating.
- **CAUTION** • To prevent fire or burns look for fuel leaks. If there are any correct them before using the mixer.
- Set the mixer at least 30 feet away from the refueling site before starting the motor.
- Never burn spilled fuel to eliminate it.
- Under no circumstance use any other type of fuel to the mixer different to the specified in this instructions.

Cement handling

- **WARNING** • Contact with cement produces skin dermatitis and burns that can be very serious. If inhaled y causes nose and throat irritation and in the long-term considerable damage. Contact with eyes causes red eyes, chemical burns and even blindness.
- **CAUTION** • To prevent risk and injury is necessary that people handling cement wear the right personal protection equipment: alkali-resistant gloves, high water-proof boots, overall with long sleeves, slacks, full protection glasses and anti-dust mask.





- Covering with adhesive tape the shirtsleeves inside the gloves is recommended. Do not wear wristwatch, rings or bracelets. Cement can get accumulated underneath the jewelry.
- Tuck the pants legs inside the waterproof boots.
- If possible, use waterproof pads between the concrete and knees, elbows and hands.
- Eliminate immediately the wet cement falling or spilling in your clothes.
- Most of cement burns are produced in the inner side of the legs when fresh cement penetrates through faulty protective shoes. Fresh cement slowly harms skin. When the worker feels the chemical burn, the injury is set.
- **CAUTION** • In the event cement is in contact with the skin or gets trapped between skin and clothes, immediately wash the contaminated skin and clothes with large amounts of clean running water. If there is no access

to water use a cloth dampened with vinegar to wash the contaminated area.

- To prevent contact with fresh cement the workers need to follow good hygiene measures aside from the personal protection equipment. Start the workday with clean clothes and finish with a shower.
- Wash clothes as soon as possible when workday is over.
- Separate work clothes from the rest of the family's when washing.
- Wear rubber gloves to wash work clothes. If skin is in contact with clothes wash the area with soap and water.
- Wash clothes with hot water using double amount of detergent that for a regular wash.
- If using a washing machine, decontaminate the washing machine running a full washing cycle empty, without clothes, use hot water and detergent before using it for the regular laundry.

Concrete mixer operation

- Operate the mixer in a well-leveled floor that can support its weight. Use wedges to level the machine in case it wobbles.
- Before using the mixer, double-check there is enough workspace around.
- Keep the area around the mixer free of debris, grease, oil or any obstacle that would make the operator to trip over the moving parts.
- Never put hands or any tool into the mixer drum while it rotates.
- Do not wear loose clothes near the mixer. They could get tangled in the drum's serrated rack and cause an accident. 
- Do not get hands near the moving drum's serrated rack. 
- Do not try to move the mixer when loaded or functioning.
- The concrete mixer is designed to produce concrete mixes, mortar and plaster. It is not suitable to mix any other material, let alone flammable or explosive substances.
- It is not advisable start the motor if the drum is loaded.
- Before operating the mixer verify the pulley is perfectly fasten to the drum transmission spindle.

PRETUL

Safety warnings for concrete mixers

- When loading or unloading the mixer keep both legs firm and balanced.
- Never stand up on the mixer. It could tilt over you or the moving parts could trap you and cause severe injury.
- Remember the mixer can only be manipulated and controlled by means of the control flywheel and when the motor is running. Do not set your hands or your body close to the mixer when the motor is running. Do not get your hands or body near the moving drum.



- CAUTION** • Never load material into a stopped drum. It shall always be in movement.
- CAUTION** • Never stop a loaded drum. It shall be unloaded and empty before stopping it.
- CAUTION** • DO NOT TOW. The mixer shall never be towed away using a vehicle.
- Do not leave the mixer unattended and unsupervised until it is turned off and has come to a complete stop.

Parts List

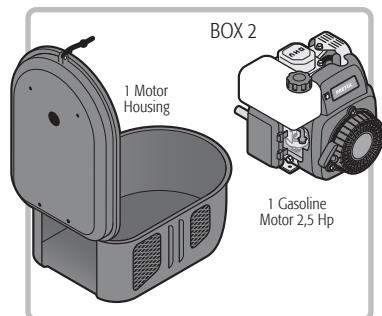
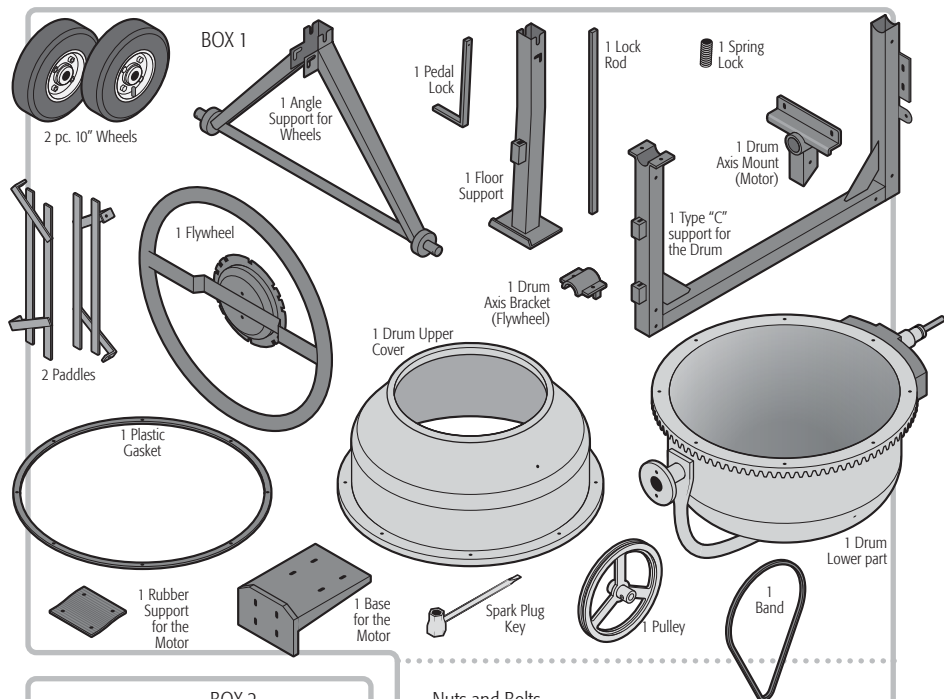

Nuts and Bolts

3 pins	2 for the wheels and 1 for the pedal spring
13 sets (*)	M8x70 Supports Hex Bolts
4 sets (*)	M8x20 Brackets Hex Bolts
10 sets (*)	M8x16 Drum Hex Screws
1 sets (*)	M6x25 Insurance Rod Hex Bolts
4 sets (*)	M10x20 Paddles Recessed Head Screws (includes insulated washers to seal the drum)
1 retainer ring	For the drum axis

* Each set includes: bolts or screws, washers and nuts.

Assembly

PRETUL

⚠ CAUTION • At least two people shall assemble the mixer.

- Assemble the mixer in a well-leveled floor that can support its weight. Use wedges to level the machine in case it wobbles.
- The mixer is shipped with all the screws and bolts. Use Allen keys set and the open-end wrenches necessary to assemble.

1. Set both wheels **(A)** in the axis structure sides **(B)**. Fasten both wheels with the pins **(C)**.

⚠ CAUTION Maximum load 300 lb at 25 PSI

2. Set the spring **(D)** in the release pedal edge **(E)** and set the pin **(D')** in the lower hole of the pedal, as indicated in the illustration. Pass the drum lock **(F)** through the frames **(G)**. Assemble the drum support **(H)** in the leg **(I)** and the wheels structure **(J)**.

3. Use four sets of M8 x 70 bolts, washers, pressure washers and nuts to fasten the drum support elements. Use a M6 x 25 bolts set and nuts to join the end of the release pedal and the drum lock.

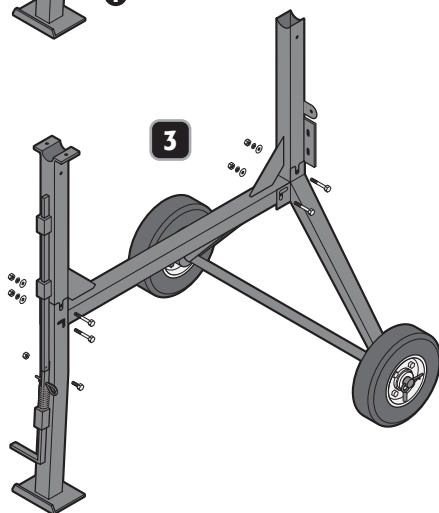
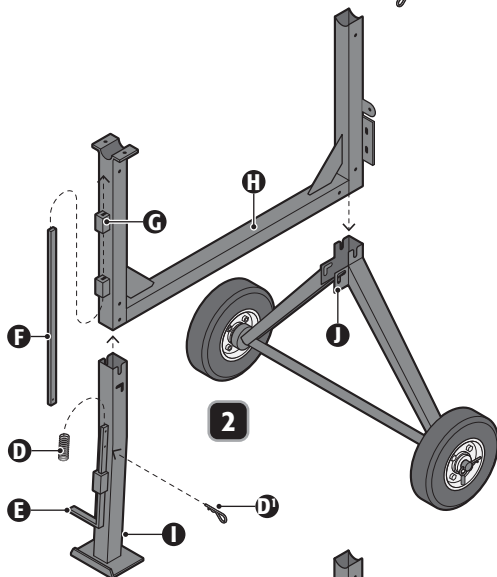
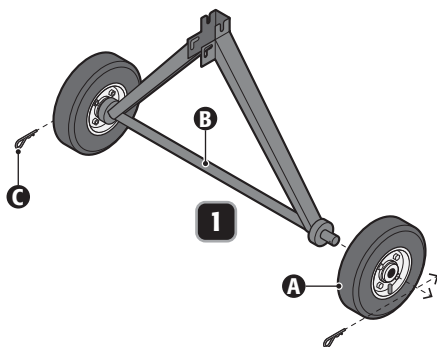

PRETUL

Assembly

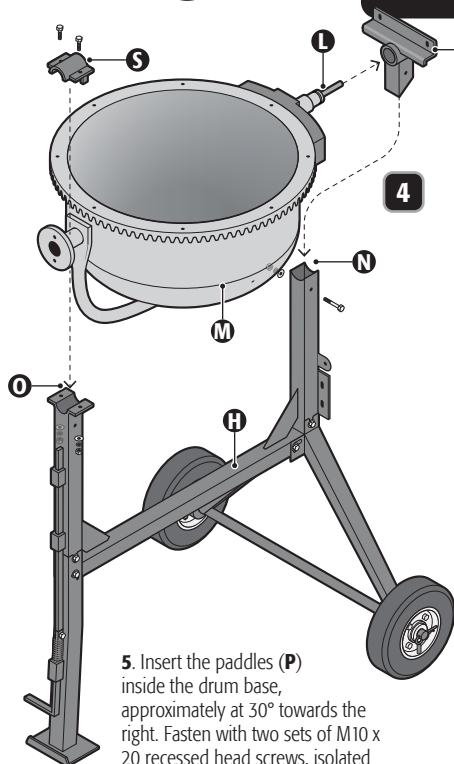

4. Set the frame (K) into the drum drive axis (L). Mount the lower part of the drum (M) into the support (H) inserting the frame (K) into the pole (N) and placing the support axis in the bracket (O). Use a set of M8 x 70 bolt, washer, pressure washer and nut to secure the mount to the support pole. Set the bracket (S) with the orientation as shown in the graphic to fasten the support axis. Use two sets of M8 x 20 bolts, washers, pressure washers and nuts. Tighten so that the clamp is well fixed, but also allows free movement of the drum.

CAUTION * The insulated washers shall be set outside the drum.

- Mount the drum cover (Q) into the frame (K) and the support rod using four sets of M8 x 70 bolts, washers, pressure washers and nuts.
- Place the retaining ring (U) on the ribbed side of the bearing support from the drum axis (X).

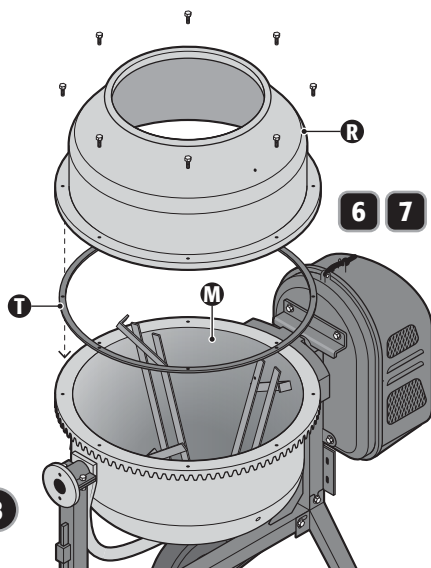
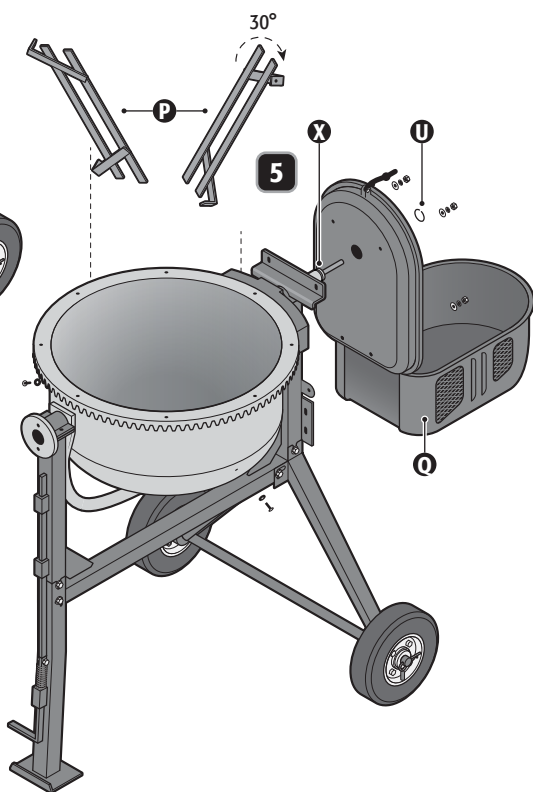

6. Set the plastic gasket (T) onto the drum base circumference matching the orifices. Fixing the gasket with adhesive tape is recommended to facilitate the mounting.

7. Set the drum cover (R) onto the base (M). Secure the cover with 10 M8 x 16 screws.

Assembly

PRETUL

8. Mount the control flywheel in the support axis (A). Use two M8 x 20 sets of bolts, washers, pressure washers and nuts to secure the flywheel in place.

• Secure the upper part of the paddles (P) to the drum cover using two sets of M10 x 20 recessed head screws, insulated washers * pressure washers and nuts.

⚠ CAUTION * The insulated washers shall be set outside the drum.

9. Mount the base for the motor (F) on the motor support (N) using four sets of M 8 x 70.

10. Mount the pulley (B) to the drum axis (C) as shown in the graphic, and fasten firmly using the allen screw that has the pulley in the flat area of the drum axis.

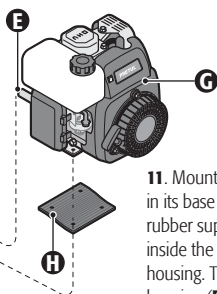
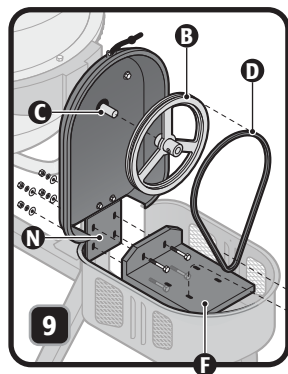

11. Mount the motor (G) in its base (F) over the rubber support (H) inside the motor housing. The motor housing (E) shall be oriented towards the drum.

12. Couple the pulley (B) to the motor axis (E) placing the band (D) in the outer circumference of the pulley and the motor axis. **⚠ CAUTION** The band (D) should not work outside the slot of the pulley (B) and/or the motor axis (E). The motor base (F) contains slotted holes that allow you to move the motor from back to front to align the motor shaft with the pulley.

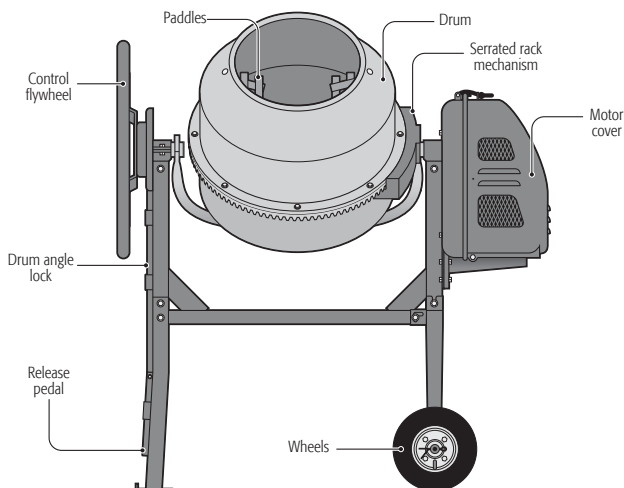
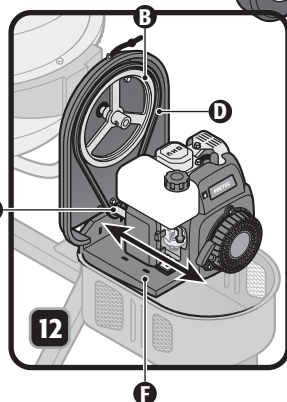

Parts

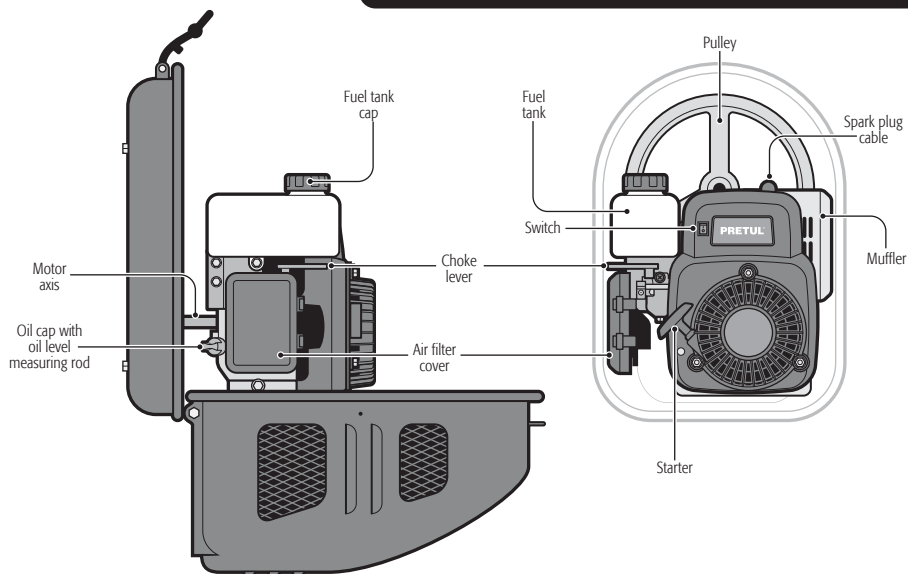

Fuel and oil

Oil supply

- Verify the oil level: Remove the oil cap with oil level measuring rod (A) and wipe it clean. Set the cap in place again but do not thread it. Remove the cap once more and check oil level.
- If oil level is close to or below the lower limit marked in the measuring rod, fill up with oil up to the oil level marked in the measuring rod barely touches the upper limit marked. Set the cap back and thread it.

CAUTION • The motor can seriously get damaged with no oil. Always check oil level before operating the mixer. The mixer shall always sit on level ground to correctly measure the oil level.

Fuel supply

- Set the mixer onto flat and leveled surface.
- Clean and dry the area around the fuel cap.
- Remove the fuel cap (B).
- Using a funnel fill up the fuel tank slowly up to the maximum level mark.
- Clean any fuel spilling.
- Close the cap turning it until hearing a click.
- Clean any fuel spills before starting the mixer.

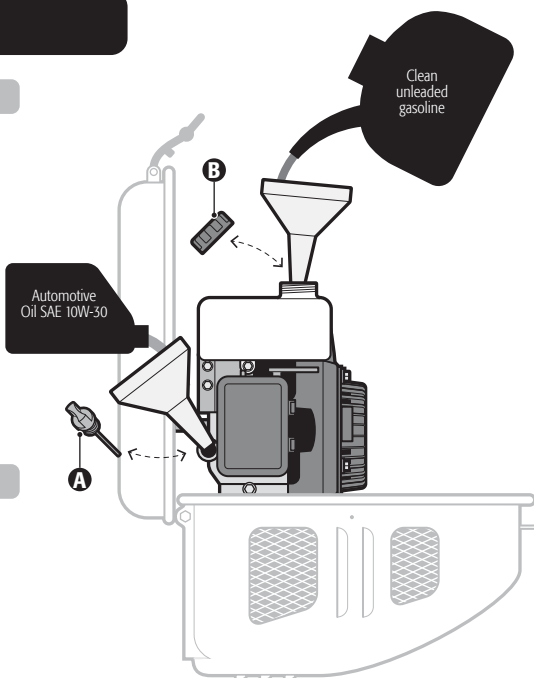

Turning on

- Move the choke lever (A) into the closed (|↘|) position. **⚠ CAUTION** When the motor is hot or room temperature is too high, it is not necessary to close the shutter before starting.
- Set the switch (B) in the ON position (I).
- Pull the starter (C) lightly until feeling resistance, then pull fast and using strength. When pulling the starter, set it back lightly to the original position. Do not allow it to snap back.
- Let the motor warm up a few seconds and then move gradually the choke lever (A) into the open (|↑|) position.

Note: The engine cover should always be closed while the revolution is in operation.

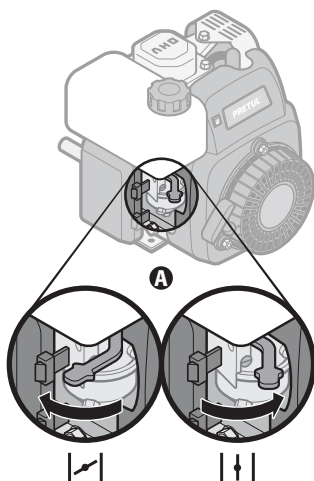

Turning off

- **⚠ CAUTION** • Remove the load from the mixer drum before shutting off the motor. Otherwise the load could set before its time. Only in an emergency the motor shall be turned off even if the drum is load.
- Turn off the switch (B).
- Move the choke lever (A) into the closed (|↘|) position.

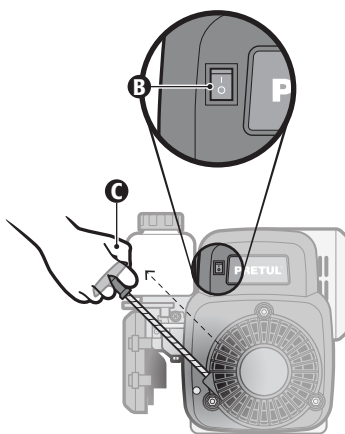

Operating in high altitudes

- In high altitudes the air-fuel mix in the carburetor will lower the motor performance and the fuel consumption will increase.
- The mixer's motor is adjusted to operate at altitudes higher than 6561 ft above sea level. If you notice the performance is being poor, go to a

TRUPER Authorized Service Center to regulate the carburetor and adjust the main bolt.

- Even if the mixer's motor has an adequate carburetor injection, power will diminish approximately 3,5% per each 984 ft increase in height. Low performance will be accentuated if no modification is made in the carburetor.

⚠ WARNING • If the mixer's motor is operated in heights different to which the carburetor is adjusted, aside from the low performance, there could also be overheating and severe damage to the motor caused by the excessive air-fuel mix.

Drum tilt

- The control flywheel turns in the same direction as the drum angle. It easily controls the drum-working angle: to mix, unload and to store it.
- The slots in the flywheel inner disc determine the work angles.
- To turn the flywheel in the desired angle, step on the release pedal.
- To block the drum angle align the flywheel slot with the pin and release the pedal so that the pin can get coupled into the slot.

Loading material

⚠ WARNING • Start the mixer motor before loading the drum. Always load material with the drum rotating. Otherwise the mixer gets ruined and the warranty is void.

⚠ CAUTION • Slowly load the material into the drum's mouth. Do not throw all the material at once. Otherwise it adheres firmly to the drum.

• To get the right mix load the material in this order:

1. Load the required amount of gravel.
2. Load the required amount of cement.
3. Load the required amount of sand.
4. Pour the required amount of water.

Unloading the material

• When the mix is ready and without stopping the mixer motor set the drum in its unloading position.

⚠ CAUTION • Do not turn off the motor until the drum is completely empty.

Drum cleansing

• Clean the mixer thoroughly at the end of each workday. Keep the drum always clean. Eliminate all the dry cement, otherwise the accumulation of material adhere inside the drum could damage the drum and would make the warranty void.

• To clean the residues adhered after a workday use a small mix made of water and gravel and have the drum turn around five minutes. Unload the mix and hose down the gravel and water mix inside and outside the drum.

⚠ CAUTION • Do not put bricks inside the drum to clean it. Do not try to hit the drum with a shovel, hammer or any other tool to eliminate the adhered residues.

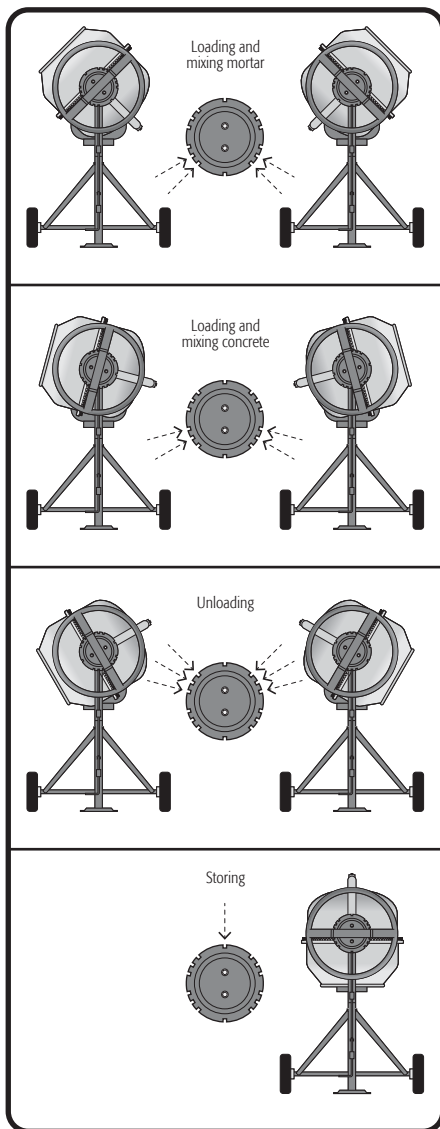

- ⚠ CAUTION** • Use only TRUPER original spare parts.
- ⚠ CAUTION** • Before servicing the mixer shut off the motor.
- Failure to comply with any of the previous points expose the user to severe injury or can damage the mixer. These damages are not covered by the Warranty.

General maintenance

- Inspect periodically all the bolts, nuts and screws are firmly tightened.
- Check the air filter regularly to make sure it is clean.
- Double-check the oil and fuel levels to refill when necessary.
- Verify the starter line. If frayed, go immediately to a TRUPER Authorized Service Center to replace it.
- Inspect periodically the band. It shall not be misaligned or show wear.
- Periodically clean and lubricate the rack mechanism.

Air filter cleansing

- Check air filter to assure is in good repair. Remember, a dirty air filter can make starting difficult, loosing performance and shorten the engine's useful life.
- Remove the filter cover. Release its two locks (A).
- Clean both sides of the filter with 25 PSI compressed air.
- If the filter has damage, humidity or is very dirty should be replaced.
- Set back the filter assuring the filter assemble correctly on the base.
- Replace the cover by assembling the tow locks (B).

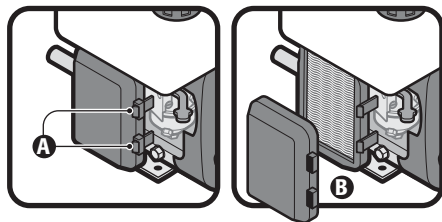

Oil change

- Set below the unit a suitable oil container.
- Uncover the oil tank input and remove the hex screw (A) from the bottom of the motor. Drain the oil and collect it into the container.
- Before filling again the oil tank, set and tighten the hex screw and follow instruction in page 10.

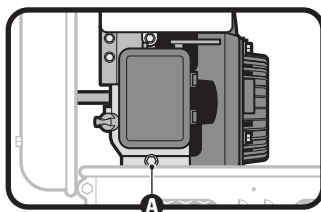

Spark plug maintenance

- Before removing the spark plug, clean the area around the spark plug base so that neither dusts nor debris enter the motor. Then, remove the spark plug.
 - Wipe clean the carbon deposits from the spark plug electrodes. Use a spark plug cleaner or a wire brush.
 - If the spark plug is worn or in doubt is still useful, replace the spark plug with a new one (Type: LG G5).
 - Verify the gap in the electrodes is 0.02" to 0.03". Adjust the gap bending carefully the ground connection electrode.
 - Verify the joint in the spark plug.
 - Set back the spark plug. Fix it in place, thread it and tighten manually.
 - Tighten with a wrench to press the washer. If using a new spark plug, turn it 1/2 to press the washer correctly. If using an old spark plug, turn it 1/8 to 1/4 to press the washer correctly.
- ⚠ CAUTION** Use care and tighten the spark plug correctly. Otherwise the motor could get hot in excess and get damaged.

Periodic maintenance

	Each use	Each 25 h or each 3 moths	Each 50 h or each 6 moths	Each 100 h or each 6 months	Each 250 h or each 2 years
General cleansing	✓				
Oil inspection	✓				
Oil change		(1)		✓	
Air filter inspection	✓				
Air filter		Perform cleaning			Change
Spark plug inspection and tightening				✓	
Spark plug replacement					✓
Throttle system inspection and tightening*				✓	
Valve inspection and tightening*				✓	
Combustion chamber cleansing*			Each 300 hours		
Fuel tank cleansing			✓		
Fuel filter cleansing*			✓		
Fuel hose replacement*					✓
Band replacement			Each year		

(1) Only applies to the first oil change

* Go to a TRUPER Authorized Service Center to carry out these replacements and tightening.





Long term storage

- Clean the fuel tank
- Start the motor until finishing all the fuel.
- After the fuel is consumed and the motor stops, turn off the switch and let the motor cool-off completely (30 minutes approximately).
- Empty the pump pulling the starter six times approximately.
- Drain oil as indicated in page 13.
- Disconnect the spark plug cable and remove it. Pour a little less than a spoonful of clean four-cycle motor oil through the spark plug orifice into the combustion chamber.
- Without the spark plug in place pull the starter two or three times to cover the inside wall of the cylinder.
- Service the spark plug as indicated in page 13.
- Clean the air filter as indicated in page 13.
- Store the concrete mixer in a dry and ventilated place under a roof and guarded against humidity.

Using the unit after long term storage

- Remove the spark plug from the cylinder.
- Pull the starter three to four times to clean the oil into the combustion chamber.
- Clean the spark plug oil and set it back in the cylinder.
- Connect the spark plug cable.
- Fill up fuel and oil as described in page 10.

Accessories and spare parts

	28134	KC-RECE-160P	Carburetor
	28135	BUJI-RECE-160P	Spark plug
	28136	FA-RECE-160P	Air filter
	28132	BAN-RECE-160P	Belt
	28133	RD-RECE-160P	Wheel

In the event of any problem contacting a TRUPER Authorized Service Center, please see our webpage WWW.TRUPER.COM to get an updated list, or call our toll-free numbers **800 690-6990** or **800-018-7873** to get information about the nearest Service Center.

AGUASCALIENTES **DE TODO PARA LA CONSTRUCCIÓN**
GRAL. BARRAGÁN #1201, COL. GREMIAL, C.P. 20030,
AGUASCALIENTES, AGS. TEL.: 449 994 0537

BAJA CALIFORNIA **SUCURSAL TIJUANA**
AV. LA ENCANTADA, LOTE #5, PARQUE INDUSTRIAL EL
FLORIDO II, C.P. 22244, TIJUANA, B.C.
TEL.: 664 969 5100

BAJA CALIFORNIA SUR **FIX FERRETERÍAS**
FELIPE ÁNGELES ESQ. RUIZ CORTÍNEZ S/N, COL. PUEBLO
NUEVO, C.P. 23670, CD. CONSTITUCIÓN, B.C.S.
TEL.: 613 132 1115

CAMPECHE **TORNILLERÍA Y FERRETERÍA AAA**
AV. ÁLVARO OBREGÓN #324, COL. ESPERANZA
C.P. 24080 CAMPECHE, CAMP. TEL.: 981 815 2808

CHIAPAS **FIX FERRETERÍAS**
AV. CENTRAL SUR #27, COL. CENTRO, C.P. 30700,
TAPACHULA, CHIS. TEL.: 962 118 4085

CHIHUAHUA **SUCURSAL CHIHUAHUA**
AV. SILVESTRE TERRAZAS #128-11, PARQUE INDUSTRIAL
BAFAR, CARRETERA MÉXICO CUAUHTÉMOC, C.P. 31415,
CHIHUAHUA, CHIH. TEL.: 614 434 0052

MEXICO CITY **FIX FERRETERÍAS**
EL MONSTRUO DE CORREGIDORA, CORREGIDORA # 35,
COL. CENTRO, C.P. 06060, CUAUHTÉMOC, CDMX.
TEL.: 55 5522 5031 / 5522 4861

COAHUILA **SUCURSAL TORREÓN**
CALLE METAL MECÁNICA #280, PARQUE INDUSTRIAL
ORIENTE, C.P. 27278, TORREÓN, COAH.
TEL.: 871 209 68 23

COLIMA **BOMBAS Y MOTORES BYMTESA DE MANZANILLO**
BLVD. MIGUEL DE LA MADRID #190, COL. 16 DE
SEPTIEMBRE, C.P. 28239, MANZANILLO, COL.
TEL.: 314 332 1986 / 332 8013

DURANGO **TORNILLOS ÁGUILA, S.A. DE C.V.**
MAZURIO #200, COL. LUIS ECHEVERRÍA, DURANGO,
DGO. TEL.: 618 817 1946 / 618 818 2844

ESTADO DE MÉXICO **SUCURSAL CENTRO JILOTEPEC**
PARQUE INDUSTRIAL # 1, COL. PARQUE INDUSTRIAL
JILOTEPEC, JILOTEPEC, EDO. DE MÉX. C.P. 54257
TEL.: 761 782 9101 EXT. 5728 Y 5102

GUANAJUATO **CIÁ. FERRETERIA NUEVO MUNDO S.A. DE C.V.**
AV. MÉXICO - JAPÓN #225, CD. INDUSTRIAL, C.P. 38010,
CELAYA, GTO. TEL.: 461 617 7578 / 79 / 80 / 88

GUERRERO **CENTRO DE SERVICIO ECLIPSE**
CALLE PRINCIPAL MZ.1 LT. 1, COL. SANTA FE, C.P. 39010,
CHILPANCIÑO, GRO. TEL.: 747 478 5793

HIDALGO **FERREPRECIOS S.A. DE C.V.**
LIBERTAD ORIENTE #304 LOCAL 30, INTERIOR DE PASAJE
ROBLEDO, COL. CENTRO, C.P. 43600, TULANCINGO,
HGO. TEL.: 775 753 6615 / 775 753 6616

JALISCO **SUCURSAL GUADALAJARA**
AV. ADOLFO B. HORN # 6800, COL. SANTA CRUZ DEL
VALLE, C.P.: 45655, TLAJOMULCO DE ZÚNIGA, JAL.
TEL.: 33 3606 5285 AL 90

MICHOACÁN **FIX FERRETERÍAS**
AV. PASEO DE LA REPÚBLICA #3140-A, COL.
EX-HACIENDA DE LA HUERTA, C.P. 58050, MORELIA,
MICH. TEL.: 443 334 6858

MORELOS **FIX FERRETERÍAS**
CAPITÁN ANZURES #95, ESQ. JOSÉ PERDIZ, COL.
CENTRO, C.P. 62740, CUAUTLA, MOR.
TEL.: 735 352 8931

NAVARRIT **HERRAMIENTAS DE TEPEC**
MAZATLAN #117, COL. CENTRO, C.P. 63000, TEPEC, NAV.
TEL.: 311 258 0540

NUEVO LEÓN **SUCURSAL MONTERREY**
CARRETERA LAREDO #300, 1B MONTERREY PARKS,
COLONIA PUERTA DE ANÁHUAC, C.P. 66052, ESCOBEDO,
NUEVO LEÓN, TEL.: 81 8352 8791 / 81 8352 8790

OAXACA **FIX FERRETERÍAS**
AV. 20 DE NOVIEMBRE #910, COL. CENTRO, C.P. 68300,
TUXTEPEC, OAX. TEL.: 287 106 3092

PUEBLA **SUCURSAL PUEBLA**
AV. PERIFÉRICO #2-A, SAN LORENZO ALMECATLA,
C.P. 72710, CUAUHLACINGO, PUE.
TEL.: 222 282 8282 / 84 / 85 / 86

QUERÉTARO **ARU HERRAMIENTAS S.A. DE C.V.**
AV. PUERTO DE VERACRUZ #110, COL. RANCHO DE
ENMEDIO, C.P. 76842, SAN JUAN DEL RÍO, QRO.
TEL.: 427 268 4544

QUINTANA ROO **FIX FERRETERÍAS**
CARRETERA FEDERAL MZ. 46 LT. 3 LOCAL 2, COL. EJIDAL,
C.P. 77710 PLAYA DEL CARMEN, Q.R.
TEL.: 984 267 3140

SAN LUIS POTOSÍ **FIX FERRETERÍAS**
AV. UNIVERSIDAD #1850, COL. EL PASEO, C.P. 78320,
SAN LUIS POTOSÍ, S.L.P. TEL.: 444 822 4341

SINALOA **SUCURSAL CULIACÁN**
AV. JESÚS KUMATE SUR #4301, COL. HACIENDA DE LA
MORA, C.P. 80143, CULIACÁN, SIN.
TEL.: 667 173 9139 / 173 8400

SONORA **FIX FERRETERÍAS**
CALLE 5 DE FEBRERO #517, SUR LT. 25 MZ. 10, COL.
CENTRO, C.P. 85000, CD. OBREGÓN, SON.
TEL.: 644 413 2392

TABASCO **SUCURSAL VILLAHERMOSA**
CALLE HELIO LOTES 1, 2 Y 3 MZ. #1, COL. INDUSTRIAL,
2A ETAPA, C.P. 86010, VILLAHERMOSA, TAB.
TEL.: 993 353 7244

TAMAULIPAS **VM ORINGS Y REFACCIONES**
CALLE ROSITA #527 ENTRE 20 DE NOVIEMBRE Y GRAL.
RODRÍGUEZ, FRACC. REYNOSA, C.P. 88780, REYNOSA,
TAMS. TEL.: 899 926 7552

TLAXCALA **SERVICIOS Y HERRAMIENTAS INDUSTRIALES**
PABLO SIDAR #132, COL. BARRIO DE SAN BARTOLOMÉ,
C.P. 90970, SAN PABLO DEL MONTE, TLAX.
TEL.: 222 271 7502

VERACRUZ **LA CASA DISTRIBUIDORA TRUPER**
BLVD. PRIMAVERA ESQ. HORTENSIA S/N, COL.
PRIMAVERA C.P. 93308, POZA RICA, VER.
TEL.: 782 823 8100 / 826 8484

YUCATÁN **SUCURSAL MÉRIDA**
CALLE 33 #600 Y 602, LOCALIDAD ITZINCAB Y MULSAY,
MPIO. UMMÁN, C.P. 97390, MÉRIDA, YUC.
TEL.: 999 912 2451

Model	Code	Brand
RECE-160P	28147	PRETUL®

Warranty. Duration: 1 year. Coverage: parts, components and workmanship against manufacturing or operating defects, except if used under conditions other than normal; when it was not operated in accordance with the instructive; was altered or repaired by personnel not authorized by TRUPER®. To make the warranty valid, present the product, stamped policy or invoice or receipt or voucher, in the establishment where you bought it or in Corregidora 35, Centro, Cuauhtémoc, CDMX, 06060, where you can also purchase parts, components, consumables and accessories. It includes the costs of transportation of the product that derive from its fulfillment of its service network. Phone number 800-018-7873. Made in China. Imported by TRUPER, S.A. de C.V. Parque Industrial 1, Parque Industrial Jilotepec, Jilotepec, Edo. de Méx. C.P. 54257, Phone number 761 782 9100.

Stamp of the business. Delivery date:

