

Manual

Cordless angle grinder

20 V \equiv **4 1/2"**
Disc

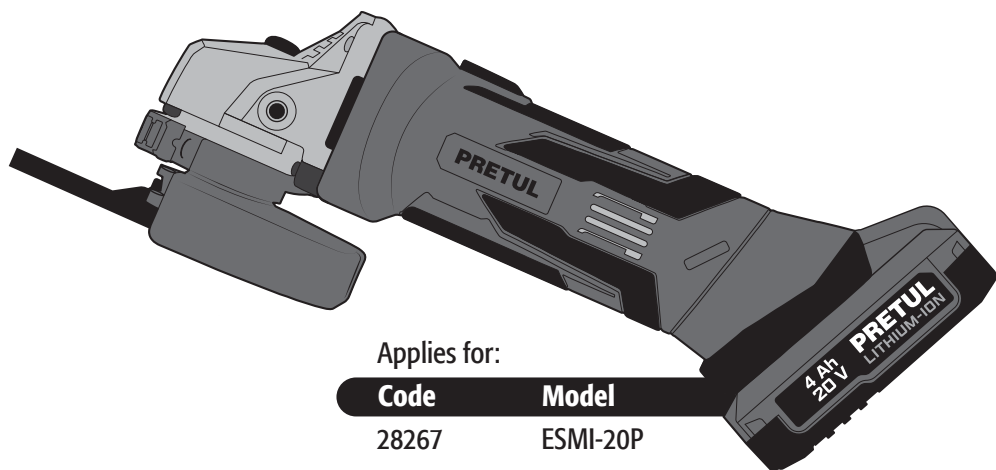

Applies for:

Code

28267

Model

ESMI-20P

ESMI-20P



Read this manual thoroughly
Before using the tool.



Technical data	3
Power requirements	3
 General safety warnings for power tools	4
 Safety warnings for the use of angle grinders	5
Parts	8
Preparation	9
Assembly	10
Start up	11
Maintenance	12
Troubleshooting	12
Authorized service centers	13
Warranty policy	14

CAUTION

To get the most out of the tool, extend its lifespan, claim the warranty if necessary, and avoid serious risks or injuries, it is essential to read this manual in its entirety before using the tool.

Keep this manual for future reference.

The illustrations in this manual are for reference only and may differ from the real appearance of the tool.

Use and care recommendations

 Use **ONLY** the provided charger or the one suggested by TRUPER to charge the battery

 Follow the battery GUIDELINES and charging **INSTRUCTIONS** (page 9)

 **Do NOT** press the lock button while the disc is in motion.



 **Keep** the tool's ventilation slots on the tool a charger **CLEAN**.



 Perform regular **MAINTENANCE** on your machine (page 12)

ESMI-20P

Code •	28267		
Description •	Cordless angle grinder		
Discs •	4 1/2"		
Voltage •	20 V ===		
Speed •	7 100 RPM		
IP Grade •	IP40		
Size of threaded thread •	5/8 - 11 - UNC - 1A		
Battery •	Ion-lithium 20 V === 4 Ah		Charging time: 120 min approx
Charger •	Input:	Voltage: 127 V ~ Frequency: 60 Hz Current: 0.9 A	Output: Voltage: 21 V === Current: 2.5 A

The power cable has Y-type cable holders.

The tool's construction class is Class III.

The construction class of the charger is: Reinforced insulation.

⚠ WARNING If the power cable is damaged, it must be replaced by the manufacturer or a TRUPER Service Center to prevent any risk of electric shock or significant accident.

The electrical insulation of this tool is compromised by splashes or spillage of liquids during its operation. Do not expose it to rain, liquids, and/or moisture.

⚠ WARNING Before accessing the terminals, all power circuits must be disconnected.



Power Requirements

⚠ WARNING Tools with double insulation and reinforced insulation eliminate the need of a grounded power cord with three prongs or a grounded power connection.

⚠ WARNING When using an extension cable, verify the gauge is enough for the power that your product needs. A lower gauge cable will cause voltage drop in the line, resulting in power loss and overheating. The following table shows the right size to use depending on cable's length and the ampere capability shown in the tool's nameplate. When in doubt use the next higher gauge.

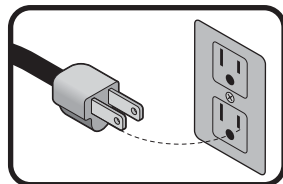

Capacity in Amperes	Number of Conductors	Extension gauge	
		from 5.9 ft to 49 ft	higher than 49 ft
from 0 A and up to 10 A	3 (one grounded)	18 AWG(*)	16 AWG
from 10 A and up to 13 A		16 AWG	14 AWG
from 13 A and up to 15 A		14 AWG	12 AWG
from 15 A and up to 20 A		8 AWG	6 AWG

* It is allowed to use it if the extensions themselves have an overcurrent protection device.

AWG = American Wire Gauge. Reference: NMX-J-195-ANCE.

⚠ WARNING When operating electric tools outdoors, use a grounded extension cord marked as **VOLTECK** 'Outdoor Use'. These extensions are specially designed for outdoor use and reduce the risk of electric shock.





⚠ WARNING! Read all safety warnings and all instructions listed below carefully. Failure to follow any of them may result in electric shock, fire, and/or serious injury. **Keep the warnings and instructions for future reference.**

Work area

Keep your work area clean, organized, and well-lit.

Cluttered and dim areas can lead to accidents.



Do not operate the tool in explosive atmospheres, such as in the presence of flammable liquids, gas, or dust.

The electric tools produce sparks that can ignite flammable material.



Keep children and other individuals at a safe distance while using the equipment.

Distractions can cause loss of control and lead to accidents.



Electrical Safety

Electrical tool plugs must match the outlet. Never modify the plug in any way.

Do not use adapters with grounded electrical tools. Unmodified electrical tools and matching plugs will reduce the risk of electric shock.



Avoid bodily contact with grounded surfaces, such as pipes, radiators, stoves, and refrigerators.

There is an increased risk of electric shock if your body is grounded.

Water entering an electrical tool will increase the risk of electric shock.

The entry of water into an electrical tool will increase the risk of electric shock.

Do not force the cable. Never use the cable for carrying, lifting, or disconnecting the tool. Keep the cable away from heat, oil, sharp edges, or moving parts.

Damaged or tangled cables increase the risk of electric shock.

If it is unavoidable to operate an electrical tool in a damp location, use a power source protected by a Residual Current Device (RCD).

The use of a Residual Current Device (RCD) reduces the risk of electric shock.

When operating an electrical tool outdoors, use an extension cord suitable for outdoor use.

The use of a suitable outdoor-rated cable reduces the risk of electric shock.

Personal Safety

Be alert, watch what you are doing, and use common sense when handling a tool. Do not use it if you are tired or under the influence of drugs, alcohol, or medication.

A moment of distraction while using the tool can cause personal injury.

Use safety equipment. Always wear eye protection.

The use of safety equipment such as safety glasses, dust mask, slip-resistant shoes, helmet, and ear protection in appropriate conditions significantly reduces the risk of personal injury.



Avoid accidental starts. Ensure the switch is in the "off" position before connecting to the power source and/or the battery or transporting the tool.

Carrying power tools with your finger on the switch or connecting power tools with the switch in the "on" position can cause accidents.

Remove any wrenches or adjusting tools before starting the power tool.

Wrenches or tools left on the rotating parts of the tool can cause personal injury.

Do not exceed your range of motion. Keep both feet firmly planted on the ground and always maintain balance.

This allows better control of the tool in unexpected situations.

Dress appropriately. Do not wear loose clothing or jewelry. Keep your hair, clothing, and gloves away from moving parts.



Loose clothes, jewelry, or long hair can get caught in moving parts.

If dust extraction and collection devices are available for the tool, check their connections and use them correctly.

The use of these devices reduces risks associated with dust.

Tool Use and Care

Do not force the tool. Use the appropriate tool for the task at hand.



The right tool performs better and is safer when used at the intended pace.

Do not use the tool if the switch is not functioning.

Any power tool that cannot be turned on or off is dangerous and must be repaired before operation.

Disconnect the tool from the power source and/or battery before making any adjustments, changing accessories, or storing it.

These measures reduce the risk of accidentally starting the tool.

Store the tools out of the reach of children and do not allow them to be handled by individuals unfamiliar with the tools or their instructions.

Power tools are dangerous in untrained hands.



Maintain the tool. Ensure that the moving parts are not misaligned or jammed, and that there are no broken parts or other conditions that may affect its operation. Repair any damage before using the tool.



Many accidents are caused by inadequate tool maintenance.

Keep cutting accessories sharp and clean.

Well-maintained cutting accessories are less likely to jam and easier to control.

Use the tool, its components, and accessories in accordance with these instructions and as intended for the type of tool, in appropriate working conditions.

Using the tool for applications other than those for which it is designed could cause a hazardous situation.

Use and Care of the Battery-Powered Tool

Only recharge with the charger specified by TRUPER.

The charger included with the machine may pose a fire hazard if used with another battery.

Use batteries specifically designed for the tool.

The use of any other battery may pose a risk of damage and fire.



When batteries are not in use, keep them away from other metallic objects such as paper clips, coins, keys, nails, screws, or other small metallic objects that may create a connection from one terminal to another.

Short-circuiting between battery terminals can cause burns or fires.

In abusive conditions, battery liquid may be expelled; avoid contact. If accidental contact occurs, rinse with water.

If the liquid meets the eyes, seek medical assistance. The liquid expelled by the battery can cause irritation or burns.

Service

Repair the tool at a TRUPER Authorized Service Center using only identical replacement parts to maintain the safety of the tool.

This will ensure that the safety of the power tool is maintained.



This tool is in compliance with the Official Mexican Standard (NOM - Norma Oficial Mexicana).

Safety warnings



When using a cordless angle grinder



This power tool is intended to operate as a cutting tool. Read all safety warnings, instructions, and specifications provided. Failure to follow the instructions below may result in electric shock, fires, and/or serious injuries:

Choose the appropriate disc

CAUTION • Never use a disc larger in diameter than what the tool is designed to hold.

WARNING • Use only discs or accessories rated for speeds equal to or greater than 7,100 rpm.

• The assigned speed of the accessory must be at least equal to the maximum speed marked on the tool.

• Accessories that run faster than intended risk breaking and coming loose.

CAUTION • Use only discs or accessories with the corresponding hole for the tool's shaft.

CAUTION • Use only discs or accessories specific to the material being worked on.

Batteries and charger

DANGER • For battery charging, use only the PRETUL charger that comes with the tool. Using another charger may cause a fire and risk of injury.

DANGER • Use only batteries designed specifically for the tool. Other batteries may pose risks of injury or fire. Connect the charger only to an alternating current (AC) power supply.

DANGER • Do not use the charger outdoors.

• Respect the "+/-" polarity when charging.

• Never recharge a leaking battery.

• Do not use batteries or the charger for purposes other than those they were designed for.

• Do not modify the battery or charger contacts.

• Do not expose the battery pack or the tool to fire or excessive temperatures. Exposure to fire or temperatures exceeding 226 °F (130 °C) can cause an explosion.

CAUTION • Keep batteries away from any metallic objects such as clips, coins, keys, nails, screws, or any other object that could cause the terminals to make contact; this could lead to a short circuit that may cause burns or fires.

CAUTION • Under extreme conditions, battery liquid may spill. If this happens, avoid any contact. In case of accidental contact, wash with plenty of water, rinse with lemon juice and vinegar. If the liquid meets the eyes, rinse with plenty of water for several minutes and seek immediate medical help. The expelled liquid from the batteries could cause irritation or burns.

CAUTION • To extend the battery life, fully discharge it at least once a month. Avoid leaving the battery uncharged for more than three months. Always charge the battery to its maximum capacity. Before using the machine for the first time, ensure the battery is charged to its maximum capacity.

• Try to minimize frequent stops during cutting to prevent potential damage to the battery.

Before operating the grinder

• Keep individuals at a safe distance from the work area. Anyone entering the work zone must use personal protective equipment.

• Take your time to assess the task at hand and ensure that all precautions are respected before starting the grinding.

DANGER • Remove any adjustment keys from the tool. Otherwise, they can be forcefully ejected, causing serious harm to the operator.

WARNING • Check that the disc guard is in good condition and securely fastened. The tool should not be used without the guard. Fragments from workpieces or a broken accessory can detach and cause damage beyond the immediate operating area.

CAUTION • Verify that the disc is not broken or cracked. Tap it lightly with a wooden hammer; the sound it produces will indicate if it's cracked.

DANGER • Ensure that the switch is turned off (See page 11, Power On) before connecting the tool; otherwise, it will start unexpectedly, potentially causing serious injuries.

CAUTION • Turn on the tool 30 seconds before using it to detect significant vibrations or any unusual movement.

• If the power tool or an accessory fall, inspect for possible damage or install an undamaged accessory. After inspecting and installing an accessory, stay away and keep individuals present away from the plane of the rotating accessory, operate the power tool at maximum speed without a load for one minute.

• Accessories with damage generally break during this time. If detected, disconnect the tool, and contact a TRUPER Authorized Service Center.



- CAUTION** • Ensure that the disc rotates freely.
- Do not tighten the disc too much; otherwise, it may break.
- WARNING** • When working with small pieces, secure them with clamps or vices. Never use your hands for this purpose.

While operating the grinder:

- Do not use the power tool near flammable materials.
- CAUTION** • Do not turn on the tool when the disc is in contact with the workpiece.
- DANGER** • Do not install a wood-cutting saw blade or toothed blade. Such blades frequently cause kickbacks and loss of control.
- WARNING** • Use personal protective equipment. Depending on the application, use a face shield, safety glasses. As needed, use a dust mask, ear protectors, gloves, and a workshop apron capable of stopping small abrasive fragments or pieces of work.
- Eye protection should stop debris generated by various operations. Dust masks or respirators should filter particles produced during the operation. Prolonged exposure to high-intensity noise can cause hearing loss.
- WARNING** • Never hold the tool by the power cord; hold it by the body or the auxiliary handle.
- CAUTION** • Hold the tool by insulated parts when performing operations where there is a risk of contact with hidden wiring. Contact with a "live" wire will electrify exposed metal parts and give an electric shock to the operator.
- Never release the power tool until the accessory comes to a complete stop.
- Never strike the work surface with the disc.
- CAUTION** • To achieve a good result during the grinding process, the angle between the disc and the work surface should be between 15° and 30°.
- DANGER** • When the disc is spinning, do not use the spindle lock to stop it, as it is very dangerous and can cause injury to the user.
- CAUTION** • Do not touch the disc or the workpiece immediately after grinding. Wait for them to cool before handling. Do not attempt to cool them with water or oil.



For instance, if a grinding wheel becomes snagged or caught by the workpiece, the edge of the wheel entering the snag point may penetrate the material's surface, causing the wheel to lift or jump. The wheel may move toward or away from the operator, depending on the direction of the wheel's movement at the snag point. Grinding wheels can also break under these conditions. Kickback is the result of improper use of the power tool and/or incorrect operating procedures or conditions, and it can be avoided by taking the appropriate precautions, as outlined below:

- Maintain a firm grip on the power tool and position your body and arm to resist kickback forces. Always use the auxiliary handle, if provided, to have maximum control over kickback or torque reaction during startup. The operator can control torque reactions or kickback forces by taking proper precautions.
- Never place your hand near the rotating accessory. The accessory can kick back onto your hand.
- Do not position your body in the area where the power tool will move if kickback occurs. Kickback will propel the tool in the opposite direction of the wheel's movement at the snag point.
- Exercise special care when working in corners, sharp edges, etc. Avoid bouncing and snagging the accessory. Corners, sharp edges, or bouncing tend to snag the rotating accessory and cause loss of control or kickback.
- Do not use a chainsaw chain, a wood carving blade, or a serrated saw blade. Such blades frequently cause kickbacks and loss of control.

Specific safety precautions for grinding operations

- Use only types of discs recommended for your power tool and the specific protection designed for the selected wheel. Discs for which the power tool was not designed cannot be adequately protected and are unsafe.
- The grinding surface of depressed-center discs should be mounted below the lip of the guard. An incorrectly positioned disc protruding through the lip of the guard cannot be adequately protected.
- The guard must be securely attached to the power tool and positioned for maximum safety to minimize the amount of disc fragments, accidental contact, and sparks that could ignite clothing.
- Discs should only be used for recommended applications. For example, do not grind with the side of a cut-off wheel. Abrasive discs are intended for peripheral grinding, and lateral forces applied to these discs may cause them to fracture.
- Always use undamaged disc flanges that are the correct size and shape. Proper flanges support the disc, reducing the possibility of breakage. Flanges for cut-off discs may be different from those for grinding discs.
- Do not use worn-out discs from larger power tools. A disc designed for a larger power tool is not suitable for the higher speed of a smaller tool and may shatter.

After operating the grinder

- WARNING** • Ensure that the tool is disconnected before inspecting, adjusting, or changing the disc.
- Do not operate the tool while carrying it at your side.
- DANGER** • Sparks produced during grinding can be hazardous if proper precautions are not taken. Ensure they do not meet the skin or flammable substances.
- Gradually clean the tool's ventilation grilles. The motor's fan directs dust into the housing, and excessive buildup of metallic dust can pose an electrical hazard.
- Do not use accessories that require liquid coolants. The use of water or other liquid coolants may result in an electric shock.

Kickback

DANGER Kickback is a sudden reaction to a rotating wheel, backing plate, brush, or any other accessory that becomes trapped or snagged. This results in a rapid stop of the rotating accessory, causing the power tool to be forcefully thrust in the direction opposite to the rotation of the accessory at the jammed point.



Safety warnings

When using a cordless angle grinder



PRETUL

Specific safety measures for abrasive cutting operations

- a) Do not jam the cutting wheel or apply excessive pressure. Do not attempt excessive depth of cut. Overloading the wheel increases the load and susceptibility to twisting or jamming in the cut, also raising the risk of kickback or disc breakage.
- b) Do not position your body in line and behind the disc. When the disc, at the point of operation, moves away from your body, potential kickback can propel the disc and the power tool directly toward you.
- c) When the disc is jammed or when interrupting a cut for any reason, turn off the power tool and keep it stationary until the disc comes to a complete stop. Never attempt to remove the cut-off wheel while it is in motion, as kickback can occur. Investigate and take corrective measures to eliminate the cause of the wheel jam.
- d) Do not restart the cutting operation on the workpiece. Allow the disc to reach its full speed and carefully re-enter the cut. The disc may jam, lift, or kick back if the power tool is restarted on the workpiece.
- e) Support panels or any large workpiece to minimize the risk of wheel jamming and kickback. Large workpieces tend to sag under their own weight. Supports should be placed beneath the workpiece near the cut line and close to the edge of the workpiece on both sides of the disc.
- f) Exercise extra caution when performing a "plunge cut" in existing walls or other blind areas. The protruding wheel can cut gas or water pipes, electrical cables, or objects that may cause kickback.

Incorrect way to operate the angle grinder

- Performing operations for which this power tool is not designed can lead to an accident and cause personal injuries.
- It is not recommended to use this power tool for operations such as sanding, planing, or polishing.
- Do not use accessories that are not specifically designed and recommended by the manufacturer.

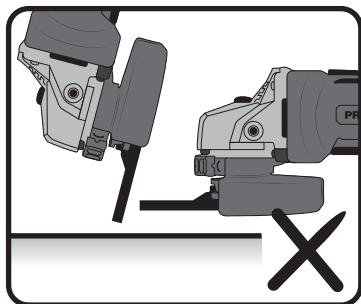

Incorrect way to operate the angle grinder

Correct way to operate the angle grinder

- The outer diameter and thickness of accessories must be within the assigned capacity.
- Incorrectly sized accessories cannot be adequately protected or controlled. For best results, use a 4 1/2" cutting and/or grinding disc with a thickness of 1 mm - 6.4 mm.
- Operate the angle grinder at an angle of 15° to 30° for the best results.

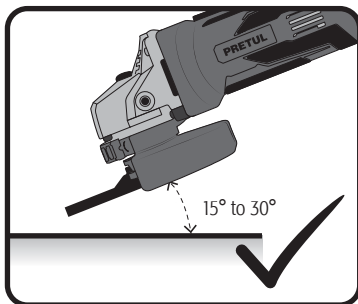

Correct way to operate the angle grinder

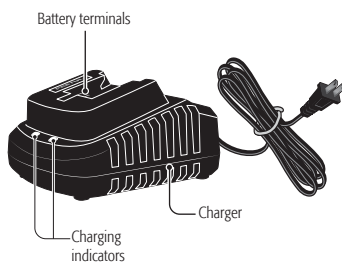
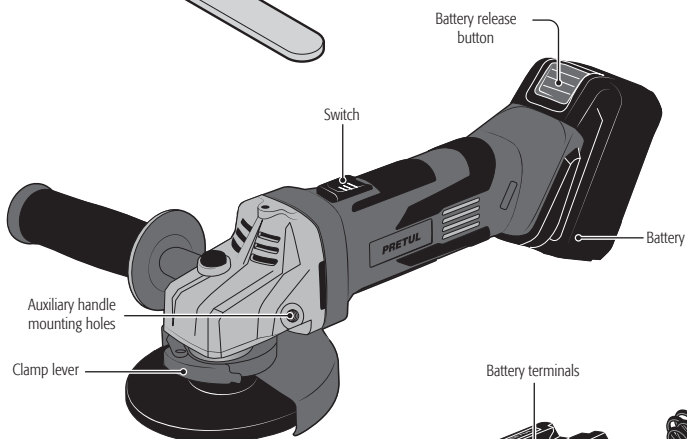
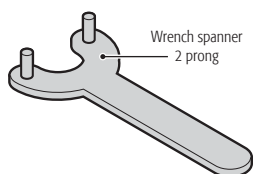
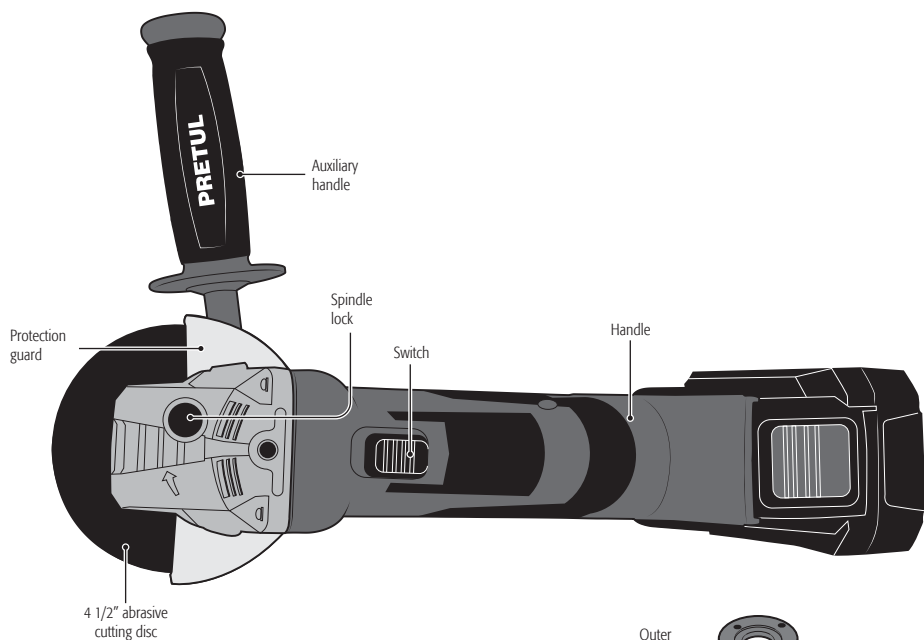

Preparation

PRETUL

Battery charge

1. Connect the charger plug to a 127 V~ electrical outlet. (The green light on the charge indicator will turn on.)
2. Insert the battery into the charger by sliding it as shown. The green light will turn off, and the red light should turn on, indicating that the charging has started.
3. When the battery is fully charged, the green light will turn on, and the red light will turn off.
4. Disconnect the charger from the power source once the charging is complete.

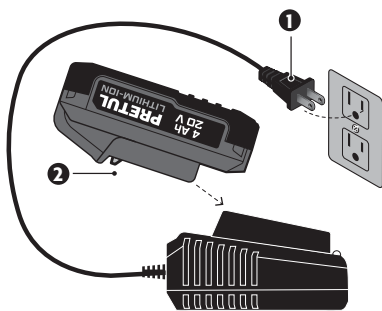

Battery failures

- If the red light is flashing, it indicates that the battery is experiencing a delay due to overheating. Wait until the battery temperature is within the appropriate range before attempting to charge.
- If the red light remains on beyond the recommended charging time or If the battery indicator lights do not turn on after inserting the battery into the charger, it indicates that the battery is defective. Replace the battery or contact an Authorized Service Center.

Important considerations about charging

- You can achieve longer battery life and better performance by charging the battery unit at an ambient temperature between 41 °F (5°C) and 113 °F (45°C). Allow a heated battery cartridge to cool before charging.
- The charger and battery unit may experience slight heating during the charging process. This is normal and poses no problem. To facilitate battery unit cooling after use, avoid placing the charger or battery unit in a warm location, such as a metal shed or an uninsulated trailer.
- The battery unit should be recharged when it is unable to produce sufficient power for tasks that were easily performed before. DO NOT CONTINUE to use it under these circumstances. Follow the charging procedure.
- The best storage location is a cool and dry place, away from direct sunlight and excessive heat or cold.
- For optimal results during extended storage periods, it is recommended to store the fully charged battery unit in a cool and dry place outside of the charger.

Batteries

- Open the clamp lever and align the protruding parts inside the protective guard. Push the protective guard downward until the protruding parts engage and rotate freely with the corresponding slots on the shaft cover.
- With the clamp lever open, rotate the protective guard to the desired working position.
- Press the lock (A) and slide the battery outward to remove it.

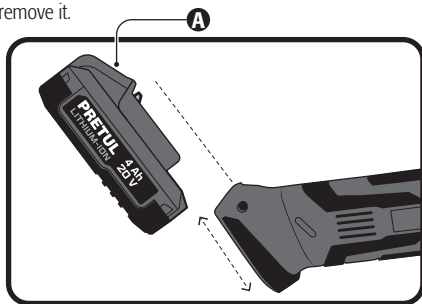

Tool/battery protection system

⚠ CAUTION • The tool is equipped with a system that automatically stops the tool to prolong both its lifespan and that of the batteries. This occurs in the following cases:

Overload: When the tool is forced, the battery consumes abnormally high current levels. Suspend the strenuous work and turn on the tool again.

Overheating: Let the tool and battery cool down before turning it on again.

Over-discharge: The battery level is not sufficient. In this case, remove the battery from the tool and charge it.

Protective guard assembly

- Open the clamp lever and align the protruding parts inside the protective guard. Push the protective guard downward until the protruding parts engage and rotate freely with the corresponding slots on the shaft cover.
- With the clamp lever open, rotate the protective guard to the desired working position.
- Secure it by pushing the clamp lever.

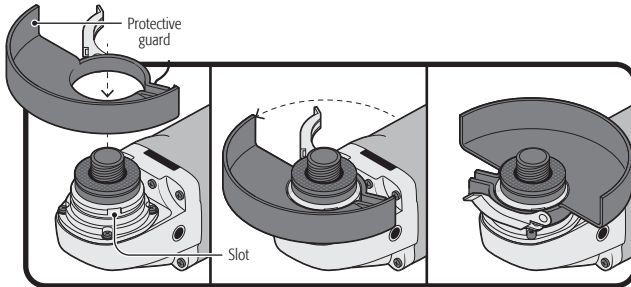

Disc assembly

1. Attach the inner flange to the shaft.
2. Place the disc on the inner flange.
3. Put the outer flange on the shaft.
4. Press the shaft lock on the grinder head.
5. Screw the outer flange with the two-pronged wrench until it is securely fixed.

⚠ DANGER • The shaft lock should only be used to change discs, never to stop the disc while it is rotating.

- Always use flanges in perfect condition, of the correct size according to the shape of the selected disc.
- A flange with the correct characteristics supports the disc, reducing the possibility of disc breakage. Flanges for cutting discs may be different from flanges for grinding discs.
- The grinding surface of depressed center discs should be installed below the plane of the guard.
- A poorly installed disc can project burrs beyond the plane of the guard and cannot be adequately protected.

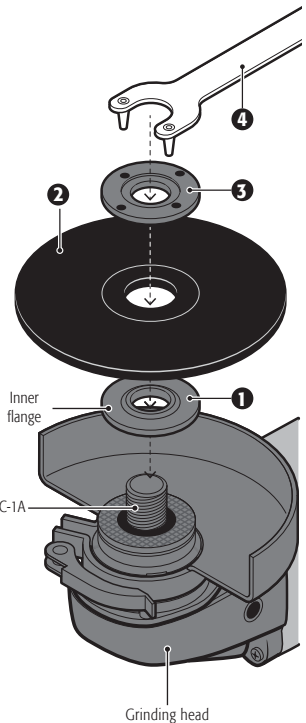

Auxiliary handle assembly

- For safe operation, use the auxiliary handle. Place it in one of the three holes for mounting it, making it easier for you to work.

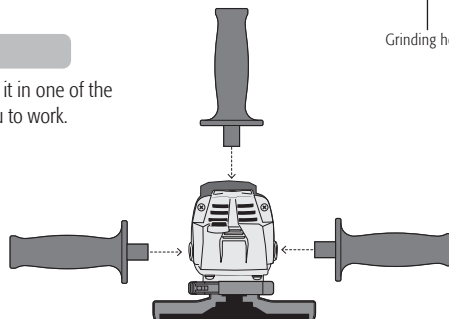

The angle grinder is a handheld power tool used for grinding and cutting steel, pipes, angle iron, bricks, tiles, stone, and/or ceramic pieces; for removing burrs from metal surfaces, and for leveling and smoothing welds.

Start up

- Press the switch precisely into the pressure position (1). Then, push slightly downward and direct the pressure forward (2) without releasing it. To keep it locked, release the switch.
- To interrupt its operation, press in the pressure position (1) and then release the switch.

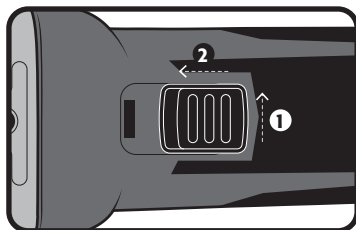

Holding the tool properly

Always hold the tool with both hands. One hand holding the handle and the other the auxiliary handle. Be careful not to block the ventilation slots.

• Grinding:

For optimal results, hold the tool at an angle of 15° to 30° in relation to the workpiece. Move it back and forth with a gentle, consistent pressure. This technique prevents the workpiece from overheating, discoloration, and the formation of any edges.

• Cutting:

Do not press, tilt, or swing the tool. Work at a moderate speed.

The disc should always rotate in the opposite direction of the cutting movement, never in the other direction, as there is a risk of the tool being thrown uncontrollably. When cutting hard stones, it is advisable to use a diamond cutting disc.

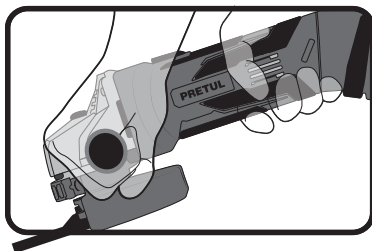
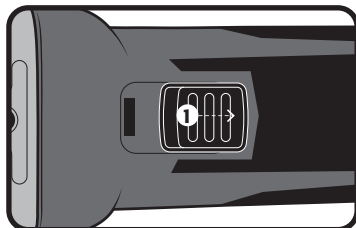

Useful tips

- Work with the disc in the correct position to avoid damage.
- Press on the workpiece with a force less than the weight of the tool to prevent overloading and damaging the motor and disc.
- After installing a new disc, allow the disc to rotate without working for at least one minute. In case it vibrates, replace it immediately.

⚠ CAUTION • Avoid working with wood or soft metals like lead, as these materials quickly saturate the disc and render it useless.

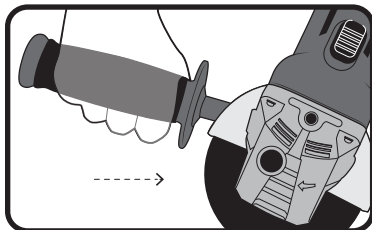

General maintenance

- Remember to remove the tool's battery before cleaning or performing maintenance.
- All of the tool's parts are essential to the insulation system and should only be maintained at a TRUPER service facility with authorization.
- ALWAYS ask for original TRUPER replacement components when sending the tool in for repair.
- Avoid using chemicals while cleaning plastic parts. Many commercial solvents can cause harm to most plastic materials.
- Use compressed air or a clean cloth to remove dust, carbon, and debris.

⚠ WARNING NEVER allow the tool to meet brake fluid, petroleum-based products, penetrating oils, etc. These substances contain chemicals that can damage or destroy plastic.

⚠ WARNING When using compressed air to clean particles, ALWAYS wear safety glasses with side shields or a face shield. In case of expelling a lot of dust, also use a dust mask.



It is not recommended to use this tool for extensive work on fiberglass, drywall, plaster, or gypsum materials, as their particles are highly abrasive to the components of any power tool. If using the tool on any of these materials, it is essential to clean it frequently with compressed air to increase the tool's lifespan.

Repairing

Use only manufacturer-recommended spare parts and accessories. If the tool does not function, repairs should be performed by an Authorized Service Center.

Storage

Store the tool neatly in a dry place, protected from dust and water.

Troubleshooting

Problem	Cause	Corrective action
The grinder loses effectiveness.	• Low battery.	• Charge the battery.
The trigger can be pressed, but the grinder does not work.	• Battery discharged.	• Charge the battery.
The battery is leaking.	• Small dripping may occur in extreme temperatures or after heavy use; this is normal. • Significant or very noticeable dripping is due to a damaged battery.	• Clean the liquid from the skin or clothing promptly with water and soap. • Replace the battery immediately.
The battery does not charge, and the charge level indicator light does not turn on.	• Charger connection improperly installed on the battery. • Charger improperly connected to the power outlet.	• Ensure the charger connection is correctly inserted into the battery. • Verify that the charger plug is properly connected to the power outlet.
The grinder heats up after extended periods of work.	• This heating is normal as it absorbs the energy generated by the motor's gears and electricity during work.	• Allow the angle grinder to cool for 5 minutes.
The battery heats up during operation.	This heating is normal; the energy extracted from the battery while the grinder is in operation causes it to heat up.	• Stop the grinder for 5 minutes to allow the battery to cool.
This heating is normal, because of the voltage regulation during charging.	• This heating is normal, a result of the chemical reactions occurring inside the battery during charging.	
This heating is normal, a result of the voltage regulation.	• This heating is normal and occurs due to voltage regulation	

In the event of any problem contacting a TRUPER Authorized Service Center, please see our webpage WWW.TRUPER.COM to get an updated list, or call our toll-free numbers 800 690-6990 or 800 018-7873 to get information about the nearest Service Center.

AGUASCALIENTES **DE TODO PARA LA CONSTRUCCIÓN**
GRAL. BARRAGÁN #1201, COL. GREMIAL, C.P. 20030,
AGUASCALIENTES, AGS. TEL.: 449 994 0537

BAJA CALIFORNIA **SUCURSAL TIJUANA**
AV. LA ENCANTADA, LOTE #5, PARQUE INDUSTRIAL EL
FLORIDO II, C.P. 22244, TIJUANA, B.C.
TEL.: 664 969 5100

BAJA CALIFORNIA SUR **FIX FERRETERÍAS**
FELIPE ÁNGELES ESQ. RUIZ CORTÍNEZ S/N, COL. PUEBLO
NUEVO, C.P. 23670, CD. CONSTITUCIÓN, B.C.S.
TEL.: 613 132 1115

CAMPECHE **TORNILLERÍA Y FERRETERÍA AAA**
AV. ÁLVARO OBREGÓN #324, COL. ESPERANZA
C.P. 24080 CAMPECHE, CAMP. TEL.: 981 815 2808

CHIAPAS **FIX FERRETERÍAS**
AV. CENTRAL SUR #27, COL. CENTRO, C.P. 30700,
TAPACHULA, CHIS. TEL.: 962 118 4083

CHIHUAHUA **SUCURSAL CHIHUAHUA**
AV. SILVESTRE TERRAZAS #128-11, PARQUE INDUSTRIAL
BAFAR, CARRETERA MÉXICO CUAUHTÉMOC, C.P. 31415,
CHIHUAHUA, CHIH. TEL.: 614 434 0052

MEXICO CITY **FIX FERRETERÍAS**
EL MONSTRUO DE CORREGIDORA, CORREGIDORA # 35,
COL. CENTRO, C.P. 06060, CUAUHTÉMOC, CDMX.
TEL.: 55 5522 5031 / 5522 4861

COAHUILA **SUCURSAL TORREÓN**
CALLE METAL MECÁNICA #280, PARQUE INDUSTRIAL
ORIENTE, C.P. 27278, TORREÓN, COAH.
TEL.: 871 209 68 23

COLIMA **BOMBAS Y MOTORES BYMTESA DE MANZANILLO**
BLVD. MIGUEL DE LA MADRID #190, COL. 16 DE
SEPTIEMBRE, C.P. 28239, MANZANILLO, COL.
TEL.: 314 332 1986 / 332 8013

DURANGO **TORNILLOS ÁGUILA, S.A. DE C.V.**
MAZURIO #200, COL. LUIS ECHEVERRÍA, DURANGO,
DGO. TEL.: 618 817 1946 / 618 818 2844

ESTADO DE MÉXICO **SUCURSAL CENTRO JILOTEPEC**
PARQUE INDUSTRIAL # 1, COL. PARQUE INDUSTRIAL
JILOTEPEC, JILOTEPEC, EDO. DE MÉX. C.P. 54257
TEL.: 761 782 9101 EXT. 5728 Y 5102

GUANAJUATO **CÍA. FERRETERA NUEVO MUNDO S.A. DE C.V.**
AV. MÉXICO - JAPÓN #225, CD. INDUSTRIAL, C.P. 38010,
CELAYA, GTO. TEL.: 461 617 7578 / 79 / 80 / 88

GUERRERO **CENTRO DE SERVICIO ECLIPSE**
CALLE PRINCIPAL MZ.1 LT. 1, COL. SANTA FE, C.P. 39010,
CHILPANCIINGO, GRO. TEL.: 747 478 5793

HIDALGO **FERREPRECIOS S.A. DE C.V.**
LIBERTAD ORIENTE #304 LOCAL 30, INTERIOR DE PASAJE
ROBLEDO, COL. CENTRO, C.P. 43600, TULANCINGO,
HGO. TEL.: 775 753 6615 / 775 753 6616

JALISCO **SUCURSAL GUADALAJARA**
AV. ADOLFO B. HORN # 6800, COL. SANTA CRUZ DEL
VALLE, C.P.: 45655, TLAJOMULCO DE ZÚÑIGA, JAL.
TEL.: 33 3606 5285 AL 90

MICHOACÁN **FIX FERRETERÍAS**
AV. PASEO DE LA REPÚBLICA #3140-A, COL.
EX-HACIENDA DE LA HUERTA, C.P. 58050, MORELIA,
MICH. TEL.: 443 334 6858

MORELOS **FIX FERRETERÍAS**
CAPITÁN ANZURES #95, ESQ. JOSÉ PERDIZ, COL.
CENTRO, C.P. 62740, CUAUTLA, MOR.
TEL.: 735 352 8931

NAYARIT **HERRAMIENTAS DE TEPIC**
MAZATLAN #117, COL. CENTRO, C.P. 63000, TEPIC, NAY.
TEL.: 311 258 0540

NEUVO LEÓN **SUCURSAL MONTERREY**
CARRETERA LAREDO #300, 1B MONTERREY PARKS,
COLONIA PUERTA DE ANAHUAC, C.P. 66052, ESCOBEDO,
NUEVO LEÓN, TEL.: 81 8352 8791 / 81 8352 8790

OAXACA **FIX FERRETERÍAS**
AV. 20 DE NOVIEMBRE #910, COL. CENTRO, C.P. 68300,
TUXTEPEC, OAX. TEL.: 287 106 3092

PUEBLA **SUCURSAL PUEBLA**
AV. PERIFÉRICO #2-A, SAN LORENZO ALMECATLA,
C.P. 72710, CUAUTLACINGO, PUE.
TEL.: 222 282 8282 / 84 / 85 / 86

QUERÉTARO **ARU HERRAMIENTAS S.A. DE C.V.**
AV. PUERTO DE VERACRUZ #110, COL. RANCHO DE
ENMEDIO, C.P. 76842, SAN JUAN DEL RÍO, QRO.
TEL.: 427 268 4544

QUINTANA ROO **FIX FERRETERÍAS**
CARRETERA FEDERAL MZ. 46 LT. 3 LOCAL 2, COL. EJIDAL,
C.P. 77710 PLAYA DEL CARMEN, Q.R.
TEL.: 984 267 3140

SAN LUIS POTOSÍ **FIX FERRETERÍAS**
AV. UNIVERSIDAD #1850, COL. EL PASEO, C.P. 78320,
SAN LUIS POTOSÍ, S.L.P. TEL.: 444 822 4341

SINALOA **SUCURSAL CULIACÁN**
AV. JESÚS KUIMATE SUR #4301, COL. HACIENDA DE LA
MORA, C.P. 80143, CULIACÁN, SIN.
TEL.: 667 173 9139 / 173 8400

SONORA **FIX FERRETERÍAS**
CALLE 5 DE FEBRERO #517, SUR LT. 25 MZ. 10, COL.
CENTRO, C.P. 85000, CD. OBREGÓN, SON.
TEL.: 644 413 2392

TABASCO **SUCURSAL VILLAHERMOSA**
CALLE HELIO LOTES 1, 2 Y 3 MZ. #1, COL. INDUSTRIAL,
2A ETAPA, C.P. 86010, VILLAHERMOSA, TAB.
TEL.: 993 353 7244

TAMAULIPAS **VM ORINGS Y REFACCIONES**
CALLE ROSITA #527 ENTRE 20 DE NOVIEMBRE Y GRAL.
RODRÍGUEZ, FRACC. REYNOSA, C.P. 88780, REYNOSA,
TAMS. TEL.: 899 926 7552

TLAXCALA **SERVICIOS Y HERRAMIENTAS INDUSTRIALES**
PABLO SIDAR #132, COL. BARRIO DE SAN BARTOLOMÉ,
C.P. 90970, SAN PABLO DEL MONTE, TLAX.
TEL.: 222 271 7502

VERACRUZ **LA CASA DISTRIBUIDORA TRUPER**
BLVD. PRIMAVERA ESQ. HORTENSIA S/N, COL.
PRIMAVERA C.P. 93508, POZA RICA, VER.
TEL.: 782 823 8100 / 826 8484

YUCATÁN **SUCURSAL MÉRIDA**
CALLE 33 #600 Y 602, LOCALIDAD ITZINCAB Y MULSA, Y.
MPIO. UMAN, C.P. 97390, MÉRIDA, YUC.
TEL.: 999 912 2451

Code	Model	Brand
28267	ESMI-20P	PRETUL

Duration: 1 year. Coverage: Parts, components, and labor are covered against manufacturing or operational defects, except when used under conditions other than normal, operated contrary to instructions, altered, or repaired by personnel not authorized by TRUPER®. To activate the warranty, please present the product along with the sealed warranty, invoice, or receipt at the store where it was purchased. Alternatively, you can visit our location at Corregidora 35, Centro, Cuauhtémoc, CDMX, 06060. At this location, you can also acquire parts, components, consumables, and accessories. The warranty includes transportation expenses resulting from service compliance within our service network. For inquiries or assistance, please contact us at Tel. 800-018-7873. This product is made in/Hecho en China. Imported by TRUPER, S.A. de C.V., Industrial Park 1, Industrial Park Jilotepec, Jilotepec, State of Mexico, C.P. 54257, Tel. 761 782 9100.



Stamp of the business. Delivery date: