

Cordless string trimmer

Manual

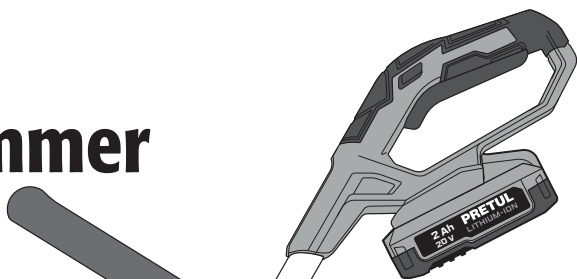

20 V_≡
Voltage

9"
Cutting diameter

DESI-20P

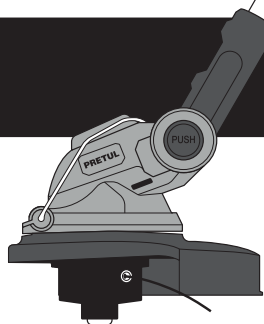

Applies for:

| Code | Model |
|-------|----------|
| 28272 | DESI-20P |





CAUTION



Read this manual thoroughly
before using the tool.



| | |
|---|----|
| Technical data..... | 3 |
| Electrical requirements..... | 3 |
|  General safety warnings for electric tools..... | 4 |
|  Safety warnings for use of string trimmer..... | 5 |
| Parts..... | 7 |
| Assembly..... | 8 |
| Start up..... | 9 |
| Maintenance..... | 11 |
| Troubleshooting..... | 12 |
| Authorized service centers..... | 13 |
| Warranty policy..... | 14 |

CAUTION

To get the most out of the tool, extend its lifespan, claim the warranty if necessary, and avoid serious risks or injuries, it is essential to read this manual in its entirety before using the tool.

Keep this manual for future references.

The illustrations in this manual are for reference and may differ from the real appearance of the tool.

Usage and care recommendations



Use **ONLY** the provided charger or the one suggested by **TRUPER** to charge the battery



Follow the battery **GUIDELINES** and charging **INSTRUCTIONS** (page 5)



To cut tall grass, do it gradually. **DO NOT** try to cut it all at once from the base (page 10)



KEEP the tool and charger ventilation slots **CLEAN**



Perform regular **MAINTENANCE** on your machine (page 11)

DESI-20P

| | | |
|-----------------------------|---|--|
| Code | • | 28272 |
| Description | • | Cordless string trimmer |
| Voltage | • | 20 V \equiv |
| Cutting diameter | • | 9" |
| Cutting string diameter | • | 0.065" |
| Speed | • | 9 000 RPM |
| Adjustable Handle length | • | 33" - 43" |
| Battery | • | 20 V \equiv 2 Ah Lithium-ion Charging time: 55 minutes |
| Charger | • | Input: Voltage : 127 V \sim Frequency: 60 Hz Current: 0.9 A Output: 21 V \equiv 2.5 A |

The Power cable has Y-type cable holders.
The tool's construction class is Class III.
The charger's construction class is Reinforced Insulation.

⚠ WARNING Avoid the risk of electric shock or severe injury. When the power cable gets damaged it should only be replaced by the manufacturer or at a TRUPER Authorized Service Center. The build quality of the electric insulation is altered if spills or liquid gets into the tool while in use. Do not expose to rain, liquids and/or dampness.

⚠ WARNING Before gaining access to the terminals all power sources should be disconnected.



Power requirements

⚠ WARNING Double-insulated and reinforced insulated tools eliminate the need for a 3-prong grounded power cord or a grounded electrical system.

⚠ WARNING When using an extension cord, make sure to use a gauge sufficient to carry the current your tool will consume. A lower gauge cable will cause voltage drops in the line, resulting in power loss and motor overheating. The following table shows the correct size to be used depending on the cable length and the amperage capacity indicated on the tool's data plate. If in doubt, use the next higher gauge.

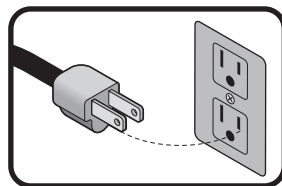

| Ampere Capacity | Number of Conductors | Extension gauge | |
|--------------------------|-------------------------|---------------------|-------------------|
| | | from 5.91' to 49.2' | higher than 49.2' |
| from 0 A and up to 10 A | 3 (one grounded) | 18 AWG(*) | 16 AWG |
| from 10 A and up to 13 A | | 16 AWG | 14 AWG |
| from 13 A and up to 15 A | | 14 AWG | 12 AWG |
| from 15 A and up to 20 A | | 8 AWG | 6 AWG |

* It is safe to use only if the extensions have a built-in artifact for over current protection.

AWG = American Wire Gauge. Reference: NMX-J-195-ANCE

⚠ WARNING When operating power tools outdoors, use a **volteck** grounded extension cable labeled "For Outdoors Use". These extensions are especially designed for operating outdoors and reduce the risk of electric shock.





WARNING! Read all safety warnings and all instructions listed below carefully. Failure to follow any of them may result in electric shock, fire, and/or serious injury. **Keep the warnings and instructions for future reference.**

Work area

Keep your work area clean, organized, and well-lit.

Cluttered and dim areas can lead to accidents.



Do not operate the tool in explosive atmospheres, such as in the presence of flammable liquids, gas, or dust.

The electric tools produce sparks that can ignite flammable material.



Keep children and other individuals at a safe distance while using the equipment.

Distractions can cause loss of control and lead to accidents.



Electrical Safety

The tool plug must match the outlet. Never modify a plug. Do not use any type of adapter for grounded tool plugs.

Modified plugs and different outlets increase the risk of electrical shock.

Avoid body contact with grounded surfaces such as pipes, radiators, electric stoves, and refrigerators.

There is an increased risk of electrical shock if the body is grounded.



Do not expose the tool to rain or humid conditions.

Water entering the tool increases the risk of electrical shock.

Do not force the cable. Never use the cable to transport, lift, or disconnect the tool. Keep the cable away from heat, oil, sharp edges, or moving parts.

Damaged or tangled cables increase the risk of electrical shock.

When using a tool outdoors, use a specially designed outdoor extension cord.

Using an appropriate outdoor extension cord reduces the risk of electrical shock.

If using the tool in a damp location is unavoidable, use a power supply protected by a ground fault circuit interrupter (GFCI).

Using a GFCI reduces the risk of electrical shock.

Personal Safety

Be alert, watch what you are doing, and use common sense when handling a tool. Do not use it if you are tired or under the influence of drugs, alcohol, or medication.

A moment of distraction while using the tool can cause personal injury.

Use safety equipment. Always wear eye protection.

The use of safety equipment such as safety glasses, dust mask, slip-resistant shoes, helmet, and ear protection in appropriate conditions significantly reduces the risk of personal injury.



Avoid accidental starts. Ensure the switch is in the "off" position before connecting to the power source and/or the battery or transporting the tool.

Carrying power tools with your finger on the switch or connecting power tools with the switch in the "on" position can cause accidents.

Remove any wrenches or adjusting tools before starting the power tool.

Wrenches or tools left on the rotating parts of the tool can cause personal injury.

Do not exceed your range of motion. Keep both feet firmly planted on the ground and always maintain balance.

This allows better control of the tool in unexpected situations.

Dress appropriately. Do not wear loose clothing or jewelry. Keep your hair, clothing, and gloves away from moving parts.

Loose clothes, jewelry, or long hair can get caught in moving parts.



If dust extraction and collection devices are available for the tool, check their connections and use them correctly.

The use of these devices reduces risks associated with dust.

Tool Use and Care

Do not force the tool. Use the appropriate tool for the task at hand.

The right tool performs better and is safer when used at the intended pace.

Do not use the tool if the switch is not functioning.

Any power tool that cannot be turned on or off is dangerous and must be repaired before operation.



Disconnect the tool from the power source and/or battery before making any adjustments, changing accessories, or storing it.

These measures reduce the risk of accidentally starting the tool.

Store the tools out of the reach of children and do not allow them to be handled by individuals unfamiliar with the tools or their instructions.

Power tools are dangerous in untrained hands.



Maintain the tool. Ensure that the moving parts are not misaligned or jammed, and that there are no broken parts or other conditions that may affect its operation. Repair any damage before using the tool.

Many accidents are caused by inadequate tool maintenance.



Keep cutting accessories sharp and clean.

Well-maintained cutting accessories are less likely to jam and easier to control.

Use the tool, its components, and accessories in accordance with these instructions and as intended for the type of tool, in appropriate working conditions.

Using the tool for applications other than those for which it is designed could cause a hazardous situation.

Use and care of the Battery-Powered Tool

Only recharge with the charger specified by PRETUL.

The charger included with the machine may pose a fire hazard if used with another battery.

Use batteries specifically designed for the tool.

The use of any other battery may pose a risk of damage and fire.

Make sure the switch is in the off position before inserting the battery.

Inserting the battery into electric tools with the switch on can cause issues.

When batteries are not in use, keep it away from any metallic objects such as clips, coins, keys, nails, screws, or any metallic object that may create a connection from terminal to another.

Short-circuiting between battery terminals can cause burns or fire.

In abusive conditions, battery liquid may be expelled; avoid contact. If accidental contact occurs, rinse with water.

If the liquid meets the eyes, seek medical assistance. The liquid expelled can cause irritation or burns.

Service

Repair the tool at a TRUPER Authorized Service Center using only identical replacement parts to maintain the safety of the tool.

This will ensure the safety of the power tool.

Safety warnings ⚠ for use of string trimmer ⚡

Safety is a combination of common sense, alertness, and knowledge of how the tool operates.

⚠ CAUTION • Read the instructions carefully before starting to use the tool. Pay attention to safety rules, warning symbols, and the hazard, caution, and attention notices in the instructions and on labels attached to the tool.

This appliance is not intended to be used by individuals (including children) with different or restricted physical, sensory, or mental capabilities, or without experience or knowledge, unless they are supervised or trained by a person responsible for their safety. Children should be supervised to ensure that they do not use the appliances as toys.

Batteries and charger

⚠ DANGER • Use only the included PRETUL charger for the battery of the tool. Other batteries may pose risks of injury or fire.

- Connect the charger only to an alternating current (AC) power supply.

⚠ DANGER • Do not use the charger outdoors.

- Respect the "+/-" polarity when charging.
- Never recharge a leaking battery.
- Do not use batteries or chargers for purposes other than those they were designed for.

- Do not modify the battery or charger contacts.
- Do not expose the battery pack to temperatures above 122 °F.

⚠ DANGER • Never expose batteries to fire; they could explode.

⚠ CAUTION • The battery can be damaged by pointed objects such as nails or screwdrivers or if subjected to external force.

⚠ CAUTION • Do not open the battery; there is a risk of a short circuit. Protect the battery from heat, intense continuous sunlight, fires, water, and moisture.

⚠ DANGER • Danger of explosion. In case of damage or incorrect use of the battery, it may emit vapor. Ventilate the area and consult a doctor if you feel unwell. Vapors can irritate the respiratory system.

⚠ CAUTION • To maximize the battery span, discharge it completely at least once a month. Do not leave the battery uncharged for more than three months. Always charge the battery to its maximum capacity. Charge the battery for a minimum of 1 hour before using the machine for the first time.

- Avoid constantly stopping while operating the tool to prevent

damage to the battery.

- Do not throw batteries into the fire. The battery may explode. Refer to local codes for possible special disposal instructions.

⚠ CAUTION Remove the battery before performing any work on the power tool. The battery must be charged before first use.

- Ensure that the exterior of the battery is clean and dry before connecting it to the charger or the machine.
- Insert the battery into the base of the machine and push it until it clicks into place (2).
- To remove it, press the battery release button (1).

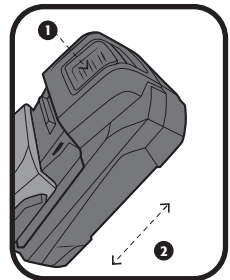

⚠ CAUTION Remember that this tool is designed for cutting grass as indicated in this manual. It should not, under any circumstances, be used for any other purpose.

Before operating the tool

- ⚠ CAUTION** • Read the instructions carefully. Familiarize yourself with the controls and proper use of the equipment.
- Use eye protection.
 - Never allow children or unfamiliar individuals to use the device.
 - Avoid using the device when people are around, especially children or pets.
 - Use the device only in daylight or when there is good lighting.
 - Never operate the device with damaged guards or protection or without guards and protections in place.
 - Turn on the engine only when hands and feet are away from the cutting elements.
 - Never assemble metal cutting elements.
 - Use only parts and replacement accessories recommended by the manufacturer.
 - Always disconnect the device from the power when not in use.
 - Disconnect the device from the power before performing maintenance or cleaning. Regularly inspect and maintain the device. The equipment should only be repaired at an authorized service center.
 - Be careful not to injure yourself with the blades used to adjust the filament length. After installing a new cutting filament, return the device to its normal use position before turning it on again.
 - Always ensure that the ventilation holes are free of debris.
 - When the device is not in use, keep it out of reach of children.
 - Thoroughly inspect the trimming area to avoid any obstacles and remove foreign objects that may be thrown by the trimmer. Otherwise, it can cause an accident and reduce the tool's lifespan.

⚠ CAUTION • The trimming area should be well-lit.

⚠ CAUTION • Make sure the trimmer has all its parts in optimal condition and that the cutting thread guard is properly placed. Check that the ventilation slots are free of debris. Do not use the trimmer if the guard is damaged or missing any parts.

⚠ WARNING • Use only original nylon line, and under no circumstances replace it with metal line.

• For best results, it is recommended to use only original thread replacements such as HTA-65B, HIDE-65P, HTA-65, and HDU-15-65 by TRUPER.



• Remember that this tool is designed for cutting grass as indicated in this manual. It should not be used for any other purpose.

⚠ WARNING • To avoid electric shocks, refrain from working in humid environments, during rain, and/or cutting wet grass.

When operating the tool

⚠ CAUTION • Do not use the trimmer near other people, children, or animals.

⚠ WARNING • Never allow the cutting head to exceed 30 cm in height, and do not direct it towards people or animals.

⚠ WARNING • Use the trimmer to cut only at ground level; under no circumstances use it to cut vegetation over stones or walls.

⚠ CAUTION • Do not walk on gravel surfaces with the trimmer running; the cutting line can throw gravel fragments at the operator or others, causing injuries.

⚠ CAUTION • Always keep the power cord in sight to avoid damaging it with the cutting line.

⚠ WARNING • Do not approach hands or feet to the cutting head while the trimmer is in operation.

⚠ DANGER • If working near traffic lanes, suspend cutting until there are no vehicles in sight. Foreign particles thrown by the trimmer towards moving vehicles can cause a serious accident.

After operating the tool

⚠ WARNING • The cutting elements continue to rotate after turning off the engine.

• Do not attempt to stop the rotating movement of the cutting line in any other way than releasing the switch. Wait for the spool to stop by itself after turning off the trimmer; this will take a few seconds.

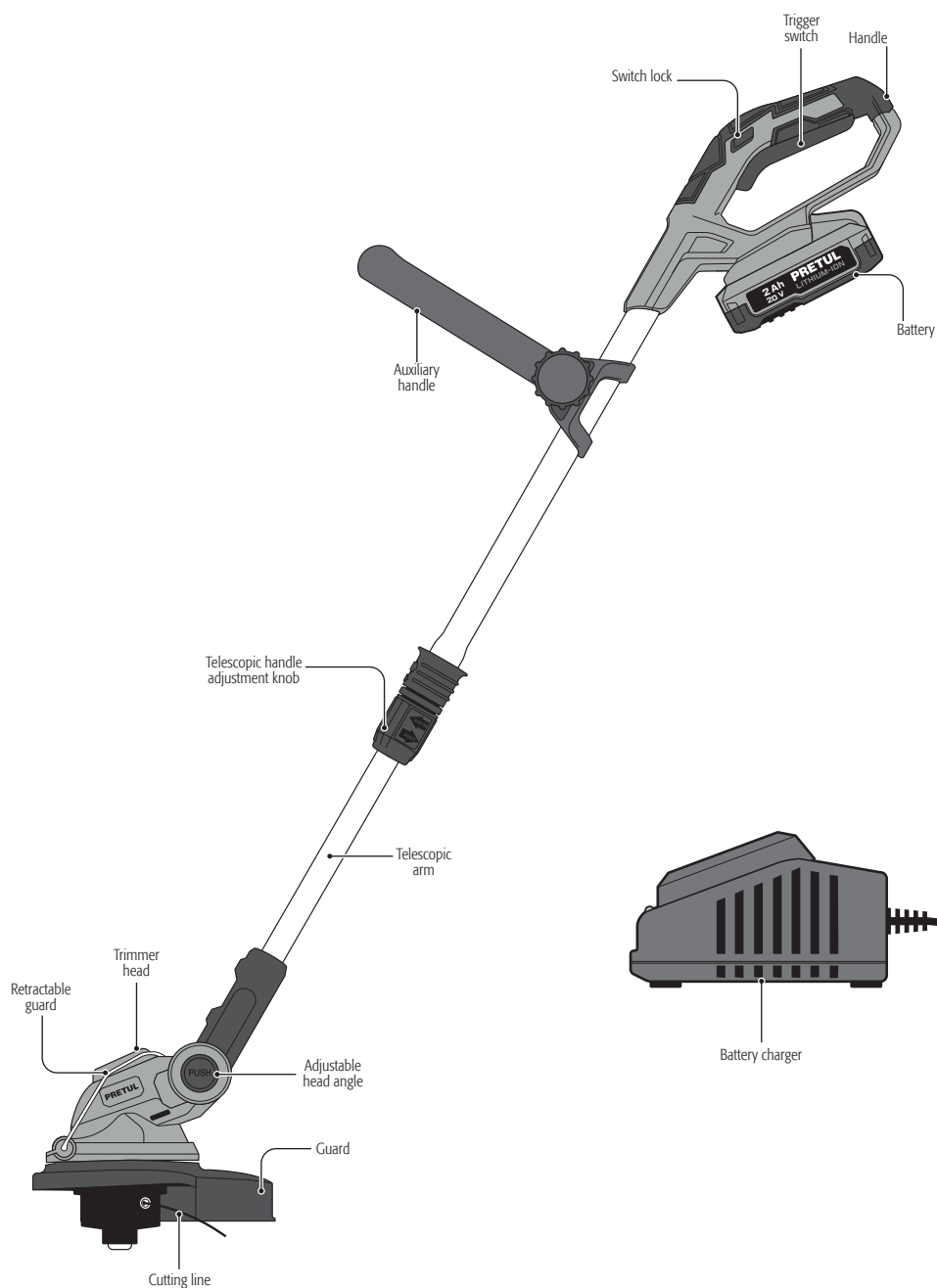

Guard

- To assemble and disassemble the guard, tighten, or loosen the two screws (A) on the bottom of the guard.

CAUTION • Operating your equipment without the guard increases the risk of accidents and can damage the machine.

CAUTION • Turn off and remove the battery from the trimmer before assembling or disassembling the guard.

Edge trimming guide

- To trim edges, use the retractable stop, moving it forward or backward.

CAUTION

- Turn off and disconnect the trimmer before adjusting the retractable stop.

Retractable edge guide

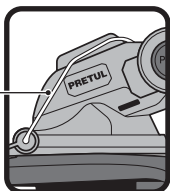

Be careful not to touch the edge of the cutting blade for the cutting line

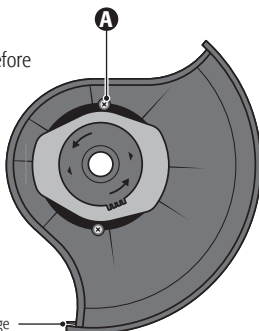

Adjustment of the auxiliary handle

- Place the auxiliary handle (D) on the base (E).
- Insert the screw into the hole of the handle (D) and the base (E) and secure the assembly by threading the knob (G).
- The angle and height of the auxiliary handle (D) can be adjusted.
- Loosen the knob (G) to position the handle as desired.
- Tighten the knob to lock the handle in place.

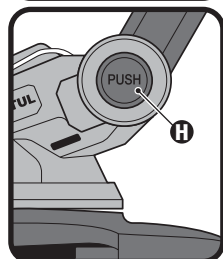
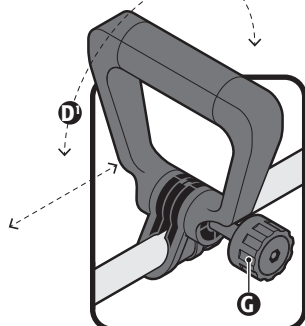
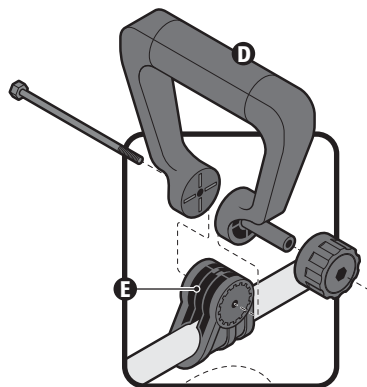
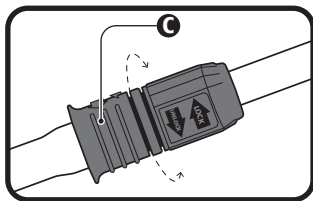

Cutting head tilt adjustment

- Press the button (H) and tilt the head to the most convenient position for the job.

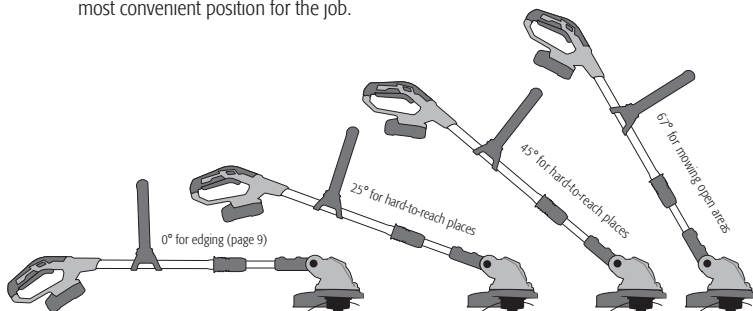

Cutting line spool

- Without the battery, remove the spool retainer cover **(B)** by pressing its side tabs inward and rotating the spool in the direction indicated with the "remove" label; pull the cover upwards.
- Remove the empty spool, ensure it is clean, and check for any damaged or worn parts.
- Cut a piece of cutting line 5.5 meters long.
- Tie a small knot at one end of the line.
- Take the other end of the line and thread it through the hole in the spool, then wind it in the direction indicated by the arrow marked on the spool cover. Avoid winding too much line; once coiled, leave at least 6.5 mm separating the wound line and the spool's edge.
- Unwound around 15 cm of the cutting line, then feed it through the spool cover's opening.
- Assemble the spool and cover, keeping the line slightly tight to prevent it from unwinding.
- Reinstall the spool into the cutting head. Press the spool cover against the cutting head and rotate it in the opposite direction from how it is marked on the spool cover until you hear a click.

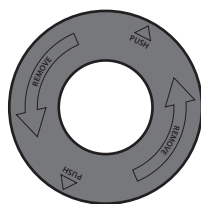
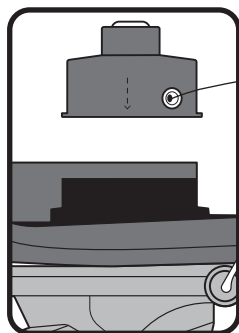
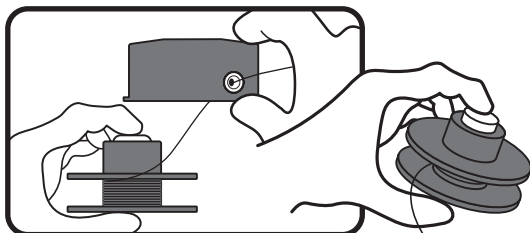
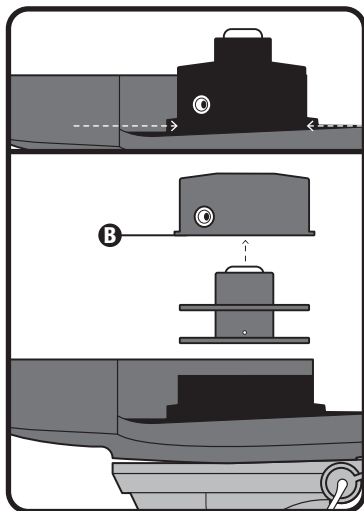

Start up

Switch on

- To turn on, press the switch lock **(B)** and hold the switch trigger **(A)** simultaneously.
- Unlock the switch lock once the tool has been turned on.
- ⚠ **CAUTION** • The tool will not turn on unless the locking lever and the on/off button are pressed simultaneously.
- To turn off the tool, release the switch trigger.
- ⚠ **CAUTION** • The cutting parts will continue moving for a while after the tool is turned off. Wait until they come to a complete stop. Do not attempt to stop the moving cutting parts, as there may be a risk of injury!

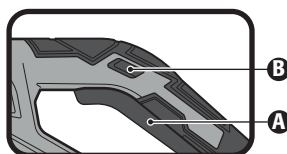

Considerations for battery usage

- Batteries come DISCHARGED from the factory. It will be necessary to charge them for approximately 55 minutes before use.
- The normal charging temperature is from 32 °F to 113 °F. Outside this range, charging is automatically suspended until it reaches the correct temperature. The normal discharge/working temperature is from 32 °F to 167 °F. If 167 °F is exceeded, the electronic control shuts off the power of the tool until the

temperature returns to the optimal temperature range. When the battery is below normal voltage during work, the tool stops operating.

- Between each charge, give the charger 15 minutes of rest. In a warm environment or after prolonged use, the battery may become too hot to be recharged. Allow the battery to cool before attempting to recharge it.

Battery Charging

- Plug the charger plug into a 127 V~ outlet (The green charge indicator light will turn on).
- Insert the battery into the charger by sliding it. The green light will go off, and the red light should turn on, indicating that the charging has started. Additionally, the level indicator on the battery will light up in a red-orange-green intermittent sequence.
- When the battery is fully charged, the green light will turn on again, and the red one will go off.
- Disconnect the charger from the power once the charging is completed.

Battery Failures

Green LED stays on, and the battery's red LED flashes due to overheating; wait for the battery temperature to be within the appropriate range to be able to charge.

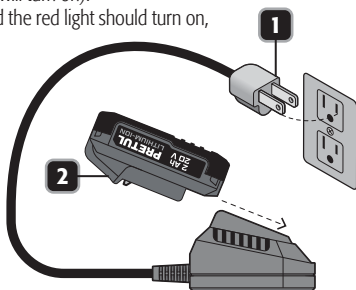

Operation

CAUTION • Remember that as the operator of the trimmer, you are responsible for your safety and those near the work area. Follow all safety rules before, during, and after operating the tool.

- Maintain a balanced posture with both feet firmly on the ground.
- Hold the trimmer firmly in front of you with the right hand on the handle at hip height and the left hand on the auxiliary handle so that the tool is aligned with your body and pointing the cutting head downward, away from your feet.

DANGER • Do not start or operate the trimmer in any other position.

- Start the trimmer and make cuts from left to right by rotating your waist while maintaining the tool's position.

NOTICE • The trimmer is equipped with a self-feeding head. Striking the head to try to advance the cutting line will invalidate the warranty of the trimmer.

- The cutting line will deteriorate with repeated cuttings and eventually break off. While the trimmer is running, you can release extra line from the spool by pressing the trigger switch once, waiting two seconds, and then pressing it again. Every time the trigger switch is turned on and off, the cutting line expands by around 6.5 mm (1/4") until it reaches the guard blade's length.

- Try not to cut tall grass or weeds all at once from the base, as debris might block the cutting head or cause you to lose control of the trimmer. Instead, remove the material gradually.
- Lower the retractable guard (A) to avoid damaging branches or walls while cutting work.

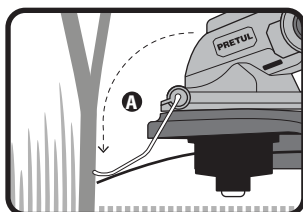
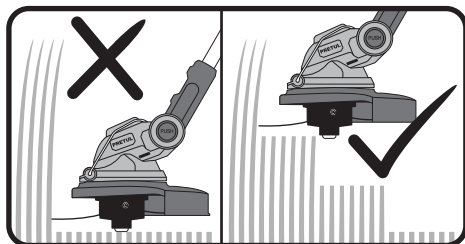
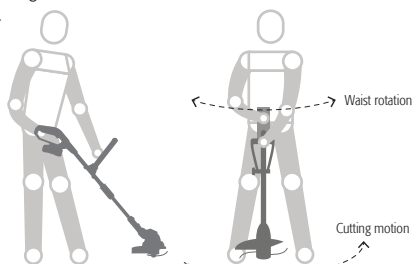

Edge trimming

- You must use the retractable edge guide and turn the trimmer head 180 degrees to trim the grass edges at the start of curbs or walkways
- Rotate the trimmer's top 180 degrees clockwise by pulling the adjustment knob **(B)** in the direction of the handle.
- Set the head to 20° (see head tilt adjustment).
- Position the retractable edge guide and move the cutting line across the grass.

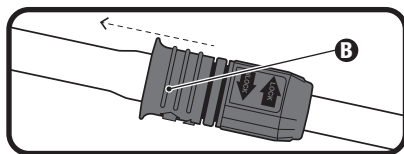

Maintenance

⚠ CAUTION • Always turn off the machine and remove the battery pack from the machine before cleaning and maintenance.

Cleaning and Care

- You can extend the trimmer's life and maintain its best condition by cleaning it after every usage.
- To clean, use a soft brush and a cloth dampened with hot water.
- Disassemble all of the tool's parts after each usage, making sure to get rid of any dirt or grass residue. Particular attention should be paid to the guard and the cutting line spool's grooves.
- Regularly clean the trimmer's ventilation slots to prevent dirt or grass from clogging them.

Service

- Any repair or maintenance should be carried out only at a TRUPER Authorized Service Center.

Environment

⚠ WARNING • Waste material from the tool, such as packaging, damaged parts, or the tool itself after reaching the end of its life, should not be treated as regular trash. They should be taken to a recycling center to be properly handled, adhering to all environmental standards.

Storage

- Clean the tool before storing it to prevent rust.
- Store the trimmer in a dry and temperate place, away from direct sunlight (preferably in a dark place) and out of the reach of children.
- Avoid storing the trimmer in plastic bags; otherwise, the generated moisture could damage it.
- Avoid storing the trimmer with the guard resting on the floor, as it could deform. The trimmer should be stored hanging from the upper handle so that the guard does not touch the ground.

| Problem | Cause | Corrective Action |
|---|---|---|
| The trimmer is losing effectiveness. | <ul style="list-style-type: none"> • Low battery. | <ul style="list-style-type: none"> • Charge the battery. |
| The trigger cannot be pressed. | <ul style="list-style-type: none"> • The switch lock is engaged. | <ul style="list-style-type: none"> • Press the switch lock to unlock. |
| The trigger can be pressed, but the head does not rotate. | <ul style="list-style-type: none"> • The battery is discharged. | <ul style="list-style-type: none"> • Charge the battery. |
| The battery is leaking. | <ul style="list-style-type: none"> • Normal minimal dripping may occur in extreme temperatures or after heavy use. • Intense or very noticeable dripping is due to a damaged battery. | <ul style="list-style-type: none"> • Clean any liquid from the skin or clothing immediately with water and soap. • Replace the battery immediately. |
| The battery does not charge, and the charge level indicator light does not turn on. | <ul style="list-style-type: none"> • Charger connection improperly installed on the battery. • Charger not properly connected to the power outlet. | <ul style="list-style-type: none"> • Insert the charger connection correctly into the battery. • Check that the charger plug is securely connected to the power outlet. |
| The trimmer heats up after prolonged periods of work. | <ul style="list-style-type: none"> • Normal heating. | <ul style="list-style-type: none"> • Allow the trimmer to cool for 5 minutes. |
| The battery heats up during operation. | <ul style="list-style-type: none"> • Normal heating due to energy extraction from the battery while the trimmer is running. | <ul style="list-style-type: none"> • Stop the trimmer for 5 minutes to allow the battery to cool. |
| The battery heats up during charging. | <ul style="list-style-type: none"> • Normal heating due to chemical reactions occurring inside the battery during charging. | |
| The charger heats up during charging. | <ul style="list-style-type: none"> • Normal heating due to voltage regulation. | |
| The cutting line does not advance when releasing and pressing the trigger switch. | <ul style="list-style-type: none"> • The cutting line is sticking together. • Insufficient line on the spool. • The line is tangled on the spool. • The line has not been released from the notches on the spool. | <ul style="list-style-type: none"> • Lubricate the cutting head with TRUPER silicone lubricant spray. • Install new line on the spool (refer to page 9). • Turn off the trimmer and retangle the line on the spool (refer to page 9). • Turn off the trimmer and pull the ends of both cutting lines to release them. |
| Grass wraps around the lower shaft and the cutting head. | <ul style="list-style-type: none"> • Cutting grass that is too high at ground level. | <ul style="list-style-type: none"> • Gradual Cutting of Tall Grass as indicated in page 10. |

In the event of any problem contacting a Service Center, please see our webpage WWW.TRUPER.COM to get an updated list, or call our toll-free numbers 800 690-6990 or 800 018-7873 to get information about the nearest TRUPER Authorized Service Center.

| | |
|---------------------|--|
| AGUASCALIENTES | DE TODO PARA LA CONSTRUCCIÓN GRAL. BARRAGÁN #1201, COL. GREMIAL, C.P. 20030, AGUASCALIENTES, AGS. TEL.: 449 994 0537 |
| BAJA CALIFORNIA | SUCURSAL TIJUANA AV. LA ENCANTADA, LOTE #5, PARQUE INDUSTRIAL EL FLORIDO II, C.P. 22244, TIJUANA, B.C. TEL.: 664 969 5100 |
| BAJA CALIFORNIA SUR | FIX FERRETERÍAS FELIPE ÁNGELES ESQ. RUIZ CORTÍNEZ S/N, COL. PUEBLO NUEVO, C.P. 23670, CD. CONSTITUCIÓN, B.C.S. TEL.: 613 132 1115 |
| CAMPECHE | TORNILLERÍA Y FERRETERÍA AAA AV. ALVARO OBREGÓN #324, COL. ESPERANZA C.P. 24080 CAMPECHE, CAMP. TEL.: 981 815 2808 |
| CHIAPAS | FIX FERRETERÍAS AV. CENTRAL SUR #27, COL. CENTRO, C.P. 30700, TAPACHULA, CHIS. TEL.: 962 118 4083 |
| CHIHUAHUA | SUCURSAL CHIHUAHUA AV. SILVESTRE TERRAZAS #128-11, PARQUE INDUSTRIAL BAFAR, CARRETERA MÉXICO CUAUHTÉMOC, C.P. 31415, CHIHUAHUA, CHIH. TEL.: 614 434 0052 |
| CIUDAD DE MÉXICO | FIX FERRETERÍAS EL MONSTRUO DE CORREGIDORA, CORREGIDORA # 35, COL. CENTRO, C.P. 06060, CUAUHTÉMOC, CDMX. TEL.: 55 5522 5051 / 5522 4861 |
| COAHUILA | SUCURSAL TORREÓN CALLE METAL MECÁNICA #280, PARQUE INDUSTRIAL ORIENTE, C.P. 27278, TORREÓN, COAH. TEL.: 871 209 68 25 |
| COLIMA | BOMBAS Y MOTORES BYMTESSA DE MANZANILLO BLVD. MIGUEL DE LA MADRID #190, COL. 16 DE SEPTIEMBRE, C.P. 28239, MANZANILLO, COL. TEL.: 314 352 1986 / 352 8013 |
| DURANGO | TORNILLOS ÁGUILA, S.A. DE C.V. MAZURIO #200, COL. LUIS ECHEVERRÍA, DURANGO, DGO. TEL.: 618 817 1946 / 618 818 2844 |
| ESTADO DE MÉXICO | SUCURSAL CENTRO JILOTEPEC PARQUE INDUSTRIAL # 1, COL. PARQUE INDUSTRIAL JILOTEPEC, JILOTEPEC, EDO. DE MÉX. C.P. 54257 TEL.: 761 782 9101 EXT. 5728 Y 5102 |
| GUANAJUATO | CÍA. FERRETERA NUEVO MUNDO S.A. DE C.V. AV. MÉXICO - JAPÓN #225, CD. INDUSTRIAL, C.P. 38010, CLEAIA, GTO. TEL.: 461 617 7578 / 79 / 80 / 88 |
| GUERRERO | CENTRO DE SERVICIO ECLIPSE CALLE PRINCIPAL MZ.1 LT. 1, COL. SANTA FE, C.P. 39010, CHILPANCIÑO, GRO. TEL.: 747 478 5793 |
| HIDALGO | FERREPRECIOS S.A. DE C.V. LIBERTAD ORIENTE #304 LOCAL 30, INTERIOR DE PASAJE ROBLED, COL. CENTRO, C.P. 43600, TULANCINGO, HGO. TEL.: 775 753 6615 / 775 753 6616 |
| JALISCO | SUCURSAL GUADALAJARA AV. ADOLFO B. HORN # 6800, COL. SANTA CRUZ DEL VALLE, C.P.: 45655, TLAJIOMULCO DE ZÚNIGA, JAL. TEL.: 33 3606 5285 AL 90 |
| MICHOACÁN | FIX FERRETERÍAS AV. PASEO DE LA REPÚBLICA #3140-A, COL. EX-HACIENDA DE LA HUERTA, C.P. 58050, MORELIA, MICH. TEL.: 443 334 6858 |
| MORELOS | FIX FERRETERÍAS CAPITÁN ANZURES #95, ESQ. JOSÉ PERDIZ, COL. CENTRO, C.P. 62740, CUAUTLA, MOR. TEL.: 735 352 8931 |
| NAVARRIT | HERRAMIENTAS DE TEPEC MAZATLÁN #117, COL. CENTRO, C.P. 63000, TEPEC, NAY. TEL.: 311 258 0540 |
| NUEVO LEÓN | SUCURSAL MONTERREY CARRETERA LAREDO #300, 1B MONTERREY PARKS, COLONIA PUERTA DE ANÁHUAC, C.P. 66052, ESCOBEDO, NUEVO LEÓN, TEL.: 81 8352 8791 / 81 8352 8790 |
| OAXACA | FIX FERRETERÍAS AV. 20 DE NOVIEMBRE #910, COL. CENTRO, C.P. 68300, TUXTEPEC, OAX. TEL.: 287 106 5092 |
| PUEBLA | SUCURSAL PUEBLA AV. PERIFÉRICO #2-A, SAN LORENZO ALMECATLA, C.P. 72710, CUAUTLACINGO, PUE. TEL.: 222 282 8282 / 84 / 85 / 86 |
| QUERÉTARO | ARU HERRAMIENTAS S.A. DE C.V. AV. PUERTO DE VERACRUZ #110, COL. RANCHO DE ENMEDIO, C.P. 76842, SAN JUAN DEL RÍO, QRO. TEL.: 427 268 4544 |
| QUINTANA ROO | FIX FERRETERÍAS CARRETERA FEDERAL MZ. 46 LT. 3 LOCAL 2, COL. EJIDAL, C.P. 77710 PLAYA DEL CARMEN, Q.R. TEL.: 984 267 3140 |
| SAN LUIS POTOSÍ | FIX FERRETERÍAS AV. UNIVERSIDAD #1850, COL. EL PASEO, C.P. 78320, SAN LUIS POTOSÍ, S.L.P. TEL.: 444 822 4341 |
| SINALOA | SUCURSAL CULIACÁN AV. JESÚS KUMATE SUR #4301, COL. HACIENDA DE LA MORA, C.P. 80143, CULIACÁN, SIN. TEL.: 667 175 9139 / 173 8400 |
| SONORA | FIX FERRETERÍAS CALLE 5 DE FEBRERO #517, SUR LT. 25 MZ. 10, COL. CENTRO, C.P. 85000, CD. OBREGÓN, SON. TEL.: 644 413 2392 |
| TABASCO | SUCURSAL VILLAHERMOSA CALLE HELIO LOTES 1, 2 Y 3 MZ. #1, COL. INDUSTRIAL, 2A ETAPA, C.P. 86010, VILLAHERMOSA, TAB. TEL.: 993 553 7244 |
| TAMAULIPAS | VM ORINGS Y REFACCIONES CALLE ROSITA #527 ENTRE 20 DE NOVIEMBRE Y GRAL. RODRÍGUEZ, FRACC. REYNOSA, C.P. 88780, REYNOSA, TAMS. TEL.: 899 926 7552 |
| TLAXCALA | SERVICIOS Y HERRAMIENTAS INDUSTRIALES PABLO SIDAR #132, COL. BARRIO DE SAN BARTOLOMÉ, C.P. 90970, SAN PABLO DEL MONTE, TLAX. TEL.: 222 271 7502 |
| VERACRUZ | LA CASA DISTRIBUIDORA TRUPER BLVD. PRIMAVERA, ESQ. HORTENSIA S/N, COL. PRIMAVERA C.P. 93308, POZA RICA, VER. TEL.: 782 825 8100 / 826 8484 |
| YUCATÁN | SUCURSAL MÉRIDA CALLE 33 #600 Y 602, LOCALIDAD ITZINCAB Y MULSAY, MPIO. UMANÁ, C.P. 97390, MÉRIDA, YUC. TEL.: 999 912 2451 |

| Code | Model | Brand |
|-------|----------|---------|
| 28272 | DESI-20P | PRETUL® |

Warranty. Duration: 1 year. Coverage: parts, components and workmanship against manufacturing or operating defects, except if used under conditions other than normal; when it was not operated in accordance with the instructive; was altered or repaired by personnel not authorized by **TRUPER®**. To make the warranty valid, present the product, stamped policy or invoice or receipt or voucher, in the establishment where you bought it or in Corregidora 35, Centro, Cuauhtémoc, CDMX, 06060, where you can also purchase parts, components, consumables and accessories. It includes the costs of transportation of the product that derive from its fulfillment of its service network. . Phone number **800-018-7873**. Made in China. Imported by TRUPER, S.A. de C.V. Parque Industrial 1, Parque Industrial Jilotepec, Jilotepec, Edo. de Méx. C.P. 54257, Phone number 761 782 9100.

Stamp of the business. Delivery date:

