

Manual

# Drill and accessory kit

**20 V<sub>≡</sub>** **1/2"**  
Chuck

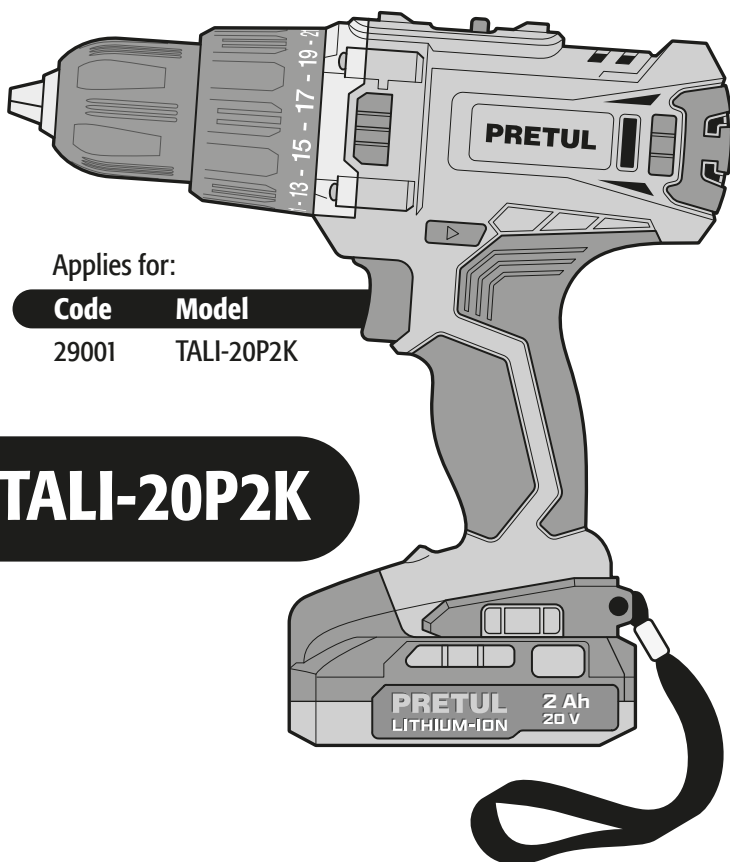

Applies for:

Code	Model
29001	TALI-20P2K

**TALI-20P2K**



Read the user's manual thoroughly  
before operating this tool.



Technical data .....	3
Power requirements .....	3
 Safety warnings for power tools .....	4
 Safety warnings for drills / drivers .....	5
Parts .....	6
Start up .....	6
Troubleshooting .....	9
Maintenance .....	9
Environmental protection .....	9
Notes .....	10
Authorized service centers .....	11
Warranty policy .....	12

## CAUTION

To gain the best performance of the tool, prolong the duty life, make the Warranty valid if necessary, and to avoid hazards of fatal injuries please read and understand this manual before using the tool.

Keep this manual for future references.

The illustrations in this manual are for reference only. They might be different from the real tool.

## Use and care recommendations



Use **ONLY** the provided charger or the one suggested by TRUPER to charge the battery.



Follow the battery **GUIDELINES** for battery usage and charging (pages 6 and 7).



Check the **TORQUE** settings and **SPEED** guide (pages 7 and 8).



Keep the tool and charger ventilation slots **CLEAN**.



Perform regular **MAINTENANCE** on your machine (page 9).

## TALI-20P2K

Code	•	29001
Description	•	Drill and accessory kit
Chuck	•	1/2" keyless
Voltage	•	20 V $\equiv$
Speed	•	0 RPM - 350 RPM   0 RPM - 1 500 RPM
Rotation	•	Forward - Reverse
Torque	•	21 + 1 function
Boring capacity	•	Wood: 5/8"   Metal: 1/2"
Battery	•	Ion-Lithium 20 V $\equiv$ 2 Ah   Charging time: 55 minutes approximately
Charger	•	Input: Voltage: 127 V $\sim$ Frequency: 60 Hz Current: 0.9 A Output: 21 V $\equiv$ 2.5 A

Charger power cord grips used in this product: Type "Y".

Tool build quality: Class III.

Charger tool build quality: Reinforced insulation.

**⚠ WARNING** Avoid the risk of electric shock or severe injury. When the power cable gets damaged it should only be replaced by the manufacturer or at a TRUPER Authorized Service Center.

The build quality of the electric insulation is altered if spills or liquid gets into the tool while in use. Do not expose to rain, liquids and/or dampness.

**⚠ WARNING** Before gaining access to the terminals all power sources should be disconnected.



## Power requirements

**⚠ WARNING** Tools with double insulation and reinforced insulation eliminate the need of a grounded power cord with three prongs or a grounded power connection.

**⚠ WARNING** When using an extension cable, verify the gauge is enough for the power that your product needs. A lower gauge cable will cause voltage drop in the line, resulting in power loss and overheating. The following table shows the right size to use depending on cable's length and the ampere capability shown in the tool's nameplate. When in doubt use the next higher gauge.

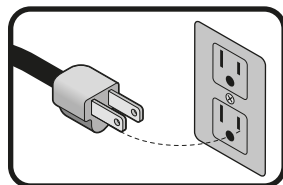

Ampere capacity	Number of conductors	Extension gauge	
		from 6' to 49'	higher than 49'
from 0 A and up to 10 A	3 (one grounded)	18 AWG(*)	16 AWG
from 10 A and up to 13 A		16 AWG	14 AWG
from 13 A and up to 15 A		14 AWG	12 AWG
from 15 A and up to 20 A		8 AWG	6 AWG

\* It is safe to use only if the extensions have a built-in artifact for over current protection.

AWG = American Wire Gauge. Reference: NMX-I-195-ANCE

**⚠ WARNING** When operating power tools outdoors, use a **5 VOLTECK** grounded extension cable labeled "For Outdoors Use". These extensions are especially designed for operating outdoors and reduce the risk of electric shock.



**⚠ WARNING! Read carefully all safety warnings and instruction listed below.** Failure to comply with any of these warnings may result in electric shock, fire and / or severe damage. **Save all warnings and instructions for future references.**

### Work area

**Keep your work area clean, and well lit.**

Cluttered and dark areas may cause accidents.



**Never use the tool in explosive atmospheres, such as in the presence of flammable liquids, gases or dust.**

Sparks generated by power tools may ignite the flammable material.



**Keep children and bystanders at a safe distance while operating the tool.**

Distractions may cause losing control.



### Electrical safety

**The tool plug must match the power outlet. Never modify the plug in any way. Do not use any adapter plugs with grounded power tools.**

Modified plugs and different power outlets increase the risk of electric shock.



**Avoid body contact with grounded surfaces, such as pipes, radiators, electric ranges and refrigerators.**

The risk of electric shock increases if your body is grounded.

**Do not expose the tool to rain or wet conditions.**

Water entering into the tool increases the risk of electric shock.

**Do not force the cord. Never use the cord to carry, lift or unplug the tool. Keep the cord away from heat, oil, sharp edges or moving parts.**

Damaged or entangled cords increase the risk of electric shock.

**When operating a tool outdoors, use an extension cord suitable for outdoor use.**

Using an adequate outdoor extension cord reduces the risk of electric shock.

**If operating the tool in a damp location cannot be avoided, use a ground fault circuit interrupter (GFCI) protected supply.**

Using a GFCI reduces the risk of electric shock.

### Personal safety

**Stay alert, watch what you are doing and use common sense when operating a tool. Do not use a power tool while you are tired or under the influence of drugs, alcohol or medication.**

A moment of distraction while operating the tool may result in personal injury.

**Use personal protective equipment. Always wear eye protection.**

Protective equipment such as safety glasses, anti-dust mask, non-skid shoes, hard hats and hearing protection used in the right conditions significantly reduce personal injury.



**Prevent unintentional starting up. Ensure the switch is in the "OFF" position before connecting into the power source and / or battery as well as when carrying the tool.**

Transporting power tools with the finger on the switch or connecting power tools with the switch in the "ON" position may cause accidents.

**Remove any wrench or vice before turning the power tool on.**

Wrenches or vices left attached to rotating parts of the tool may result in personal injury.

**Do not overreach. Keep proper footing and balance at all times.**

This enables a better control on the tool during unexpected situations.

**Dress properly. Do not wear loose clothing or jewelry. Keep hair, clothes and gloves away from the moving parts.**

Loose clothes, jewelry or long hair may get caught in moving parts.



**If you have dust extraction and recollection devices connected onto the tool, inspect their connections and use them correctly.**

Using these devices reduce dust-related risks.

### Power tools use and care

**Do not force the tool. Use the adequate tool for your application.**

The correct tool delivers a better and safer job at the rate for which it was designed.



**Do not use the tool if the switch is not working properly.**

Any power tool that cannot be turned ON or OFF is dangerous and should be repaired before operating.

**Disconnect the tool from the power source and / or battery before making any adjustments, changing accessories or storing.**

These measures reduce the risk of accidentally starting the tool.

**Store tools out of the reach of children. Do not allow persons that are not familiar with the tool or its instructions to operate the tool.**

Power tools are dangerous in the hands of untrained users.



**Service the tool. Check the mobile parts are not misaligned or stuck. There should not be broken parts or other conditions that may affect its operation. Repair any damage before using the tool.**

Most accidents are caused due to poor maintenance to the tools.



**Keep the cutting accessories sharp and clean.**

Cutting accessories in good working conditions are less likely to bind and are easier to control.

**Use the tool, components and accessories in accordance with these instructions and the projected way to use it for the type of tool when in adequate working conditions.**

Using the tool for applications different from those it was designed for, could result in a hazardous situation.

### Battery tool use and care

**Recharge only with the charger specified by TRUPER.**

A charger that is suitable for one type of battery pack may create a risk of fire when used with another battery pack.

**Use power tools only with specifically designated battery packs.**

Use of any other battery packs may create a risk of injury and fire.

**When battery pack is not in use, keep it away from other metal objects, like paper clips, coins, keys, nails, screws, or other small metal objects, that can make a connection from one terminal to another.**

Shorting the battery terminals together may cause burns or a fire.

**Under abusive conditions, liquid may be ejected from the battery; avoid contact. If contact accidentally occurs, flush with water. If liquid contacts eyes, additionally seek medical help.**

Liquid ejected from the battery may cause irritation or burns.

### Service

**Repair the tool in a TRUPER Authorized Service Center using only identical spare parts.**

This will ensure that the safety of the power tool is maintained.

# Safety warnings for Drills / drivers

# PRETUL

## Battery and charger

**⚠ DANGER** • Use only the PRETUL charger included to charge the battery. Using a different charger may cause fire or injury hazard.

**⚠ DANGER** • Use only batteries specifically designed for the tool. Different batteries could generate risk of injury or fire.

**⚠ DANGER** • Do not use the charger outdoors. 

- When charging, obey the “+/-” polarity.
- Never recharge a leaking battery or that is visibly damaged.
- Do not use batteries or a charger for purposes different that it was designed for.
- Do not modify the battery contacts or the chargers.
- Never expose the batteries to higher than 122 °F temperatures or direct sun light.

**⚠ DANGER** • Never expose the batteries to fire or impact. They could explode.

**⚠ CAUTION** • Batteries shall be kept away from metallic objects like clips, coins, keys, nails, screws or other type of object making contact with the terminals. It would cause a short circuit and burns or fire. They should be kept clean, dry and in good repair.

**⚠ CAUTION** • Under extreme conditions the battery liquid could spill out. Avoid any contact. If an accidental contact happens clean with enough water. If the battery liquid comes into contact with your eyes, clean with enough water and immediately go see the doctor. Liquid expelled from the batteries could cause irritation or burns.

- Remove battery when not in use.

**⚠ CAUTION** • If the battery will be stored for long periods of time, keep an intermediate charge (40%) to maximize its useful life. Do not leave it completely charged for long periods of time, or leave it charging when not in use.

- Keep batteries away from children reach.
- Do not discard batteries together with household trash. Go to a specialized center for it's recycling.

## Choose the right bit

**⚠ CAUTION** • Choose the right bit for the work piece. It reduces the risk of severe injury and makes the job easier.

- To work on metal or plastic, use bits suitable for metal. Sizes encompass a minimum of 0.03" (0.05" for a 0.5" chuck) and up to the chuck maximum capacity.
- On wood, use regular bits suitable for wood. In any case, to drill 0.025" or smaller orifices, use bits designed to drill on metal.
- Do not try using bits exceeding the chuck capacity.

## Before operating the tool

- Take your time to evaluate the task and make sure all necessary precautions are in place before you start drilling.
- Secure the bit properly in the chuck.

**⚠ DANGER** • Before drilling into a wall, floor, or ceiling, check for any embedded objects like electrical wires, conduits, or pipes. 

**⚠ DANGER** • Make sure the switch is off before inserting the battery to prevent the tool from starting unexpectedly, which could cause serious injury.

**⚠ DANGER** • Always turn off and unplug the tool before reversing the chuck's direction or installing/replacing a bit.

## While operating the tool

- Hold the tool by it's isolated surfaces designed for that purpose, especially when making jobs where the bit might contact hidden wiring. Contact with a power cable makes the metallic parts of the tool will be energized as well and produce a short circuit to the operator.

• Do not submit the tool to excessive loads.

**⚠ CAUTION** • If the bit gets stuck in the work piece, turn off the tool immediately. Then, remove the bit from the work piece. Do not try to remove stuck bits turning on and off the tool.

- Do not put excessive pressure on the tool to accelerate boring. Otherwise the bit will get damaged and the tool efficiency will diminish as well as it working life.

**⚠ WARNING** • The largest the bit diameter, the reactive force is higher. The reactive force is higher causing loss of control over the tool. To prevent this possibility hold firmly the tool with both hands, and keep good footing while boring at 90°.

- Stay alert and ready to relax the force when the bit goes through the material. Sudden movements can break the bit or damage the tool.

**⚠ CAUTION** • Do not touch the bit or the orifices immediately after drilling. Wait for them to cool off to manipulate. Do not try to cool them with water or oil.

- Before leaving the tool aside make sure all the moving parts have come to a complete stop.

• Avoid setting the tool where there are particles and / or dust immediately after use. These can get absorbed inside the tool mechanism and damage the machine.

- Wear hearing protectors when making jobs with a noise level higher than 85 dB. 

• Wear anti-dust mask and dust extraction equipment if necessary. Remember that working with materials like asbestos, leaded paint, additives, some types of wood, metals or minerals are highly toxic.

- Wear safety eyeglasses.   



5 Bits of 2"  
PH1 / PH2 (x2)  
Flat 1/4" | 3/16"



5 Bits of 1"  
PH1 / PH2 (x2)  
Flat 1/4" | 3/16"



4 Concrete drill bits  
3/16" x 4" | 1/4" x 4"  
5/16" x 4" | 3/8" x 5"



4 HSS drill bits  
5/32" | 1/8" | 3/16" | 1/4"



4 Brad-point wood drill bits  
5/32" | 3/16" | 7/32" | 1/4"



3 Glass drill bits  
3/16" | 1/4" | 5/16"



3 Flat drill bits for wood  
1/2" | 3/4" | 1"



3 Magnetic nut driver sockets  
1/4" | 5/16" | 3/8"



1 Magnetic extension 60 mm  
1 Flexible extension of 30 cm

20 pieces of screw # 6

20 pieces of screw # 8

20 plastic plugs 1/4"

20 plastic plugs 3/8"

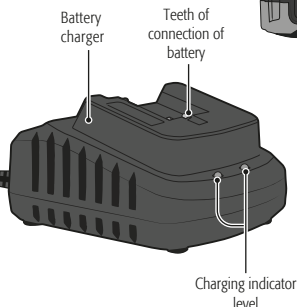
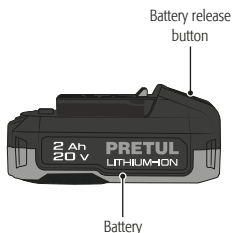
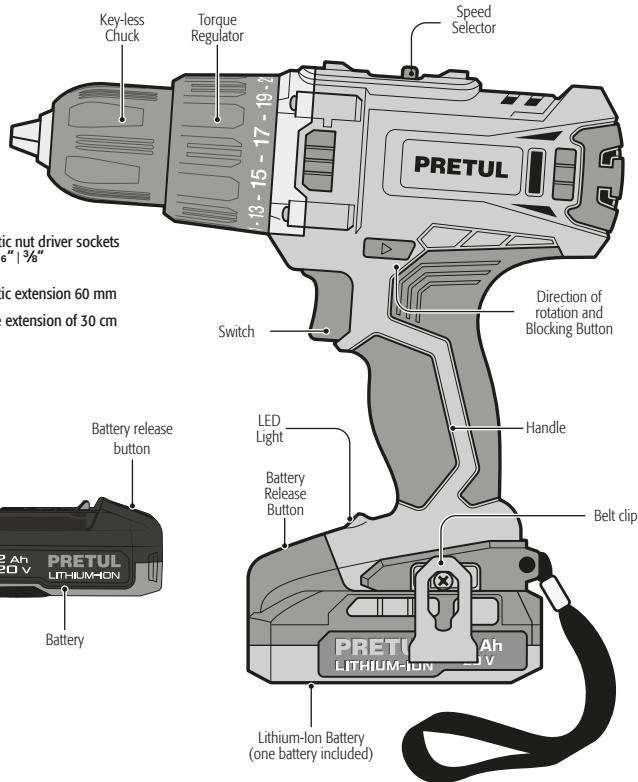

## Start up

### Belt clip assembly

- Attach the clip on the tool's accessory-designed side.
- Use the included screw (A) to adjust the clip.
- **NOTE:** If the tool already has the screw in position, just take it out before securing the clip.
- If you choose not to use the belt clip, you can detach it from the tool by loosening the screw that keeps it in position.

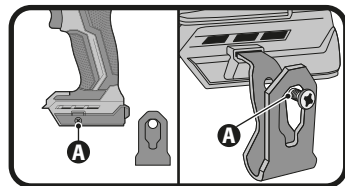

### Charging the battery

1. Connect the charger plug into a 127 V~ power outlet.
  2. Insert the battery in the charger sliding it as shown in the image. Once connected, the charger indicator green light will turn off and the red light will turn on, showing that the charge has started.
- When the battery is fully charged, the green light will turn on, and the red one will turn off.
  - Disconnect the charger from the power outlet once the charge finishes.
  - If the red on the battery level indicator blinks, means battery temperature is lower than 32 °F or higher than 113 °F. Wait until the battery temperature gets to the right temperature range to charge.
  - If the battery indicator lights do not turn on after inserting the battery into the charger, it indicates a defective battery. Please replace the battery with a new one.

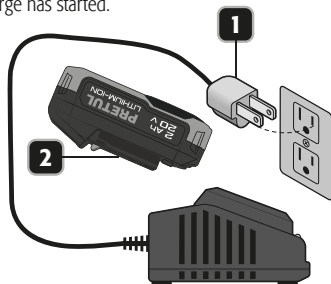

## General remarks for using the battery

The battery is shipped NOT CHARGED. It is necessary to charge the battery approximately 55 minutes before being able to use it. The normal charge is 32 °F to 113 °F. When not in this level the charge automatically stops until reaching the right temperature. The normal temperature for discharge / work is 32 °F to 167 °F. If 167 °F are exceeded, the electronic control stops the tool energy until the temperature reaches the temperature optimum new level. When the battery is below the normal tension while working the tool stops working. Give the tool 15 minutes rest. In warm weather or after a long period of work the battery will get too hot to recharge. Allow the battery to cool down before trying to charge again.

## Bits or adaptors assembly

- Hold the Chuck handle firmly with one hand and with the other hand turn the tip of the chuck counter clockwise, so that the jaws loosen.
- Insert the bit until it stops or remove it whichever the situation.
- Hold the Chuck base firmly with one hand and with the other hand turn the tip of the chuck clockwise to secure the bit.

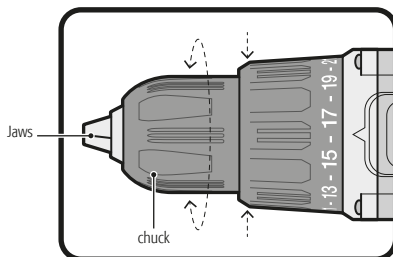

## Direction of rotation

- To bore and screw release the switch and press the direction button on the side where marks point towards the chuck.
- To reverse the turn, and unscrew press it on the other side.
- The drill switch will get blocked if the button sits in the middle.

**⚠ CAUTION** • The first time you turn on the drill and after reversing rotation you might hear a click. This in normal and does not represent a problem.

**⚠ CAUTION** • To prevent damaging the tool, never reverse the rotation direction while the drill is running.

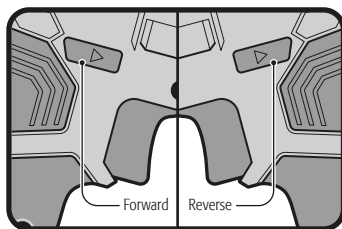

## Speed selection

- The two speeds in the drill work in a similar manner to those used in cars.
- Low speed (1) will give a lot of torque (torsion power). Use this speed when starting to drill large orifices, be it wood or metal. This will prevent the bit to get stuck.
- High speed (2) has a reduced torque but lets the drill operate with higher revolutions per minute, that make the tool when in the drill function to bore faster lean metal or wood.

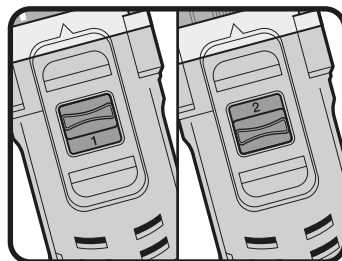

## Torque adjust

- To select the desired torque level to screw drive, turn the torque regulator until it matches the corresponding number with the upper mark: From 1 to 4 for small screws, From 5 to 9 for screws on soft materials, From 10 to 15 for screws on soft and hard material.
- To bore metal, wood or plastic turn the torque regulator into the ROTATION (∞) position.

**⚠ CAUTION** • The torque level necessary depends on the type of screw to be used and the material onto which you are working. If in doubt use a lower torque and increase gradually until reaching the right one. An adequate torque prevents damaging the tool.

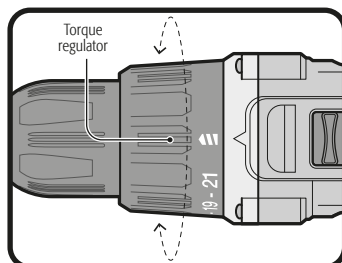

## Turn on and operation control

- The switch allows selecting the adequate speed for each job. The more you push the switch the fastest the drill will run.
- The switch is also built with a braking function. When releasing the trigger, the drill will immediately stop and you will be able to use it as a manual screwdriver to give a screw an extra turn.

## Screwing - unscrewing

- It is recommended to first bore a "pilot orifice"; slightly longer and barely narrower than the measurements of the screw. This orifice will be the entry guide for the screw and will make it easier to tighten. When screwing near the edge of a work piece, a pilot orifice prevents the wood from cracking.
- Use the adequate type of tip for each screw head to prevent the screw from sticking over from the surface.
- If inserting the screw gets difficult, remove and try to bore a slightly longer or wider orifice. However keep in mind there should be enough material to fasten the screw. If you reinitiate the screwing operation in an already-made orifice, start threading it by hand. If still difficult to thread the screw (as with noble woods), try using lubricants like soap. Liquid soap is more useful.
- Always apply enough pressure on the drill to prevent the screw head to slide. It is easy that the screw head gets damaged, making it difficult to completely get inserted or even to remove it.

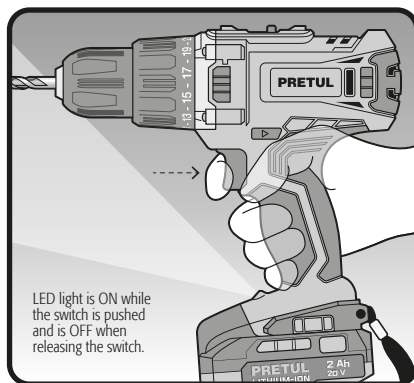

## Additional recommendations

- Use the adequate speed for each job: do not try to bore at low speeds or to screw at high speeds.
- If the operation overloads the drill, take it out and repeat the operation applying less strength.
- Use low speeds to start bores where there is no support point; on plastic or metal; when screwing, boring ceramic or any other application that requires a high torque. Use high speeds to drill woods and using polishing devices.
- To get a longer drill duty life, use the variable speed control.

## Drilling

- When trying to bore large diameter orifices it is better to start with a narrow bit and then replace it with the required size. This prevents overloading the drill.
- When drilling deep orifices remove the bit a little and regularly while boring to allow the shavings to be correctly expelled from the orifice.

**⚠ CAUTION** • If the bit gets stuck, immediately release the switch to prevent damaging the tool. Try to release the bit reversing the operation direction.

- Keep the drill aligned regarding the orifice. Ideally the bit shall enter the work piece perpendicularly. If the angle is changed while drilling, it could make the bit to break and block the orifice or causing personal injury.



Problem	Cause	Solution
The drill loses efficiency.	<ul style="list-style-type: none"> <li>• Low battery.</li> </ul>	<ul style="list-style-type: none"> <li>• Charge the battery.</li> </ul>
The trigger cannot be pushed.	<ul style="list-style-type: none"> <li>• The direction rotation button is in the blocking position.</li> </ul>	<ul style="list-style-type: none"> <li>• Move the direction button into the rotate or reverse position.</li> </ul>
The trigger can be pushed but the drill stops operations.	<ul style="list-style-type: none"> <li>• Uncharged battery.</li> <li>• Regulator is adjusted into a inadequate torque.</li> </ul>	<ul style="list-style-type: none"> <li>• Charge battery.</li> <li>• Adjust the regulator into a torque that allows the job. Try with the next torque level.</li> </ul>
The torque regulator stops operation.		
The battery leaks.	<ul style="list-style-type: none"> <li>• Small leaking can be present in extreme temperatures or after heavy use. This is normal.</li> <li>• Intense leaking or very evident shows a damaged battery.</li> </ul>	<ul style="list-style-type: none"> <li>• Immediately clean the liquid from skin or clothing using water and soap.</li> <li>• Replace the battery immediately.</li> </ul>
The battery is not charging and the charger light is not on.	<ul style="list-style-type: none"> <li>• The battery is wrongly fit into the charger.</li> <li>• The charger is not correctly plugged into the power outlet.</li> </ul>	<ul style="list-style-type: none"> <li>• Insert correctly the battery to the charger.</li> <li>• Double-check the battery is correctly connected into the power outlet.</li> </ul>
The drill gets hot after long periods or work.	<ul style="list-style-type: none"> <li>• This heating is normal. It absorbs the energy from the motor cogs and the electricity generated during the job.</li> </ul>	<ul style="list-style-type: none"> <li>• Allow the drill to cool off for 5 minutes.</li> </ul>
The battery gets hot while operating.	<ul style="list-style-type: none"> <li>• This heating is normal. The energy absorbed from the battery makes this warning.</li> </ul>	<ul style="list-style-type: none"> <li>• Stop the drill around 5 minutes to allow the battery to cool off.</li> </ul>
The battery gets hot while charging.	<ul style="list-style-type: none"> <li>• This type of warming is normal. Results from the chemical reactions happening.</li> </ul>	
The charger gets hot while charging.	<ul style="list-style-type: none"> <li>• This type of warming is normal resulting from tension regulation.</li> </ul>	

## Maintenance

### Cleaning and care

- Keep the air vents clean and free of obstructing debris to guarantee an adequate motor cooling.
- Regularly inspect all the assembly screws. Double check they are correctly tightened. In the event one screw is loose, tighten immediately.
- Use a clean and soft cloth to clean the tool. Never use alcohol or detergent. Disconnect the tool and remove the battery before cleaning.

### Service

- Servicing the tool shall be carried out only in a TRUPER Authorized Service Center.
- Service and maintenance carried out by non - qualified people may result dangerous and could cause personal damage. It also makes the Warranty void.

## Environmental protection

Power tools and batteries should not be disposed off together with household trash. Please deliver this tool and the batteries to its adequate recycling in the authorized disposal sites. Verify the nearest recycling center in your community.

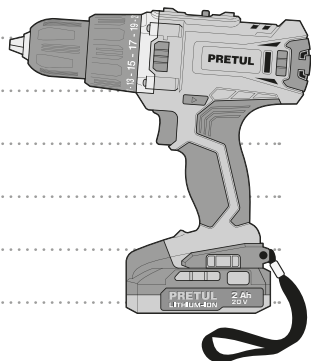
A grey and black cordless drill is positioned at the bottom right corner of the page. The brand name 'PRETUL' is visible on the side of the handle, and '2.8A' is printed near the base. The drill is oriented horizontally, pointing towards the left. The background of the entire page is white with horizontal dotted lines for writing.

In the event of any problem contacting a TRUPER Authorized Service Center, please see our webpage [WWW.TRUPER.COM](http://WWW.TRUPER.COM) to get an updated list, or call our toll-free numbers 800 690-6990 or 800-018-7873 to get information about the nearest Service Center.

## AGUASCALIENTES

### DE TODO PARA LA CONSTRUCCIÓN

GRAL. BARRAGÁN #1201, COL. GREMIAL, C.P. 20030, AGUASCALIENTES, AGS. TEL.: 449 994 0537

## BAJA CALIFORNIA

### SUCURSAL TIJUANA

AV. LA ENCANTADA, LOTE #5, PARQUE INDUSTRIAL EL FLORIDO II, C.P. 22244, TIJUANA, B.C. TEL.: 664 969 5100

## BAJA CALIFORNIA SUR

### FIX FERRETERÍAS

FELIPE ÁNGELES ESQ. RUIZ CORTÍNEZ S/N, COL. PUEBLO NUEVO, C.P. 26670, CD. CONSTITUCIÓN, B.C.S. TEL.: 613 152 1115

## CAMPECHE

### TORNILLERÍA Y FERRETERÍA AAA

AV. ALVARO OBREGÓN #324, COL. ESPERANZA C.P. 24080 CAMPECHE, CAMP. TEL.: 981 815 2808

## CHIAPAS

### FIX FERRETERÍAS

AV. CENTRAL SUR #27, COL. CENTRO, C.P. 30700, TAPACHULA, CHIS. TEL.: 962 118 4083

## CHIHUAHUA

### SUCURSAL CHIHUAHUA

AV. SILVESTRE TERRAZAS #128-11, PARQUE INDUSTRIAL BAFAR, CARRETERA MÉXICO CUAUHTÉMOC, C.P. 31415, CHIHUAHUA, CHIH. TEL. 614 434 0052

## CIUDAD DE MÉXICO

### FIX FERRETERÍAS

EL MONSTRUO DE CORREGIDORA, CORREGIDORA # 35, COL. CENTRO, C.P. 06060, CUAUHTÉMOC, CDMX. TEL: 55 5522 5051 / 5522 4861

## COAHUILA

### SUCURSAL TORREÓN

CALLE METAL MECÁNICA #280, PARQUE INDUSTRIAL ORIENTE, C.P. 27278, TORREÓN, COAH. TEL.: 871 209 68 25

## COLIMA

### BOMBAS Y MOTORES BYMTESSA DE MANZANILLO

BVD. MIGUEL DE LA MADRID #190, COL. 16 DE SEPTIEMBRE, C.P. 28239, MANZANILLO, COL. TEL.: 314 352 1986 / 352 8013

## DURANGO

### TORNILLOS ÁGUILA, S.A. DE C.V.

MAZURIO #200, COL. LUIS ECHEVERRÍA, DURANGO, DGO. TEL.: 618 817 1946 / 618 818 2844

## ESTADO DE MÉXICO

### SUCURSAL CENTRO JILOTEPEC

PARQUE INDUSTRIAL # 1, COL. PARQUE INDUSTRIAL JILOTEPEC, JILOTEPEC, EDO. DE MÉX. C.P. 54257 TEL: 761 782 9101 EXT. 5728 Y 5102

## GUANAJUATO

### CÍA. FERRETERA NUEVO MUNDO S.A. DE C.V.

AV. MÉXICO - JAPÓN #225, CD. INDUSTRIAL, C.P. 38010, CELAYA, GTO. TEL.: 461 617 7578 / 79 / 80 / 88

## GUERRERO

### CENTRO DE SERVICIO ECLIPSE

CALLE PRINCIPAL MZ.1 LT. 1, COL. SANTA FE, C.P. 39010, CHILPANCIÑO, GRO. TEL.: 747 478 5793

## HIDALGO

### FERREPRECIOS S.A. DE C.V.

LIBERTAD ORIENTE #304 LOCAL 30, INTERIOR DE PASAJE ROBLED0, COL. CENTRO, C.P. 43600, TULANCINGO, HGO. TEL.: 775 753 6615 / 775 753 6616

## JALISCO

### SUCURSAL GUADALAJARA

AV. ADOLFO B. HORN # 6800, COL. SANTA CRUZ DEL VALLE, C.P.: 45655, TLAJOMULCO DE ZUNIGA, JAL. TEL.: 33 3606 5285 AL 90

## MICHOACÁN

### FIX FERRETERÍAS

AV. PASEO DE LA REPÚBLICA #3140-A, COL. EX-HACIENDA DE LA HUERTA, C.P. 58050, MORELIA, MICH. TEL.: 443 334 6858

## MORELOS

### FIX FERRETERÍAS

CAPITÁN ANZURES #95, ESQ. JOSÉ PERDIZ, COL. CENTRO, C.P. 62740, CUAUTLA, MOR. TEL.: 735 352 8931

## NAVARRIT

### HERRAMIENTAS DE TEPIIC

MAZATLÁN #117, COL. CENTRO, C.P. 63000, TEPIIC, NAY. TEL.: 311 258 0540

## NUEVO LEÓN

### SUCURSAL MONTERREY

CARRETERA LAREDO #500, 1B MONTERREY PARKS, COLONIA PUERTA DE ANAHUAC, C.P. 66052, ESCOBEDO, NUEVO LEÓN, TEL.: 81 8352 8791 / 81 8352 8790

## OAXACA

### FIX FERRETERÍAS

AV. 20 DE NOVIEMBRE #910, COL. CENTRO, C.P. 68300, TUXTEPEC, OAX. TEL.: 287 106 3092

## PUEBLA

### SUCURSAL PUEBLA

AV. PERIFÉRICO #2-A, SAN LORENZO ALMECATLA, C.P. 72710, CUAUHTLACINGO, PUE. TEL.: 222 282 8282 / 84 / 85 / 86

## QUERÉTARO

### ARU HERRAMIENTAS S.A. DE C.V.

AV. PUERTO DE VERACRUZ #110, COL. RANCHO DE ENMEDIO, C.P. 76842, SAN JUAN DEL RÍO, QRO. TEL.: 427 268 4544

## QUINTANA ROO

### FIX FERRETERÍAS

CARRETERA FEDERAL MZ. 46 LT. 3 LOCAL 2, COL. EJIDAL, C.P. 77710 PLAYA DEL CARMEN, Q.R. TEL.: 984 267 3140

## SAN LUIS POTOSÍ

### FIX FERRETERÍAS

AV. UNIVERSIDAD #1850, COL. EL PASEO, C.P. 78320, SAN LUIS POTOSÍ, S.L.P. TEL.: 444 822 4341

## SINALOA

### SUCURSAL CULIACÁN

AV. JESÚS KUMATE SUR #4301, COL. HACIENDA DE LA MORA, C.P. 80143, CULIACÁN, SIN. TEL.: 667 173 9139 / 173 8400

## SONORA

### FIX FERRETERÍAS

CALLE 5 DE FEBRERO #517, SUR LT. 25 MZ. 10, COL. CENTRO, C.P. 85000, CD. OBREGÓN, SON. TEL.: 644 413 2392

## TABASCO

### SUCURSAL VILLAHERMOSA

CALLE HELIO LOTES 1, 2 Y 3 MZ. #1, COL. INDUSTRIAL, 2A ETAPA, C.P. 86010, VILLAHERMOSA, TAB. TEL.: 993 353 7244

## TAMAULIPAS

### VM ORINGS Y REFACCIONES

CALLE ROSITA #527 ENTRE 20 DE NOVIEMBRE Y GRAL. RODRÍGUEZ, FRACC. REYNOSA, C.P. 88780, REYNOSA, TAMS. TEL.: 899 926 7552

## TLAXCALA

### SERVICIOS Y HERRAMIENTAS INDUSTRIALES

PABLO SIDAR #132, COL. BARRIO DE SAN BARTOLOMÉ, C.P. 90970, SAN PABLO DEL MONTE, TLAX. TEL.: 222 271 7502

## VERACRUZ

### LA CASA DISTRIBUIDORA TRUPER

BVD. PRIMAVERA, ESQ. HORTENSIYA S/N, COL. PRIMAVERA C.P. 93308, POZA RICA, VER. TEL.: 782 825 8100 / 826 8484

## YUCATÁN

### SUCURSAL MÉRIDA

CALLE 33 #600 Y 602, LOCALIDAD ITZINCAB Y MULSAV, MPIO. UMAN, C.P. 97390, MÉRIDA, YUC. TEL.: 999 912 2451

Model	Code	Brand
TALI-20P2K	29001	PRETUL

Warranty. Duration: 1 year. Coverage: parts, components and workmanship against manufacturing or operating defects, except if used under conditions other than normal; when it was not operated in accordance with the instructive; was altered or repaired by personnel not authorized by TRUPER®. To make the warranty valid, present the product, stamped policy or invoice or receipt or voucher, in the establishment where you bought it or in Corregidora 35, Centro, Cuauhtémoc, CDMX, 06060, where you can also purchase parts, components, consumables and accessories. It includes the costs of transportation of the product that derive from its fulfillment of its service network. Phone number 800-018-7873. Made in China. Imported by TRUPER, S.A. de C.V. Parque Industrial 1, Parque Industrial Jilotepec, Jilotepec, Edo. de Méx. C.P. 54257, Phone number 761 782 9100.

Stamp of the business. Delivery date:

