

FOSET. Llave temporizadora para lavabo

47918
LLI-10

INSTRUCTIVO

Lea cuidadosamente las siguientes instrucciones de uso antes de instalar.

Herramientas recomendadas



1. Ubique y cierre la llave de suministro de agua. Generalmente se encuentran debajo del lavabo. Si se trata de un reemplazo de grifo, quite el grifo viejo y limpie completamente la superficie del lavabo.

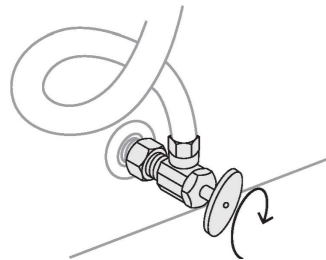

3. Inserte la llave en el lavabo con su chapetón.

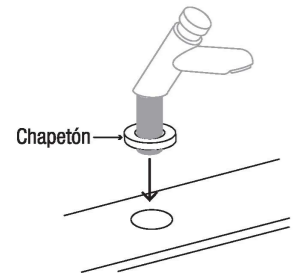

5. Abra el suministro de agua, purgue la línea de alimentación y ciérrela.

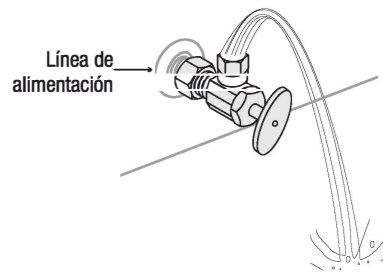

2. Desenrosque la tuerca y retire el empaque.

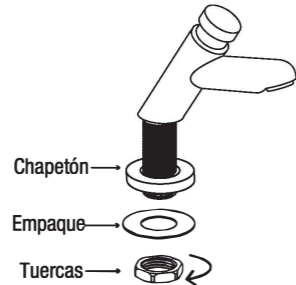

4. Inserte el empaque y enrosque la tuerca.

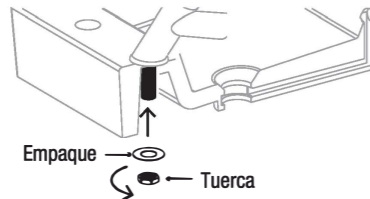

6. Enrosque la manguera (no incluida) a la línea de alimentación.

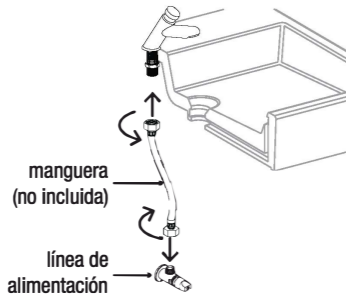

7. Abra el suministro de agua.

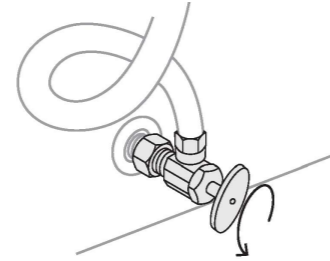

MANTENIMIENTO DE LA VÁLVULA TEMPORIZADORA

1. Desenrosque la válvula temporizadora.

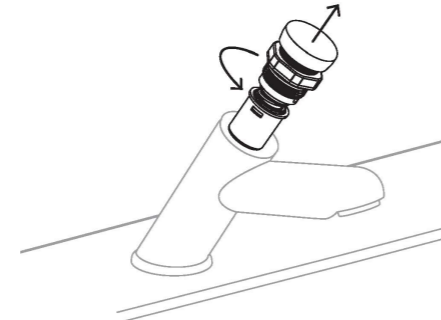

3. Limpie la parte inferior de la válvula y el vaso con cepillo a chorro de agua.



NMX

NMX-C-415-ONNCCE-2015

Importado por Truper, S.A. de C.V. Parque Industrial 1, Parque Industrial Jilotepec, Jilotepec, Edo. de Méx. C.P. 54257 Made in/Hecho en China, Tel.: 76 1782 9100. www.truper.com 04-2022

8. Para abrir el flujo de agua, oprima la válvula y automáticamente se cerrará el flujo.

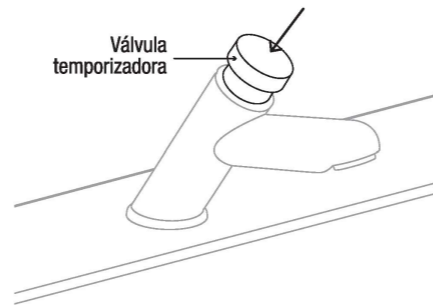

2. Retire el vaso y el resorte, posteriormente inserte y retire el resorte tres veces para limpiar el orificio de la válvula.

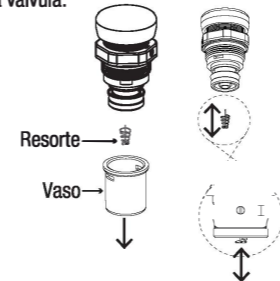

4. Inserte el resorte y el vaso en la válvula temporizadora y arme nuevamente.

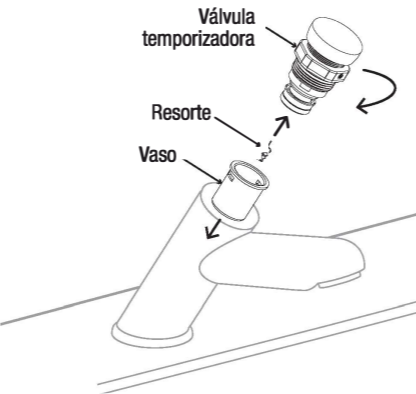

FOSET. Self-closing lavatory faucet

47918
LLI-10

INSTALLATION INSTRUCTIONS

Read carefully the following using instructions before installing.

Recommended tools

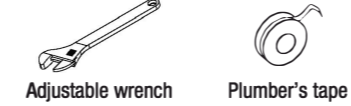

1. Locate and close the water supply valve. Usually found under the sink. If it is a replacement faucet, remove the old faucet and clean the entire surface of the sink's surface.

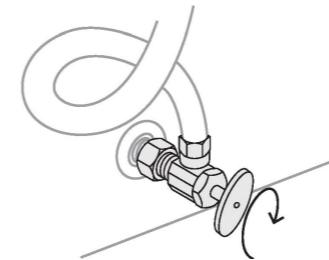

3. Insert the faucet into the sink with its escutcheon.

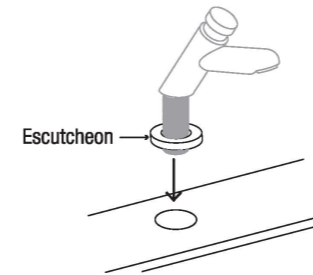

5. Open the water supply, purge the supply line and close it.

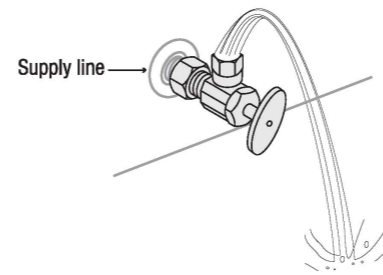

2. Unscrew the nuts, remove the washer, separator and gasket.

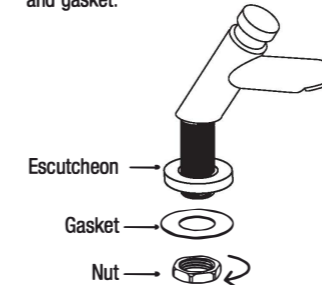

4. Insert the gasket and screw on the nut.

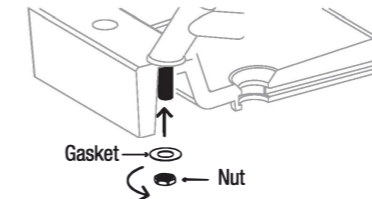

6. Screw the hose (not included) to the supply line.

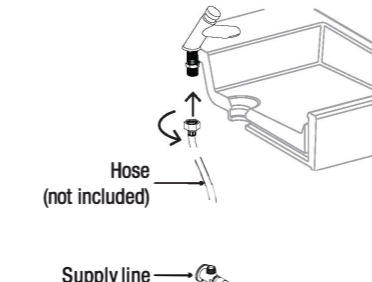

7. Open the water supply.

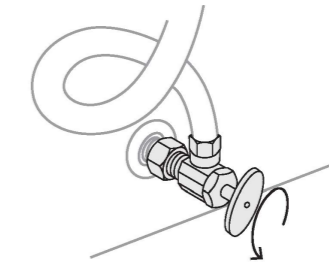

TIMER VALVE MAINTENANCE

1. Unscrew the timer valve.

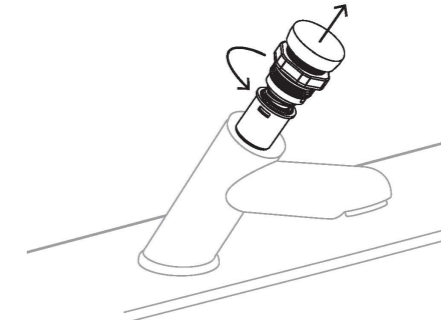

3. Clean the bottom of the valve and the cup with water and a soft brush.

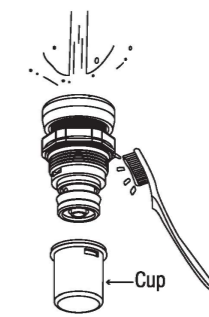

NMX

NMX-C-415-ONNCCE-2015

Imported by Truper, S.A. de C.V. Parque industria 1 Parque industrial Jilotepec, Jilotepec Edo. de Méx. C.P. 54257 Made in/Hecho en China, Tel.: 76 1782 9100. www.truper.com

8. To open the water flow, push the valve and it will automatica y close the flow

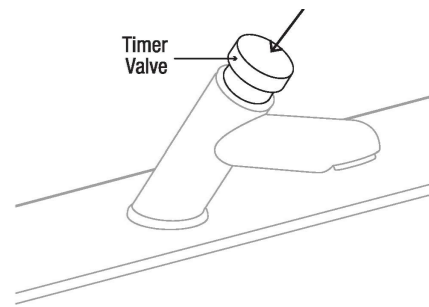

2. Remove the cup and spring, then insert and remove the spring three times to clean the valve hole.

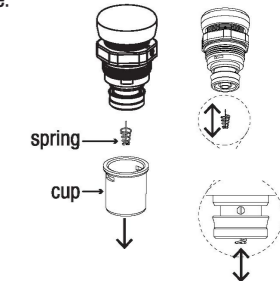

4. Insert the spring and the cup into the timer valve and assemble again

